

Project Name

Qty

Type

Catalog / Part Number

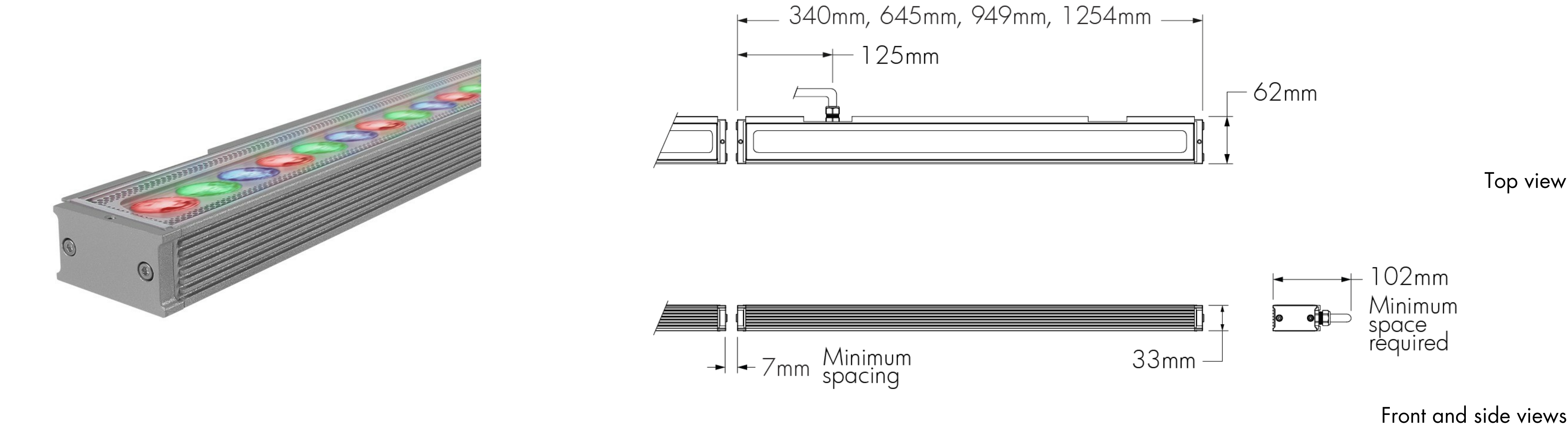

Photometric Summary

| | Delivered output (lm) | Intensity (peak cd) |
|---------|-----------------------|---------------------|
| WW | 1,565 | 2,464 |
| 8°x8° | 1,901 * | 36,611 * |
| 10°x10° | 1,771 * | 18,023 * |
| 10°x30° | 1,800 * | 14,126 * |
| 10°x60° | 1,898 | 8,350 |
| 10°x90° | 1,681 * | 3,712 * |
| 30°x30° | 1,770 * | 6,921 * |
| 30°x60° | 1,815 * | 2,406 * |
| 60°x60° | 1,620 * | 1,417 * |
| 90°x90° | 1,688 * | 886 * |

Based on RGB full output, 4ft [1219mm], DMX/RDM configuration.

Photometric performance is measured in compliance with IESNA LM-79-08.

*Estimated. Consult website for the latest photometric files.

Optics

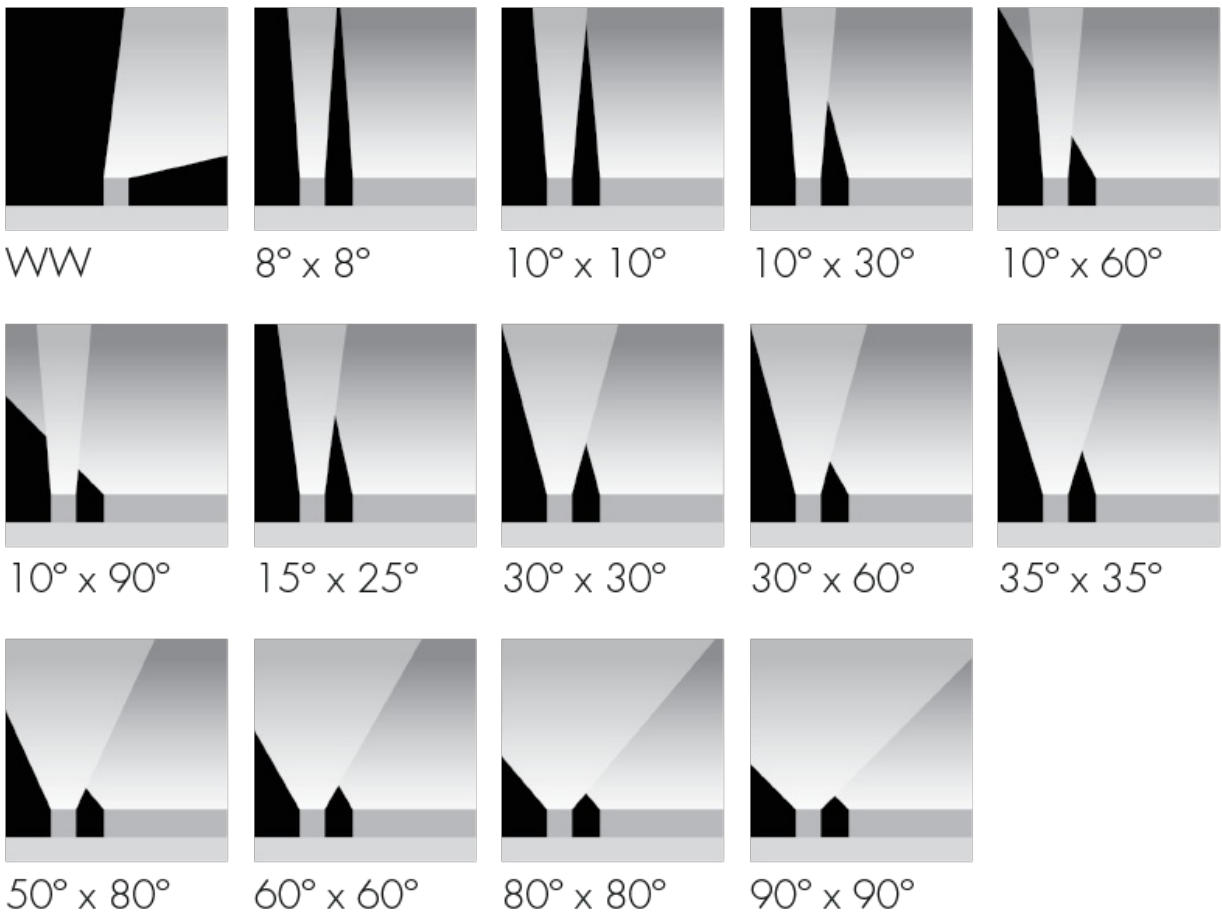

Colours and Colour Temperatures



Description

The Lumenfacade Remote Colour Changing is a high performance LED luminaire for grazing or flood-lighting exterior facades with colour. It has a remote power supply, which makes the fixture profile very slim and therefore easier to integrate into architecture. Featuring second generation LED technology, the luminaire is available in 305 mm, 610 mm, 914 mm or 1219 mm sections, and offers a wide number of options, including: a choice of optics for grazing or floodlighting; RGB, RGBW or RGBA colour mixing; various mounting options, finishes, accessories and controls. The Lumenfacade is also available with a unique asymmetric wallwash distribution, providing exceptional uniformity and brightness for walls and signage.

Features

| | |
|-------------------------------|--|
| Colour and Colour Temperature | Additive RGB, Additive RGB + white 4000K, Additive RGB + amber |
| Length (nominal) | 305 mm, 610 mm, 914 mm, 1219 mm |
| Optics | Asymmetric Wallwash, 8° x 8°, 10° x 10°, 10° x 30°, 10° x 60°, 10° x 90°, 15° x 25°, 30° x 30°, 30° x 60°, 35° x 35°, 50° x 80°, 60° x 60°, 80° x 80°, 90° x 90° |
| Options | Corrosion-resistant coating for hostile environments, 3G ANSI C136.31 Vibration Rating for bridge applications |
| Power Consumption | 49.21 W/m DC |
| Warranty | 5-year limited warranty |

Controls

DMX

Ratings

IP66IK07*
*asymmetric wallwash lens is IK06 rated

Certifications



Performance

| | |
|---------------------|---|
| Delivered Output | 1,898 lm (1219 mm fixture, RGB full output, 10° x 60°), 2,215 lm (1219 mm fixture, RGBW full output, 10° x 60°), 1,442 lm (1219 mm fixture, RGBA full output, 10° x 60°) |
| Delivered Intensity | 8,350 cd at nadir (1219 mm fixture, RGB full output, 10° x 60°), 7,300 cd at nadir (1219 mm fixture, RGBW full output, 10° x 60°), 4,730 cd at nadir (1219 mm fixture, RGBA full output, 10° x 60°) |
| Lumen Maintenance | L70 280,000 hrs, L95 35,000 hrs |

Physical

| | |
|-------------------|---|
| Housing Material | Low copper content extruded aluminium |
| Lens Material | Clear tempered glass |
| Hardware Material | Stainless steel |
| End Cap Material | Machined aluminium |
| Gasket Material | Silicone |
| Surface Finish | Electrostatically applied polyester powder coat |
| Weight | 305 mm: 0.95 kg, 610 mm: 1.77 kg, 914 mm: 2.54 kg, 1219 mm: 3.36 kg |

Electrical and control

| | |
|--------------------|---|
| Voltage | 15V DC (RGB), 12V DC (RGBW, RGBA), Remote power & data supply required |
| Fixture Cable | Power and data in one cable |
| Conductors | 4C #16-4 |
| Control | DMX enabled, Lumentalk system is enabled with LDB accessory - see typical wiring diagrams for details |
| Resolution (DMX) | Per foot or per fixture, 3 channels (RGB) or 4 channels (RGBW, RGBA) |
| RGB Colour Mixing | 12 LEDs per 305 mm (4x Red, 4x Green, 4x Blue) |
| RGBW Colour Mixing | 12 LEDs per 305 mm (3x Red, 3x Green, 3x Blue, 3x White) |
| RGBA Colour Mixing | 12 LEDs per 305 mm (3x Red, 3x Green, 3x Blue, 3x Amber) |

Environmental

| | |
|---------------------------|---|
| Storage Temperature | -40 °C to 85 °C (device must reach start-up temperature value before operating) |
| Start-up Temperature | -25 °C to 50 °C |
| Operating Temperature | -40 °C to 50 °C |
| Ingress Protection Rating | IP66 |
| Impact Resistance Rating | IK07 (asymmetric wallwash lens is IK06 rated) |

Accessories (order separately)

| | |
|---------------------------------|--|
| Control and Power Supply Boxes | DMX/RDM control box, Lumentalk Data Bridge |
| Control Systems | Lumentone™ 2, Pharos® kit |
| Diagnostic and Addressing Tools | LumenID, LumentalkID |

Asymmetric wallwash optic details

WW - Asymmetric wallwash

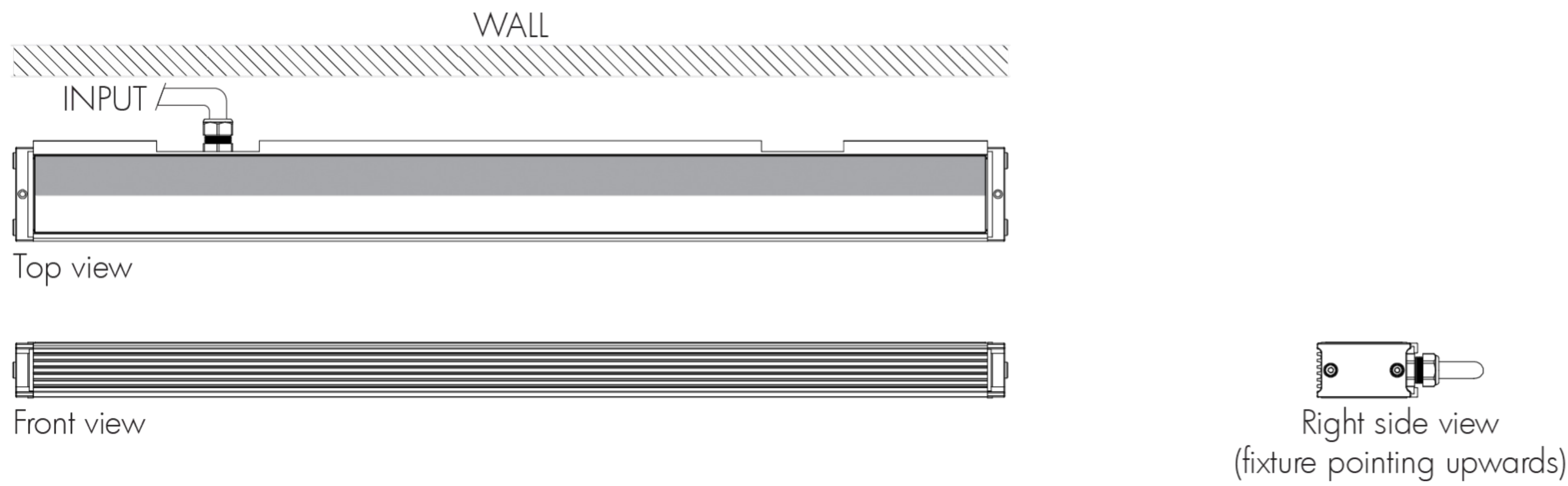

- Always position frosted side toward the wall.
- Recommended setback from wall is 1/10 of the wall height. Example: 0.6 m setback for a 6.1 m wall.

Mounting options

UMPR - Fixed Mounting Remote version

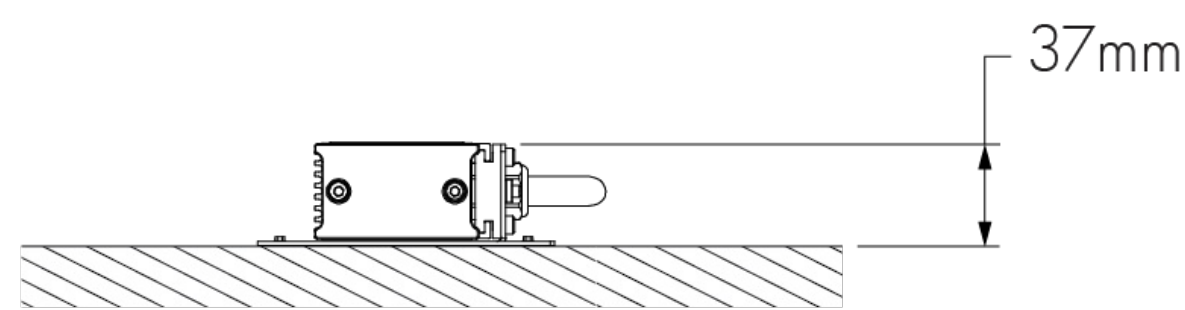

UMPR - Mounting hole pattern

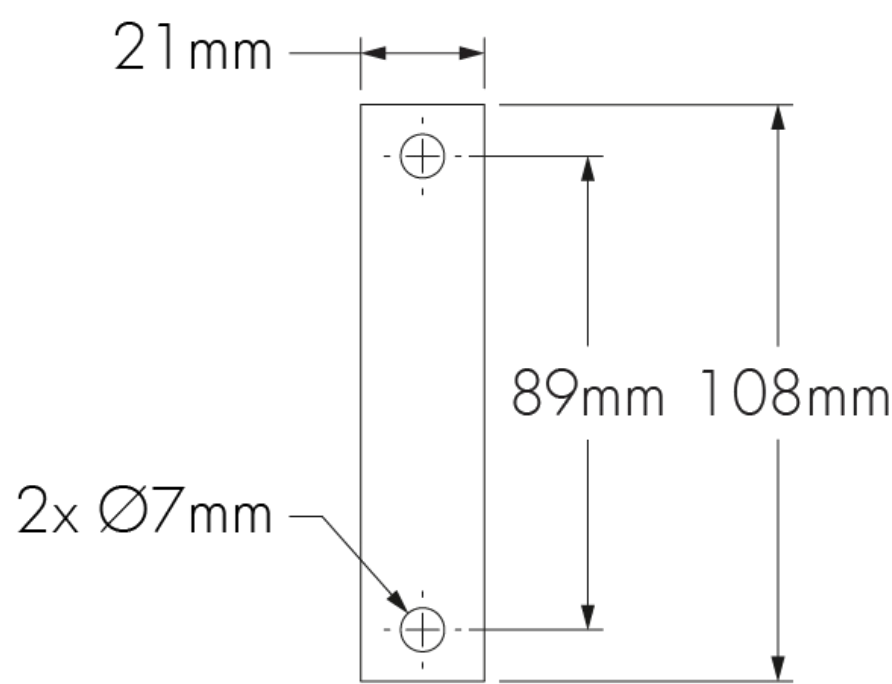

WAMR3 - Adjustable Arm Mounting 76 mm Remote version

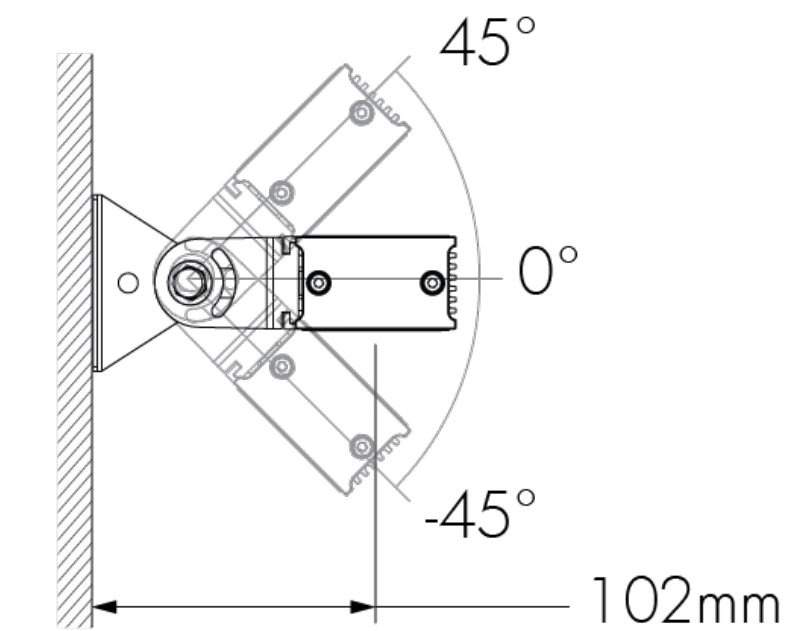

WAMR3 - Mounting hole pattern

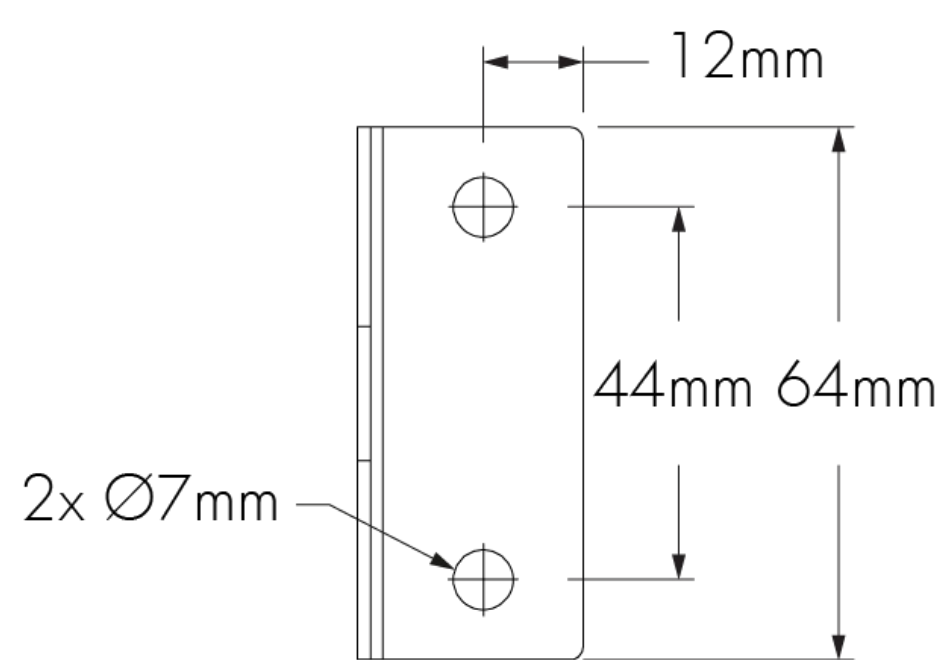

WAMR6 - Adjustable Arm Mounting 152 mm Remote version

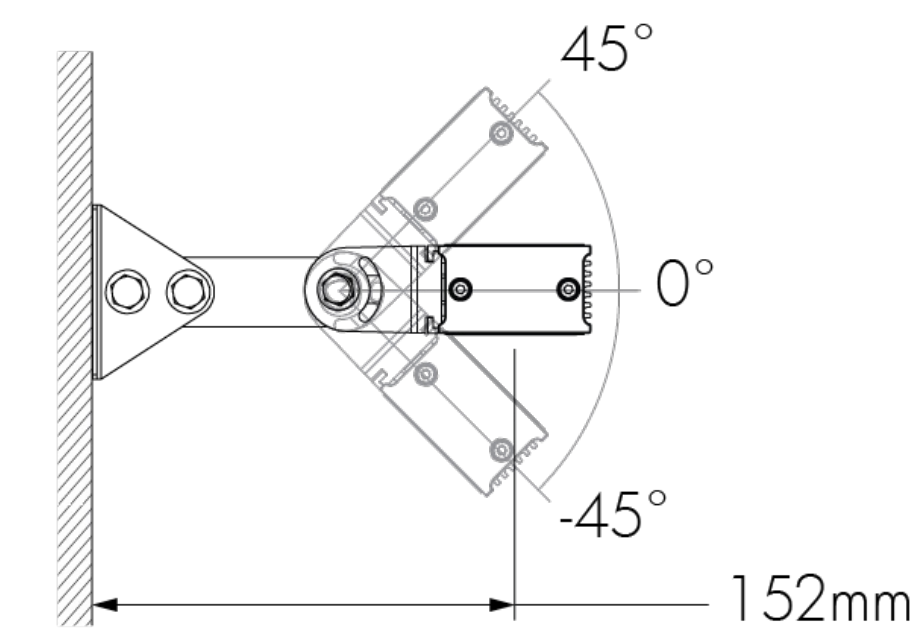

WAMR6 - Mounting hole pattern

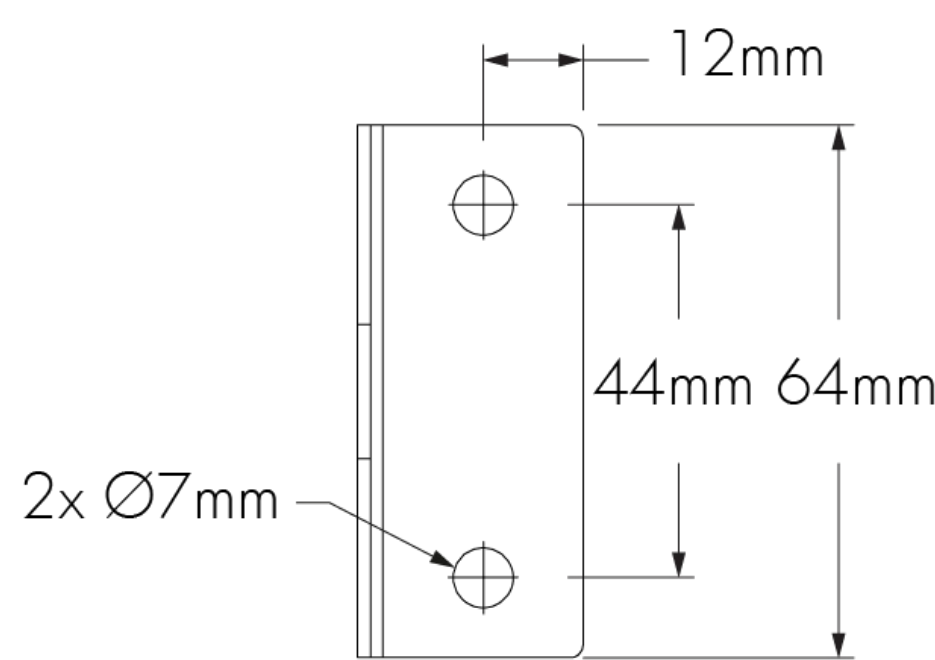

WAMR12 - Adjustable Arm Mounting 305 mm Remote version

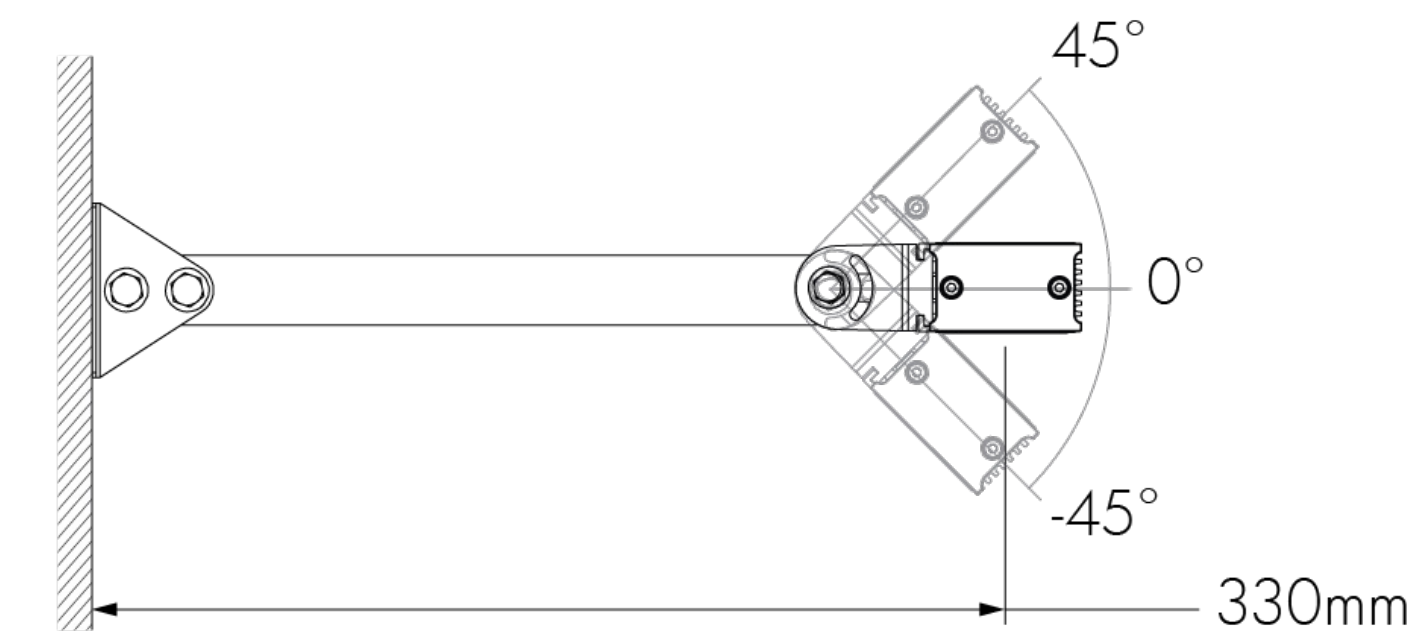

WAMR12 - Mounting hole pattern

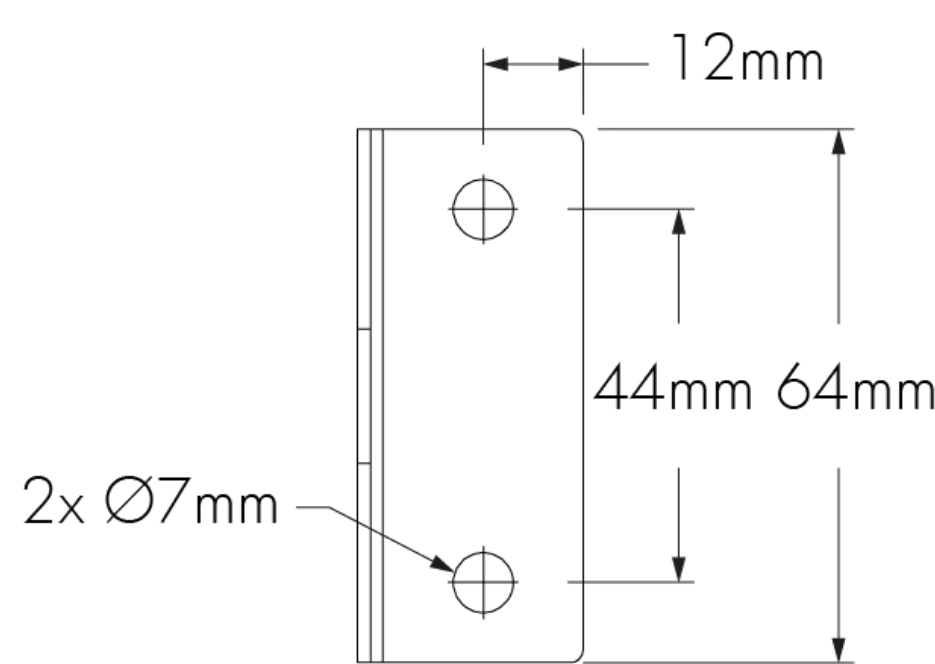

WAMR18 - Adjustable Arm Mounting 457 mm Remote version

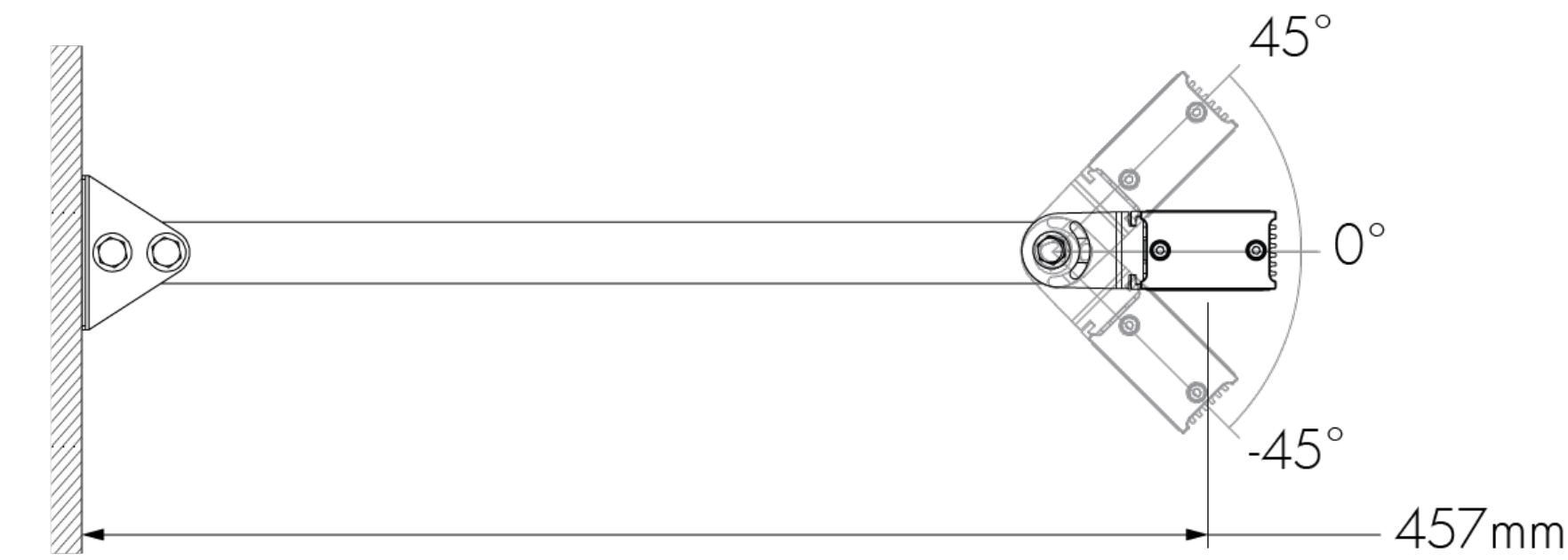

WAMR18 - Mounting hole pattern

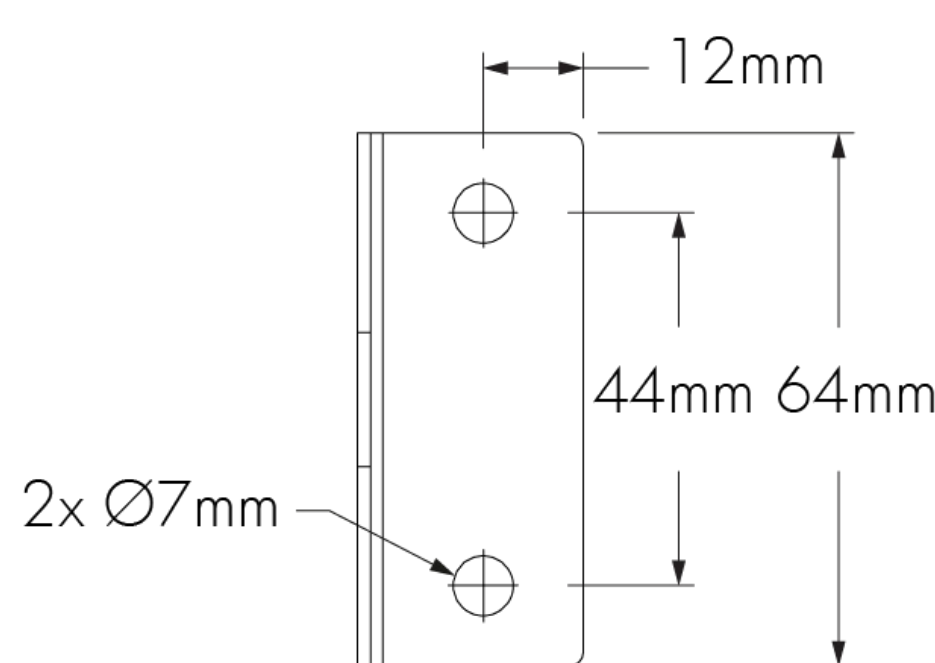

Control and power supply boxes (order separately)

CBX60-100 - DMX/RDM control box

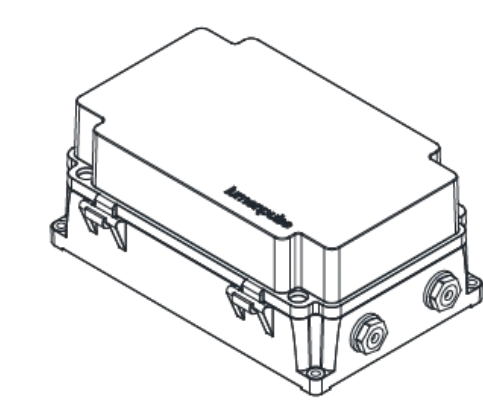

DMX/RDM control box. Up to six low voltage power and data outputs to fixtures or fixture runs. Consult CBX60, CBX100 specification sheet for details.

LDB - Lumentalk Data Bridge

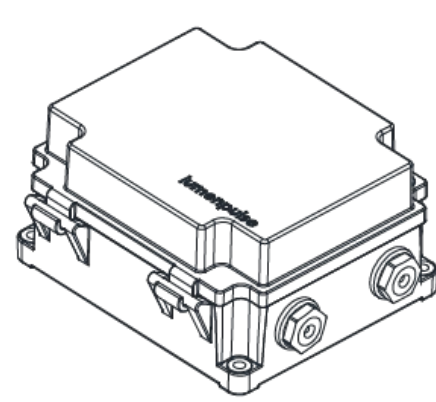

Lumentalk Data Bridge, 0-10V or DMX output. Consult LDB specification sheet for details.

Control systems (order separately)

LTN2 - Lumentone™ 2



Lumentone 2 is a simple pre-programmed DMX 512 controller with a push button rotary dial and live feedback.

PHAROS - Pharos® kit

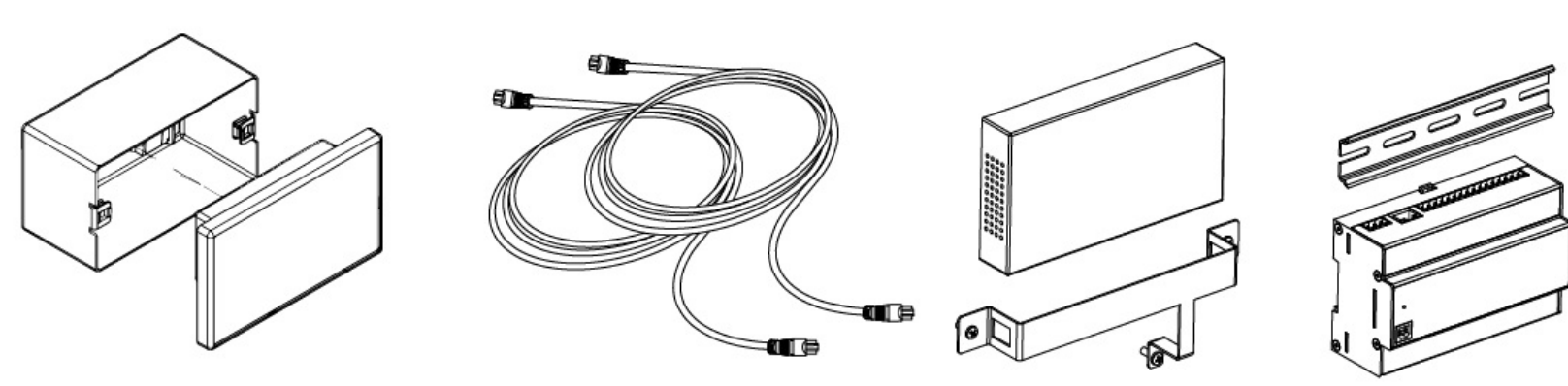

The Pharos kit, available for 1 or 2 DMX universes, allows for complete control of large lighting installations. 2 DMX universes kit shown.

Diagnostic and addressing tools (order separately)

LID - LumenID

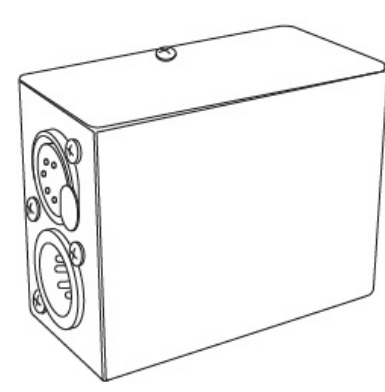

LumenID is a diagnostic and addressing DMX/RDM tool. It must be specified on all DMX applications. Consult LID specification sheet for details.

LID-LT - LumentalkID

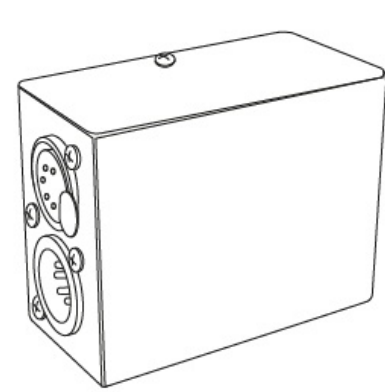

LumentalkID is a diagnostic and addressing tool. It must be specified for all Lumentalk (LT) applications. Consult LID-LT specification sheet for details.

Resolution details

1FT - Resolution per foot: each 0.3 m section is addressed independently (recommended for most installations)

DMX addresses:

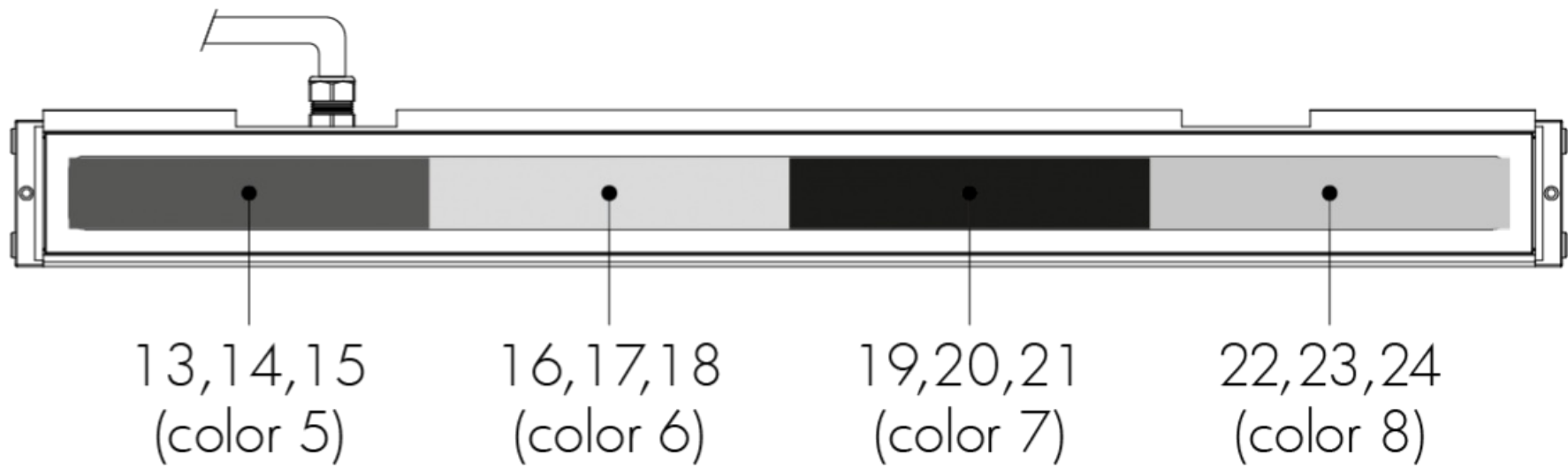
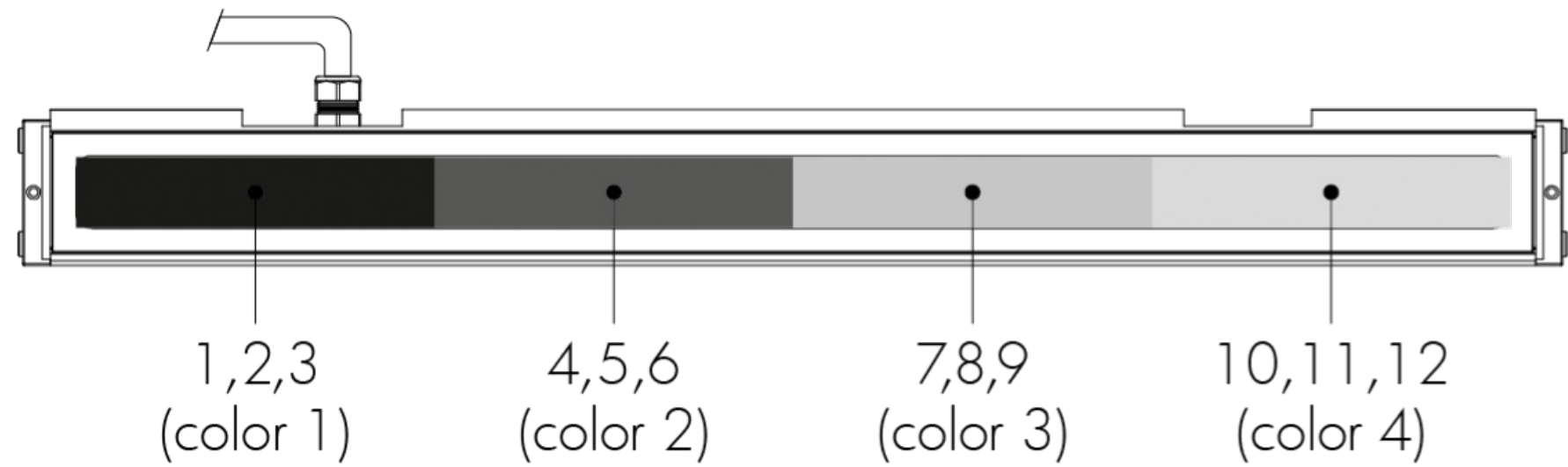

RGB colour mixing option

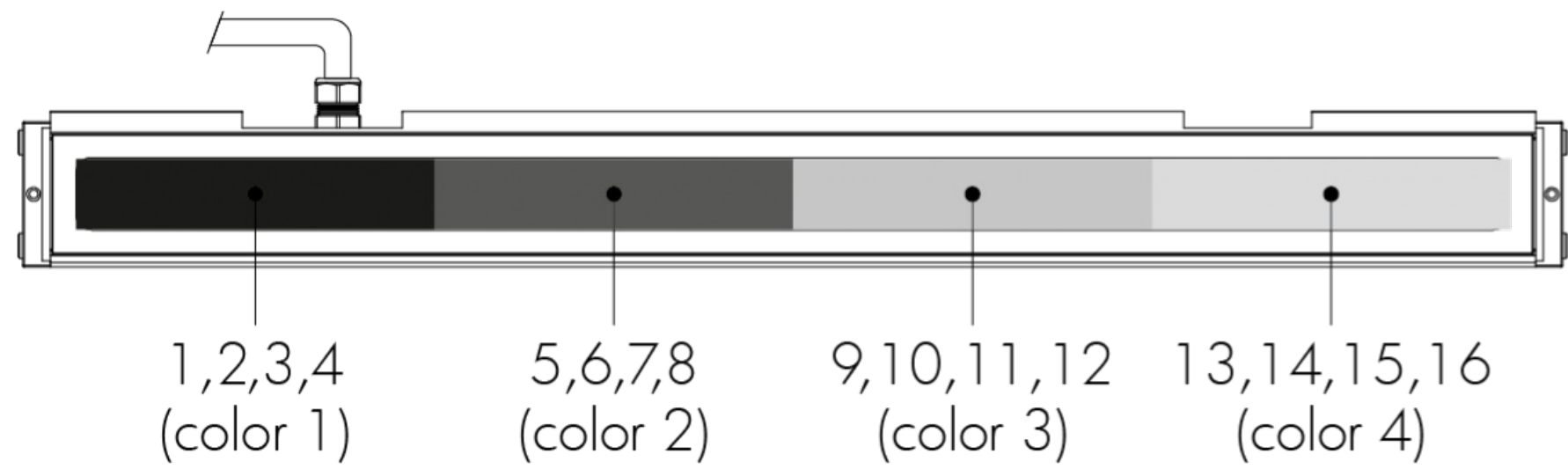

RGBW, RGBA colour mixing options

1FX - Resolution per fixture: each fixture is addressed independently

DMX addresses:

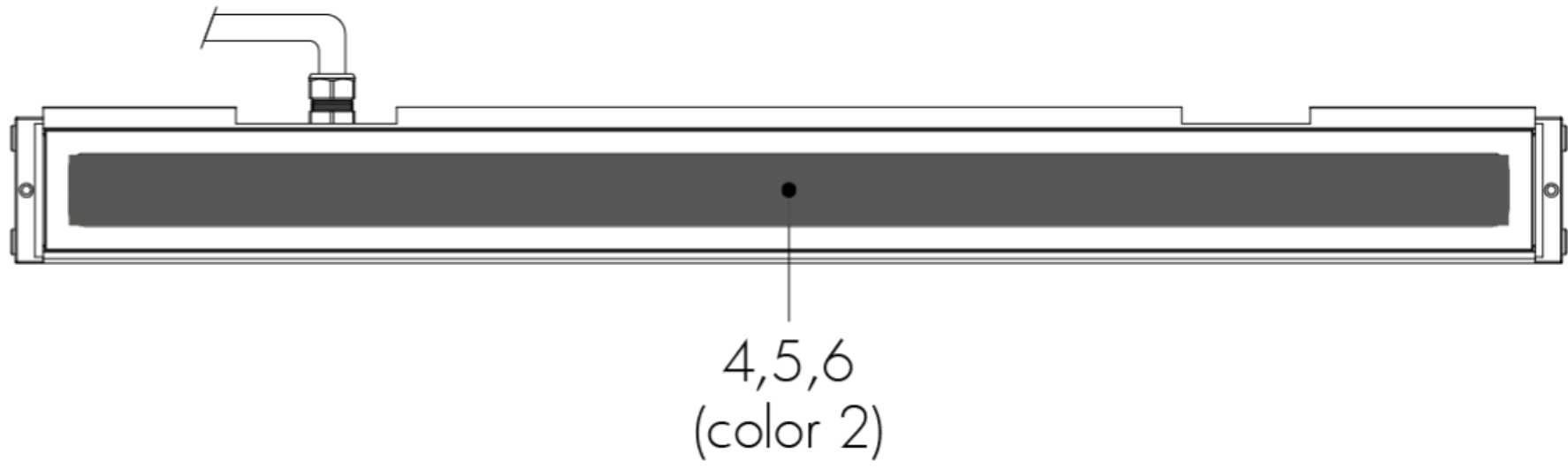
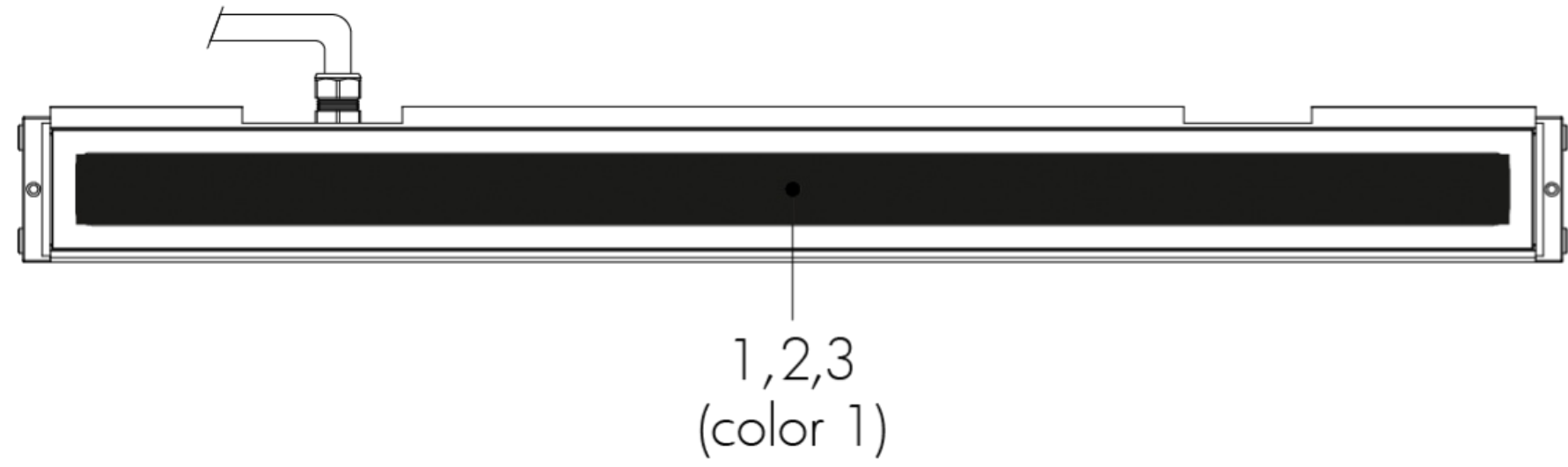

RGB colour mixing option

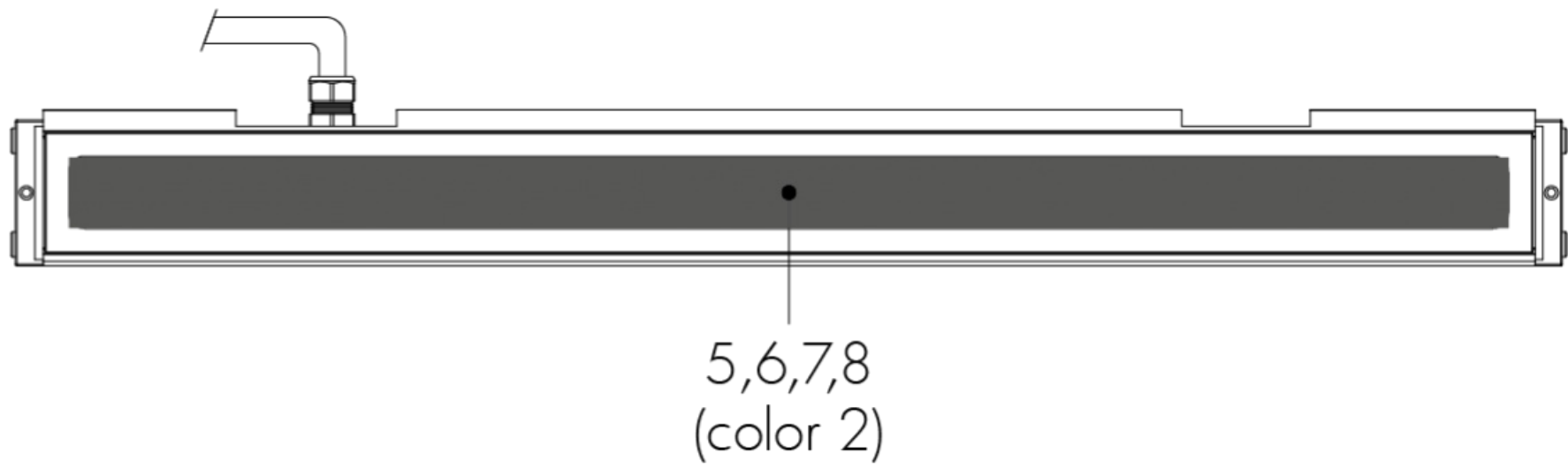
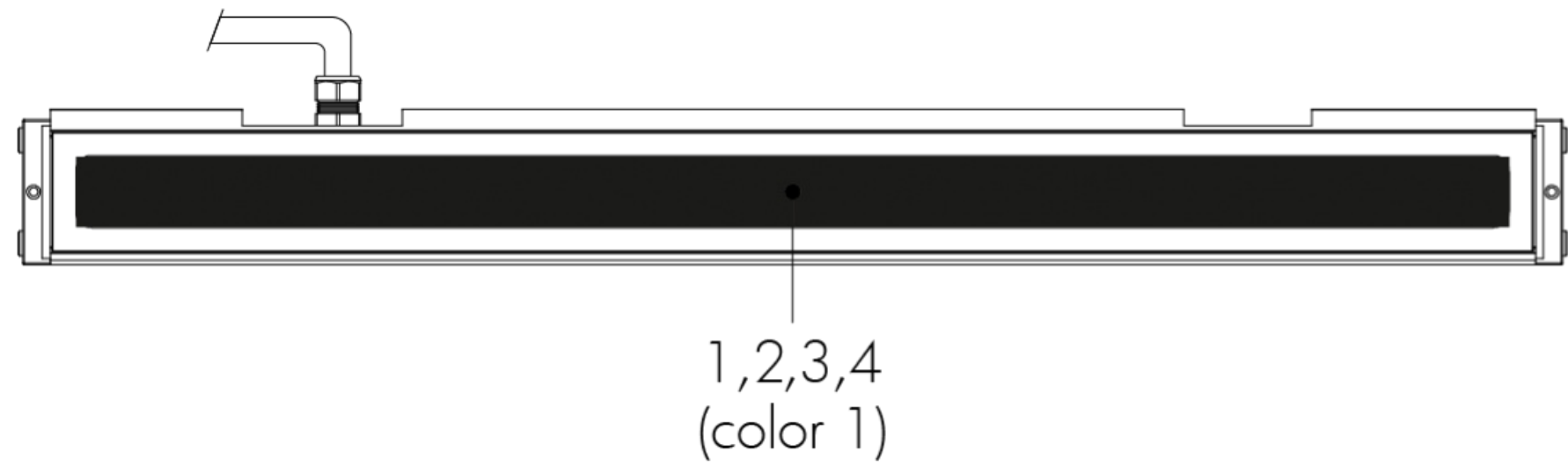

RGBW, RGBA colour mixing options

- 1219 mm fixtures shown.
- Resolution is factory set and cannot be changed in the field.

Typical wiring diagrams

Wiring colour code

| UL Color Code | USE |
|---------------|----------------|
| Red | 0-10V / Data + |
| Green | 0-10V / Data - |
| Black | 12/15/24V DC + |
| White | 12/15/24V DC - |

Maximum fixture cable length

RGB - 15V DC

| Fixture length | Maximum fixture cable length |
|----------------|------------------------------|
| 305 mm | 30.5 m |
| 610 mm | 27.4 m |
| 914 mm | 18.3 m |
| 1219 mm | 13.7 m |

RGBW - 12V DC

| Fixture length | Maximum fixture cable length |
|----------------|------------------------------|
| 305 mm | 30.5 m |
| 610 mm | 21.3 m |
| 914 mm | 13.7 m |
| 1219 mm | 10.7 m |

RGBA - 12V DC

| Fixture length | Maximum fixture cable length |
|----------------|------------------------------|
| 305 mm | 30.5 m |
| 610 mm | 21.3 m |
| 914 mm | 13.7 m |
| 1219 mm | 10.7 m |

Lumentalk (LT using LDB-DMX)

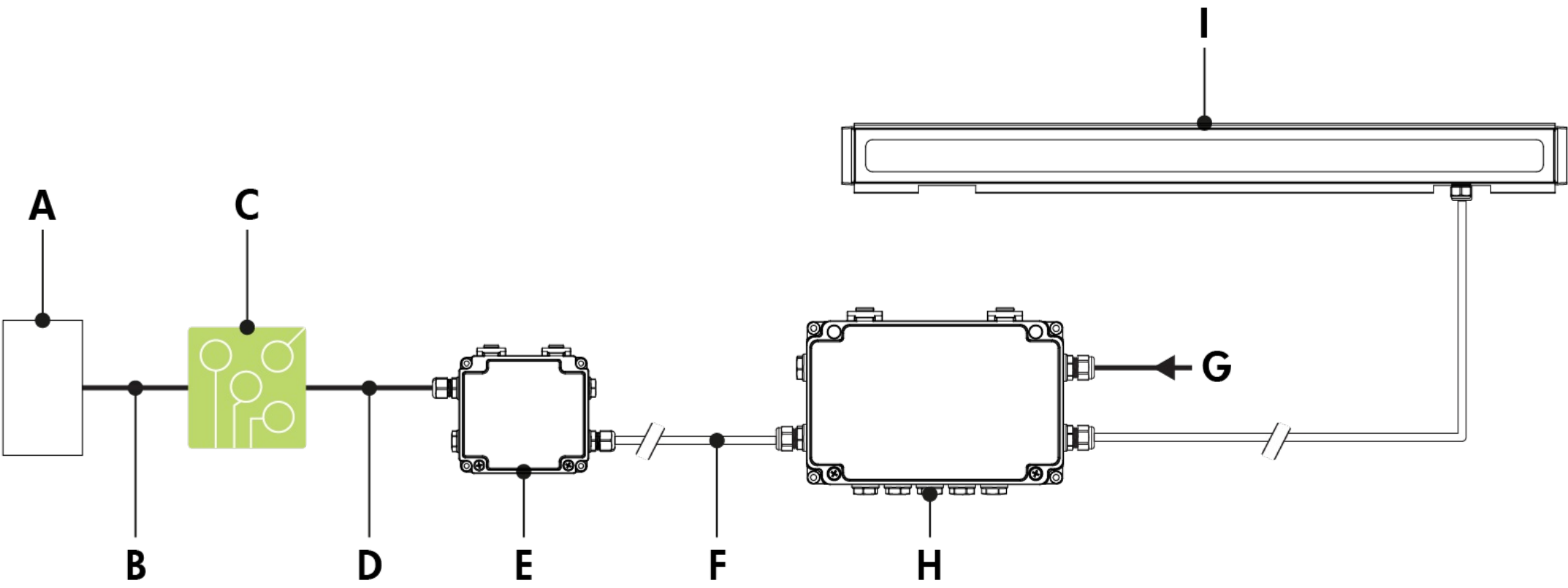

- A** - DMX controller (order separately from Lumenpulse, or by others)
- B** - Data wiring (by others)
- C** - Lumentranslator (LTL-DMX)
- D** - Power line (100-277V AC, wiring by others)
- E** - Lumentalk Data Bridge (LDB-DMX)
- F** - Data wiring (by others)
- G** - Power input (100-277V, wiring by others)
- H** - CBX60
- I** - Lumenfacade Remote

- Consult CBX60 installation instructions for additional wiring details.
- Consult factory for specific applications and maximum fixture count/cable length recommendations.
- Lumentalk Data Bridge required for Lumentalk system, see LDB installation instructions for details. Fixtures must be specified as 1FT or 1FX and Lumentalk Data Bridge must be specified as DMX. 2-step commissioning process: 1 - DMX system using LumenID software and a LID, 2 - Lumentalk system using LumentalkID software and a LID-LT. Consult factory for details.
- Maximum of 1 DMX controller per Lumentalk network, maximum of 48 DMX channels per Lumentalk network (minimum step transition update rate is 1 second, minimum fade time between two colours is 1 minute). Consult factory for applications that require additional capabilities.
- Maximum of 1 transmitter (Lumentranslator or Lumenlink) per system.
- No third party fixtures allowed on the same circuit.
- 49.21 W/m DC.

DMX (1FT or 1FX)

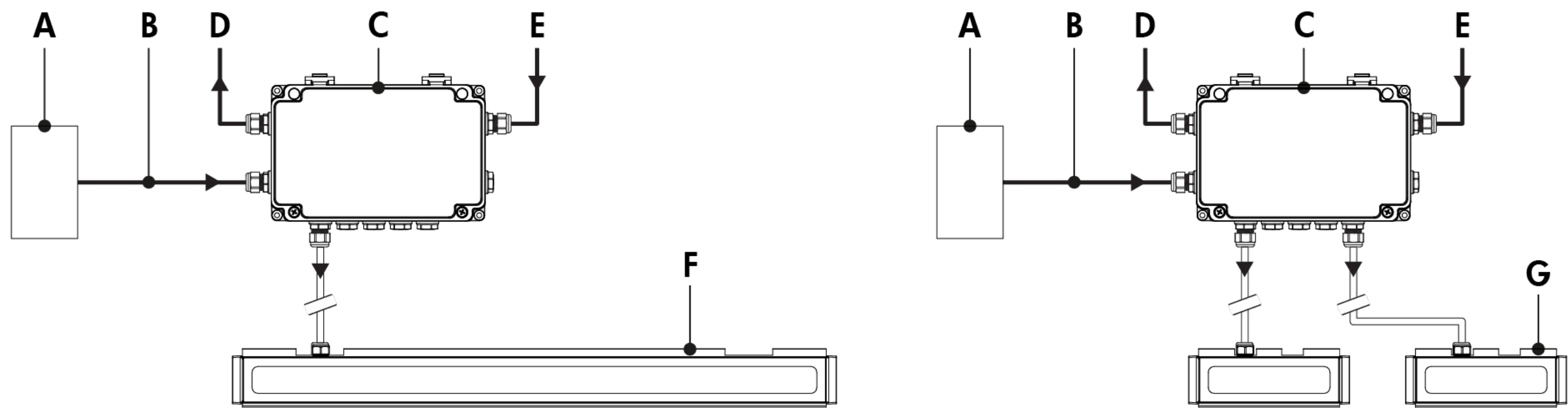

- A** - DMX controller (order separately from Lumenpulse, or by others)
- B** - Data input (Belden 9841 or equivalent, by others)
- C** - CBX60
- D** - Data output to next CBX60 (optional, not isolated/not boosted)
- E** - Power input (100-277V, wiring by others)
- F** - Lumenfacade Remote
- G** - Lumenfacade Remote

- Consult CBX60 installation instructions for additional wiring details.
- Consult factory for specific applications and maximum fixture count/cable length recommendations.
- Maximum of 6 outputs per CBX60.
- 49.21 W/m DC.

| How to order | | | | | | | |
|--------------|----|---|---|---|---|---|---|
| 1 | 2 | 3 | 4 | 5 | 6 | 7 | 8 |
| | | | | | | | |
| 9 | 10 | | | | | | |
| | | | | | | | |

1 . Housing

| | |
|------|----------------------------------|
| LOGR | Lumenfacade™ Remote Power Supply |
|------|----------------------------------|

2 . Cable Length

| | |
|-------|-----------------------|
| 10FT | 3 m |
| 20FT | 6.1 m |
| 30FT | 9.1 m |
| 50FT | 15.2 m ⁽¹⁾ |
| 70FT | 21.3 m ⁽²⁾ |
| 100FT | 30.5 m ⁽³⁾ |

⁽¹⁾ Not available for 914 mm RGBW, 914 mm RGBA or 1219 mm fixture lengths.

⁽²⁾ Not available for 914 mm or 1219 mm fixture lengths.

⁽³⁾ Not available for 610 mm, 914 mm or 1219 mm fixture lengths.

3 . Voltage

| | |
|-----|-------------------------------|
| 15V | 15V DC fixture ⁽¹⁾ |
| 12V | 12V DC fixture ⁽²⁾ |

⁽¹⁾ Available for RGB colour option only.

⁽²⁾ Available for RGBW and RGBA colour options only.

4 . Length

| | |
|----|---------------------------------|
| 12 | 340 mm (0.95 kg) ⁽¹⁾ |
| 24 | 645 mm (1.77 kg) |
| 36 | 949 mm (2.54 kg) |
| 48 | 1254 mm (3.36 kg) |

⁽¹⁾ To connect to the Lumentalk system, 1FT or 1FX must be specified as the control option, and a Lumentalk Data Bridge (LDB-DMX) is required. See the typical wiring diagrams in the specification sheet for details.

5 . Colour and Colour Temperature

| | |
|------|--|
| RGB | Additive RGB |
| RGBW | Additive RGB + white 4000K standard. 2700K, 3000K and 3500K available, consult factory. ⁽¹⁾ |
| RGBA | Additive RGB + amber |

⁽¹⁾ Longer lead times apply for Royal Blue, 2700K, 3000K and 3500K white colour temperature mixes.

6 . Control ⁽¹⁾ ⁽²⁾

| | |
|-----|----------------------------|
| 1FT | DMX resolution per foot |
| 1FX | DMX resolution per fixture |

⁽¹⁾ To connect to the Lumentalk system, 1FT or 1FX must be specified as the control option, and a Lumentalk Data Bridge (LDB-DMX) is required. See the typical wiring diagrams in the specification sheet for details.

⁽²⁾ A Lumentranslator and LumentalkID (LIDLT) must be specified for Lumentalk applications. Consult Lumentranslator and Lumentalk pages and specification sheets for details.

7 . Optics

| | |
|--------------|--------------------------|
| WW | Asymmetric Wallwash |
| 8x8 | 8° x 8° ⁽¹⁾ |
| 10x10 | 10° x 10° ⁽¹⁾ |
| 10x30 | 10° x 30° |
| 10x60 | 10° x 60° |
| 10x90 | 10° x 90° |
| 15x25 | 15° x 25° |
| 30x30 | 30° x 30° |
| 30x60 | 30° x 60° |
| 35x35 | 35° x 35° |
| 50x80 | 50° x 80° |
| 60x60 | 60° x 60° |
| 80x80 | 80° x 80° |
| 90x90 | 90° x 90° |

⁽¹⁾ For best results, we recommend a 152 mm setback from surface. Contact factory for application support.

10 . Options

| | |
|------------|---|
| CRC | Corrosion-resistant coating for hostile environments ⁽¹⁾ |
| 3GV | 3G ANSI C136.31 Vibration Rating for bridge applications ⁽²⁾ |

⁽¹⁾ Use only when exposed to salt spray and harsh chemicals. This option is not required for normal outdoor exposure.

⁽²⁾ Available with UMPR mounting option only.

8 . Mounting Options

| | |
|---------------|---|
| UMPR | Fixed Mounting Remote version ⁽¹⁾ |
| WAMR3 | Adjustable Arm Mounting 76 mm Remote version |
| WAMR6 | Adjustable Arm Mounting 152 mm Remote version |
| WAMR12 | Adjustable Arm Mounting 305 mm Remote version |
| WAMR18 | Adjustable Arm Mounting 457 mm Remote version |

⁽¹⁾ Suitable to use when 3GV option is specified.

9 . Finish

| | |
|------------|---|
| BK | Black Sandtex® |
| BRZ | Bronze Sandtex® |
| SI | Silver Sandtex® |
| WH | Smooth white |
| CC | Custom colour and finish (please specify RAL colour) ⁽¹⁾ |

⁽¹⁾ Lumenpulse offers a wide selection of RAL CLASSIC (K7) colours with a smooth texture and high-gloss finish. Please consult factory for a list of available K7 colours, other RAL textures and glosses, or to match alternate colour charts. Final colour matching results may vary.