

## USG STRUCTURAL PANEL

### CUSTOM HOME APPLICATION

- Three easy steps: lay, fasten, finish
- No pouring, no setting, no curing
- An alternative to poured concrete for noncombustible assemblies meeting ASTM E136-12
- A complete dry application
- Mold-, moisture- and termite-resistant
- Fast installation/dimensionally stable

USG Structural Panels allow for the design flexibility and versatility of wood or cold-formed steel-framed structures, while providing the durability and long-lasting benefits of traditional, time-consuming poured systems. They are truly noncombustible when tested in accordance with ASTM E136-12.

**A qualified architect or engineer should review and approve calculations, framing and fastener spacing for all projects. Be sure to check your local building codes for specific provisions.**

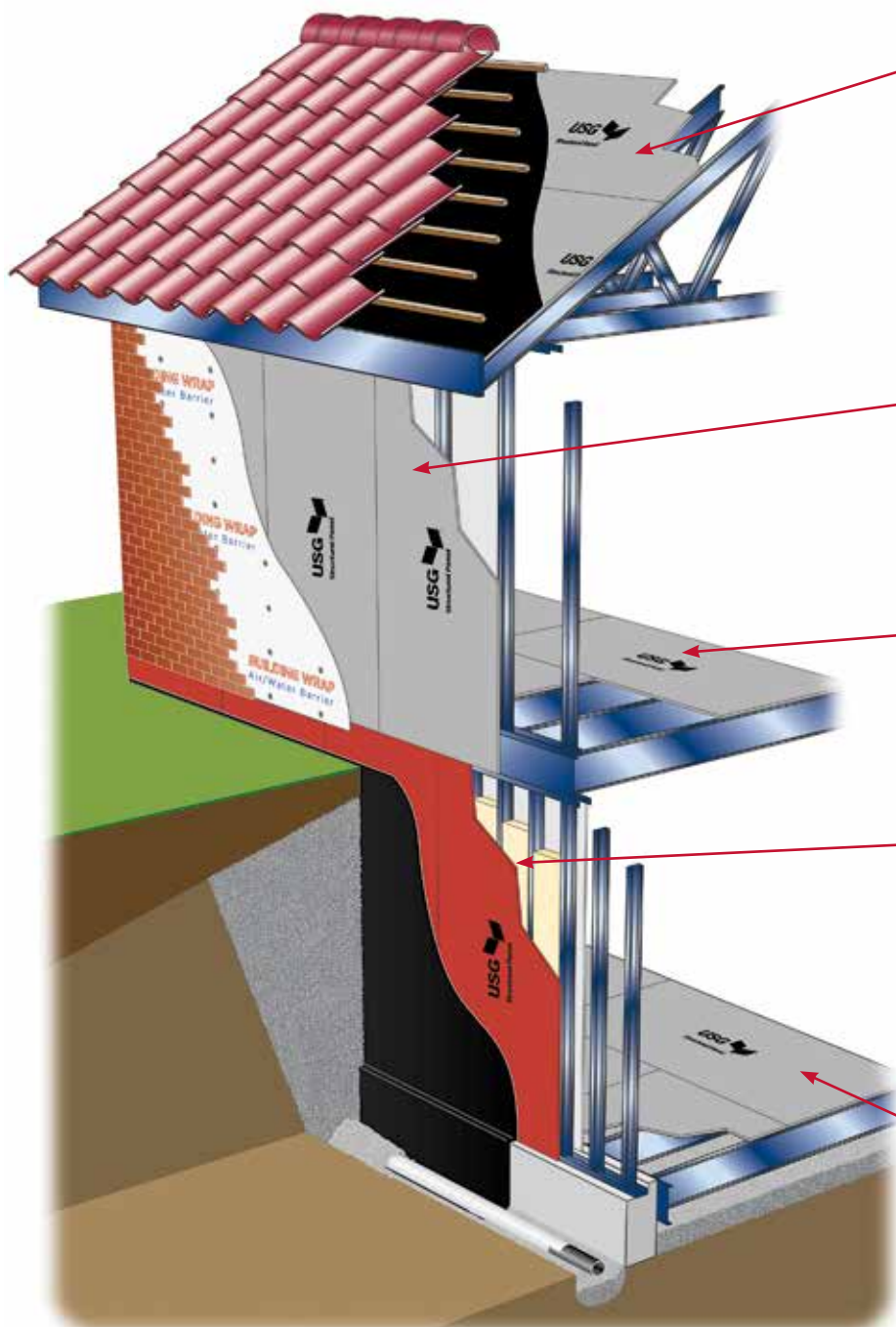

#### USG Structural Panel Concrete Roof Deck

- Low-slope roof applications: Great uplift strength and membranes can adhere directly to the panels
- Steep-slope roof applications: Sloped roof decorative coverings without any shrinking, swelling or need for gapping
- Acts as a noncombustible, nonrotting nail base
- Fire-tested: one- and two-hour UL fire-resistant roof/ceiling systems

#### USG Structural Panel Concrete Subfloor (For wall applications)

- Load-bearing capacities (axial and shear)
- Fire-tested: one-, two- and three-hour UL fire-resistant load-bearing wall systems
- Moisture-, mold- and termite-resistant
- Thinner profile and faster installation than CMU or concrete

#### USG Structural Panel Concrete Subfloor

- Great shear diaphragm and uniform load capacities
- Moisture-, mold- and termite-resistant
- Fire-tested: one- and two-hour UL fire-resistant floor/ceiling systems

#### USG Structural Panel Concrete Foundation Wall

- Designed for full-height basement (up to 2,083 psf [99.7 kPa] psi ultimate)
- Nonrotting
- Moisture-, mold- and termite-resistant
- Wall cavity can be insulated, no strapping required
- Services can be run through wall cavity
- Thinner profile and faster installation than CMU or concrete

#### USG Structural Panel Concrete Subfloor (Enhanced Vented Slab System)

- Moisture-, mold- and termite-resistant
- Vented slab design reduces moisture infiltration
- Services can be run through floor cavity
- Overall improved Indoor Air Quality and great moisture insulation

#### MSRP based upon full truckload delivered to jobsite:

**Subfloor: \$4.50/sf**  
**Roof Deck: \$5.40/sf**  
**Foundation Wall SD: \$4.90/sf**  
**Foundation Wall XD: \$7.50/sf**

SCP57-USA-ENG/rev. 10-18  
 © 2018 USG Corporation and/or its affiliates.  
 All rights reserved. Printed in U.S.A.

Manufactured by or for  
 United States Gypsum Company  
 550 West Adams Street  
 Chicago, IL 60661

800 USG.4YOU | 800 (874-4968)  
[usg.com/structural](http://usg.com/structural) | [usgstructural@usg.com](mailto:usgstructural@usg.com)

#### PRODUCT INFORMATION

See [usg.com](http://usg.com) for the most up-to-date product information.

#### TRADEMARKS

The trademarks USG, IT'S YOUR WORLD. BUILD IT., the USG logo, the design elements and colors, and related marks are trademarks of USG Corporation or its affiliates.

#### NOTICE

We shall not be liable for incidental or consequential damages, directly or indirectly sustained, nor for any loss caused by application of these goods not in accordance with current printed instruction or for other than the intended use. Our liability is expressly limited to replacement of defective goods. Any claim shall be deemed waived unless made in writing to us within thirty (30) days from date it was or reasonably should have been discovered.

#### SAFETY FIRST!

Follow good safety/industrial hygiene practices during installation. Wear appropriate personal protective equipment. Read SDS and literature before specification and installation.