

PERFORMANCE CREDENZA™

Planning Guide + Price List

QUICK LINKS

Introduction

General Information

Finish Information

Surface Materials

Planning Guide

Planning

Price List

Consoles

Utility Credenzas

Food Service Credenzas



General Information

This price book supercedes all previous versions.

Before placing your order, confirm you have all required information necessary. Lead times for orders begin after all required information is included and correct.

Delivery Information

We know lead times are important and sticking to them even more so. We work to maintain a 6-8 week lead time on all standard products in this book from receipt of a clean order. All orders are acknowledged with an approximate shipping date and will be invoiced with the price in effect at the date the purchase order is received.

Shipping charges are prepaid (within the continental U.S.). Therefore, pricing is a delivered price based on normal ground transportation. If you have special instructions, need to ship by air, or are shipping to Alaska or Hawaii, contact NuCraft Customer Service. NuCraft can also help arrange to have products blanket wrapped for an additional charge. Contact the NuCraft Customer Service team or specify it on your purchase order.

Minimum Freight Charge: Any order below \$2,100 net will be assessed a \$285 net minimum freight charge (one per order).

Orders are subject to acquiring the materials required for manufacturing. Fulfillment can be affected by strikes, fires, embargoes and acts of government. These elements are beyond our control.

NuCraft offers a variety of services to accommodate a wide range of delivery requirements. Availability of these services is dependent on a number of factors and may not be offered with all shipments. Examples of delivery services that have additional fees include:

- Specific date within our standard 3-5 day delivery window (for orders under \$50,000 net)
- Specific time of day, morning or afternoon (for orders under \$50,000 net)
- Delivery to a warehouse before delivery to its final destination (unless product is picked up at the warehouse)

Contact the NuCraft Customer Service team for availability and pricing on these services.

Freight Terms

Shipping charges for NuCraft products are prepaid for standard delivery in the continental United States. Standard delivery is defined as follows: Product is delivered on a 53' trailer being pulled by a long-haul tractor (total length of 85'). Facility will receive delivery Monday through Friday between the hours of 8:00 AM and 4:00 PM. Facility has docks with levelers and a fork truck for unloading. Product will be loaded on load bars two levels high. Receiving facility is responsible to have personnel on hand to unload the truck upon arrival, drivers do not unload. Delivery sites or times that do not meet this criteria will be accommodated, but will typically incur a charge to cover additional shipping costs. Please notify NuCraft in advance of the shipment if this is the case and the additional charge (if any) will be determined by NuCraft.

Product ships FOB dock. The customer obtains title to their product and materials, and assumes the risk of loss for them, upon shipment from NuCraft's facilities.

Storage

NuCraft has no storage facilities for finished product. If a customer cannot accept an order when it is ready for shipment, the customer must designate an alternative shipping address. If no address is provided, NuCraft may, at its discretion, transfer the product to storage. If product is transferred to an off-site storage facility, the customer may be charged for transportation to the facility and for any associated storage fees. NuCraft considers transfer of the product to a storage facility the equivalent of shipment, including invoicing and payment. Customers assume the risk of damage or loss during storage.

Transportation Times and Delays

Third party carriers that NuCraft contracts with will make reasonable efforts to accommodate requested delivery times and dates. Scheduled delivery appointments may, however, be delayed for a variety of reasons, including inclement weather, traffic, transportation equipment problems, and delays encountered at other delivery locations along the delivery route. NuCraft does not recommend scheduling activities that depend on the delivery appointment (for example, scheduling furniture installers to install furniture the day of the delivery appointment). NuCraft shall not be liable for any costs incurred as a result of a missed delivery appointment.

Shipment Damage Claims

Legal title to merchandise passes to the buyer upon acceptance by the carrier. **Inspect all cartons upon delivery.** Details of visible damage should be noted on the delivery receipt. Do not install product if damage is found upon inspection. The carrier should be notified by the buyer to inspect the merchandise, and file a claim immediately. If visible damage is not apparent, sign the delivery receipt "No visible damage." This will allow recourse for a concealed damage claim. Although most claims for transportation damages must be filed against the carrier within nine months of the date of delivery, concealed damage claims must be filed within 15 days of receipt.

Do not destroy packing materials until shipment has been inspected. Then proceed to file a claim with the carrier.

Failure to make any claims against NuCraft within 10 days shall constitute acceptance of the merchandise and a waiver of any defects, errors or shortages discovered upon inspection.

Cancellations

Cancellations must be reviewed by our Customer Service team. Because we build your products to order, orders cannot be cancelled once processing has begun. Processing includes but is not limited to development of shop drawings and other engineering drawings. If cancellation is approved, a processing fee of 20-100% will be assessed based on the status of the order.

Change Order Policy

NuCraft will make every attempt to honor any reasonable change request to product provided that the request is received prior to start of production. Change orders will be accepted only if the request is made in writing and received in time to make the change. NuCraft reserves the right to increase our acknowledged price and ship date if necessary to make the requested changes. Please submit any change order request to our Customer Service team. NuCraft will assess charges to the customer as stipulated in the following:

- Standard Orders: Change orders received prior to production will be charged \$200 net to cover print and administrative costs.
- Special Orders: Change orders received prior to production will be charged \$200 net to cover print and administrative costs. There may be additional costs associated with engineering labor required for the change order.
- Change orders received after production must be evaluated by NuCraft. If approved, the charge will be \$200 net plus any restocking charges accumulated. There may be additional costs associated with engineering labor required for the change order.



General Information

Repair Authorization

Prior written approval is required for repairs of merchandise charged to NuCraft. Failure to do so will result in customer funded repairs.

Payment Terms

Terms consist of a 1% cash discount for payment within 10 days of invoice date, or payment of the net amount within 30 days of the invoice date (1% 10 days, net 30 days). Discount is not allowed on credit card payments.

Credit Card Payments

When paying by credit card (Visa, Mastercard or American Express), include the card number, expiration date, card holder name (printed) and card holder signature on the purchase order. A credit card payment form is available upon request. No cash discount allowed on credit card payments.

Warranty

NuCraft warrants that each piece of furniture it manufactures will be free from defects in materials and workmanship for a period of ten years of single-shift use. Textiles, decorative trim, electrical components, lamps, mechanical devices, casters and custom-made products not described in NuCraft's catalog are warranted for one year from the date of original delivery. Height adjustable desk mechanisms are warranted for two years. This warranty is applicable only if the furniture is given normal and proper care and is properly installed and maintained in an office environment. This warranty extends only to products manufactured and sold in North America and only to original purchasers acquiring new NuCraft products through authorized dealers, or from others specifically authorized by NuCraft to sell its products.

NuCraft's sole obligation under this warranty is to repair or replace, at NuCraft's discretion, products which prove to be defective during the warranty period. Purchasers may be required to establish that a claim is within the warranty period. To initiate a warranty claim, the purchaser should contact an authorized NuCraft dealer.

This warranty does not cover: 1) Damage caused by a carrier 2) COM (Customer's Own Material) specified by the customer that is not a standard product offering 3) Color, grain or texture of wood and other covering materials (due to the natural variations over which NuCraft has no control) 4) Damages resulting from user modification, attachments to a product, misuse, abuse, alteration or negligent use.

NuCraft extends no other warranties, expressed or implied, including warranty of merchantability or fitness for a particular purpose. NuCraft shall not be liable for loss of time, inconvenience, commercial loss, incidental or consequential damages.

Environmental Statement

NuCraft is committed to supporting responsible environmental policies and practices in all that we do. We strive for sustainability, weighing our business decisions against the costs to the ecological, social and economic systems they affect.

Our products are manufactured to meet the credit requirements of the U.S. Green Building Council's LEED rating systems in one or more of the following categories:

- Recycled Content
- Certified Wood
- Low-Emitting Materials

Computer Aided Planning

NuCraft products and pricing are available on CD via 2020 Cap, an AutoCAD®-based space planning tool.

2020 Cap is an integrated software system developed specifically for interior designers and facility planners to enhance workplace performance. This modern suite of applications works together seamlessly, in concert. Navigate catalogs, select products, design in plan view and 3D, assign options, create worksheets and build a project where you want, when you want. Take your pick. It's dynamic and interactive. Design projects are a work in progress. And now you can perform any of the many discrete tasks that go into a project any time, any place.

For additional information, you may contact 2020 Cap direct at 800-227-0038.

iSpec®

NuCraft offers a free online product configuration and specification service that saves you time and allows you to be creative while leaving the nuts and bolts to someone else. No specific software is required, nor is there any learning curve. This service applies to all NuCraft products. For additional information, call 1-877-NUCRAFT and ask for the iSpec Team or log on to www.nucraft.com/ispec.



Finish Information

Surface Materials Palette

We crafted our materials palette using the same demanding standards that distinguish our furniture. Thoughtful design and attention to every detail elevate your possibilities.

Anchored by NuCraft veneers, unrivaled for clarity, quality, and depth of finish, our collection of surface materials comprises a sophisticated set of balanced elements that supports your design vision.

Some elements have their roots in NuCraft's rich heritage. Others are new materials and reflect current trends and taste. Together, they ensure that you're ready for today and positioned well for the future. Beautifully.

Custom Finishes

NuCraft specializes in expert custom finish matching. For a nominal upcharge we can provide custom finishes, and we are frequently asked to match the finishes of other furniture manufacturers. For orders over \$5000 list, a finish sample will automatically be sent for approval prior to entering the order. Additionally, for finishes that appear unusual to match or for customers directly requesting a sample, a finish sample will also be sent for approval prior to entering the order.

Custom finishes requiring colored varnishes to create a painted look can only be applied to Maple veneer and require one extra week in addition to the standard leadtime. NuCraft's standard black finish (G82) can be applied to all NuCraft standard veneers. Walnut is the standard black veneer. Other species must be specified when ordering.

Custom finishes carry a 10% upcharge per item, per finish.

Do not add the finish upcharge to any item that is not wood. Example: casters, ganging connectors.

Treatments

Note: Default veneer sheen will vary per finish and were determined by a team of experts who reviewed the colorways to determine if gloss or matte best highlighted the natural characteristics of the species of wood and the color of the stain. Default finish is bolded on pages 5-6. If no direction is provided on incoming orders, default sheen will be selected.

Gloss: Gloss is a durable finish that tends to nicely mask normal wear and leaves wood grain visible to the eye. It achieves a medium gloss open pore appearance (40 – 50 sheen range). Finish numbers preceded by the letter "G" indicate a Gloss finish.

Matte: Like Gloss, Matte is durable, tends to nicely mask normal wear and leaves wood grain visible to the eye. It achieves a low luster, open pore appearance (10 – 20 sheen range). Finish numbers preceded by the letter "M" indicate a Matte finish.

Since each veneer type responds differently to both types of treatment, all will have a distinctive look and feel when finished. For example, a Walnut veneer with a Gloss treatment will remain much more textured than a Cherry veneer with the same treatment.

About the Wood

All NuCraft veneers are carefully selected for uniformity of color and grain. Still, wood is a natural substance and minor variations may occur due to its own uniqueness. Because of this, the furniture you receive may not be an exact match to our samples.

NuCraft takes great pride in our finish color consistency. However, wood is a natural product that will have color variation within a single piece of furniture, as well as from one piece to the next. Other factors also affect color over time, such as exposure to light (both intensity and duration). For example, lighter finishes cause more variation in colors over time.

In cases where a returning customer wants a precise match with existing furniture, we recommend sending a sample of the existing furniture finish. Please contact NuCraft Customer Service to determine an appropriate sample. This will ensure a finish match between old and new orders. This type of order is considered a control sample. There will be a 10% upcharge on an order of this type. Due to natural aging of veneers, natural finishes may vary.

Care and Maintenance of Wood Finishes

Our finish material is a crystal clear, urethane acrylic blend. This type of finish may be repaired in the field by a qualified refinisher.

NuCraft recommends using a damp cloth to clean your fine wood furniture. Always wipe with the grain of the wood. Should your wood furniture require a more thorough cleaning, we recommend using a mild cleaner such as Joy dish soap or Murphy's oil soap, thoroughly diluted in water (one part soap to thirty parts water). Water will not damage NuCraft's finish, but will leave surface spots when it dries. To avoid this, dry the surface with a soft cloth after it is cleaned. Marks that cannot be removed with the cleaning methods above may be able to be removed using naphtha, a mild degreasing solvent.

Caution: while the use of polishes that contain wax, petroleum solvents or silicones may immediately enhance the "shine" of a product, it may also eventually remove the fine original finish applied in our factory. Silicone on the surface of wood may also make it very difficult to respray or refinish.

All NuCraft furniture is inspected and polished before it leaves our factory. In some instances, the packing materials may imprint on the factory polish. Cleaning and polishing the furniture once it is unpacked will normally restore the furniture to its original beauty.

In some cases, the rubber support feet used on the bottom of common office equipment (teleconferencing phones, laptops, microphones, copiers, etc.) can create unsightly marks in the surface of wood tops, due to oxidation of the lacquer finish. We suggest these machines be placed on a protective type of padding, such as felt.

Wood will fade as a result of exposure to UV light. This is particularly prevalent with light finishes. If color changes due to fading are a concern for your application, the impact can be minimized by selecting medium to dark stains for your wood surfaces. Our top coat includes a UV inhibitor which makes the finishes less prone to fading.



Finish Information

Laminates

Selected Formica® and Nevamar® laminates are available on Training Tables, Conference Tables, Conference Room Furniture and select Occasional Tables. For standard laminate and wood pricing, refer to individual item pricing columns.

Non-Standard Laminates

To order a color other than those on our list (see pages 5-6), refer to Nevamar or Formica standard grade, matte texture laminate offerings (excluding manufacturers' non-standard matte offering). **Add \$103 list per item for a non-standard solid, matrix or pattern.** Add 20% per color for woodgrain laminates (includes stained-to-match for remainder of unit to match laminate color). Add one week to the lead-time for all non-standard laminate orders. Call the NuCraft Customer Service team for quotes on premium grades and laminates. Mirror and metal laminates are not available.

Care and Maintenance of Laminate and Novawrap

Laminate and Novawrap surfaces may be cleaned with a damp cloth and ordinary soap or non-abrasive household liquid detergent. Dry the surface with a clean cloth or soft paper towel to prevent streaks from appearing.

Care and Maintenance of Metal

Metal surfaces can be wiped with a damp cloth and rubbed dry. A mild non-abrasive household liquid detergent can be used if necessary. Regular maintenance of metal components, including tightening of fasteners and light lubrication of moving parts, will extend the life of your furniture.

Satin Etched Glass

Glass color may vary slightly on multi-piece conference table tops over 180" x 60" when satin etched glass is specified due to the iron content and etching process of the glass.

Care and Maintenance of Glass

Clear or frosted glass may be cleaned with commercial glass cleaner. Be sure to use a lint-free cloth if cleaning the frosted side of the glass.

Stone and Solid Surface Material

Despite its reputation for durability, natural stone can easily be broken during handling and/or installation if proper techniques are not followed. In addition, NuCraft is not responsible for the installation of natural stone or solid surface materials on its products. Therefore, installers specifically trained in the installation of these materials must be utilized to ensure a quality installation. NuCraft shall not be liable for any damages incurred during the handling and/or installation of natural stone or solid surface materials on its products.

Care and Maintenance of Granite

Granite surfaces may be cleaned with a damp cloth and ordinary soap or non-abrasive household liquid detergent. Dry the surface with a clean cloth or soft paper towel to prevent streaks from appearing.

Care and Maintenance of Leather

Genuine leather requires very little care. NuCraft recommends that leather be dusted regularly. If a more thorough cleaning is needed, use lukewarm water and a mild, non-abrasive soap. Generate some lather and lightly rub the surface with cheesecloth. Rinse off any soap film with clean water and towel dry. The leather may dry dull. To restore the leather to a normal gloss, rub it with a clean towel. Never use furniture polish, oil, varnish or ammonia. Saddle soap may be used to prevent the leather from becoming brittle or cracked and to maintain the original supple finish.

Touch Up Finish Kits

Model #	Description	Price
KIT-M	Metal Kit	80
KIT-P	Paint Kit	80
KIT-S	Stain Kit	80

REQUIRED INFORMATION:

(ORDER CANNOT BE ENTERED WITHOUT THIS INFORMATION)

- Kit model number
- Quantity of kits
- Specify finish (See pages 5-6)

General Information:

- Touch-up kits must be ordered on a purchase order separate from NuCraft product due to Hazmat shipping



WOOD FINISHES

STANDARD

Default veneer sheen will vary per finish and were determined by a team of experts who reviewed the colorways to determine if gloss or matte best highlighted the natural characteristics of the species of wood and the color of the stain. Default finish is bolded. If no direction is provided, default sheen will be selected.

	Matte	Gloss
Ash		
Chalk	M48	G48
Angora	M49	G49
Blanco	M44	G44
Oat	M45	G45
Rift Cut Oak		
Nougat	M01	G01
Wheat	M02	G02
Carbon	M03	G03
Bramble	M07	G07
Cherry		
Sherry	M20	G20
Cognac	M21	G21
Spring	M95	G95
Auburn	M93	G93
Walnut		
Marron	M35	G35
Mocha	M33	G33
Zinc	M30	G30
Onyx	M82	G82
Otter	M31	G31
Walnut	M26	G26
Linea		
Oak Linea	M08	G08
Walnut Linea	M27	G27
Paldao		
Thicket	M75	G75
Paldao	M76	G76

HERITAGE COLLECTION

Heritage Collection consists of popular mainstays of the NuCraft veneer collection preserved from our previous offering.

	Matte	Gloss
Natural Maple	M60	G60
Natural Walnut	M25	G25
Castano Walnut	M37	G37
Cordovan Cherry	M99	G99
CoCo Cherry	M96	G96

PREMIUM

(Please refer to specific product lines for application restrictions)

Quartered Figured Anigre

Roux	M11	G11
Truffle	M12	G12
Velvet	M18	G18

Black Limba

Morel	M73	G73
Sable	M71	G71

STONE TOPS

Available only on select Occasional Tables and Flow. Stone orders may affect lead times. Please contact NuCraft Customer Service for details.

Stone

Absolute Black Honed Granite	ST01
Carrara Marble	ST16

Quartz | Caesarstone

Pure White	ST04
Blizzard	ST07
Haze	ST15
Concrete	ST08
Raven	ST06

Quartz | Lumbermen's

Wilsonart Haida	ST14
-----------------	------

SOLID SURFACE

Wilsonart Designer White	ST11
--------------------------	------



Performance Credenza™ Surface Materials

METAL FINISHES

Aged Bronze	A8010
Black	A44
Burnished	A8009
Cloud	A8004
Foil	A8006
Galaxy	A8007
Satin Bronze	A8011
Shadow	A8005
Storm	A8012

PAINTS

Aged Bronze	S8010
Black	S44
Burnished	S88
Cloud	S8004
Foil	S8006
Galaxy	S8007
Moonlight	S87
Satin Bronze	S8011
Shadow	S8005
Storm	S8012

Paint to Match

To request a custom paint color, contact NuCraft Customer Service. A paint sample must be matched and approved prior to order.

GLASS (SATIN OR GLOSS)

	Satin	Gloss
Black	BS	-
Clove	VS	VG
Meringue	MS	MG
Quill	QS	QG
White	WS	WG

LAMINATES

	Code	Coordinating Wood Finish	Suggested ABS Edgeband Coordinate
Wood Grain Laminates			
Formica White Ash	8841-58	M8841	R02, R01
Formica Natural Ash	8843-58	M8843	R02
Formica Aged Ash	8844-58	M8844	R04
Formica Weathered Ash	8842-58	M8842	R05
Formica Oiled Legno	8846-58	M8846	R05
Formica Bleached Legno	8845-58	M8845	R04
Formica Jarrah Legno	8847-58	M8847	R05
Formica Blackened Legno	8848-58	M8848	R05
Formica Pecan Woodline	5883-58	M5883	R04
Formica Chestnut Woodline	5884-58	M5884	R05
Formica Urban Planked Oak	9312-58	M9312	R04
Formica Natural Walnut	6401-58	M6401	R04
Formica Thermo Walnut	6402-58	M6402	R04
Formica Smoky Brown Pear	5488-58	M5488	R05
Formica Espresso Pear	5489-58	M5489	R05
Formica Smoky Walnut Woodline	6926-58	M6926	R05

Solid Laminates

Formica Brite White	459-58	R01
Formica Dover White	7197-58	R01
Formica Pearl	934-58	R02
Formica Graystone	464-58	R02
Formica Folkstone	927-58	R03
Formica Graphite	837-58	R05

Patterned Laminates

Nevamar Cool Chic	VA7002T	R02
Nevamar Serene Stardom	VA5001T	R05
Nevamar Calm Distinction	VA6001T	R05
Nevamar Easy Elegance	VA5002T	R05
Wilsonart Sheer Mesh	4876-38	R02
Wilsonart Grey Mesh	4877-38	R02
Wilsonart Pewter Mesh	4878-38	R05

ABS FINISHES

Ashen	R04
Parchment	R02
Shale	R05
Stone	R03
Whitecap	R01



Performance Credenza™

Overview

CONSOLES

Page 14-15

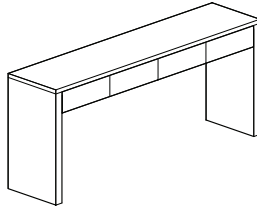
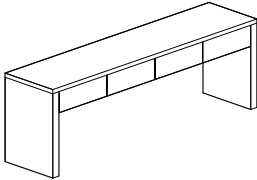

UTILITY CREDENZAS

Page 16-23

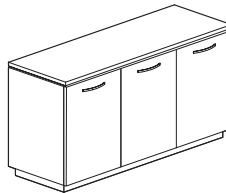
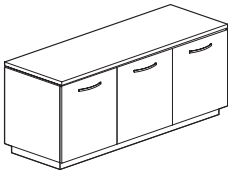

FOOD SERVICE CREDENZAS

Pages 24-27

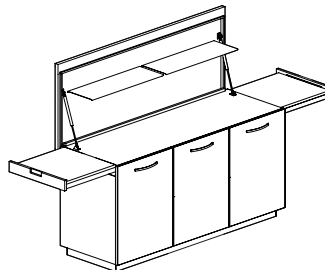
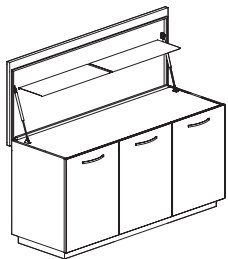



Performance Credenza™ Planning

Section Contents

Specification Overview

Detail Overview

Dimensions

Edge Profiles

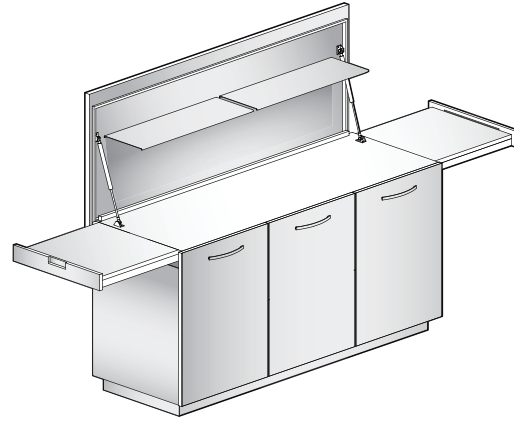
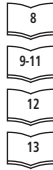

Specification Overview

Consoles

1. Select the Size

When specifying a console, you'll first select between conference and buffet heights. Then select the appropriate width; three, four and five drawer consoles are available.

2. Select the Options

Choose the desired edge profile. Consoles are available in two edge profiles, which are along the front edge only. Consoles are standard with a natural finger pull on the bottom of the drawer fronts. Select the optional applied pull if the aesthetic of a pull is desired.

3. Select the Surface Materials

Choose between veneer or laminate for tops, and veneer or painted cases; all standard veneers, laminates and ABS edge options are available. If pulls have been optioned, select metal finish. Laminate choice must also be selected, if specified.

Utility Credenzas

1. Select the Size

When specifying a Utility Credenza, you'll first select between conference and buffet heights. Then select the appropriate width; two, three, four and five door credenzas are available.

2. Select the Components

Credenzas come with adjustable shelves as standard. Additional components are available, if desired. Choose from sliding or fixed equipment racks, set of three drawers, or front or end opening trash/recycling unit. A thermostatically controlled fan can be added to the back panel to remove heat generated by enclosed equipment.

3. Select the Options

Choose the desired edge profile. Credenzas are available in two edge profiles, which are along the front edge only. Painted plinth base or painted reveal, along with a painted case option are also available as a design detail. Integrated pulls, metal pulls or locks can also be specified if desired.

4. Select the Surface Materials

Choose between veneer, stone, glass, solid surface or laminate tops. Cases can be either veneer or painted: all standard veneers, paint color and laminate options are available. Select a metal finish for pulls or the painted plinth base or reveal, if specified. Laminate choice must also be selected, if specified.

Food Service Credenzas

1. Select the Style

Food Service Credenzas are standard with three doors in buffet height. Styles are available with double sided or no pull-out worksurfaces.

2. Select the Components

Build-Your-Own Credenzas come with adjustable shelves as standard. Additional components are available, if desired. Choose from a set of three drawers, open module to slide in a refrigeration unit (center position only), or front or end opening trash/recycling unit. Grain matched door fronts for refrigeration units are also available. Refrigerators are not included with Food Service Credenzas.

3. Select the Options

Choose the desired edge profile. Credenzas are available in two edge profiles, which are along the front edge only. Locks can also be selected, if desired. Painted plinth base or painted reveal, along with a painted case option, are also available as a design detail. Integrated or metal pulls can be specified, if desired.

4. Select the Surface Materials

Choose between veneer or laminate for the top surface, and veneer or painted options for the case. All standard veneers, laminate and paint options are available. Select a metal finish for pulls, the painted plinth base or reveal. Laminate and ABS choice must also be selected, if specified.



Performance Credenza™ Planning

Detail Overview – Utility Credenzas

Edge Profile

Veneer Tops are 1-1/4" thick with 3/8" deep wood edge band. The edge band is veneered over for a clean appearance. Credenzas are available in four edge profiles, which are along the front edge of the top. Laminate tops with ABS edge are 1-1/4" thick and 2mm ABS square edge.

Reveal and Plinth Base

Credenzas are designed with a reveal and plinth base that are recessed on all four sides. Standard in veneer, both are available painted to offer aesthetic flexibility.

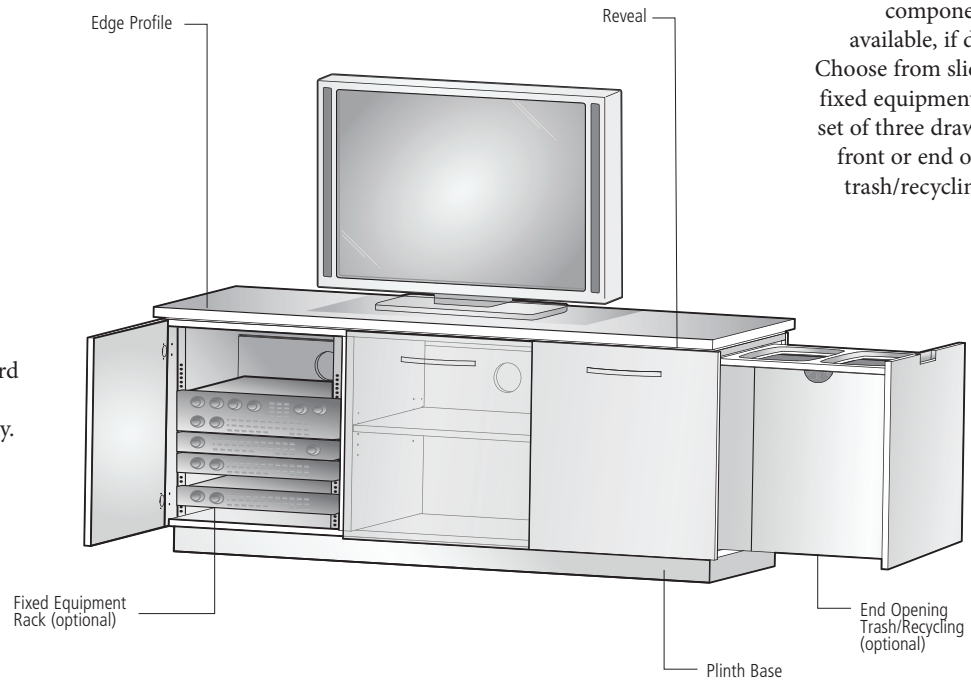

Components

Credenzas come with adjustable shelves as standard. Additional components are available, if desired. Choose from sliding or fixed equipment racks, set of three drawers, or front or end opening trash/recycling unit.

Ventilation

Utility Credenzas are standard with a cut-back bottom panel and round cutouts in each opening to create a convection current needed for passive ventilation.

To control ventilation, a thermostatic fan can be added to the round cutout. The fan is included when the sliding or fixed rack is specified, or can be ordered separately. The fan activates automatically at 87° F and turns off when the ambient temperature in the cabinet reaches 85° F.

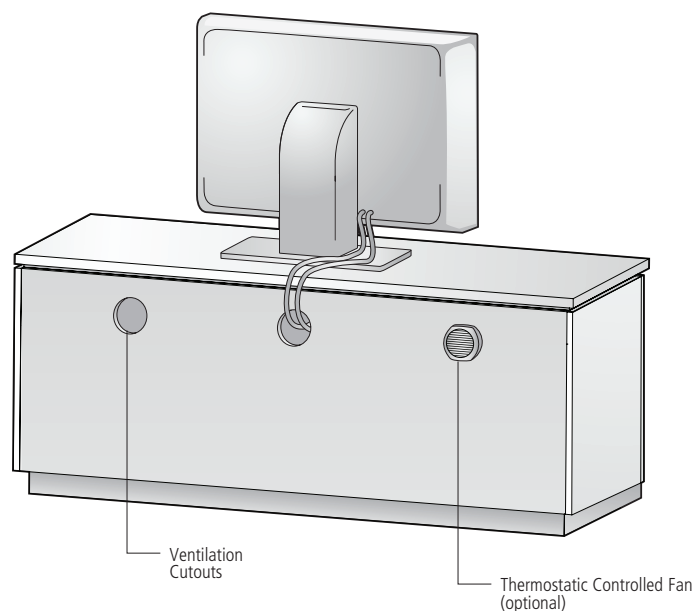

Cable Management

Cables can be routed into the case through the round cutout in the back panel or through the cut-back bottom panel. Cables can pass between modules via a mouse hole in the upper back corner of the side panels.

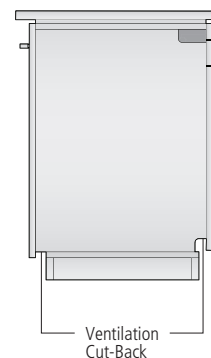



Performance Credenza™ Planning

Detail Overview – Utility Credenzas

120"-long Utility Credenza

The longest Utility Credenza is 120" and consists of two cases (one 72"-long and one 48"-long) joined together with a one-piece top. 120" stone and quartz top options include a two-piece top with seam located at center. In this particular unit, the 24" Open Module option for a refrigerator is limited to the second opening from the left.

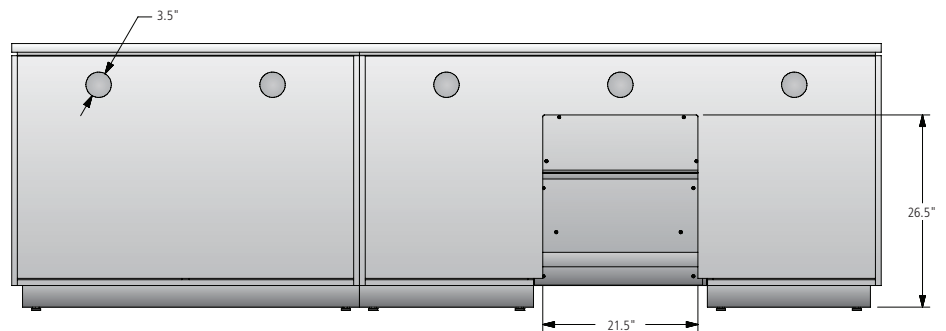
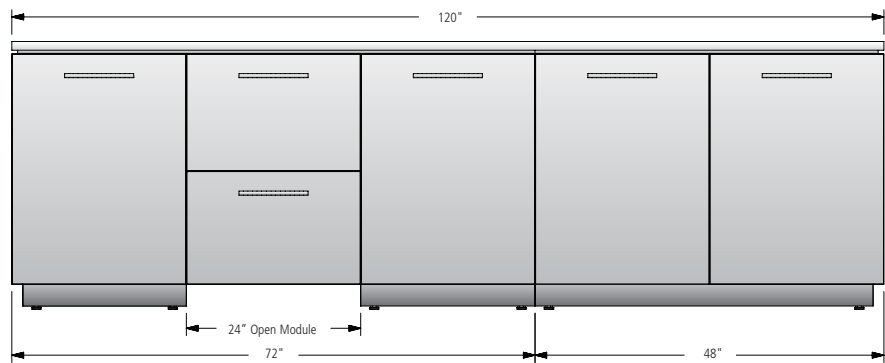
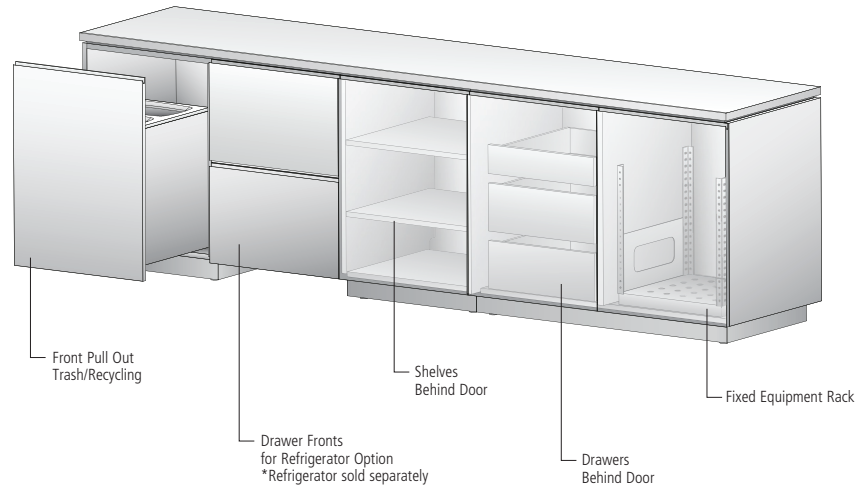

Note: All images above show the 24" Open Module option for a refrigerator unit with the optional drawer fronts. If these options are not selected, this section of the case includes the plinth base.



Performance Credenza™ Planning

Detail Overview – Food Service Credenzas

Flip-Up Top

The flip-up top pivots to reveal a durable laminate surface. The cylinder and spring mechanism creates assisted open and closed motion.

Flip-Up Shelves

The Flip-up shelves, standard, provide a heavy duty auxiliary surface. When not in use, they fold flat against the underside of the top.

Pull-Out Worksurfaces

Pull-Out Worksurfaces provide additional serving surface on the same plane as the main surface. Available on the left end, right end or both ends, they pull out when needed and store away into the case when not in use.

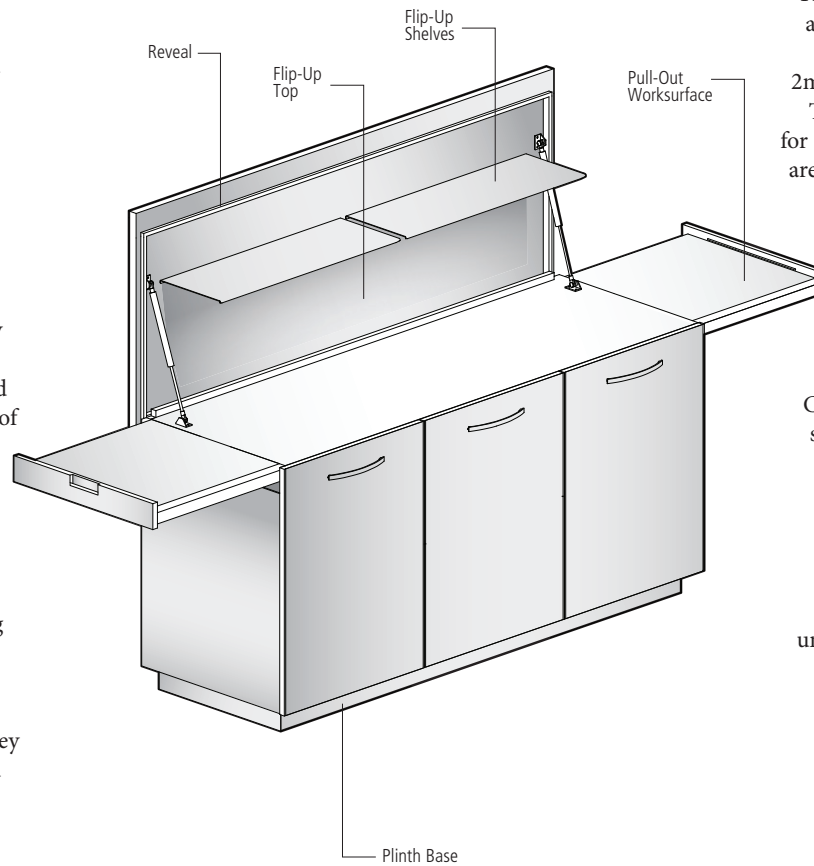

Edge Profile

Tops are 1-1/4"-thick with either a 7/8"-deep wood edge band on veneer and laminate tops, or a 2mm ABS edge on laminate tops. The edge band is veneered over for a clean appearance. Credenzas are available in four edge profiles, which are applied to the front edge of the top.

Components

Build-Your-Own Credenzas come with adjustable shelves as standard. Additional components are available, if desired. Choose from a set of three drawers, open module to slide in a refrigeration unit (center position only), or front or end opening trash/recycling unit. Grain matched door fronts for refrigeration units are also available. Refrigerators are not included with Food Service Credenzas.

Reveal and Plinth Base

Credenzas are designed with a reveal and plinth base that are recessed on all four sides. Standard in veneer, the reveal and plinth base are available painted to offer aesthetic flexibility.

Components:

Drawers

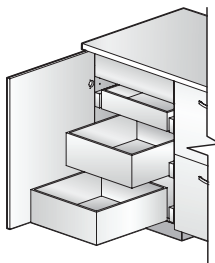

- (3) white drawers behind one door

Trash/Recycling

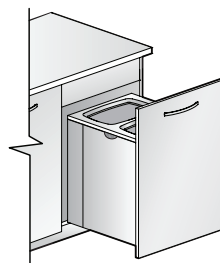

- (2) 41 qt. containers provided
- White painted surround provides clean aesthetic
- Front opening and end opening available

Open Module

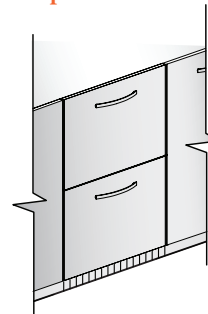

- Available in center position only
- Reference www.nucraft.com for recommended refrigerator suppliers
- Grain-matched drawer fronts are available for recommended models (as shown above)



Performance Credenza™ Planning

Dimensions:

Food Service Credenza

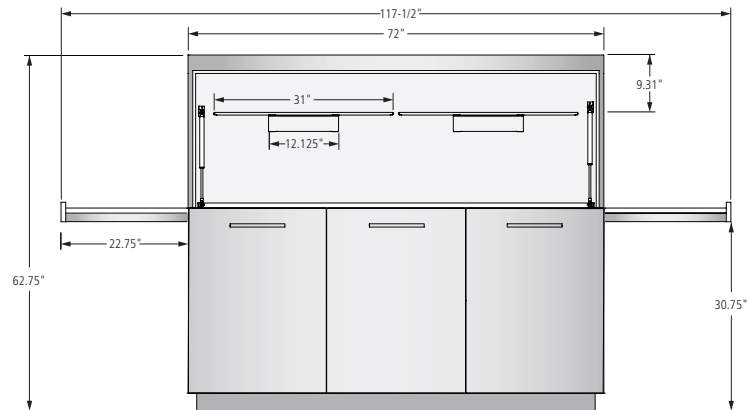

Side View – Open

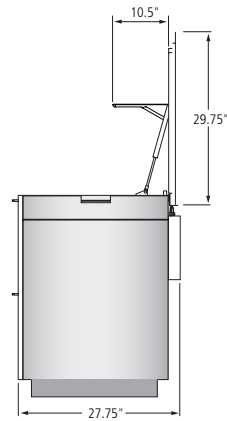

Side View – Closed

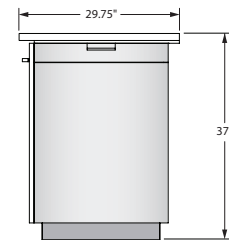

Component Dimensions:

Drawers

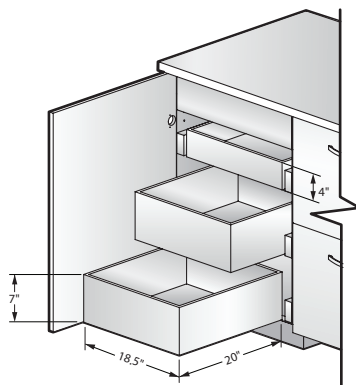

Trash/Recycling - Front Open

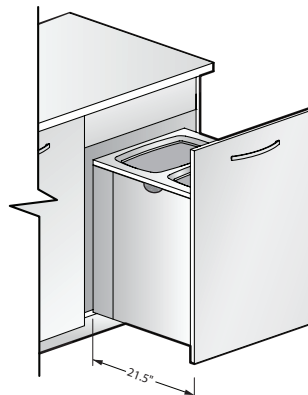

Trash/Recycling - End Open

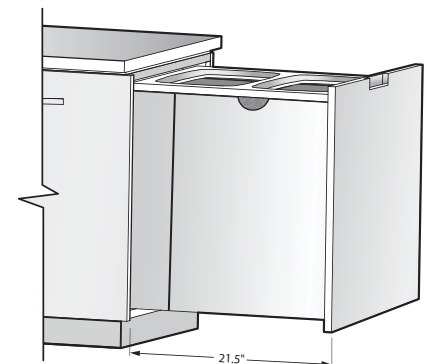



Performance Credenza™ Planning

Edge Profiles

(all shown with the integrated pull option)

Veneer with Square (SQ) Edge

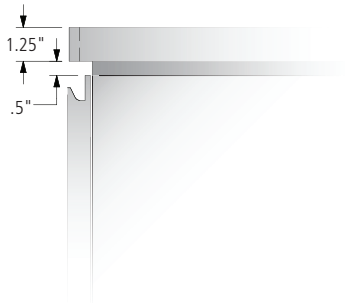

Veneer with Radius Knife (RK) Edge

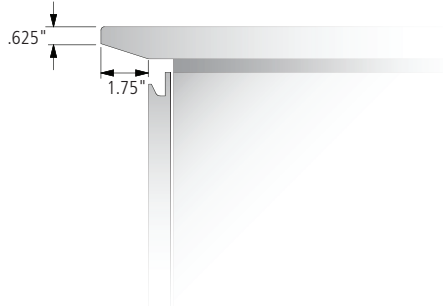

Laminate with Square ABS Edge

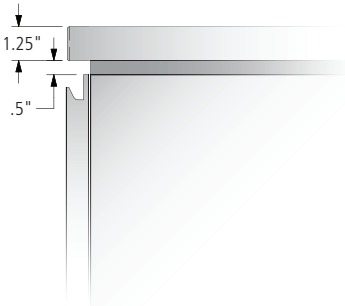

Laminate with Square Hardwood Edge

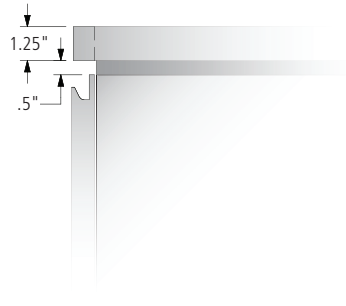

Inset Laminate with Radius Knife (RK) Hardwood Edge

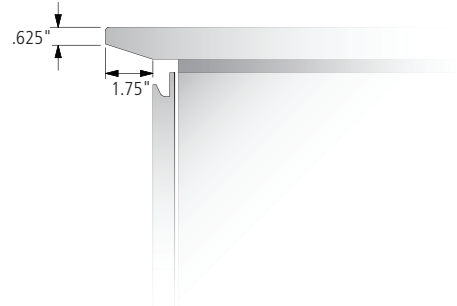

Glass

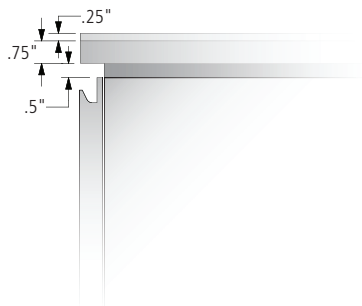

Stone/Quartz

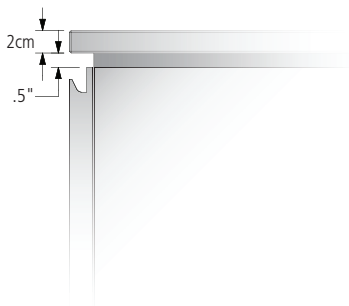

Solid Surface

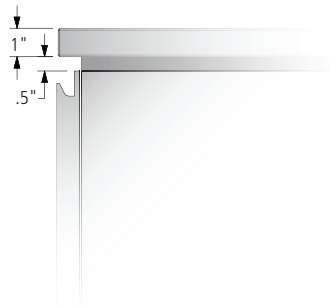



Performance Credenza™ Consoles

Veneer Top with Hardwood Edge

Price

Veneer Premium
Veneer Veneer

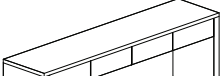
Console	Model #	W x D x H	Description	-V	-PV
Conference Height					
	PC-C-5929	58 7/8 x 18 x 29	Three Drawers	3584	3942
	PC-C-7729	76 1/2 x 18 x 29	Four Drawers	4466	4913
	PC-C-9529	94 1/2 x 18 x 29	Five Drawers	5345	5878

PC-C-7729

Buffet Height

PC-C-5937	58 7/8 x 18 x 37	Three Drawers	4123	4533
PC-C-7737	76 1/2 x 18 x 37	Four Drawers	5133	5643
PC-C-9537	94 5/8 x 18 x 37	Five Drawers	6146	6761

Options:

Pulls:

Add **-PL** \$172 for 59", \$227 for 77" and \$282 for 95"

REQUIRED INFORMATION: (ORDER CANNOT BE ENTERED WITHOUT THIS INFORMATION)

See pages 5-6 for surface material options.

- Choose Wood Species & Finish
- Choose Metal Finish, if **-PL** is selected
- Choose Edge Profile (front edge top only):



RK - Radius Knife



SQ - Square

General Information:

- Tops are 1 1/4" thick with 3/8" deep wood edge band, veneered over
- Panel legs are 2 1/4" thick
- Drawer fronts are standard with natural finger pull. If aesthetic of pulls is desired, select **-PL** for pull option.
- Consoles ship fully assembled



5" Pull (Optional)



Performance Credenza™ Consoles

Laminate Top

Laminate Top

Console	Model #	W x D x H	Description	Price	
				Laminate with ABS Edge & Painted Case -PE	Inset Laminate with Wood Edge & Veneer Case -P
	Conference Height				
	PC-C-5929	58 7/8 x 18 x 29	Three Drawers	2869	3387
	PC-C-7729	76 1/2 x 18 x 29	Four Drawers	3573	4220
	PC-C-9529	94 1/2 x 18 x 29	Five Drawers	4275	5050

PC-C-7729

Buffet Height

PC-C-5937	58 7/8 x 18 x 37	Three Drawers	3353	3895
PC-C-7737	76 1/2 x 18 x 37	Four Drawers	4172	4850
PC-C-9537	94 5/8 x 18 x 37	Five Drawers	4997	5808

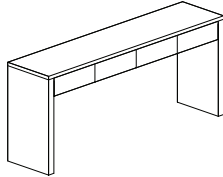

PC-C-7737

Options:

Pulls:

Add **-PL** \$172 for 59", \$227 for 77" and \$282 for 95"

REQUIRED INFORMATION: (ORDER CANNOT BE ENTERED WITHOUT THIS INFORMATION)

See pages 5-6 for surface material options.

- Choose Wood Species & Finish, if **-P** is specified
- Choose Laminate Finish
- Choose Metal Finish, if **-PL** is specified
- Choose ABS Edge Finish if **-PE** is specified
- Choose Paint Finish if **-PE** is specified
- Choose Edge Profile (front edge top only) if **-P** is specified:



RK - Radius Knife



SQ - Square



5" Pull (Optional)

General Information:

- Tops are 1-1/4" thick
- Inset laminate tops have a 3/8"-deep wood edge band
- Laminate with ABS edge tops have a 2mm-thick ABS square edge
- Panel legs are 2 1/4" thick
- Drawer fronts are standard with natural finger pull. If aesthetic of pulls is desired, select **-PL** for pull option.
- Laminate with ABS Edge (-PE) only available with painted case option



Performance Credenza™ Utility Credenzas

Veneer Top with Hardwood Edge

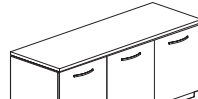
Veneer Top with Hardwood Edge							Price		
	Utility Credenzas	Model #	W x D x H	Description	Internal Width	Internal Depth	Internal Height	Veneer -V	Premium Veneer -PV
	Conference Height								
		PC-U-4829	48 x 24-3/4 x 30-1/4	Two Doors	(2) 22-3/4	23-1/8	23-7/16	5962	6560
		PC-U-7229	72 x 24-3/4 x 30-1/4	Three Doors	(3) 22-3/4	23-1/8	23-7/16	7335	8068
		PC-U-9629	96 x 24-3/4 x 30-1/4	Four Doors	(4) 22-3/4	23-1/8	23-7/16	8709	9580
		PC-U-12029	120 x 24-3/4 x 30-1/4	Five Doors	(5) 22-3/4	23-1/8	23-7/16	9972	10969

PC-U-7229

Buffet Height

	PC-U-4837	48 x 24-3/4 x 37	Two Doors	(2) 22-3/4	23-1/8	30-1/8	6855	7541
	PC-U-7237	72 x 24-3/4 x 37	Three Doors	(3) 22-3/4	23-1/8	30-1/8	8436	9279
	PC-U-9637	96 x 24-3/4 x 37	Four Doors	(4) 22-3/4	23-1/8	30-1/8	10014	11017
	PC-U-12037	120 x 24-3/4 x 37	Five Doors	(5) 22-3/4	23-1/8	30-1/8	11468	12614

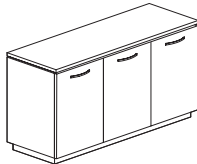

PC-U-7237

Options:

Locks:	Add -L	\$165
Integrated Pull:	Add -IP	\$301 for 48" Credenzas, \$369 for 72" Credenzas, \$415 for 96" Credenzas, \$500 for 120" Credenzas
Painted Plinth Base:	Add -PBP	No charge
Painted Reveal:	Add -RP	No charge



Integrated Pull (Optional)

REQUIRED INFORMATION: (ORDER CANNOT BE ENTERED WITHOUT THIS INFORMATION)

See pages 5-6 for surface material options.

- Choose Wood Species & Finish
- Choose Metal Finish for Pulls unless -IP is specified
- Choose Paint Finish, if -RP or -PBP options are specified
- Choose Components, if applicable (see next page, credenzas come with adjustable shelves as standard)
- Choose Edge Profile (front edge top only):



RK - Radius Knife



SQ - Square

General Information:

- Tops are 1 1/4" thick with 3/8" deep wood edge band, veneered over
- Radius Knife (RK) edge profile adds 1-7/8" to overall depth
- Conference Height Credenzas ship with one adjustable shelf behind each door and metal pulls, unless other components are specified
- Buffet Height Credenzas ship with two adjustable shelves behind each door and metal pulls, unless other components are specified
- Back panel has ventilation cutout for each position. Cutout can accept optional fan if additional airflow is needed.
- Metal finish defaults to pull finish when painted plinth base or reveal is selected. If alternate finish is desired, note on order.
- Locks, if selected, are centered above pull and will default to Foil finish if metal color is not specified. Trash/recycling units are non-locking.
- 48"-96" credenzas ship in one piece; 120" credenzas will ship with two pieces for the case and one piece for the top



Performance Credenza™ Utility Credenzas

Veneer Top with Hardwood Edge

Components	Model #	Description	Price
Front Opening Components			
	TF-[]	Pull-out trash/recycling unit - (2) 41 qt. containers	891
	R1-[]	Sliding equipment rack - 12RU with thermostatically controlled fan and plugstrip	2443
	R2-[]	Fixed equipment rack - 12RU with thermostatically controlled fan and plugstrip	667
	D3-[]	Three drawers (behind one door)	2098
	OM-[]	Open Module to accept refrigerator (Refrigerator not included. Only Available in Center Position)	0
End Opening Component (only available in 1st and last positions)			
	TE-[]	Pull-out trash/recycling unit - (2) 41 qt. containers	891
Accessories			
	FAN	Thermostatically controlled fan	422
	FAN-UK	Thermostatically controlled fan for UK power	460
	DF-GE	Drawer Fronts for GE Monogram refrigerated drawer unit	353

REQUIRED INFORMATION: (ORDER CANNOT BE ENTERED WITHOUT THIS INFORMATION)

[] Specify location for each component, one per location. Location comes standard with adjustable shelves if no component is specified.



2-Door Credenza

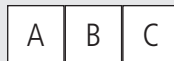

3-Door Credenza

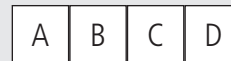

4-Door Credenza



5-Door Credenza

General Information:

- Door on trash/recycling unit pulls out with bin
- Trash/recycling units have a 41 qt. capacity
- Maximum of 1 trash/recycling unit for a 2-Door Credenza, 2 trash/recycling units for both 3-Door and 4-Door Credenzas, and 3 trash/recycling units for a 5-Door Credenza
- Drawers and trash bin surround are painted Cloud
- Labels are included with pull-out trash/recycling unit
- Thermostatically controlled fan activates automatically at 87° F and turns off at 85° F
- Trash/recycling units are non-locking
- OM-[] only available in Position B on 3-Door, 4-Door and 5-Door Buffet Height Credenzas, 33-7/8" H x 24"W x 24-3/4"D, adds 1" to the overall depth of the Credenza
- Open module is intended for refrigeration unit (refrigerator not included)
- 48" - 96" Credenzas ship fully assembled; 120" credenzas will ship in 3 pieces, a 72" credenza, 48" credenza and a 120" long common top.
- 120"-L credenzas consists of a 72" and 48" credenza side by side with a common top. The 72" credenza will always be on the left side and the 48" credenza will always be on the right side.



Performance Credenza™ Utility Credenzas

Laminate Top

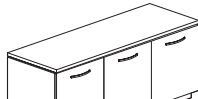
Laminate Top							Price		
	Utility Credenzas	Model #	W x D x H	Description	Internal Width	Internal Depth	Internal Height	Laminate with ABS Edge & Painted Case	Inset Laminate with Wood Edge & Veneer Case
		Conference Height							
		PC-U-4829	48 x 24-3/4 x 30-1/4	Two Doors	(2) 22-3/4	23-1/8	23-7/16	4772	5635
		PC-U-7229	72 x 24-3/4 x 30-1/4	Three Doors	(3) 22-3/4	23-1/8	23-7/16	5868	6932
		PC-U-9629	96 x 24-3/4 x 30-1/4	Four Doors	(4) 22-3/4	23-1/8	23-7/16	6969	8230
		PC-U-12029	120 x 24-3/4 x 30-1/4	Five Doors	(5) 22-3/4	23-1/8	23-7/16	7979	9425

PC-U-7229

Buffet Height

PC-U-4837	48 x 24-3/4 x 37	Two Doors	(2) 22-3/4	23-1/8	30-1/8	5574	6476
PC-U-7237	72 x 24-3/4 x 37	Three Doors	(3) 22-3/4	23-1/8	30-1/8	6860	7972
PC-U-9637	96 x 24-3/4 x 37	Four Doors	(4) 22-3/4	23-1/8	30-1/8	8143	9463
PC-U-12037	120 x 24-3/4 x 37	Five Doors	(5) 22-3/4	23-1/8	30-1/8	9324	10838

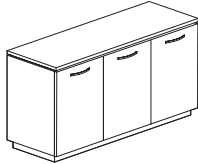

PC-U-7237

Options:

Locks:

Add **-L** \$165

Integrated Pull:

Add **-IP** \$301 for 48" Credenzas, \$369 for 72" Credenzas, \$415 for 96" Credenzas, \$500 for 120" Credenzas

Painted Plinth Base:

Add **-PBP** No charge

Painted Reveal:

Add **-RP** No charge



REQUIRED INFORMATION: (ORDER CANNOT BE ENTERED WITHOUT THIS INFORMATION)

See pages 5-6 for surface material options.

- Choose Wood Species & Finish if **-P** is specified
- Choose Laminate Finish
- Choose ABS Edge Finish, if **-PE** is specified
- Choose Metal Finish for Pulls unless **-IP** is specified
- Choose Paint Finish, if **-RP**, **-PE** or **-PBP** options are specified
- Choose Components, if applicable (see next page, credenzas come with adjustable shelves as standard)
- Choose Edge Profile (front edge top only), if **-P** is specified



RK - Radius Knife



SQ - Square

General Information:

- Tops are 1 1/4" thick with 3/8" deep wood edge band
- Radius Knife (RK) edge profile adds 1-7/8" to overall depth
- Conference Height Credenzas ship with one adjustable shelf behind each door and metal pulls, unless other components are specified
- Buffet Height Credenzas ship with two adjustable shelves behind each door and metal pulls, unless other components are specified
- Back panel has ventilation cutout for each position. Cutout can accept optional fan if additional airflow is needed.
- Metal finish defaults to pull finish when painted plinth base or reveal is selected. If alternate finish is desired, note on order.
- Locks, if selected, are centered above pull and will default to Foil finish if metal color is not specified. Trash/recycling units are non-locking.
- Laminate with ABS Edge (-PE) only available with painted case option
- Inset Laminate with Hardwood Edge (-P) only available with veneer case option
- Unless specified otherwise, the color of the painted plinth and painted reveal will default to the color of the painted case on credenzas with laminate tops with ABS edge and painted case.
- 48"-96" credenzas ship in one piece; 120" credenzas will ship with two pieces for the case and one piece for the top



Performance Credenza™ Utility Credenzas

Laminate Top

Components	Model #	Description	Price
Front Opening Components			
TF-[]		Pull-out trash/recycling unit - (2) 41 qt. containers	891
R1-[]		Sliding equipment rack - 12RU with thermostatically controlled fan and plugstrip	2443
R2-[]		Fixed equipment rack - 12RU with thermostatically controlled fan and plugstrip	667
D3-[]		Three drawers (behind one door)	2098
OM-[]		Open Module to accept refrigerator (Refrigerator not included. Only Available in Center Position)	0
End Opening Component (only available in 1st and last positions)			
TE-[]		Pull-out trash/recycling unit - (2) 41 qt. containers	891
Accessories			
FAN		Thermostatically controlled fan	422
FAN-UK		Thermostatically controlled fan for UK power	460
DF-GE		Drawer Fronts for GE Monogram refrigerated drawer unit	353

REQUIRED INFORMATION: (ORDER CANNOT BE ENTERED WITHOUT THIS INFORMATION)

[] Specify location for each component, one per location. Location comes standard with adjustable shelves if no component is specified.



2-Door Credenza

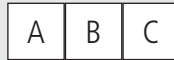

3-Door Credenza

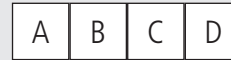

4-Door Credenza



5-Door Credenza

General Information:

- Door on trash/recycling unit pulls out with bin
- Trash/recycling units have a 41 qt. capacity
- Maximum of 1 trash/recycling unit for a 2-Door Credenza, 2 trash/recycling units for both 3-Door and 4-Door Credenzas, and 3 trash/recycling units for a 5-Door Credenza
- Drawers and trash bin surround are painted Cloud
- Labels are included with pull-out trash/recycling unit
- Thermostatically controlled fan activates automatically at 87° F and turns off at 85° F
- Trash/recycling units are non-locking
- OM-[] only available in Position B on 3-Door, 4-Door and 5-Door Buffet Height Credenzas, 33-7/8" H x 24"W x 24-3/4"D, adds 1" to the overall depth of the Credenza
- Open module is intended for refrigeration unit (refrigerator not included)
- 48" - 96" Credenzas ship fully assembled; 120" credenzas will ship in 3 pieces, a 72" credenza, 48" credenza and a 120" long common top.
- 120"-L credenzas consists of a 72" and 48" credenza side by side with a common top. The 72" credenza will always be on the left side and the 48" credenza will always be on the right side.



Performance Credenza™ Utility Credenzas

Glass Top

Utility Credenzas	Model #	W x D x H	Description	Internal Width	Internal Depth	Internal Height	Price			
							Veneer		Premium Veneer	
							Gloss Glass	Satin Glass	Gloss Glass	Satin Glass
							-VG	-VS	-PVG	-PVS
Conference Height										
	PC-U-4829	48 x 24-3/4 x 30	Two Doors	(2) 22-3/4	23-1/8	23-7/16	7055	7155	7407	7727
	PC-U-7229	72 x 24-3/4 x 30	Three Doors	(3) 22-3/4	23-1/8	23-7/16	8434	8801	9109	9504
	PC-U-9629	96 x 24-3/4 x 30	Four Doors	(4) 22-3/4	23-1/8	23-7/16	10015	10452	10818	11288
	PC-U-12029	120 x 24-3/4 x 30	Five Doors	(5) 22-3/4	23-1/8	23-7/16	11468	11966	12385	12924

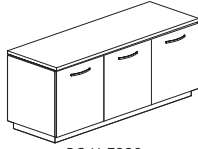

PC-U-7229

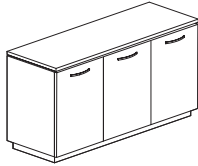

PC-U-7237

Buffet Height

PC-U-4837	48 x 24-3/4 x 36-3/4	Two Doors	(2) 22-3/4	23-1/8	30-1/8	7882	8225	8512	8883
PC-U-7237	72 x 24-3/4 x 36-3/4	Three Doors	(3) 22-3/4	23-1/8	30-1/8	9702	10124	10478	10933
PC-U-9637	96 x 24-3/4 x 36-3/4	Four Doors	(4) 22-3/4	23-1/8	30-1/8	11517	12018	12438	12978
PC-U-12037	120 x 24-3/4 x 36-3/4	Five Doors	(5) 22-3/4	23-1/8	30-1/8	13187	13761	14243	14862

Options:

Locks:	Add -L	\$165
Integrated Pull:	Add -IP	\$301 for 48" Credenzas, \$369 for 72" Credenzas, \$415 for 96" Credenzas, \$500 for 120" Credenzas
Painted Plinth Base:	Add -PBP	No charge
Painted Reveal:	Add -RP	No charge
Painted Case:	Add -PA	Deduct \$568 for 48" Credenza, \$699 for 72" Credenza, \$829 for 96" Credenza, \$950 for 120" Credenza (from the Veneer case prices)



Integrated Pull (Optional)

REQUIRED INFORMATION: (ORDER CANNOT BE ENTERED WITHOUT THIS INFORMATION)

See pages 5-6 for surface material options.

- Choose Wood Species & Finish, if applicable
- Choose Metal Finish for Pulls unless **-IP** is specified
- Choose Paint Finish, if **-PA**, **-RP** or **-PBP** options are specified
- Choose Components, if applicable (see next page, credenzas come with adjustable shelves as standard)

General Information:

- Glass Tops are 1/4" thick and sit on a 3/4" subtop
- Conference Height Credenzas ship with one adjustable shelf behind each door and metal pulls, unless other components are specified
- Buffet Height Credenzas ship with two adjustable shelves behind each door and metal pulls, unless other components are specified
- Back panel has ventilation cutout for each position. Cutout can accept optional fan if additional airflow is needed.
- Metal finish defaults to pull finish when painted plinth base or reveal is selected. If alternate finish is desired, note on order.
- Locks, if selected, are centered above pull and will default to Foil finish if metal color is not specified. Trash/recycling units are non-locking.
- 48"-96" credenzas ship in one piece; 120" credenzas will ship with two pieces for the case and one piece for the top
- Subtop finish will match case finish



Performance Credenza™ Utility Credenzas

Glass Top

Components	Model #	Description	Price
Front Opening Components			
TF-[]		Pull-out trash/recycling unit - (2) 41 qt. containers	891
R1-[]		Sliding equipment rack - 12RU with thermostatically controlled fan and plugstrip	2443
R2-[]		Fixed equipment rack - 12RU with thermostatically controlled fan and plugstrip	667
D3-[]		Three drawers (behind one door)	2098
OM-[]		Open Module to accept refrigerator (Refrigerator not included. Only Available in Center Position)	0
End Opening Component (only available in 1st and last positions)			
TE-[]		Pull-out trash/recycling unit - (2) 41 qt. containers	891
Accessories			
FAN		Thermostatically controlled fan	422
FAN-UK		Thermostatically controlled fan for UK power	460
DF-GE		Drawer Fronts for GE Monogram refrigerated drawer unit	353

REQUIRED INFORMATION: (ORDER CANNOT BE ENTERED WITHOUT THIS INFORMATION)

[] Specify location for each component, one per location. Location comes standard with adjustable shelves if no component is specified.



2-Door Credenza

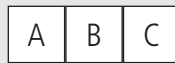

3-Door Credenza

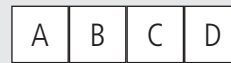

4-Door Credenza

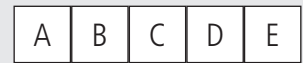

5-Door Credenza

General Information:

- Door on trash/recycling unit pulls out with bin
- Trash/recycling units have a 41 qt. capacity
- Maximum of 1 trash/recycling unit for a 2-Door Credenza, 2 trash/recycling units for both 3-Door and 4-Door Credenzas, and 3 trash/recycling units for a 5-Door Credenza
- Drawers and trash bin surround are painted Cloud
- Labels are included with pull-out trash/recycling unit
- Thermostatically controlled fan activates automatically at 87° F and turns off at 85° F
- Trash/recycling units are non-locking
- OM-[] only available in Position B on 3-Door, 4-Door and 5-Door Buffet Height Credenzas, 33-7/8" H x 24"W x 24-3/4"D, adds 1" to the overall depth of the Credenza
- Open module is intended for refrigeration unit (refrigerator not included)
- 48" - 96" Credenzas ship fully assembled; 120" credenzas will ship in 3 pieces, a 72" credenza, 48" credenza and a 120" long common top.
- 120"-L credenzas consists of a 72" and 48" credenza side by side with a common top. The 72" credenza will always be on the left side and the 48" credenza will always be on the right side.



Performance Credenza™ Utility Credenzas

Stone/Quartz and Solid Surface Tops

Price

Utility Credenzas	Model #	W x D x H	Description	Internal Width	Internal Depth	Internal Height	Solid Surface		Stone/Quartz	
							Veneer	Premium Veneer	Veneer	Premium Veneer
							-SS-V	-SS-PV	-S-V	-S-PV
Conference Height										
	PC-U-4829	48 x 24-3/4 x 30	Two Doors	(2) 22-3/4	23-1/8	23-7/16	7453	8198	7752	8525
	PC-U-7229	72 x 24-3/4 x 30	Three Doors	(3) 22-3/4	23-1/8	23-7/16	9168	10084	9534	10487
	PC-U-9629	96 x 24-3/4 x 30	Four Doors	(4) 22-3/4	23-1/8	23-7/16	10887	11975	11323	12452
	PC-U-12029	120 x 24-3/4 x 30	Five Doors	(5) 22-3/4	23-1/8	23-7/16	12465	13710	12964	14258

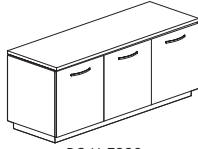

PC-U-7229

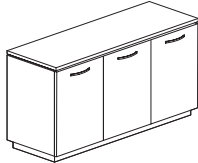

PC-U-7237



Integrated Pull (Optional)

Buffet Height

PC-U-4837	48 x 24-3/4 x 36-3/4	Two Doors	(2) 22-3/4	23-1/8	30-1/8	8568	9424	8911	9801
PC-U-7237	72 x 24-3/4 x 36-3/4	Three Doors	(3) 22-3/4	23-1/8	30-1/8	10546	11599	10967	12063
PC-U-9637	96 x 24-3/4 x 36-3/4	Four Doors	(4) 22-3/4	23-1/8	30-1/8	12520	13769	13019	14320
PC-U-12037	120 x 24-3/4 x 36-3/4	Five Doors	(5) 22-3/4	23-1/8	30-1/8	14333	15766	14907	16397

Options:

Locks:	Add -L	\$165
Integrated Pull:	Add -IP	\$301 for 48" Credenzas, \$369 for 72" Credenzas, \$415 for 96" Credenzas, \$500 for 120" Credenzas
Painted Plinth Base:	Add -PBP	No charge
Painted Reveal:	Add -RP	No charge
Painted Case:	Add -PA	Deduct \$568 for 48" Credenza, \$699 for 72" Credenza, \$829 for 96" Credenza, \$950 for 120" Credenza (from the Veneer case prices)

REQUIRED INFORMATION: (ORDER CANNOT BE ENTERED WITHOUT THIS INFORMATION)

See pages 5-6 for surface material options.

- Choose Wood Species & Finish, if applicable
- Choose Metal Finish for Pulls unless **-IP** is specified
- Choose Paint Finish, if **-PA**, **-RP** or **-PBP** options are specified
- Choose Solid Surface Color, if **-SS-V** or **-SS-PV** is specified
- Choose Stone/Quartz Color, if **-S-V** or **-S-PV** is specified
- Choose Components, if applicable (see next page, credenzas come with adjustable shelves as standard)

General Information:

- Solid Surface Tops are 1" thick
 - 48" - 96" Solid Surface Top credenzas ship fully assembled
 - 120" Solid Surface Top credenzas will ship in 3 pieces, a 72" case, 48" case, and a 120" long common top. The 72" case will always be on the left side and the 48" case will always be on the right side.
- Stone/Quartz Tops are 2cm thick
 - 48" - 96" Stone/Quartz Top credenzas ship fully assembled
 - 120" Stone/Quartz Top credenzas will ship in 4 pieces, a 72" case, 48" case, and a two 60" long tops. The 72" case will always be on the left side and the 48" case will always be on the right side. Top seam will be located at center of credenza.
- Stone and Solid Surface Material: Despite its reputation for durability, natural stone can easily be broken during handling and/or installation if proper techniques are not followed. In addition, NuCraft is not responsible for the installation of natural stone or solid surface materials on its products. Therefore, installers specifically trained in the installation of these materials must be utilized to ensure a quality installation. NuCraft shall not be liable for any damages incurred during the handling and/or installation of natural stone or solid surface materials on its products.
- Conference Height Credenzas ship with one adjustable shelf behind each door and metal pulls, unless other components are specified
- Buffet Height Credenzas ship with two adjustable shelves behind each door and metal pulls, unless other components are specified
- Back panel has ventilation cutout for each position. Cutout can accept optional fan if additional airflow is needed.
- Metal finish defaults to pull finish when painted plinth base or reveal is selected. If alternate finish is desired, note on order.
- Locks, if selected, are centered above pull and will default to Foil finish if metal color is not specified. Trash/recycling units are non-locking.



Performance Credenza™ Utility Credenzas

Stone/Quartz and Solid Surface Tops

Components	Model #	Description	Price
Front Opening Components			
TF-[]		Pull-out trash/recycling unit - (2) 41 qt. containers	891
R1-[]		Sliding equipment rack - 12RU with thermostatically controlled fan and plugstrip	2443
R2-[]		Fixed equipment rack - 12RU with thermostatically controlled fan and plugstrip	667
D3-[]		Three drawers (behind one door)	2098
OM-[]		Open Module to accept refrigerator (Refrigerator not included. Only Available in Center Position)	0
End Opening Component (only available in 1st and last positions)			
TE-[]		Pull-out trash/recycling unit - (2) 41 qt. containers	891
Accessories			
FAN		Thermostatically controlled fan	422
FAN-UK		Thermostatically controlled fan for UK power	460
DF-GE		Drawer Fronts for GE Monogram refrigerated drawer unit	353

REQUIRED INFORMATION: (ORDER CANNOT BE ENTERED WITHOUT THIS INFORMATION)

[] Specify location for each component, one per location. Location comes standard with adjustable shelves if no component is specified.



2-Door Credenza

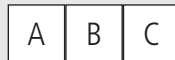

3-Door Credenza

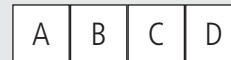

4-Door Credenza



5-Door Credenza

General Information:

- Solid Surface Tops are 1" thick
 - 48" - 96" Solid Surface Top credenzas ship fully assembled
 - 120" Solid Surface Top credenzas will ship in 3 pieces, a 72" case, 48" case, and a 120" long common top. The 72" case will always be on the left side and the 48" case will always be on the right side.
- Stone/Quartz Tops are 2cm thick
 - 48" - 96" Stone/Quartz Top credenzas ship fully assembled
 - 120" Stone/Quartz Top credenzas will ship in 4 pieces, a 72" case, 48" case, and a two 60" long tops. The 72" case will always be on the left side and the 48" case will always be on the right side. Top seam will be located at center of credenza.
- Stone and Solid Surface Material: Despite its reputation for durability, natural stone can easily be broken during handling and/or installation if proper techniques are not followed. In addition, NuCraft is not responsible for the installation of natural stone or solid surface materials on its products. Therefore, installers specifically trained in the installation of these materials must be utilized to ensure a quality installation. NuCraft shall not be liable for any damages incurred during the handling and/or installation of natural stone or solid surface materials on its products.
- Trash/recycling units have a 41 qt. capacity
- Maximum of 1 trash/recycling unit for a 2-Door Credenza, 2 trash/recycling units for both 3-Door and 4-Door Credenzas, and 3 trash/recycling units for a 5-Door Credenza
- Drawers and trash bin surround are painted Cloud
- Labels are included with pull-out trash/recycling unit
- Thermostatically controlled fan activates automatically at 87° F and turns off at 85° F
- Trash/recycling units are non-locking
- OM-[] only available in Position B on 3-Door, 4-Door and 5-Door Buffet Height Credenzas, 33-7/8" H x 24"W x 24-3/4"D, adds 1" to the overall depth of the Credenza
- Open module is intended for refrigeration unit (refrigerator not included)



Performance Credenza™ Food Service Credenzas

U.S. Patent No. D610,829

Veneer Top with Hardwood Edge

	Build-Your-Own	Model #	W x D x H	Description	Veneer -V	Premium Veneer -PV
	Double Sided Pull-Out Worksurface					
		PC-F-7237LR	72 x 27-3/4 x 37	Three Doors with Left- and Right-Hand Pull-Out Worksurface	13762	15138
	No Pull-Out Worksurface					
		PC-F-7237	72 x 27-3/4 x 37	Three Doors	11106	12216

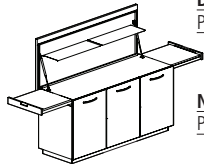

PC-F-7237LR

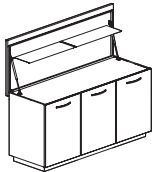

PC-F-7237

[] Specify Left (L) or Right (R)

Options:

Locks:	Add -L	\$165
Integrated Pull:	Add -IP	\$369 for 72" Credenzas
Painted Plinth Base:	Add -PBP	No Charge
Painted Reveal:	Add -RP	No Charge

REQUIRED INFORMATION: (ORDER CANNOT BE ENTERED WITHOUT THIS INFORMATION)

See pages 5-6 for surface material options.

- Choose Wood Species & Finish
- Choose Metal Finish for Pulls
- Choose Paint Finish, if **-PBP** or **-RP** options are specified
- Choose Edge Profile (front edge top only):



RK - Radius Knife



SQ - Square

General Information:

- Tops are 1 1/4" thick with 7/8" deep wood edge band, veneered over
- Radius Knife (RK) edge profile adds 1-7/8" to overall depth
- Build-Your-Own Credenzas come with adjustable shelves unless other components are specified
- Flip-up shelf is 10.5"d
- Laminate sub top and pull-out worksurface is Formica Surf 923-58
- Optional pull-out worksurface adds an additional 22" of worksurface to each side
- Flip-up shelf weight capacity: 25 lbs
- Pull-out worksurface weight capacity: 45 lbs in center of shelf
- Metal finish defaults to pull finish on flip-up shelf and when painted plinth base or reveal is selected. If alternate finish is desired, note on order.
- Locks, if selected, are centered above pull and will default to Foil finish if metal color is not specified. Trash/recycling units are non-locking.
- Refrigerators are not included with Food Service Credenzas
- Credenzas ship fully assembled
- Credenzas default to metal pulls.



Integrated Pull
(Optional)



Performance Credenza™ Food Service Credenzas

U.S. Patent No. D610,829

Veneer Top with Hardwood Edge

Components	Model #	Description	Price
Front Opening Components			
TF-[]		Pull-out trash/recycling unit - (2) 41 qt. containers	891
R1-[]		Sliding equipment rack - 12RU with thermostatically controlled fan and plugstrip	2443
R2-[]		Fixed equipment rack - 12RU with thermostatically controlled fan and plugstrip	667
D3-[]		Three drawers (behind one door)	2098
OM-[]		Open Module to accept refrigerator (Refrigerator not included. Only Available in Center Position)	0
End Opening Component (only available in positions A and C - not available in same location as pull out worksurface)			
TE-[]		Pull-out trash/recycling unit - (2) 41 qt. containers	891
Accessories			
FAN		Thermostatically controlled fan	422
FAN-UK		Thermostatically controlled fan for UK power	460
DF-GE		Drawer Fronts for GE Monogram refrigerated drawer unit	353

REQUIRED INFORMATION: (ORDER CANNOT BE ENTERED WITHOUT THIS INFORMATION)

[] Specify location for each component. Location comes standard with adjustable shelves if no component is specified.

A	B	C
---	---	---

3-Door Credenza

General Information:

- Door on trash/recycling unit pulls out with bin
- Trash/recycling units have a 41 qt. capacity
- Maximum of 2 trash/recycling units for a 3-Door Credenza
- Drawers and trash bin surround are painted Cloud
- Labels are included with rollout trash/recycling unit
- Thermostatically controlled fan activates automatically at 87° F and turns off at 85° F
- Drawer fronts for refrigerated units and trash/recycling units are non-locking.



Performance Credenza™

Food Service Credenzas

U.S. Patent No. D610,829

Laminate Top

Build-Your-Own	Model #	W x D x H	Description	Price	
				Laminate with ABS Edge & Painted Case	Inset Laminate with Wood Edge & Veneer Case
				-PE	-P
Double Sided Pull-Out Worksurface					
	PC-F-7237LR	72 x 27-3/4 x 37	Three Doors with Left- and Right-Hand Pull-Out Worksurface	12386	13006
No Pull-Out Worksurface					
	PC-F-7237	72 x 27-3/4 x 37	Three Doors	9995	10494

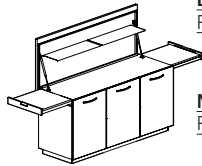

PC-F-7237LR

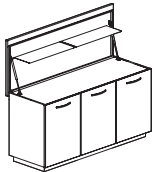

PC-F-7237

[] Specify Left (L) or Right (R)

Options:

Locks:	Add -L	\$165
Integrated Pull:	Add -IP	\$369 for 72" Credenzas
Painted Plinth Base:	Add -PBP	No Charge
Painted Reveal:	Add -RP	No Charge

REQUIRED INFORMATION: (ORDER CANNOT BE ENTERED WITHOUT THIS INFORMATION)

See pages 5-6 for surface material options.

- Choose Wood Species & Finish, if applicable
- Choose Laminate Finish
- Choose ABS Edge Finish, if **-PE** is specified
- Choose Metal Finish for Pulls
- Choose Paint Finish, if **-PBP**, **-RP**, or **-PE** options are specified
- Choose Edge Profile if **-P** is specified (front edge top only):



RK - Radius Knife



SQ - Square

General Information:

- Tops are 1 1/4" thick with 7/8" deep wood edge band
- Radius Knife (RK) edge profile adds 1-7/8" to overall depth
- Build-Your-Own Credenzas come with adjustable shelves unless other components are specified
- Flip-up shelf is 10.5" deep
- Laminate sub top and pull-out worksurface is Formica Surf 923-58
- Optional pull-out worksurface adds an additional 22" of worksurface to each side
- Flip-up shelf weight capacity: 25 lbs
- Pull-out worksurface weight capacity: 45 lbs in center of shelf
- Metal finish defaults to pull finish on flip-up shelf and when painted plinth base or reveal is selected. If alternate finish is desired, note on order.
- Locks, if selected, are centered above pull. Drawer fronts for refrigerated units and trash/recycling units are non-locking.
- Refrigerators are not included with Food Service Credenzas
- Credenzas ship fully assembled
- Locks, if selected, are centered above pull and will default to Foil finish if metal color is not specified. Trash/recycling units are non-locking
- Laminate with ABS edge (**-PE**) option only available with Painted Case



Integrated Pull
(Optional)



Performance Credenza™

Food Service Credenzas

U.S. Patent No. D610,829

Laminate Top

Components	Model #	Description	Price
Front Opening Components			
	TF-[]	Pull-out trash/recycling unit - (2) 41 qt. containers	891
	R1-[]	Sliding equipment rack - 12RU with thermostatically controlled fan and plugstrip	2443
	R2-[]	Fixed equipment rack - 12RU with thermostatically controlled fan and plugstrip	667
	D3-[]	Three drawers (behind one door)	2098
	OM-[]	Open Module to accept refrigerator (Refrigerator not included. Only Available in Center Position)	0
End Opening Component (only available in positions A and C - not available in same location as pull out worksurface)			
	TE-[]	Pull-out trash/recycling unit - (2) 41 qt. containers	891
Accessories			
	FAN	Thermostatically controlled fan	422
	FAN-UK	Thermostatically controlled fan for UK power	460
	DF-GE	Drawer Fronts for GE Monogram refrigerated drawer unit	353

REQUIRED INFORMATION: (ORDER CANNOT BE ENTERED WITHOUT THIS INFORMATION)

[] Specify location for each component. Location comes standard with adjustable shelves if no component is specified.

A	B	C
---	---	---

3-Door Credenza

General Information:

- Door on trash/recycling unit pulls out with bin
- Trash/recycling units have a 41 qt. capacity
- Maximum of 2 trash/recycling units for a 3-Door Credenza
- Drawers and trash bin surround are painted Cloud
- Labels are included with rollout trash/recycling unit
- Thermostatically controlled fan activates automatically at 87° F and turns off at 85° F
- Drawer fronts for refrigerated units and trash/recycling units are non-locking.