

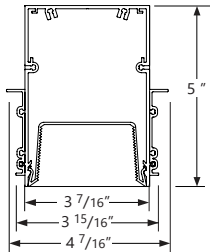

SQ - square shielding shape



SQ - square regress

Project _____

Type _____

Notes _____



Ordering Guide

ZERLED		SQ		NOMINAL LUMENS/FT		CRI		COLOR TEMPERATURE		FIXTURE LENGTH	
PRODUCT ID		SHIELDING SHAPE									
ZERLED	Zen Recessed LED	SQ	square regress*	400	400 lm/ft - Minimum	80	80 CRI	27	2700 K	2	2'
				1000	1000 lm/ft - Maximum	90	90 CRI	30	3000 K	3	3'
								35	3500 K	4	4'
								40	4000 K	5	5'
										6	6'
										7	7'
										8	8'
										12	12'
										S#	system run*
* All shieldings use MSO - microgroove spotless lens.				Outputs between listed min and max are available. Consult factory for outputs outside of the listed range.				Come in 1' increments * Please consult factory			

FINISH		VOLTAGE		DRIVER		CIRCUITS	
W	white	UNV	universal	DP	dimming (0-10V) 1%	1	1 circuit
C	custom			LT	Lutron ⁽¹⁾	2	2 circuits
				BI	bi-level dimming	+E(#)	emergency section
				O	other ⁽²⁾		
Consult factory for 347 V				(1) Specify system (2) Please consult factory; see page 2			

MOUNTING/SUSPENSION		BATTERY (OPTIONAL)		REMOTE CONTROLS (OPTIONAL)		END CAP (OPTIONAL)		CUSTOM	
TB9	t-bar 9/16"	B#	battery pack	DS#	daylight sensor	OPDS	open spackle end cap	C	custom
TB15	t-bar 15/16"			DOS#	daylight & occupancy sensor				
ST	screw slot t-bar			WC#	wireless control dimming				
TG9	tegular 9/16"								
TG15	tegular 15/16"								
DF	drywall flange								
DS	drywall spackle flange								
Not available with 347V Please consult factory				Remote only. See integrated controls guide for more details.				Please specify	

Zen Square

LINEAR - RECESSED



● LED UPGRADE / REPLACEMENT

All LED light engines used are field replaceable and upgradable to ensure the lighting system will last for years.

● LED SYSTEM

CRI	Minimum 80 or 90 color rendering index
CCT	Choice of 3000K, 3500K and 4000K color temperature with a great color consistency (within 3-step MacAdam ellipse). Both within fixture and fixture to fixture.
LED life	Minimum 50,000h with 85% of lumen maintenance in 25°C ambient temperature, in compliance with IES LM-80 testing measurements.
Thermal Management	Aluminum housing acting as the heat sink to maximize life.
Environment	Dry and damp rated in operating ambient temperatures of 0-40°C (32-104°F)

● ELECTRICAL

Lutron driver* LDE1 - EcoSystem H-Series (1%)
LDE5 - EcoSystem 5-Series (5%)
LTE - Hi-Lume® A-series 2Wires Forward Phase (1%)
*Consult factory

Other drivers DALI - Digital Addressable Lighting Interface
DMX - Digital Multiplex
LV - line voltage - Advance Mark 10
Xitanium SR - For wireless sensor

Emergency Integral emergency battery pack or emergency circuit optional.

Input Voltage 120V, 277V, 347V, UNV.

i Incorporating these components may have limitations or affect the length of the luminaire. Please contact factory for more details.

● UNIQUE ZEN SHIELDING OPTIONS

A new linear downlight optical concept. A Zen spotless optic with highly efficient and comfortable micro groove side walls for excellent shielding along and across.

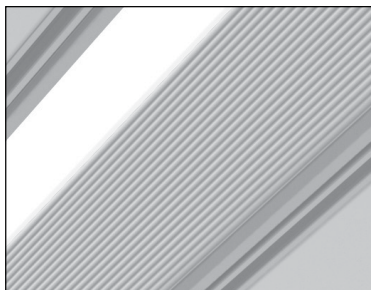

MSO - microgroove spotless lens

● WEIGHT

ZEN 4 ft 9 lbs / 4.1 kg
ZEN 8 ft 18 lbs / 8.2 kg
ZEN 12 ft 27 lbs / 12.3 kg

● FINISH

White, black, aluminum paint, powder coated and custom finishes are also available.

● APPROVALS

Certified to UL and CSA standards
Suitable for damp locations.



● CONSTRUCTION

Housing	Extruded aluminum (0.075" nominal)
End Cap	Die cast aluminum (0.10" nominal)
Mounting Brackets	Cold rolled sheet steel painted (16 gauge)
Microgroove Lens	Uniform frosted acrylic lens

● END CAP OPTION

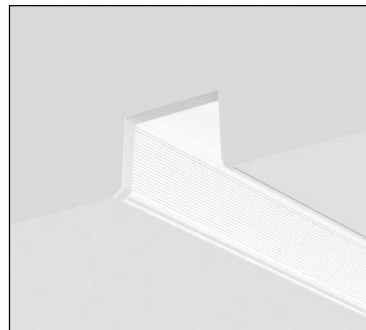

OPDS - open spackle end cap

Zen Square

LINEAR - RECESSED



● TB CEILING MOUNTING OPTIONS

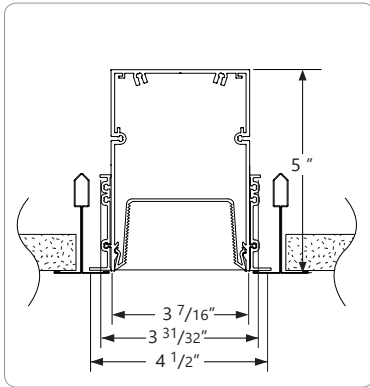

TB15 15/16" T-BAR

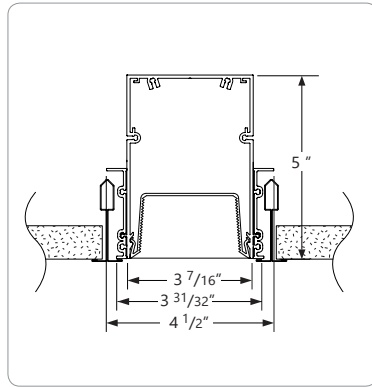

TB9 9/16" T-BAR

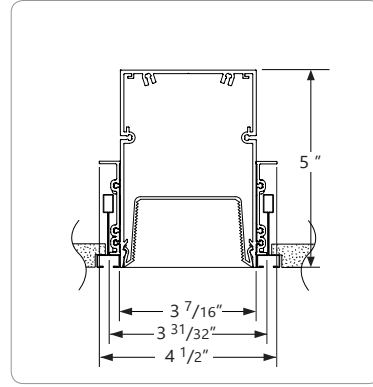

ST SCREW SLOT T-BAR

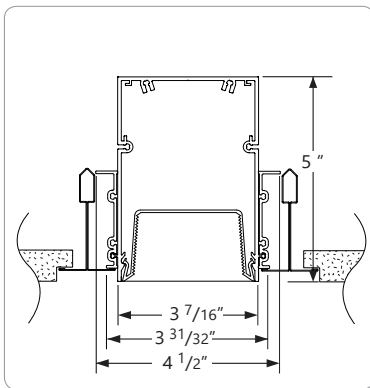

TG15 15/16" TEGULAR

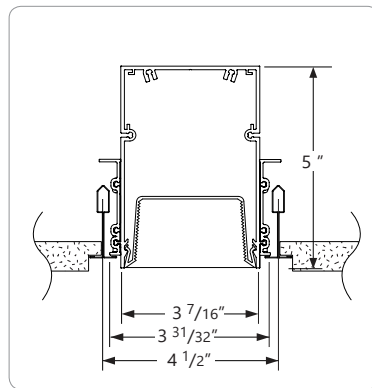

TG9 9/16" T-TEGULAR

● DRYWALL CEILING MOUNTING OPTIONS

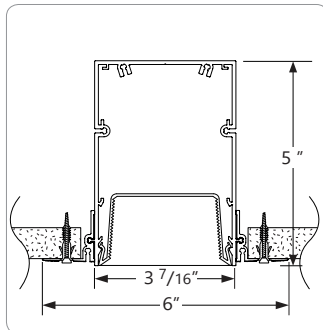

DS SPACKLE FLANGES

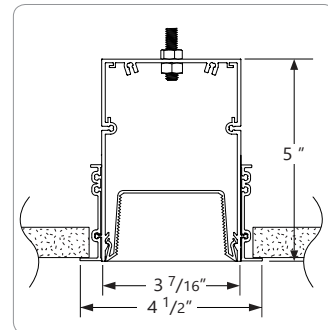

DF VISIBLE FLANGES WITH
1/4-20 STUD MOUNTING

i Specification sheets and installation sheets for all mountings for ZEN luminaires are available for download at www.axislighting.com



● PHOTOMETRIC DATA

SQUARE (SQ) - 800 lm

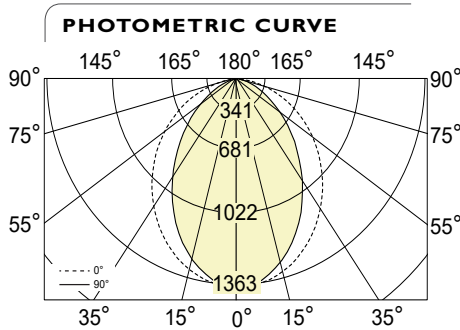

Lumen/ft : 800 lm/ft
Total Lumens: 2990 lm (for 4ft)
Input Watts: 29.3 W
Efficacy: 102 lm/W

CRI:80 shown
 IES FILE: ZERLED-SQ-800-80-35-4-W.IES
 TESTED ACCORDING TO IES LM-79-2008

CANDELA DISTRIBUTION

Vertical Angle	Horizontal Angles				
	0	22.5	45	67.5	90
0	1363	1363	1363	1363	1363
5	1355	1353	1349	1346	1346
15	1297	1284	1258	1236	1228
25	1186	1155	1100	1055	1039
35	1035	983	900	832	809
45	855	785	679	601	578
55	655	571	458	389	368
65	445	355	257	212	200
75	236	157	110	96	92
85	61	31	25	23	22
90	2	3	5	6	6

ZONAL LUMENS

Zone	Lumens
0	
0-10	128
10-20	355
20-30	508
30-40	568
40-50	536
50-60	432
60-70	285
70-80	141
80-90	36
90	

LUMINANCE DATA (cd/m²)

Vertical Angle	Horizontal Angles		
	0	45	90
45	11504	6940	5441
55	10728	5187	3757
65	9669	3372	2302
75	7987	1783	1260
85	4994	556	394

i All IES files are available for download at: www.axislighting.com