



WALL /CEILING MOUNT
LED

Fixture Type

Date

Job Name

Approved By

Catalog Number

SPECIFICATIONS

ADA Compliant

Description	The Apex 13 LED fixtures build on the highly successful Anyx line. The cut-off, LED version features an upgraded, die cast, marine grade aluminum external trim, as well as an innovative twist-lock system. The Apex 13 series has been installed successfully in large scale projects such as dorm rooms, unsecured hallways, transportation stations and public schools. Natatorium finish is standard for all versions of this fixture.
Trim	One piece die cast aluminum mechanically interlocked to base plate and sealed against moisture and contaminants with two high temperature silicone O-rings. Chemically primed and finished with electrostatically applied polyester powder coat. Locked in place with one concealed tamper resistant set screw.
Lens	One piece injection molded opal prismatic polycarbonate with minimum 0.130" wall thickness. Secured to base plate by trim and sealed with two high temperature silicone O-rings. Optional full cut-off lens available, see ordering information for details.
Reflector	One piece injection molded UV stabilized polycarbonate.
Base Plate	Pressure die cast marine grade aluminum. Chemically primed and finished with electrostatically applied polyester powder coat.
Drivers	Constant current drivers, 120-277V, 347V optional.
LED	Samsung LM561B+ Series @ 2700K, 3000K, 3500K, 4000K, and 5000K and 82 CRI wired in parallel-series. L ₇₀ projected life of 130,000 hours at 50°C. Tested in accordance with LM-80. Ten year warranty on LED boards against operational defects.
Gaskets	Closed cell die cut neoprene gasket provided between fixture mounting plate and mounting surface. High temperature silicone O-ring between the trim and lens, between the lens and base plate, and between the mounting plate and base plate.
Listings	U.L., C.U.L., Wet standard. 1598a Marine Listed.
Lifetime Warranty	Luminaire LED Incorporated will repair or replace any fixture damaged due to vandalism for the lifetime of the installation.



DIMENSIONAL DATA

	A	B
APX13	13.13	3.14

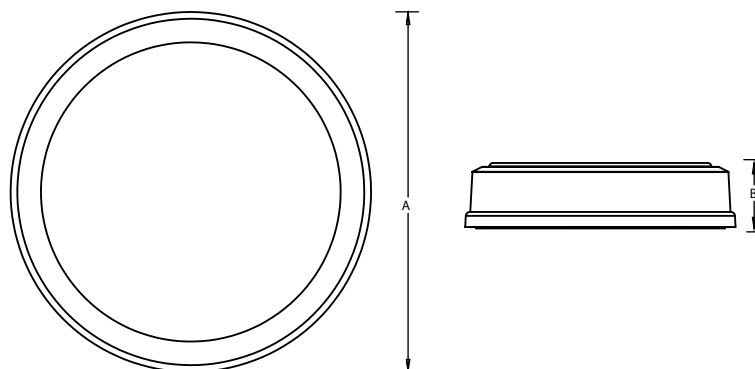

ORDERING INFORMATION

SERIES	LED	CCT	VOLTS	DRIVER	LENS	COLOR	OPTIONS		TX/SD
APX13	25W	2700K	120-277	CC	FL	BLK	DIM	EMB310	
		3000K	347*	DIM		WHT	PC	EMB125R	
		3500K				BRZ	GLR	EMB250R	
		4000K				GRY	SHCAB	EMB375R	
		5000K				CUST	FCL	ST/SC	

* SHCAB required

CC = Constant Current (Standard)

DIM = 0-10V Dimming, 10% at lowest level

OPTIONS

LENS	FL = Flat Opal Standard
COLORS	BLK = Black WHT = White BRZ = Bronze GRY = Gray CUST = Custom Color (Consult Factory)
DIM	0-10V dimming driver. 10% at lowest level.
PC	Photoelectric switch (requires SHCAB option).
GLR	Fuse and fuse holder.
SHCAB	Low profile pressure die cast marine grade aluminum back box. Provided with (3) 1/2 " i.p.t. holes for conduit entry with threaded plugs. Chemically primed and finished with electrostatically applied polyester powder coat.
FCL	Full cut-off lens.
EMB310	800 lumen self contained, 90 minute emergency battery pack. 0°C (32°F) to 55°C (131°F). Not available in 347V. SHCAB option required and included. Meets CA Title 20 Standards.
EMB125R	Stand-alone inverter that will operate a 125W maximum load for 90 minutes. 20°C (68°F) to 30°C (86°F).
EMB250R	Stand-alone inverter that will operate a 250W maximum load for 90 minutes. 20°C (68°F) to 30°C (86°F).
EMB375R	Stand-alone inverter that will operate a 375W maximum load for 90 minutes. 20°C (68°F) to 30°C (86°F).
ST/SC	Phillips head screws instead of TORX® head.
TX/SD	TORX® head bit.



PHOTOMETRIC DATA

Model	Watts	Input Watts	Delivered Lumens							
			2700K	3000K	3500K	4000K	5000K			
APX13	25W	26.5W	1970	1996	2033	2096	2158			
APX13 HO	50W	49.0W	3683	3734	3801	3919	4037			

MODEL APX13-25W-4000K

Delivered Lumens: 1941 Lumens

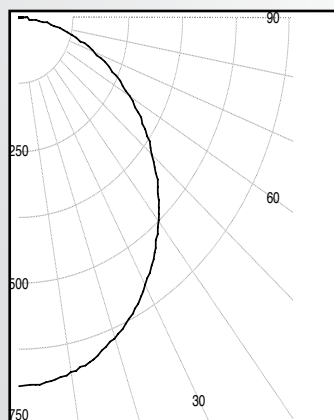

IES FILE: APX13-25W-4000K

Total Power: 26.5W

Testing was performed in accordance with IES LM-79-08

Zone	Lumens	% Lamps
0 - 30	537	27.6
0 - 40	876	45.1
0 - 60	1534	79.0
60 - 90	401	20.7
0 - 90	1935	99.7
90 -180	6	0.3
0 - 180	1941	100.0

MOUNTING PLATE DETAILS

