



CEILING MOUNT
LED

APEX 13

Vandal Resistant

APX 13 Full Cut-Off LED

Fixture Type

Date

Job Name

Approved By

Catalog Number

SPECIFICATIONS

ADA Compliant

- Description** The Apex 13 LED fixtures build on the highly successful Anyx line. The full cut-off, LED version features an upgraded, die cast, marine grade aluminum external trim, as well as an innovative twist-lock system. The Apex 13 series has been installed successfully in large scale projects such as dorm rooms, unsecured hallways, transportation stations and public schools. Natatorium finish is standard for all versions of this fixture.
- Trim** One piece die cast aluminum mechanically interlocked to base plate and sealed against moisture and contaminants with two high temperature silicone O-rings. Chemically primed and finished with electrostatically applied polyester powder coat. Locked in place with one concealed tamper resistant set screw.
- Lens** One piece injection molded opal prismatic polycarbonate with minimum 0.130" wall thickness, painted to provide full cut-off optics when ceiling mounted. Secured to base plate by trim and sealed with two high temperature silicone O-rings.
- Reflector** One piece injection molded UV stabilized polycarbonate.
- Base Plate** Pressure die cast marine grade aluminum. Chemically primed and finished with electrostatically applied polyester powder coat.
- Drivers** Constant current drivers, 120-277V, 347V optional.
- LED** Samsung LM561B+ Series @ 2700K, 3000K, 3500K, 4000K, and 5000K and 82 CRI wired in parallel-series. L₇₀ projected life of 130,000 hours at 50°C. Tested in accordance with LM-80. Ten year warranty on LED boards against operational defects.
- Gaskets** Closed cell die cut neoprene gasket provided between fixture mounting plate and mounting surface. High temperature silicone O-ring between the trim and lens, between the lens and base plate, and between the mounting plate and base plate.
- Listings** U.L., C.U.L., Wet standard. 1598a Marine Listed.
- Lifetime Warranty** Luminaire LED Incorporated will repair or replace any fixture damaged due to vandalism for the lifetime of the installation.



DIMENSIONAL DATA

	A	B
APX13	13.13	3.14

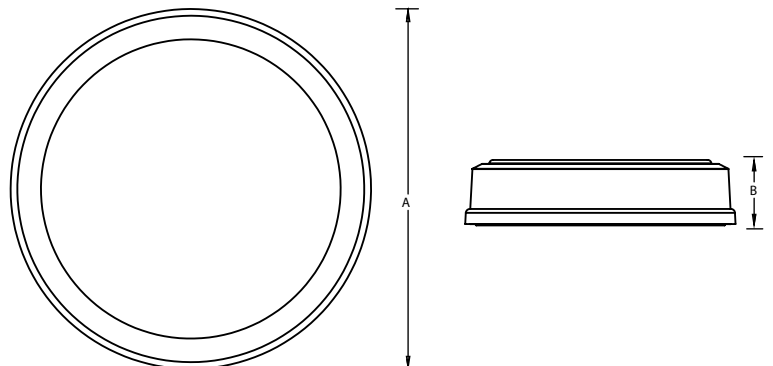

ORDERING INFORMATION

SERIES	LED	CCT	VOLTS	DRIVER	LENS	COLOR	OPTIONS		TX/SD
APX13	15W	2700K	120-277	CC	FCL	BLK	DIM	EMB310	
	25W	3000K	347*	DIM		WHT	PC	EMB125R	
	50W*	3500K				BRZ	GLR	EMB250R	
		4000K				GRY	SHCAB	EMB375R	
		5000K				CUST		ST/SC	

* SHCAB required

* SHCAB required

CC = Constant Current (Standard)

DIM = 0-10V Dimming, 10% at lowest level

OPTIONS

LENS	FCL=Full Cutoff (Ceiling Mount Only)
COLORS	BLK = Black WHT = White BRZ = Bronze GRY = Gray CUST = Custom Color (Consult Factory)
DIM	0-10V dimming driver. 10% at lowest level.
PC	Photoelectric switch (requires SHCAB option).
GLR	Fuse and fuse holder.
SHCAB	Low profile pressure die cast marine grade aluminum back box. Provided with (3) 1/2 " i.p.t. holes for conduit entry with threaded plugs. Chemically primed and finished with electrostatically applied polyester powder coat.
EMB310	800 lumen self contained, 90 minute emergency battery pack. 0°C (32°F) to 55°C (131°F). Not available in 347V. SHCAB option required and included. Meets CA Title 20 Standards.
EMB125R	Stand-alone inverter that will operate a 125W maximum load for 90 minutes. 20°C (68°F) to 30°C (86°F).
EMB250R	Stand-alone inverter that will operate a 250W maximum load for 90 minutes. 20°C (68°F) to 30°C (86°F).
EMB375R	Stand-alone inverter that will operate a 375W maximum load for 90 minutes. 20°C (68°F) to 30°C (86°F).
ST/SC	Phillips head screws instead of TORX® head.
TX/SD	TORX® head bit.

PHOTOMETRIC DATA

Model	Watts	Input Watts	Delivered Lumens								
			2700K	3000K	3500K	4000K	5000K				
APX13 FCL	15W	15.3W	1261	1277	1301	1341	1387				
APX13 FCL	25W	25.3W	1503	1522	1553	1599	1647				
APX13 HO FCL	50W	49.0W	2810	2846	2904	2990	3080				

MODEL APX13-25W-3500K-FCL

Delivered Lumens: 1553 Lumens

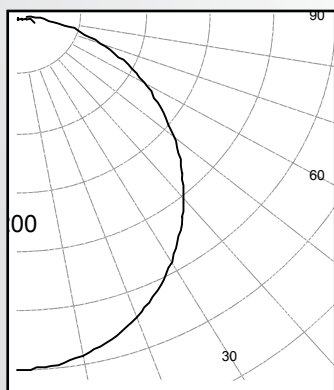

IES FILE: APX13-25W-4000K-FCL

Total Power: 25.3W

Testing was performed in accordance with IES LM-79-08

Zone	Lumens	% Lamps
0 - 30	454	29.2
0 - 40	731	47.1
0 - 60	1255	80.8
60 - 90	298	19.2
0 - 90	1553	100.0
90 -180	0	0.0
0 - 180	1553	100.0

MOUNTING PLATE DETAILS

