

WALL / CEILING/  
PENDANT MOUNT  
LED

Fixture Type

Date

Job Name

Approved By

Catalog Number

## SPECIFICATIONS

ADA Compliant

<b>Description</b>	The Sonar 4 series features nearly unlimited architectural flexibility while maintaining maximum vandal resistance. A wide variety of grill configurations, colors and lengths are available which can be combined in nearly unlimited ways. Furthermore, the all aluminum body construction and optional wet location listing allow the Sonar 4 series to be used in many environmental conditions. Natatorium finish is standard for all versions of this fixture.	
<b>Housing</b>	Marine grade heat treated extruded aluminum. Chemically primed and finished with robotically applied polyester powder coat.	
<b>Grill</b>	Marine grade die cast aluminum finished with polyester powder coat and secured to housing with tamper resistant stainless steel machine screws.	
<b>Lens</b>	Extruded UV stabilized opal polycarbonate with integral prisms. Maximum wall thickness 0.160". Secured to housing with die cast aluminum clamps and stainless steel TORX® head screws.	
<b>End Caps</b>	Die-cast marine grade aluminum with conduit knockouts that are visible from interior of end cap.	
<b>Drivers</b>	Constant current driver at 700mA, 120-277V.	
<b>LED</b>	Samsung LM561B+ series @ 2700K, 3000K, 3500K, 4000K, or 5000K and 82 CRI wired in parallel-series. L <sub>70</sub> projected life of over 130,000 hours at 50°C. Ten year warranty on LED boards against operational defects. Tested in accordance with LM-80.	
<b>Listings</b>	U.L., C.U.L., Damp Standard, Wet optional.	
<b>Lifetime Warranty</b>	Luminaire LED Incorporated will repair or replace any fixture damaged due to vandalism for the lifetime of the installation.	

## DIMENSIONAL DATA

	A	B	C
SPC412	15.50	4.35	2.70
SPC422	26.10	4.35	2.70
SPC434	37.88	4.35	2.70
SPC446	49.69	4.35	2.70

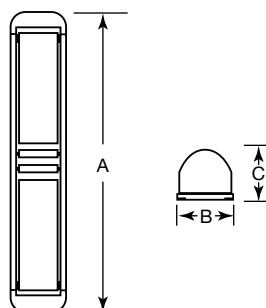

## ORDERING INFORMATION

SERIES	LED	GRILL	CCT	VOLTS	DRIVER	LENS	COLOR	OPTIONS		TX/SD
SPC4 12"	5W	NB	2700K	120-277	CC	CP	BLK	DIM	EMB10ST	
	10W	2CR	3000K	347	DIM	OP	WHT	PC	EMB310	
SPC4 22"	15W	3CR	3500K		PRD		BRZ	GLR	EMB310ST	
	20W	2OF	4000K				GRY	WET	EMB20R	
SPC4 34"	20W	3OF	5000K				SIL	NSF	EMB125R	
	30W	4OF					CUST	COR	EMB250R	
SPC4 46"	25W	6OF						JB	EMB375R	
	40W	6.2OF						PS	ST/SC	
	50W	9OF						OCCBT		
		CUS								
	Specify Watts or Lumens Above	When specifying Watts or Lumens you are required to select PRD Driver								

CC = Constant Current (Standard)

DIM = 0-10V Dimming, 10% at lowest level

PRD = Programmable driver. Specify Lumens or Watts. Consult factory.



## OPTIONS

LENS	CP = Clear Prismatic Standard	OP = Opal Optional				
COLORS	BLK = Black	WHT = White	BRZ = Bronze	GRY = Gray	SIL = Silver	CUST = Custom Color (Consult Factory)
*PRD	Programmable driver. When ordering, must specify Watts or Lumens. Consult factory for availability.					
DIM	0-10V dimming driver. 10% at lowest level. Consult factory for availability in select models.					
PC	Photoelectric switch.					
GLR	Fuse and fuse holder.					
WET	Silicone and neoprene gasketing for wet location. Surface mount only.					
NSF	National Sanitation Foundation rated. White finish only.					
COR	Corner mounted back box. Constructed from 16 gauge cold rolled zinc coated steel. Finished with white powder coat. Damp only.					
JB	Die cast joiner band for continuous row mount. Consult factory for row information.					
PS	Painted screws to match luminaire finish.					
OCCBT	Bluetooth connected microwave occupancy sensor mounted behind the lens. All LED boards sensed to dim to 50%, 30%, 20%, or 10% field selectable low levels. N/A in SPC412. N/A with EMB options. Consult factory for availability in select models.					
EMB10ST	1000 lumen self-testing, self-contained, 90 minute emergency battery pack. Not available for 12" length. 0°C (32°F) to 55°C (131°F).					
EMB310	1200 lumen self-contained 90 minute emergency battery pack. 0°C (32°F) to 55°C (131°F). Not available for 12" or 22" lengths. Meets CA Title 20 Standards.					
EMB310ST	1000 lumen self-testing, self-contained, 90 minute emergency battery pack. Not available for 12" or 22" lengths. 0°C (32°F) to 55°C (131°F). Meets CA Title 20 Standards.					
EMB20R	Remote mounted micro inverter that will operate a 25W maximum load for 90 minutes. 0°C (32°F) to 50°C (122°F).					
EMB125R	Remote mounted inverter that will operate a 125W maximum load for 90 minutes. 20°C (68°F) to 30°C (86°F).					
EMB250R	Stand-alone inverter that will operate a 250W maximum load for 90 minutes. 20°C (68°F) to 30°C (86°F).					
EMB375R	Stand-alone inverter that will operate a 375W maximum load for 90 minutes. 20°C (68°F) to 30°C (86°F).					
ST/SC	Phillips head screws instead of TORX® head.					
TX/SD	TORX® head bit.					



## PHOTOMETRIC DATA

Model	Watts	Input Watts	Delivered Lumens		Delivered Lumens		Delivered Lumens		Delivered Lumens		Delivered Lumens	
			Clear	Opal	Clear	Opal	Clear	Opal	Clear	Opal	Clear	Opal
			2700K		3000K		3500K		4000K		5000K	
SPC412	5W	7.5	628	581	635	586	648	599	669	619	688	637
SPC412	10W	10.4	898	814	907	841	927	859	956	866	984	912
SPC422	15W	14.0	1193	1106	1206	1118	1231	1142	1270	1177	1308	1212
SPC422	20W	21.0	2166	2007	2189	2029	2235	2071	2305	2136	2374	2200
SPC434	20W	20.2	2111	1966	2134	1987	2178	2028	2246	2092	2349	2200
SPC434	30W	31.1	2965	2748	2998	2778	3060	2835	3155	2924	3249	3011
SPC446	25W	26.9	2814	2608	2845	2636	2903	2690	2994	2775	3083	2858
SPC446	40W	42.2	4332	4015	4380	4061	4470	4144	4609	4272	4748	4400
SPC446	50W	54.6	5262	4877	5320	4929	5428	5030	5598	5198	5765	5344
SPC4x- *PRD			Specify Wattage or Delivered Lumens in Ordering Information									

## GRILL DETAILS

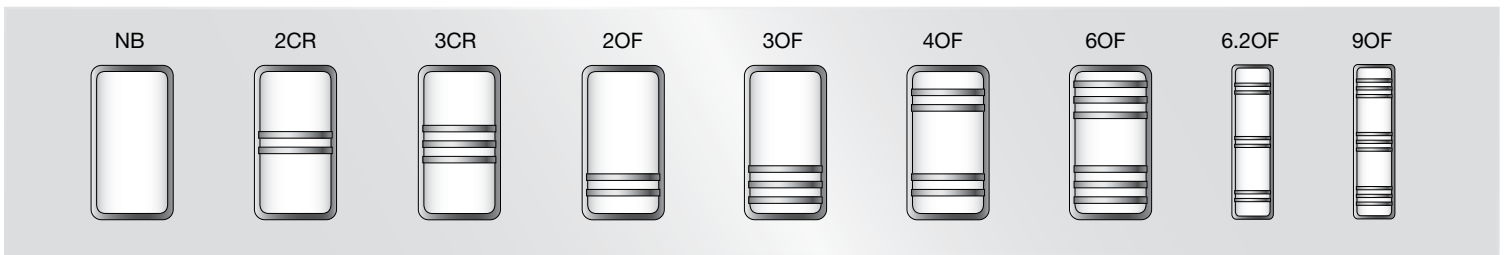

## PHOTOMETRIC DATA

### MODEL VPF41-5W-4000K CP

Delivered Lumens: 619 Lumens

Total Power: 7.5W

Testing was performed in accordance with IES LM-79-08

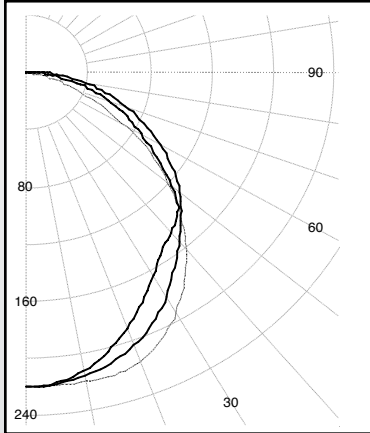

Zone	Lumens	% Lamps
0 - 30	169	27.3
0 - 40	273	44.1
0 - 60	479	77.3
60 - 90	136	21.9
0 - 90	615	99.3
90 - 180	5	0.7
0 - 180	619	100.0

### MODEL VPF44-25W-4000K-CP

Delivered Lumens: 2,772 Lumens

Total Power: 26.9W

Testing was performed in accordance with IES LM-79-08

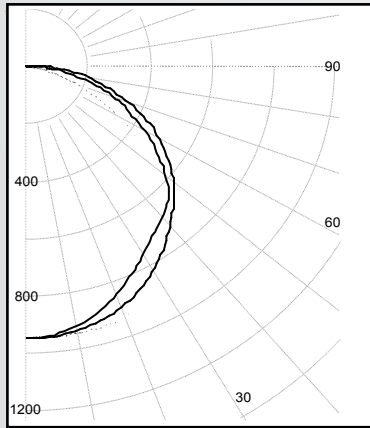

Zone	Lumens	% Lamps
0 - 30	733	26.4
0 - 40	1194	43.1
0 - 60	2116	76.3
60 - 90	633	22.8
0 - 90	2749	99.2
90 - 180	24	0.8
0 - 180	2772	100.0

## MOUNTING PLATE DETAILS

