

WALL / CEILING/
PENDANT MOUNT
LED

Fixture Type

Date

Job Name

Approved By

Catalog Number

SPECIFICATIONS

ADA Compliant

Description	The Sonar 8 series features nearly unlimited architectural flexibility while maintaining maximum vandal resistance. A wide variety of trims, colors and lengths are available which can be combined in nearly unlimited ways. Furthermore, the all aluminum body construction and optional wet location listing allow the Sonar 8 series to be used in many environmental conditions. Natatorium finish is standard for all versions of this fixture.
Housing	Marine grade heat treated extruded aluminum. Chemically primed and finished with robotically applied polyester powder coat.
Grill	Marine grade die cast aluminum finished with polyester powder coat and secured to housing with tamper resistant stainless steel machine screws.
Lens	Extruded UV stabilized opal polycarbonate with integral prisms. Maximum wall thickness 0.160". Secured to housing with die cast aluminum clamps and stainless steel TORX® head screws.
End Caps	Die-cast marine grade aluminum with conduit knockouts that are visible from interior of end cap.
Drivers	Constant current driver at 350mA, 120-277V only.
LED	Samsung LM561B series @ 3000K, 3500K, 4000K, or 5000K and 82 CRI wired in parallel-series. L ₇₀ projected life of over 130,000 hours at 50°C. Ten year warranty on LED boards against operational defects. Tested in accordance with LM-80.
UL Listing	U.L., C.U.L., Damp Standard, Wet optional.
Lifetime Warranty	Luminaire LED Incorporated will repair or replace any fixture damaged due to vandalism for the lifetime of the installation.



DIMENSIONAL DATA

	A	B	C
SPC812	12.00	8.75	4.00
SPC818	18.40	8.75	4.00
SPC824	27.64	8.75	4.00
SPC834	37.87	8.75	4.00
SPC846	49.68	8.75	4.00

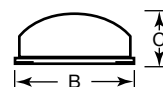
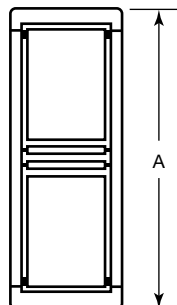

ORDERING INFORMATION

SERIES	GRILL	LED	CCT	VOLTS	LENS	COLOR	OPTIONS		TX/SD
SPC8 12"	NB	12" - 5W	3000K	120-277	CP	BLK	DIM	EMB310	
SPC8 18"	2CR	12" - 15W	3500K	347	OP	WHT	PC	EMB310ST	
SPC8 24"	3CR	18" - 5W	4000K			BRZ	GLR	EMB20R	
SPC8 34"	2OF	18" - 15W	5000K			GRY	WET	EMB125R	
SPC8 46"	3OF	24" - 15W				CUST	NSF	EMB250R	
	4OF	24" - 25W					COR	EMB375R	
	6OF	34" - 20W					JB	EMB722C	
	6.2OF	34" - 40W					PS	ST/SC	
	9OF	46" - 25W					2B		
	CUS	46" - 50W					OCC		
		46" - 100W					OCC50		

OPTIONS

LENS	CP = Clear Prismatic Standard	OP = Opal Optional			
COLORS	BLK = Black	WHT = White	BRZ = Bronze	GRY = Gray	CUST = Custom Color (Consult Factory)
DIM	0-10V dimming driver. Consult factory for availability in select models.				
PC	Photoelectric switch.				
GLR	Fuse and fuse holder.				
WET	Silicone and neoprene gasketing for wet location. Surface mount only.				
NSF	National Sanitation Foundation rated. White finish only.				
COR	Corner mounted back box. Constructed from 16 gauge cold rolled zinc coated steel.				
JB	Die cast joiner band for continuous row mount. Consult factory for row information. Finished with white powder coat. Damp only.				
PS	Painted screws to match luminaire finish.				
2B	(2) LED drivers for independent LED board operation.				
OCC	Microwave occupancy sensor mounted behind the lens. Fixture switched on or off depending on occupancy condition. Consult factory for availability in select models.				
OCC50	Microwave occupancy sensor mounted behind the lens. 50% of LED's constantly on and 50% sensed. 2 ft. and 4 ft. fixtures only.				
EMB310	1200 lumen self-contained 90 minute emergency battery pack. 0°C (32°F) to 55°C (131°F). Not available for 12" or 18" lengths. Not available in 347V.				
EMB310ST	1000 lumen self-testing, self-contained, 90 minute emergency battery pack. Not available for 12" or 18" lengths. 0°C (32°F) to 55°C (131°F). Not available in 347V.				
EMB20R	Remote mounted micro inverter that will operate a 25W maximum load for 90 minutes. 0°C (32°F) to 50°C (122°F). Not available in 347V.				
EMB125R	Remote mounted inverter that will operate a 125W maximum load for 90 minutes. 20°C (68°F) to 30°C (86°F). Not available in 347V.				
EMB250R	Stand-alone inverter that will operate a 250W maximum load for 90 minutes. 20°C(68°F) to 30°C (86°F). Not available in 347V.				
EMB375R	Stand-alone inverter that will operate a 375W maximum load for 90 minutes. 20°C(68°F) to 30°C (86°F). Not available in 347V.				
EMB722C	Cold weather, 2600 lumen self contained 90 minute emergency battery pack for 25W minimum operation. -20°C (-4°F) to 60°C (140°F). Not available for 12" and 18" lengths. Not available in 347V.				
ST/SC	Slotted screws instead of TORX® head.				
TX/SD	TORX® head bit.				



GRILL DETAILS

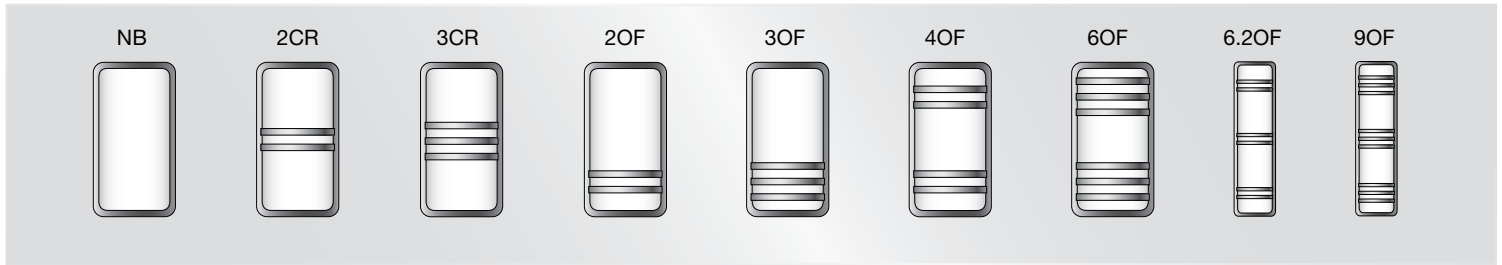

PHOTOMETRIC DATA

Model	Watts	Input Watts	Delivered Lumens		Delivered Lumens		Delivered Lumens		Delivered Lumens	
			Clear	Opal	Clear	Opal	Clear	Opal	Clear	Opal
			3000K		3500K		4000K		5000K	
SPC812	5W	6.8	555	514	567	525	585	542	603	558
SPC812	15W	13.6	1199	1111	1224	1135	1263	1171	1299	1205
SPC818	5W	6.5	670	620	684	633	705	653	726	673
SPC818	15W	13.0	1339	1241	1367	1267	1410	1307	1453	1346
SPC824	15W	13.0	1339	1241	1367	1267	1410	1307	1453	1346
SPC824	25W	26.6	2911	2698	2971	2754	3064	2839	3156	2925
SPC824	50W	56.0	5116	4742	5221	4839	5383	4990	5544	5139
SPC834	20W	19.5	2011	1864	2052	1902	2116	1960	2178	2019
SPC834	40W	38.9	4012	3718	4094	3795	4222	3913	4348	4031
SPC846	25W	26.6	2911	2698	2971	2754	3064	2839	3156	2925
SPC846	50W	53.5	5621	5211	5737	5318	5915	5483	6092	5647
SPC846	100W	114.6	10474	9709	10688	9907	11019	10215	11350	10520

PHOTOMETRIC DATA

MODEL SPC812-15W-4000K OP

Delivered Lumens: 1,084 Lumens

Total Power: 52.0W

Testing was performed in accordance with IES LM-79-08

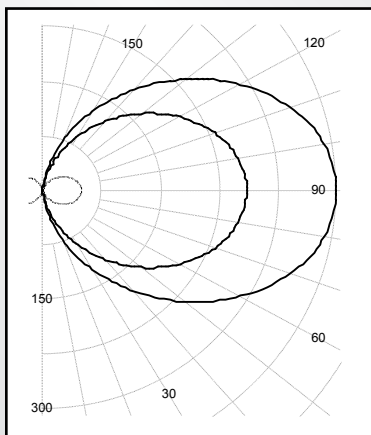

Zone	Lumens	% Lamps
0 - 30	19	1.7
0 - 40	50	4.6
0 - 60	182	16.8
60 - 90	360	33.2
0 - 90	542	50.0
90 - 180	542	50.0
0 - 180	1084	100.0

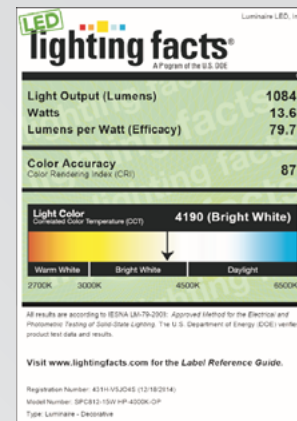

MODEL VPF84-50W-4000K-CP

Delivered Lumens: 5,215 Lumens

Total Power: 52.0W

Testing was performed in accordance with IES LM-79-08

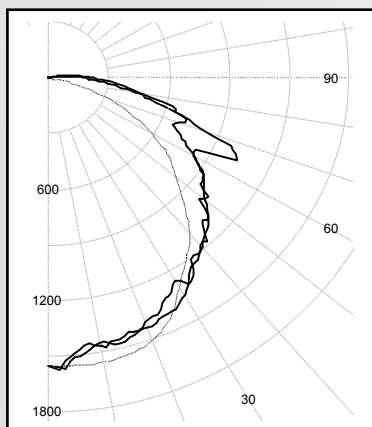

Zone	Lumens	% Lamps
0 - 30	1196	22.9
0 - 40	1974	37.9
0 - 60	3592	68.9
60 - 90	1484	28.5
0 - 90	5076	97.3
90 - 180	138	2.7
0 - 180	5215	100.0

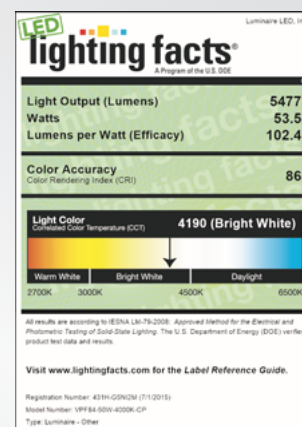

MOUNTING PLATE DETAILS

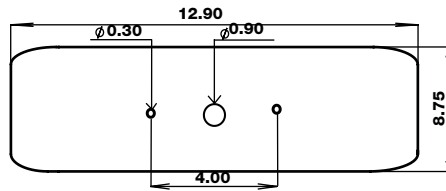
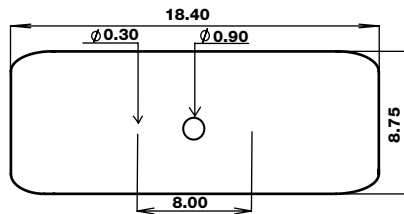
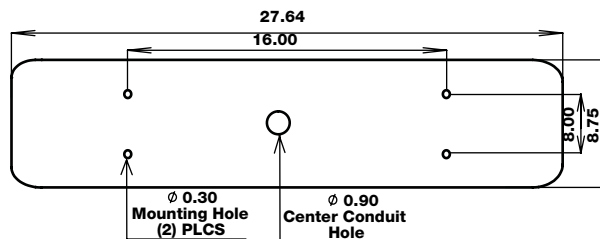
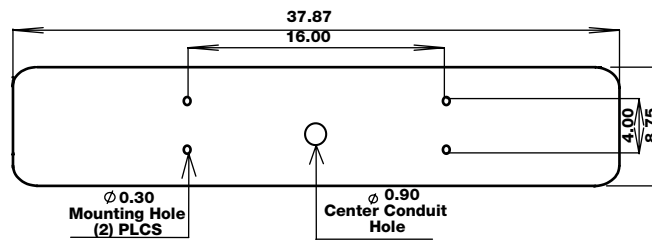
SPC812

SPC818

SPC824

SPC834

SPC846
