



WALL /CEILING MOUNT
LED

ANYX 17

ARV17 BRV17 XRV17 YRV17

Vandal Resistant

LED

Fixture Type

Date

Job Name

Approved By

Catalog Number

SPECIFICATIONS



Description	The Anyx 17 series features a durable, color-impregnated polycarbonate housing supported by a marine grade, die cast aluminum base plate to provide a lighting fixture that will survive in the harshest environments. The fixture has been installed successfully in large scale projects such as dorm rooms, unsecured hallways, transportation stations and public schools. Natatorium finish is standard for all versions of this fixture.
Trim	One piece injection molded UV stabilized polycarbonate mechanically interlocked to base plate and sealed against moisture and contaminants with two high temperature silicone O-rings. Color is molded through entire part for scratch resistant finish. Locked in place with one concealed tamper resistant set screw.
Lens	One piece injection molded UV stabilized prismatic polycarbonate with minimum 0.130" wall thickness. Available in Clear or Opal and secured to base plate by trim and silicone O-rings.
Reflector	Die formed heavy gauge specular aluminum, shaped for maximum efficiency.
Base Plate	Pressure die cast marine grade aluminum. Chemically primed and finished with electrostatically applied polyester powder coat.
Driver	Constant current drivers, 120-277V or 347V optional.
LED	Samsung LM561B+ @ 2700K, 3000K, 3500K, 4000K, 5000K and 82 CRI, wired in parallel-series. L ₇₀ projected life of over 130,000 hours at 50°C. Tested in accordance with LM-80. Ten year warranty on LED boards against operational defects.
Gaskets	Closed cell die cut neoprene gasket provided between fixture base plate and mounting surface. High temperature silicone O-ring between the trims and lens and between the lens and base plate.
Listings	U.L., C.U.L., Wet standard, 1598a Marine Listed.
Lifetime Warranty	Luminaire LED, Incorporated will repair or replace any fixture damaged due to vandalism for the lifetime of the installation.

DIMENSIONAL DATA

	A	B
ARV17	17.00	5.05
BRV17	17.00	5.05
XRV17	17.00	5.05
YRV17	17.00	5.05

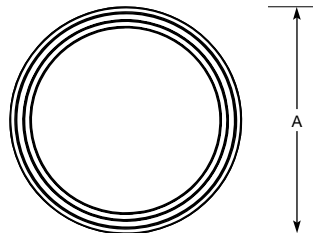

www.luminaireled.net

5 Sutton Place
P.O. Box 2162
Edison, NJ 08818

P. 732.549.0056
F. 732.549.9737



Luminaire LED Incorporated products are manufactured in the USA with components purchased from USA suppliers, and meet the Buy American requirements under the ARRA. Content of specification sheets is subject to change; please consult our website for current product information.

Rev: 04/19+

ORDERING INFORMATION

SERIES	LED	CCT	VOLTS	DRIVER	LENS	COLOR	OPTIONS		TX/SD
ARV17	25W	2700K	120-277	CC	CP	BLK	DIM	ALMR	
BRV17	40W	3000K	347	DIM	OP	WHT	PC	GLR	
XRV17	50W	3500K		PRD		BRZ	CAB	KO	
YRV17		4000K				GRY	OCC	EMB310	
		5000K				CUST	OCCFA	EMB125R	
							AMBNL	EMB250R	
	PRD - Specify Watts or Lumens Above						REDNL	EMB375R	

CC = Constant Current (Standard)

DIM = 0-10V Dimming, 10% at lowest level

PRD = Programmable driver. Specify Watts or Lumens under "LED" in Ordering Information.



OPTIONS

LENS	CP = Clear Prismatic Standard		OP = Opal Optional		
COLORS	BLK = Black	WHT = White	BRZ = Bronze	GRY = Gray	CUST = Custom Color (Consult Factory)
*PRD	Programmable driver. When ordering must specify Watts or Lumens. Consult factory for availability.				
DIM	0-10V dimming driver. 10% at lowest level.				
PC	Photoelectric switch (requires CAB option).				
CAB	Pressure die cast marine grade aluminum back box. Provided with (4) 1/2 " i.p.t. holes for conduit entry and (3) threaded plugs. Chemically primed and finished with electrostatically applied polyester powder coat.				
OCC	Microwave occupancy sensor mounted behind the lens. All LED boards sensed on/off. Consult factory for availability in select models.				
OCCFA	Microwave occupancy sensor mounted behind the lens. All LED boards sensed to dim to 50%, 30%, 20% or 10% field selectable low levels. Factory standard preset of 50% dimming level and 20 minute time out.				
AMBNL	Ring of Avago PLCC-4 Amber Series measured at 593nm, wired in parallel-series. Requires separately controlled circuit.				
REDNL	Ring of Avago PLCC-4 RED series measured at 621nm, wired in parallel-series. Requires separately controlled circuit.				
ALMR	Accessory metal ring that completely seals gap between mounting base and mounting surface. Anti-ligature for ceiling mount applications only.				
GLR	Fuse and fuse holder.				
KO	Add (3) i.p.t. holes to housing (Required CAB option).				
EMB310	800 lumen self contained, 90 minute emergency battery pack. 0°C (32°F) to 55°C (131°F). Not available in 347V. Meets CA Title 20 Standards.				
EMB125R	Stand-alone inverter that will operate a 125W maximum load for 90 minutes. 20°C (68°F) to 30°C (86°F). Not available in 347V.				
EMB250R	Stand-alone inverter that will operate a 250W maximum load for 90 minutes. 20°C (68°F) to 30°C (86°F). Not available in 347V.				
EMB375R	Stand-alone inverter that will operate a 375W maximum load for 90 minutes. 20°C (68°F) to 30°C (86°F). Not available in 347V.				
TX/SD	TORX® head bit.				



PHOTOMETRIC DATA

Model	Watts	Input Watts	Lens	Delivered Lumens				
				2700K	3000K	3500K	4000K	5000K
ARV17	25W	25.7W	OP	2156	2180	2225	2294	2362
ARV17	25W	25.7W	CP	2736	2766	2823	2911	2998
ARV17	40W	42.9W	OP	2873	2906	2965	3057	3146
ARV17	40W	42.9W	CP	3647	3688	3763	3880	3996
ARV17	50W	55.5W	OP	4031	4076	4160	4289	4417
ARV17	50W	55.5W	CP	5116	5173	5279	5443	5606
ARV17 HO	100W	111.2W	OP	7426	7517	7671	7901	8138
ARV17 HO	100W	111.2W	CP	9425	9540	9735	10027	10327
ARV17 HO	PRD			Specify Wattage or Delivered Lumens in Ordering Information				

MODEL ARV17- 25W - 4000K - CP IES FILE: ARV17- 25W - 4000K - CP

Delivered Lumens 2,696 Lumens

Total Power: 25.7W

Testing was performed in accordance with IES LM-79-08

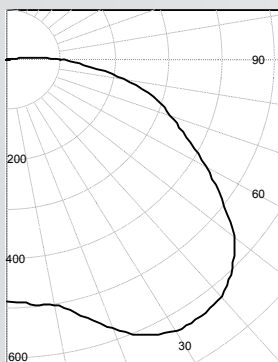

Zone	Lumens	% Lamps
0 - 30	482	17.9
0 - 40	877	32.5
0 - 60	1772	65.7
60 - 90	835	31.0
0 - 90	2607	96.7
90 -180	89	3.3
0 -180	2696	100.0

TRIM OPTIONS

ARV17



BRV17



XRV17



YRV17



MOUNTING PLATE DETAILS

ARV 17 BackBox w/KO

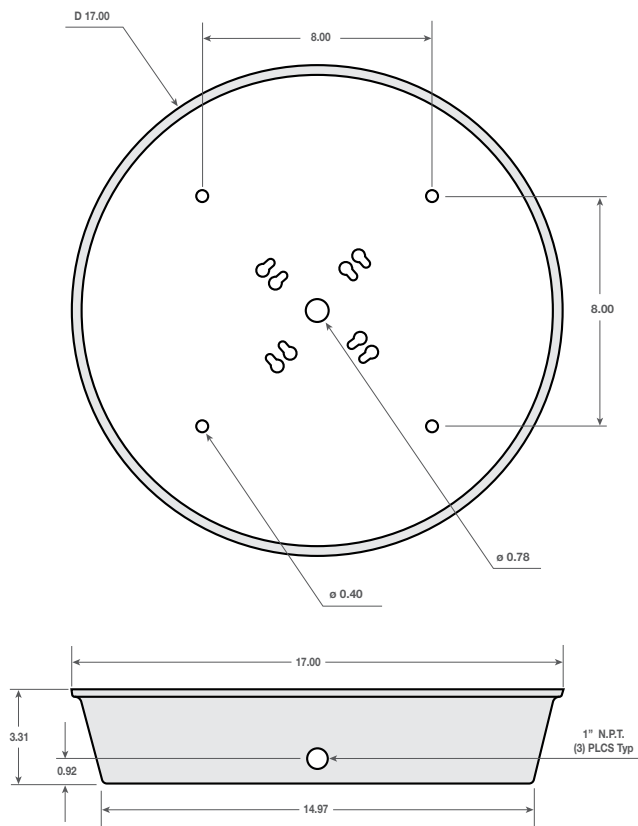

ARV17 Recessed Housing

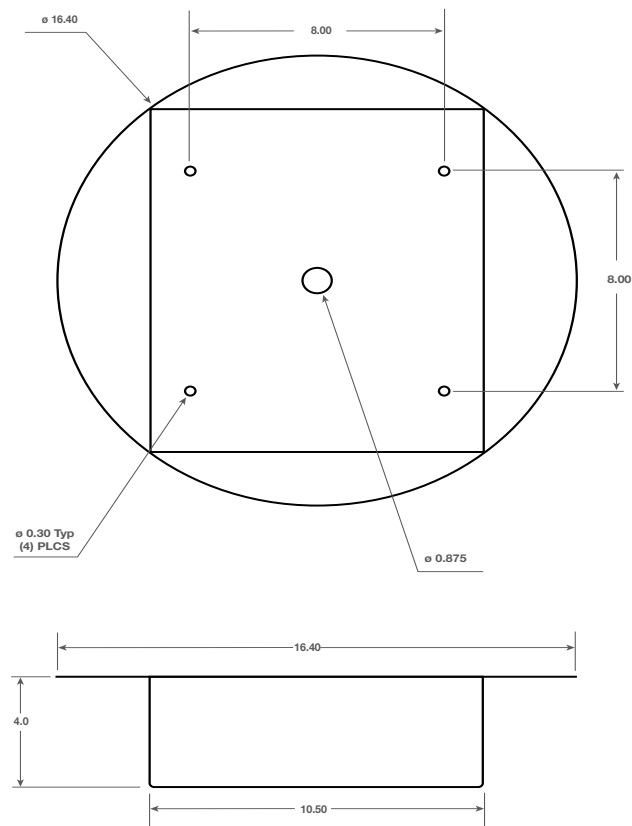

MOUNTING PLATE DETAILS

