

# Parts Diagram

Strive® Seating  
Sled Base Armless Chair

August 2019

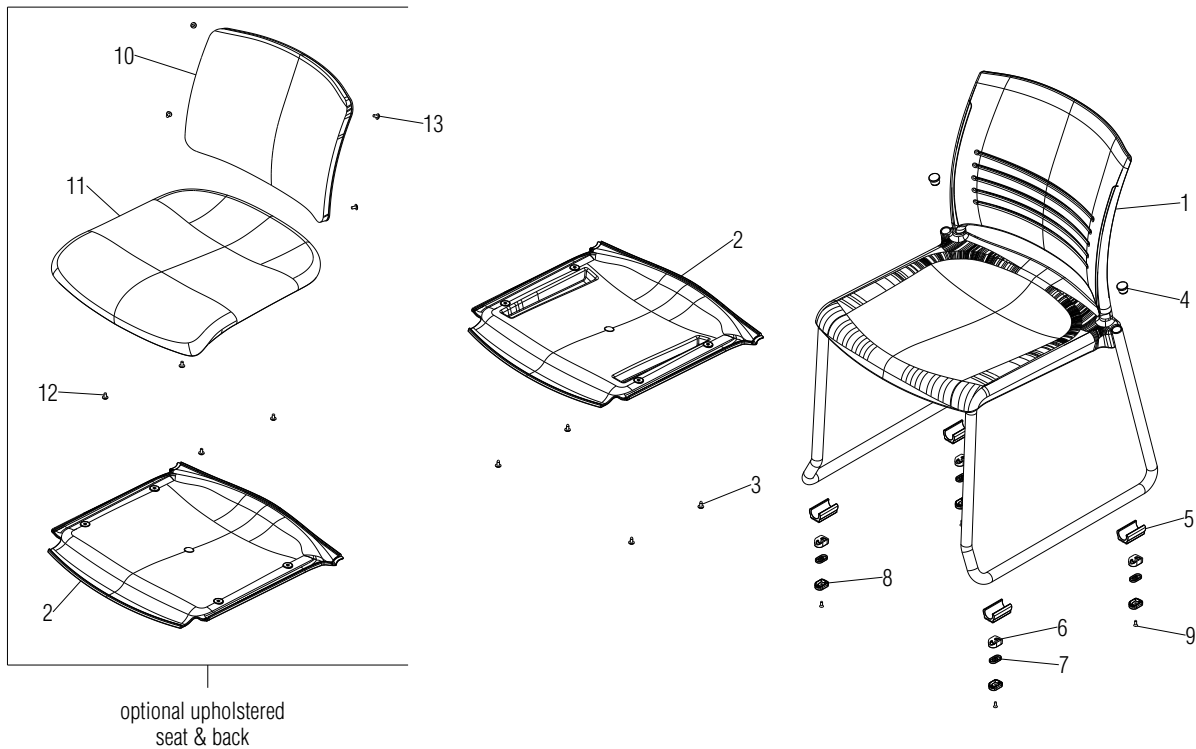

.XX = Select Color

Item 1 is a replacement chair that includes all parts (seat/back/frame are not servicable).

Item 5 is attached using PC.12.0583.X.

Item 7 (glide shoe) mates to Item 6 (glide housing) and is attached with PC.12.0583.X screw.

Item 8 is attached using 12.4016.X.

Item	Part Number	Item Description	Req Qty	Item	Part Number	Item Description	Req Qty
1	SRFP	Replacement Chair, Poly	1	6	06.0028.BL.X	Housing, Stainless Steel Glide	4
	SRFU	Replacement Chair, Upholstered Seat	1	7	PT.06.6034.X	Shoe, Stainless Steel Glide	4
	SRFB	Replacement Chair, Upholstered Seat & Back	1	8	PT.06.6029.BLX	Glide, Black Plastic	4
2	46.2240.BL.X	Shroud, Seat with Bumpers (poly chair)	1	9	PC.12.0583.X	Screw, #8 x 1/2" PH FH Type-B T/S (used on Items 5 & 6/7)	4
	46.2228.BL.X	Shroud, Seat (upholstered chair)	1		12.4016.X	Screw, #8 x 1/2" PPH Type 25 T/C ZC (used on Item 8)	4
3	12.0011.X	Screw, M6 x 18mm PPH BosScrew	4	10	STRBC	Assembly, Upholstered Backrest Cushion	1
4	53.6550.XX.X	Arm Cap, Plastic	2	11	STRRC	Assembly, Upholstered Seat Cushion	1
5	10.0127.X	Glide, Non-Skid (dual durometer)	4	12	12.0055.CZ.X	Screw, #10-16 x 1/2" Type AB T/F BLK ZC	4
				13	12.0111.XX.X	Screw, #10-24 x 3/8" PTH M/S ZC x/ PATCH	4