



Install Instruction

LOOP RECESSED + BATTERY PACK

1X2 | 2X2 | 1X4 | 2X4 | 6"X2 | 6"X4

ATTENTION:

This installation guide does not apply to Loop Recessed 1x1, 6"x1 and 6"x1.5. See their version installation document for instructions.

IMPORTANT SAFEGUARDS

When using electrical equipment, basic safety precautions should always be followed including the following:

READ AND FOLLOW ALL SAFETY INSTRUCTIONS

- Installation and servicing should be performed by qualified service personnel.
- Install in accordance with the National Electrical Code, Canadian Electrical Code, and any local regulations.
- A Constant/Unswitched AC source is required (120 through 277 VAC, 50 or 60 Hz).
- The Constant/Unswitched lead must be fed from the same branch circuit as the Switched lead.
- The maximum mounting height for emergency lighting purposes is 26 feet.
- The luminaire is not suitable for wet or hazardous locations.
- To reduce risk of electric shock, disconnect both the Switched (normal) and Constant/Unswitched (emergency charging) connections before servicing the luminaire.
- Do not attempt to service the battery. A sealed, no maintenance battery is used that is not field replaceable. Contact Fluxwerx for information on service.
- Do not install near gas or electric heaters.
- Equipment should be installed in locations and at heights where it will not be subjected to tampering by unauthorized personnel.
- The use of accessory equipment not recommended by the manufacturer may cause an unsafe condition.
- Do not use this equipment for other than its intended use.

SAVE THESE INSTRUCTIONS

IMPORTANT: All fixtures should be installed in accordance with national and local building and electrical codes.

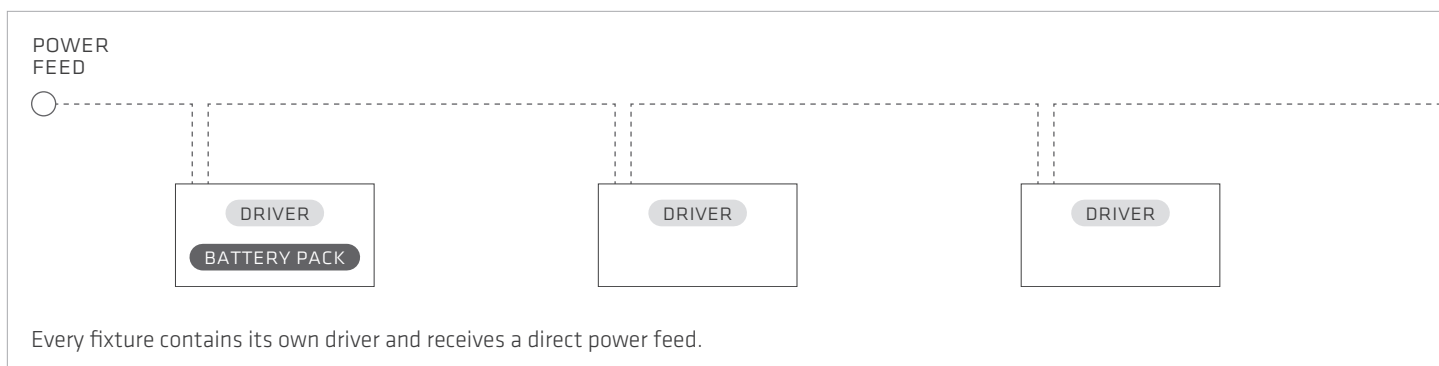

DRYWALL

If installing in DRYWALL, install the drywall flange kit first. Refer to separate drywall flange kit instruction sheet.



TOOLS + MATERIALS REQUIRED

Tools

- Phillips Screw Driver
- Screw Gun
- Pliers

Materials

- Wire Connectors
- #8 Sheet Metal Screw
- Hanger Wire

INSTALLATION

1A BEND MOUNTING TAB

Loop 1x2, 2x2, 1x4, 2x4

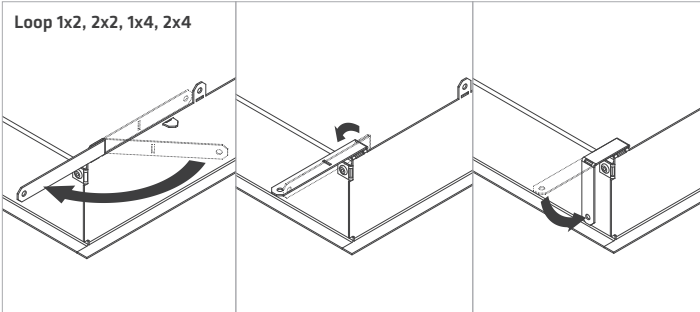

Bend mounting tab as shown.

1B BEND MOUNTING TAB

Loop 6"x2, 6"x4

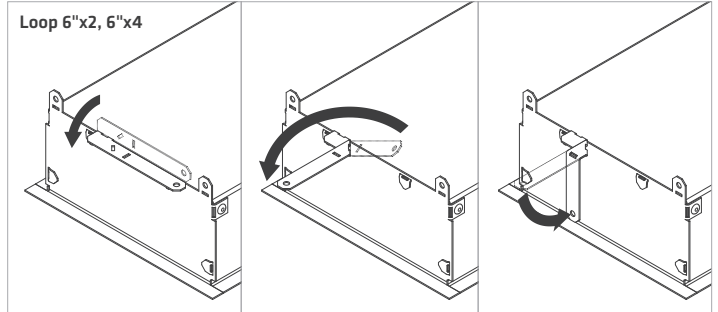

Bend mounting tab as shown.

2 POSITION ON T-GRID

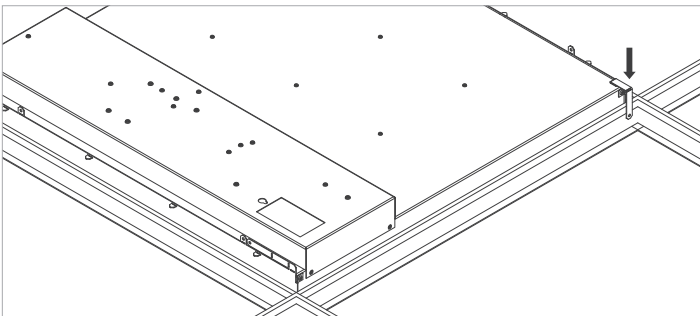

Lay fixture into T-grid.

3 ATTACH TO GRID STRUCTURE

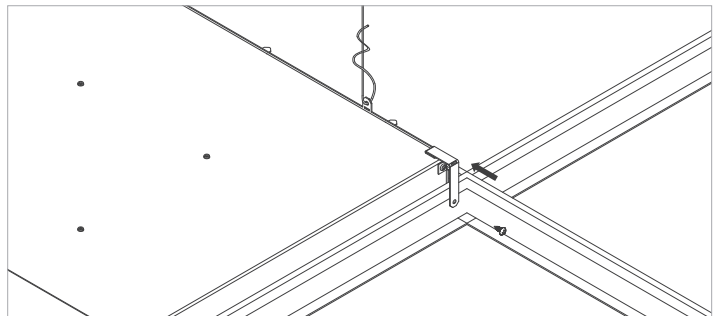

Use a #8-1/4" sheet metal screw to fasten fixture to T-grid and use a hanger wire to tie off appropriately in accordance with local building codes (screws and hanger wires supplied by others).

4 MAKE ELECTRICAL CONNECTIONS

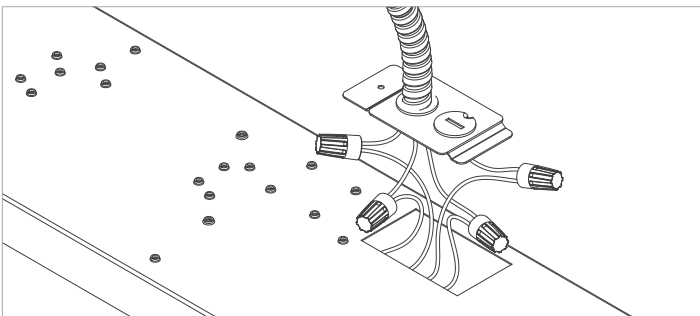

Make all electrical connections to the fixture.

NOTES:

1. Wire 0-10V DC dimming leads as Class 1
2. For flex whip option, see Step 5
3. Ensure **constant**/unswitched lead is fed from the same branch circuit as the **switched** lead

5 OPTIONAL FLEX WHIP

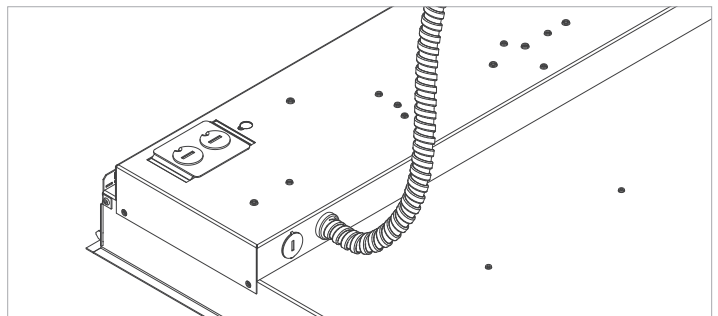

Optional flex whip pre-installed. Complete electrical connections in accordance with local building codes.

6 EMERGENCY DRIVER CHECK

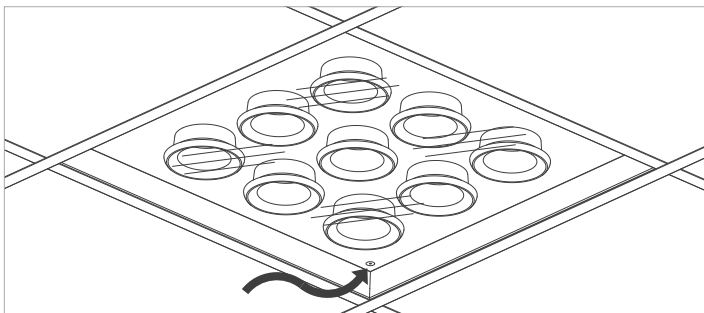

1. Energize branch circuit
2. Ensure charge indicator light is lit
3. Allow batteries to charge for at least 1 hour for quick test
4. Press test button + confirm luminaire lights after switching to battery power

NOTE: The batteries must be charged for at least 24 hours before conducting a long-term test

7 REMOVE PROTECTIVE FILM

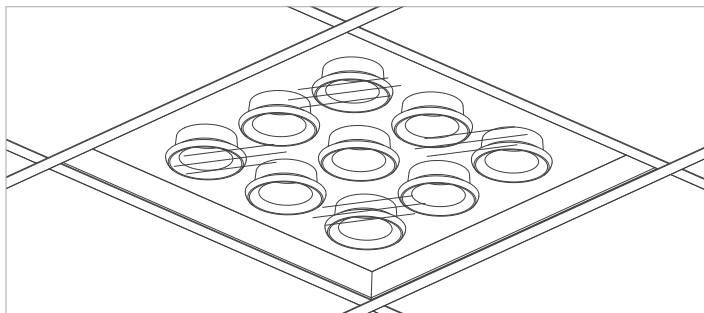

Remove dust protection film from the fixture after all building furnishing is complete.

OPERATION

When the circuit is energized, the charging indicator light is illuminated, indicating the batteries are being charged. When power fails, the internal emergency driver automatically switches to emergency battery power. The emergency driver will operate the luminaire at over 1400 lumens output for a minimum of 90 minutes. When the circuit power is restored, the emergency driver returns to charging mode.

MAINTENANCE

Although no routine maintenance is required to keep the emergency luminaire functional, it should be checked periodically to ensure that it is working. The following schedule is recommended:

1. Visually inspect the charging indicator light monthly. It should be illuminated. If the charging indicator is flashing, contact Fluxwerx.
2. Test the emergency operation of the luminaire at 30-day intervals for a minimum of 30 seconds by depressing the test switch. The luminaire should switch to battery operation and illuminate.
3. Conduct a 90-minute discharge test once a year by de-energizing the lighting circuit. The emergency luminaire should be illuminated for a minimum of 90 minutes.

TROUBLE SHOOTING + REPLACEMENT

*** Servicing should be performed by qualified service personnel ***

If the luminaire fails to light during an emergency test, the battery-driver may need replacing. De-energize both the Constant/Unswitched and Switched circuits.

Contact Fluxwerx for replacement battery-driver, NOT Philips Bodine. To replace the battery-driver, first disconnect the single white barrel connector, then disconnect the battery-driver cable harness. Unscrew the battery-driver. Re-assemble in reverse order. The batteries are Nickel-Cadmium rechargeable batteries and must be recycled or disposed of properly, per local regulations.



Ni-Cd

IMPORTANT

THIS PRODUCT CONTAINS NICKEL-CADMIUM RECHARGEABLE BATTERIES.
BATTERIES MUST BE RECYCLED OR DISPOSED OF PROPERLY.