

Install Instruction

LOOP RECESSED LED

1X2 | 2X2 | 1X4 | 2X4 | 6"X2 | 6"X4

ATTENTION:

This installation guide does not apply to Loop Recessed 1x1, 6"x1 and 6"x1.5. See their version installation document for instructions.

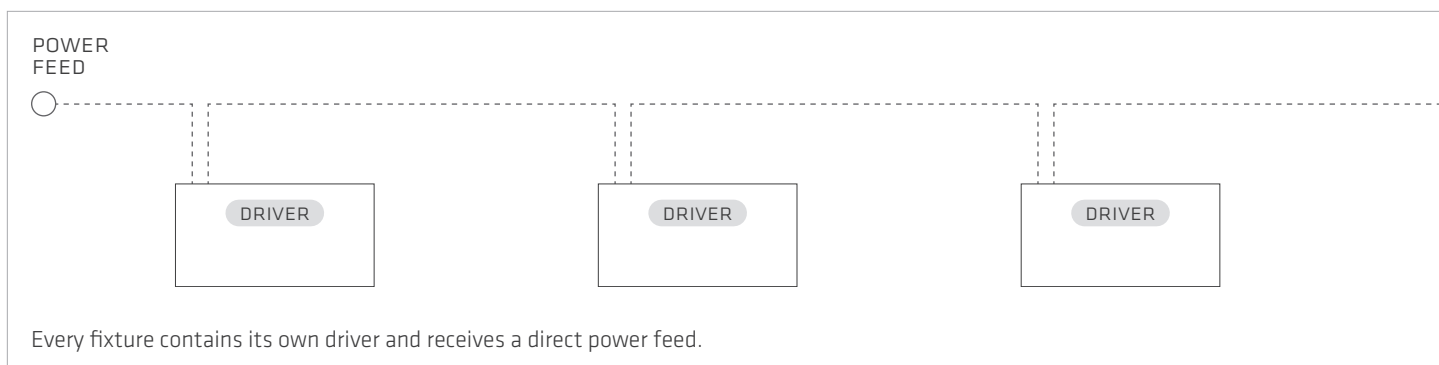

DRYWALL

If installing in DRYWALL, install the drywall flange kit first. Refer to separate drywall flange kit instruction sheet.



TOOLS + MATERIALS REQUIRED

Tools

- Phillips Screw Driver
- Screw Gun
- Pliers

Materials

- Wire Connectors
- #8 Sheet Metal Screw
- Hanger Wire

INSTALLATION

1A BEND MOUNTING TAB

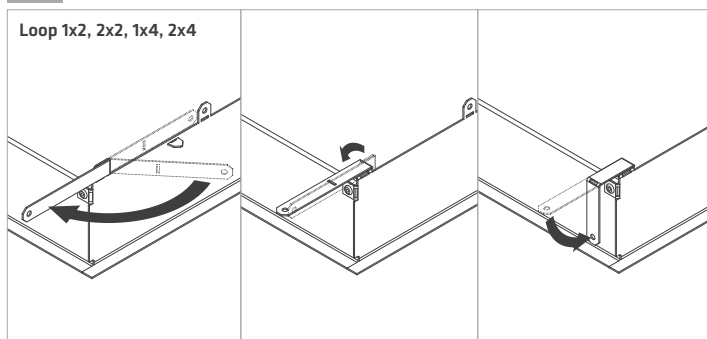

Bend mounting tab as shown.

1B BEND MOUNTING TAB

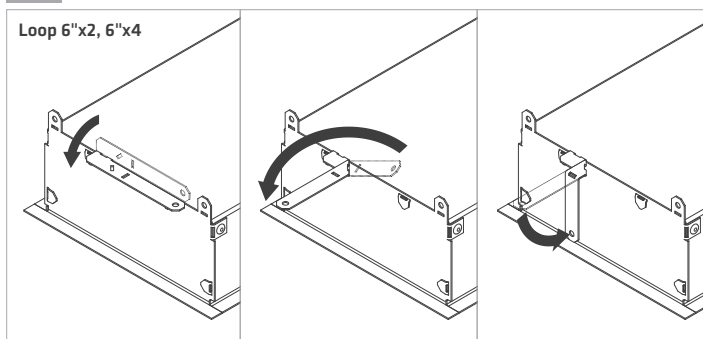

Bend mounting tab as shown.

2 POSITION ON T-GRID / FLANGE KIT

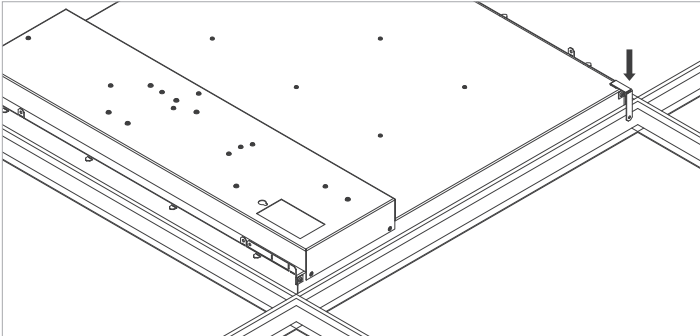

Lay fixture into T-grid or drywall flange kit.

3 ATTACH TO BUILDING STRUCTURE

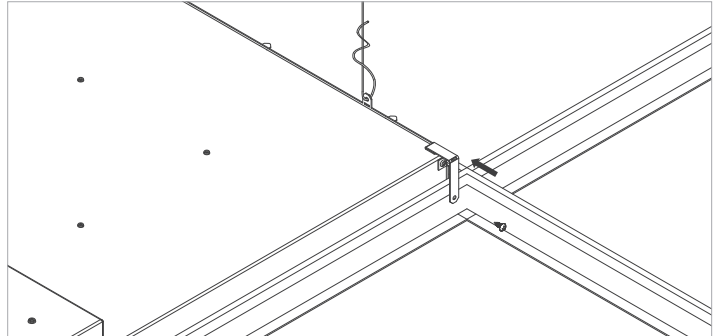

Use a #8-1/4" sheet metal screw to fasten fixture to T-grid or flange kit and use a hanger wire to tie off appropriately in accordance with local building codes (screws and hanger wires supplied by others).

4 MAKE ELECTRICAL CONNECTIONS

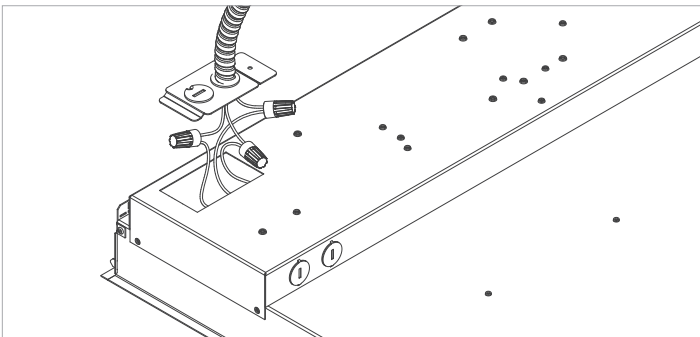

Make all electrical connections to the fixture.

NOTE:

1. Wire 0-10VDC Dimming Leads as Class 1
2. For flex whip option, see Step 5

5 OPTIONAL FLEX WHIP

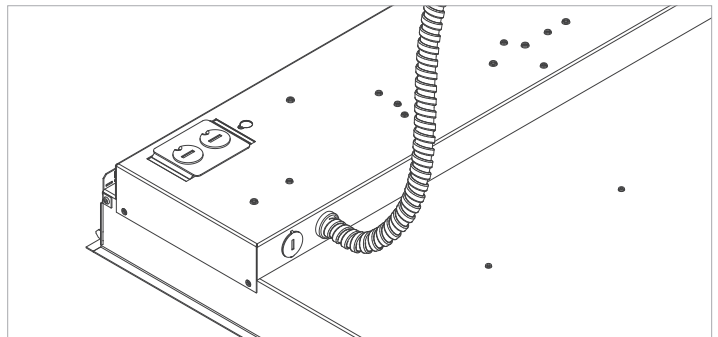

Optional flex whip pre-installed. Complete electrical connections in accordance with local building codes.

6 REMOVE PROTECTIVE FILM

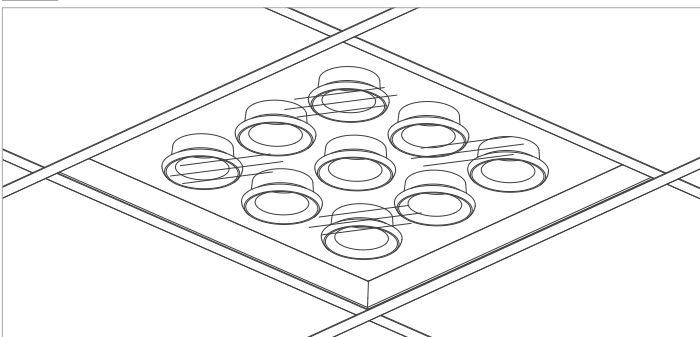

Remove dust protection film from the fixture after all building furnishing is complete.