

**NOTE:**

Two people are recommended for the assembly of Workwall. Make sure to assemble Workwall on a clean, padded surface to avoid any scratches or damage to any of the parts.

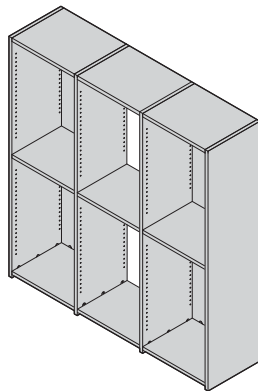

**3 Unit**

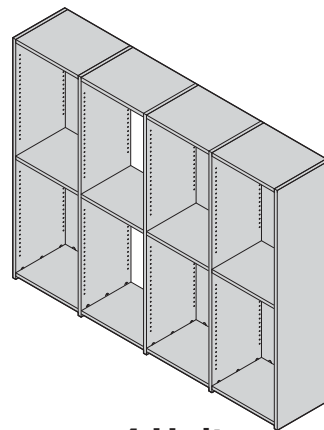

**4 Unit**

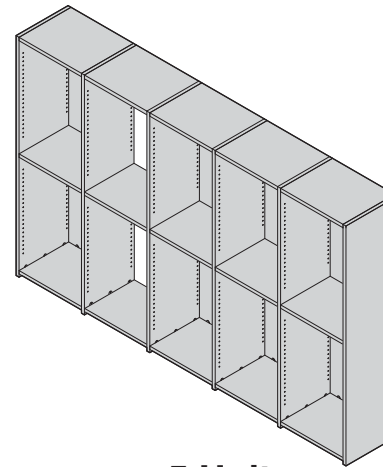

**5 Unit**

**NOTE:**

Workwall can be used as a divider with doors on either side of the unit.

**NOTE:**

Make sure the assembly has been completed before removing all of the E, B, I, MC, ect. stickers from the surfaces of all the parts.

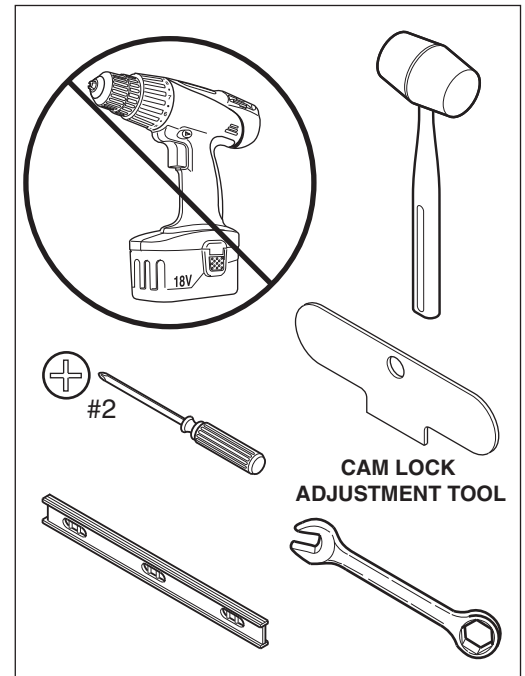

**TOOLS FOR INSTALLING A 3" GROMMET ONLY**

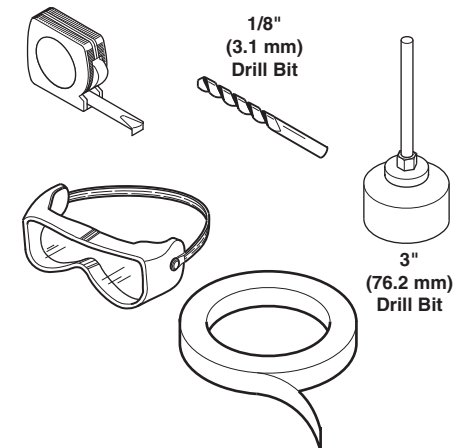

If you have a problem, question, or request, call your local dealer, or Steelcase Line 1 at **888.STEELCASE** (888.783.3522) for immediate action by people who want to help you. (Outside the U.S.A., Canada, Mexico, Puerto Rico, and the U.S. Virgin Islands, call: 1.616.247.2500) Or visit our website: [www.steelcase.com](http://www.steelcase.com)

© 2012 Steelcase Inc.  
Grand Rapids, MI 49501  
U.S.A.

Printed in U.S.A.

## Components

Letter	Description
E	End Panel
B	Back Panel
I	Inner Panel
T	Top Shelf
MC	Middle Shelf, Closed
LC	Lower Shelf, Closed
MO	Middle Shelf, Open
LO	Lower Shelf, Open
A	Adjustable Shelf

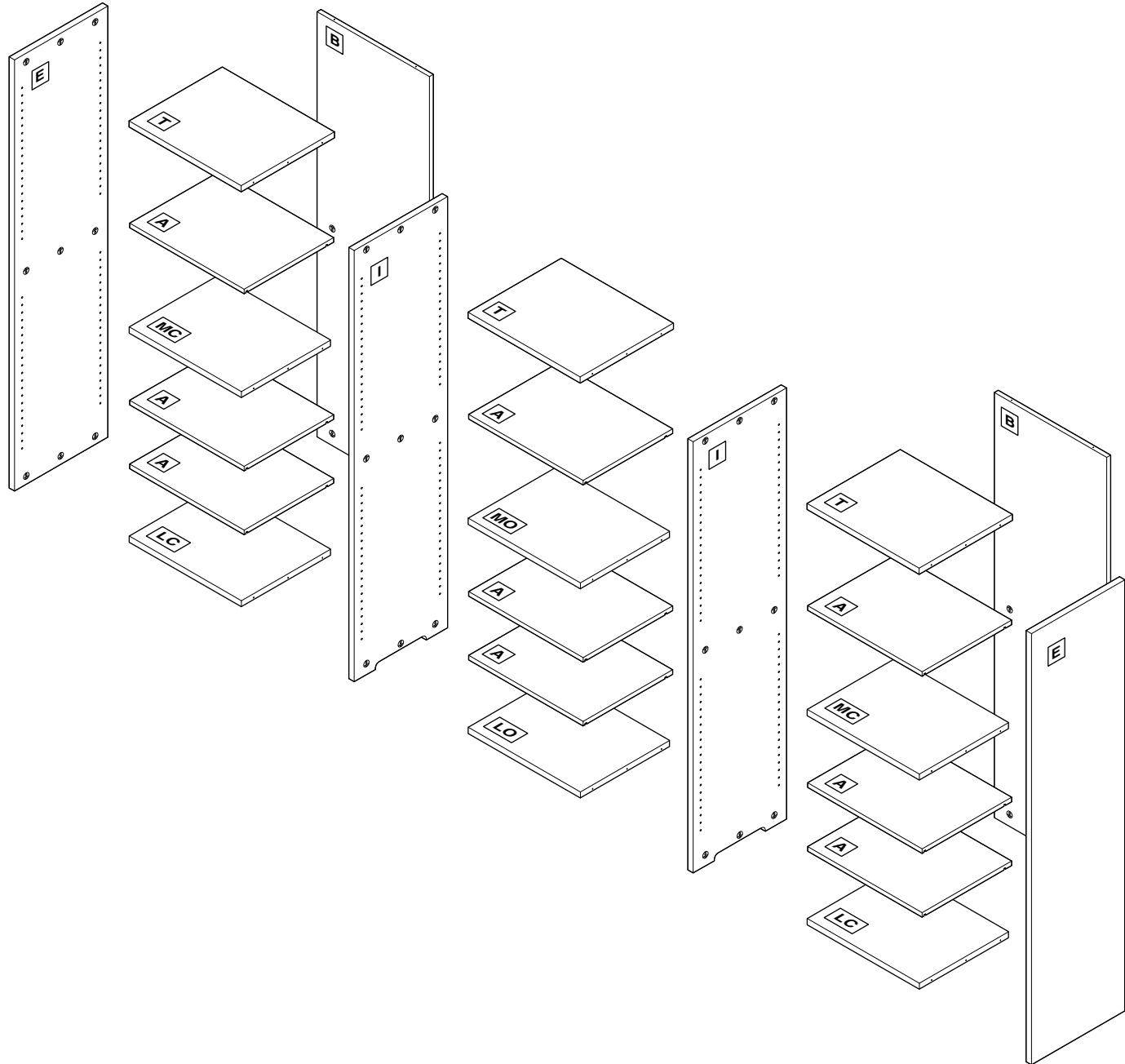

## (Tips for Proper Alignment of Parts)

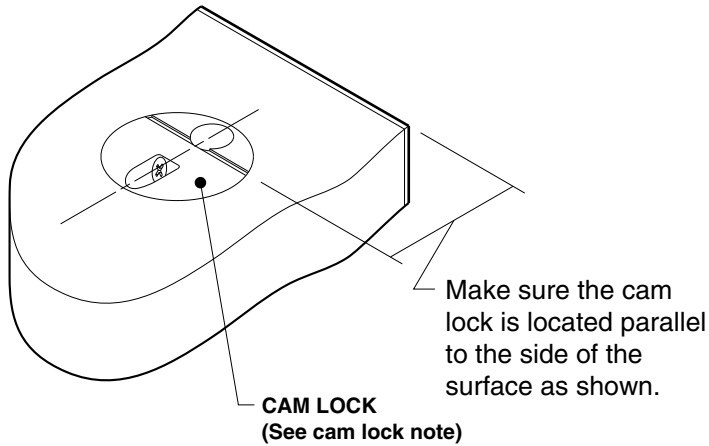

### CAM LOCK NOTE:

If cam lock is installed high on the surface, tap it down flush with the surface. If that doesn't work, replace part.

If cam lock is installed low into the surface, screw cam pin out to extend the length of the cam pin.

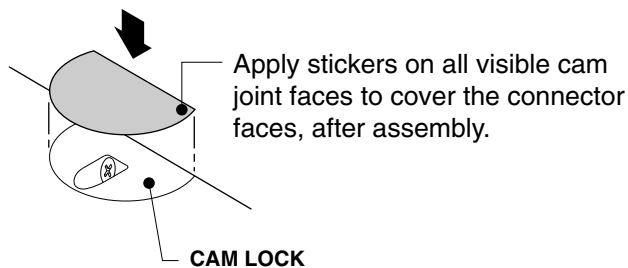

**NOTE:** When assembly has been **completed**, make sure to remove all of the E, B, I, ect. stickers from the surfaces of all the parts.

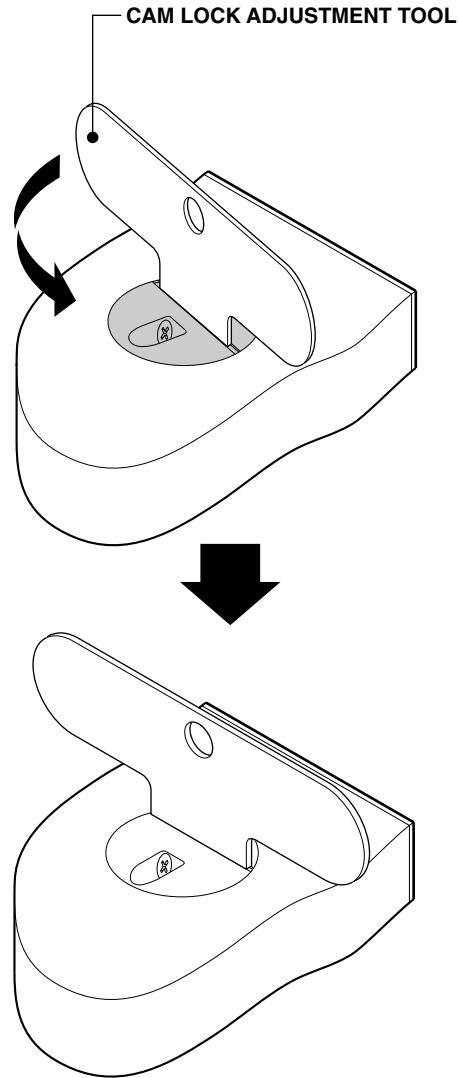

Use mallet, before tightening cam screws, to bring parts together and avoid light leaks.

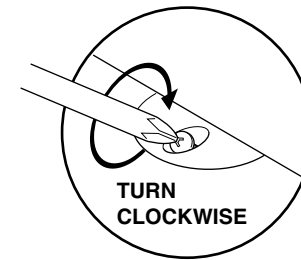

**Fasten Cam Locks**  
(The cam lock screw needs to be turned 3/4 full turn or 270° clockwise for complete engagement.)

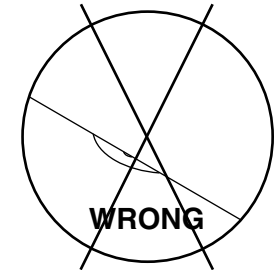

If the cam lock screw is not visible, you have installed the panel/shelf wrong and you need to turn the panel/shelf 180°.

**NOTE:** The cam pin is offset and needs to be installed on the shorter offset side. If the screw heads are not visible, turn the panel/shelf 180°.

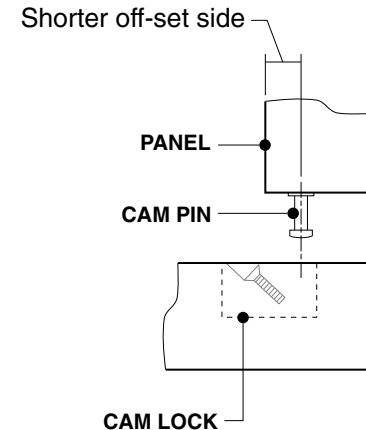

## 3 Opening Unit

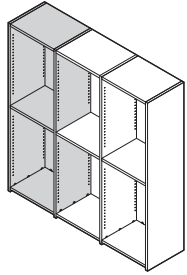

**NOTE:** Assemble as close to assembled units final desired location to avoid moving a heavy unit.

**NOTE:** Before assembling each part, please make sure cams are parallel to the side of the surface & pins are nicely screwed with the collar touching the edge of the part. (See page 3 for proper alignment of parts)

Use mallet, before tightening cam screws, to bring parts together and avoid light leaks.

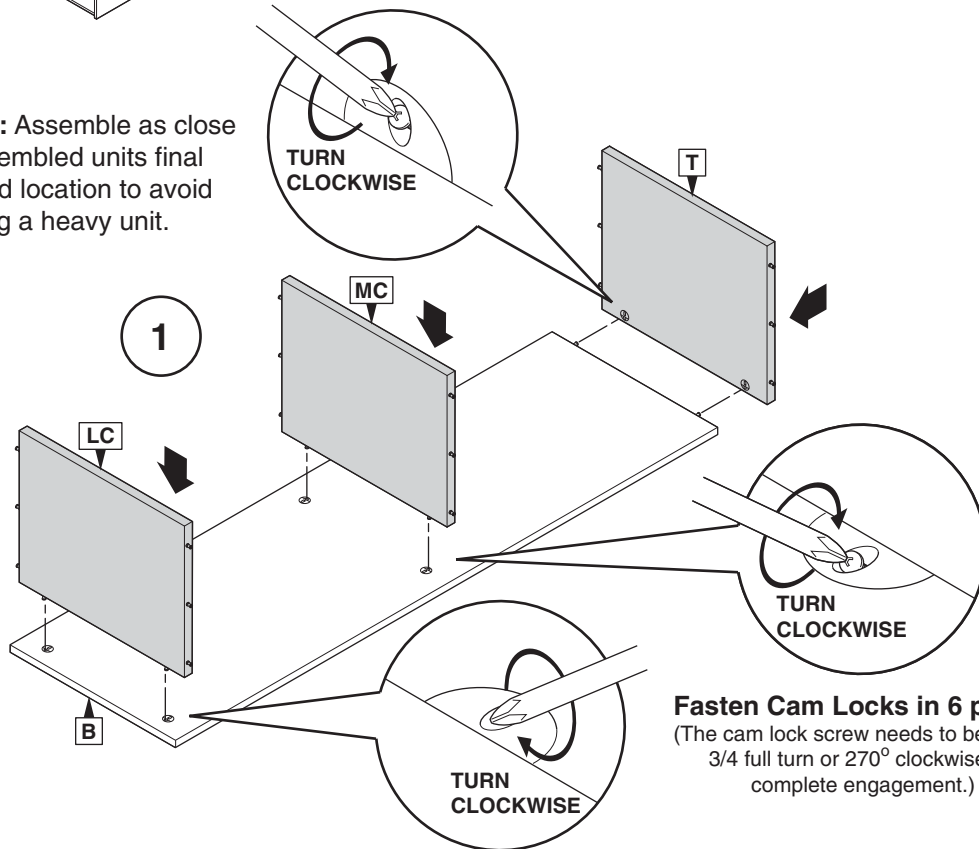

**Fasten Cam Locks in 6 places**  
(The cam lock screw needs to be turned 3/4 full turn or 270° clockwise for complete engagement.)

Cam locks can be seen on the topside of the bottom shelf when installing the bottom shelf.

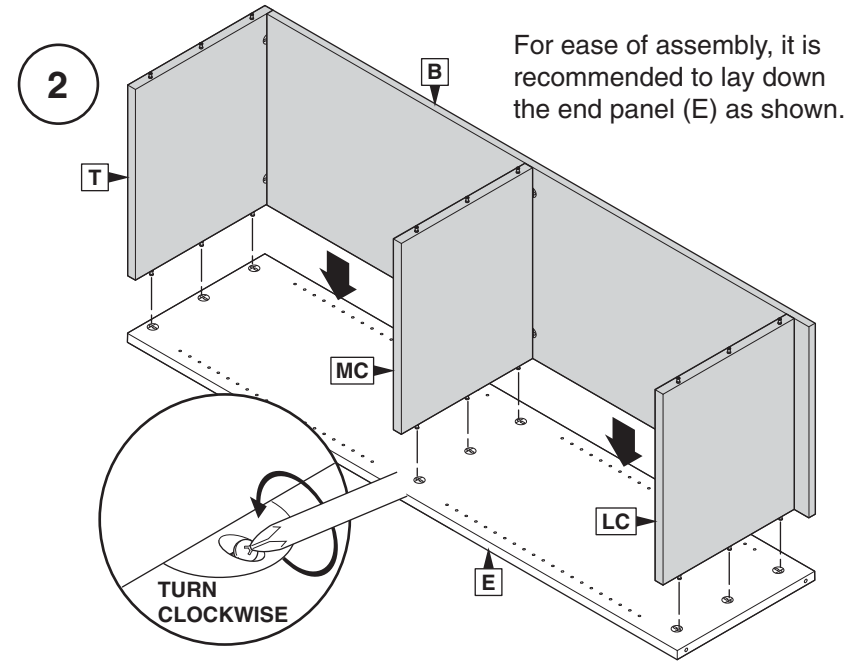

**Fasten Cam Locks in 9 places**  
(The cam lock screw needs to be turned 3/4 full turn or 270° clockwise for complete engagement.)

For ease of assembly, it is recommended to lay down the end panel (E) as shown.

**NOTE:** Before assembling each part, please make sure cams are parallel to the side of the surface & pins are nicely screwed with the collar touching the edge of the part. (See page 3 for proper alignment of parts)

Use mallet, before tightening cam screws, to bring parts together and avoid light leaks.

**NOTE:** Please adjust glides for leveling after assembling each sub unit (each opening).

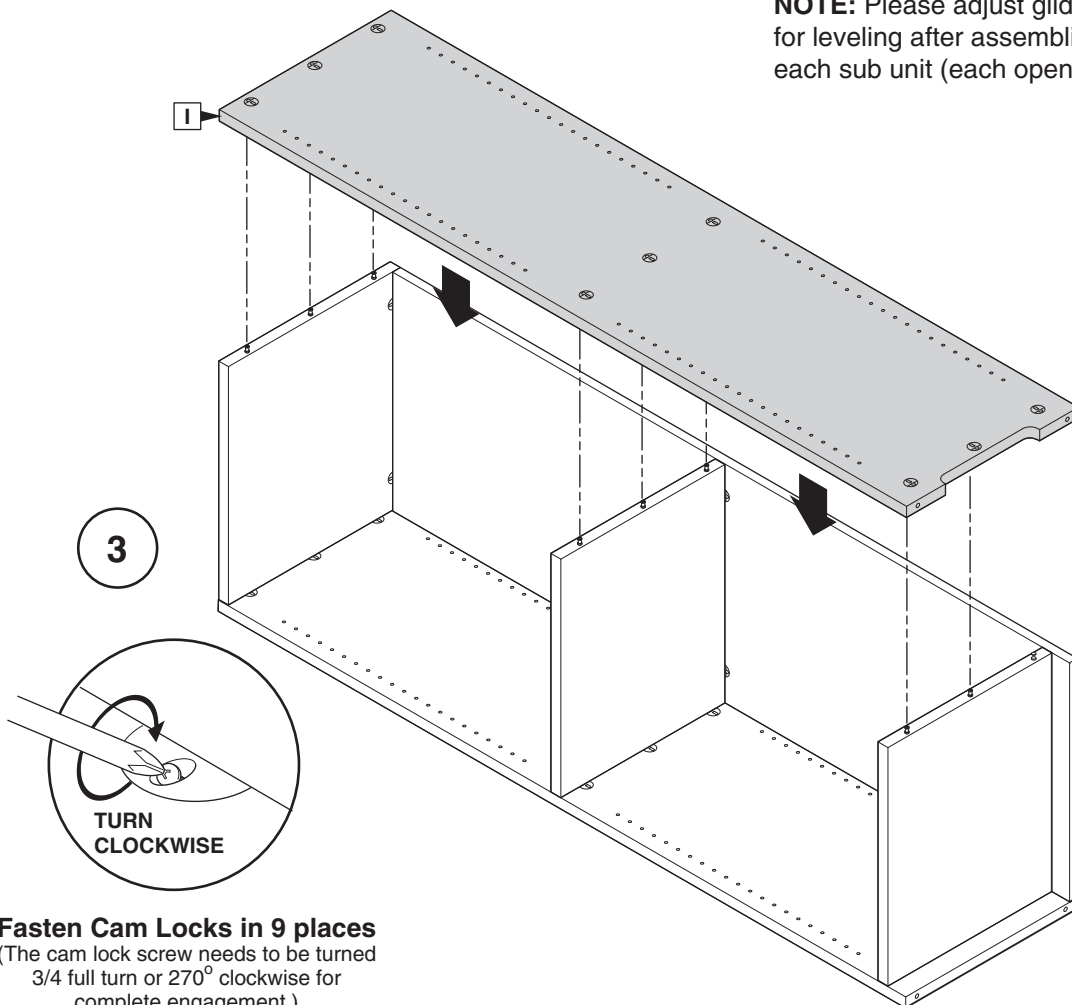
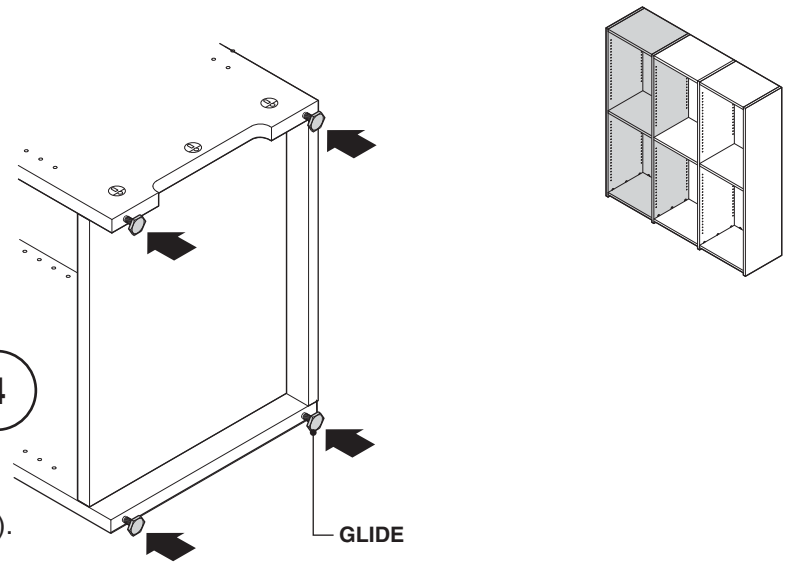

**Fasten Cam Locks in 9 places**  
(The cam lock screw needs to be turned 3/4 full turn or 270° clockwise for complete engagement.)

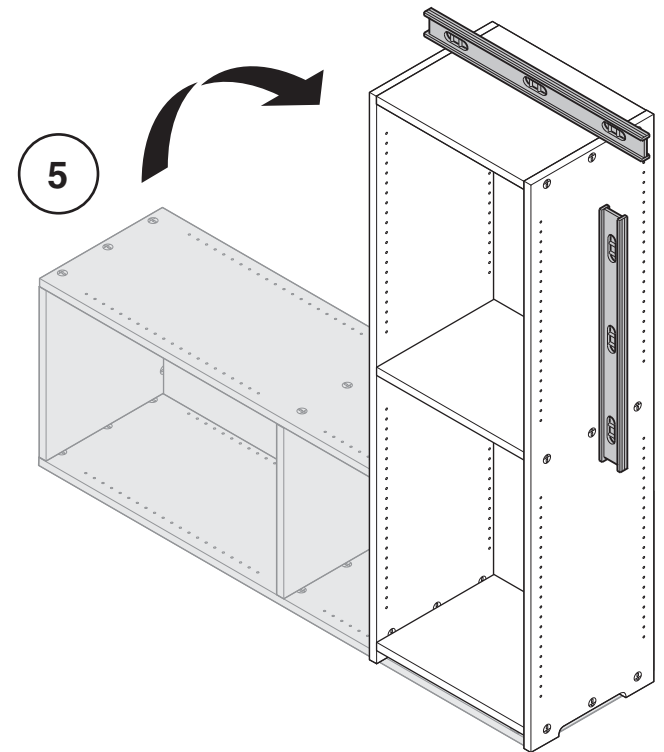

**NOTE:** Before assembling each part, please make sure cams are parallel to the side of the surface & pins are nicely screwed with the collar touching the edge of the part.  
(See page 3 for proper alignment of parts)

Use mallet, before tightening cam screws, to bring parts together and avoid light leaks.

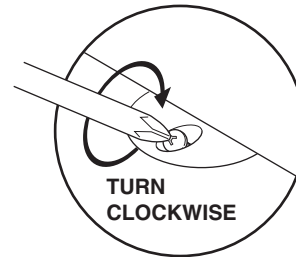

**Fasten Cam Locks in 9 places**  
(The cam lock screw needs to be turned 3/4 full turn or 270° clockwise for complete engagement.)

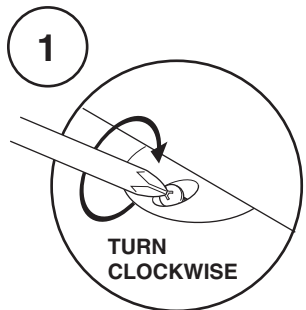

**Fasten Cam Locks in 9 places**  
(The cam lock screw needs to be turned 3/4 full turn or 270° clockwise for complete engagement.)

**NOTE:** Please adjust glides for leveling after assembling each sub unit (each opening).

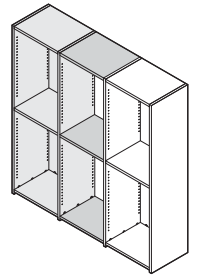
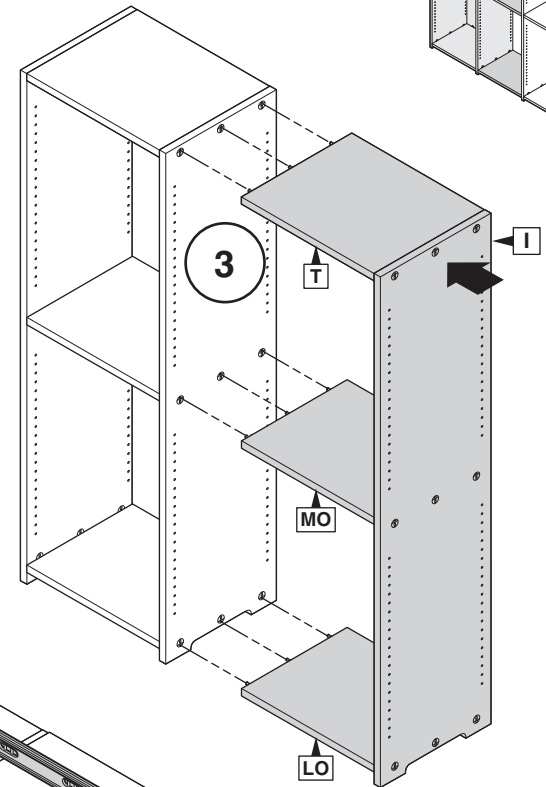
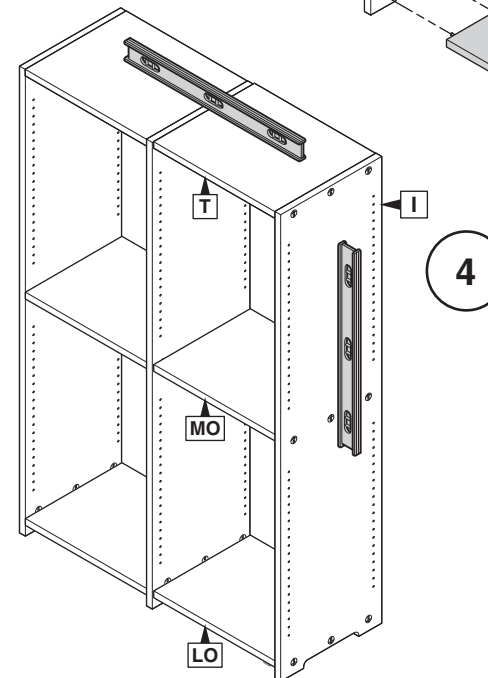
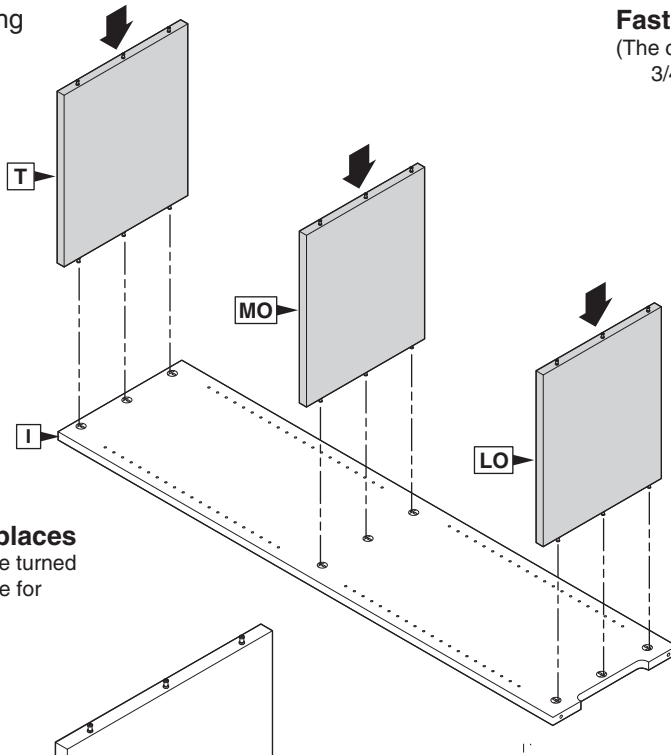
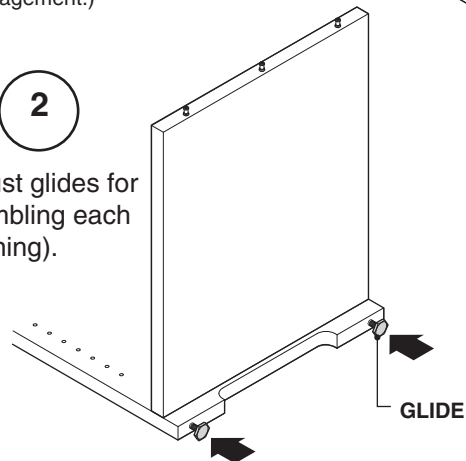

**NOTE:** Before assembling each part, please make sure cams are parallel to the side of the surface & pins are nicely screwed with the collar touching the edge of the part.  
(See page 3 for proper alignment of parts)

Use mallet, before tightening cam screws, to bring parts together and avoid light leaks.

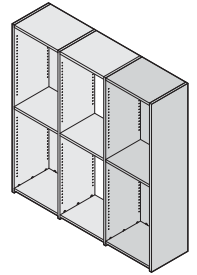

2

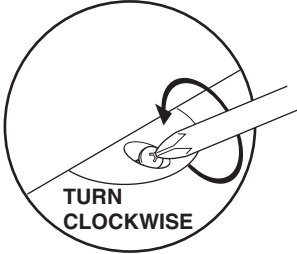

**Fasten Cam Locks in 9 places**  
(The cam lock screw needs to be turned 3/4 full turn or 270° clockwise for complete engagement.)

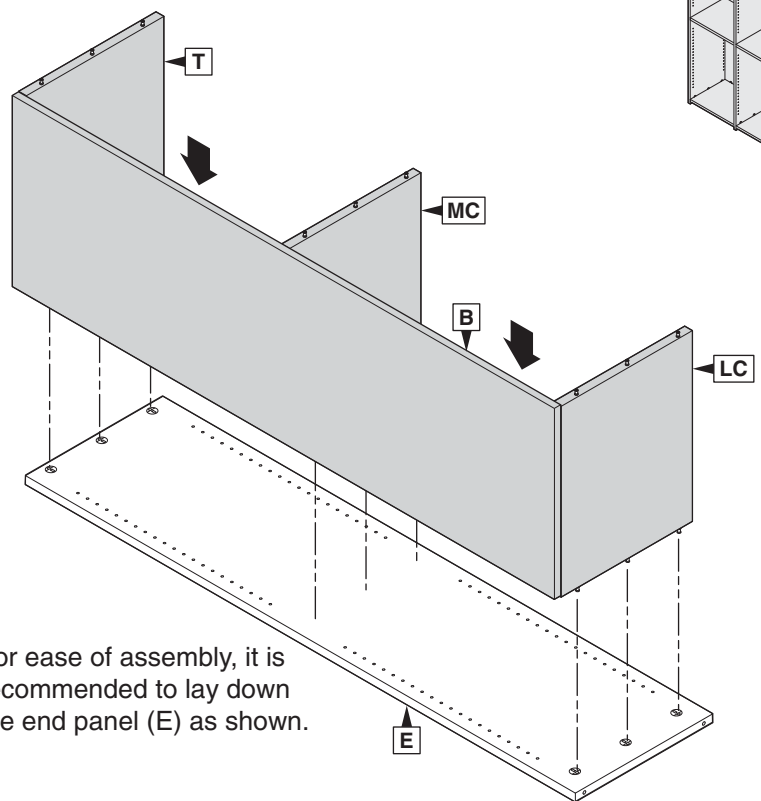

For ease of assembly, it is recommended to lay down the end panel (E) as shown.

1

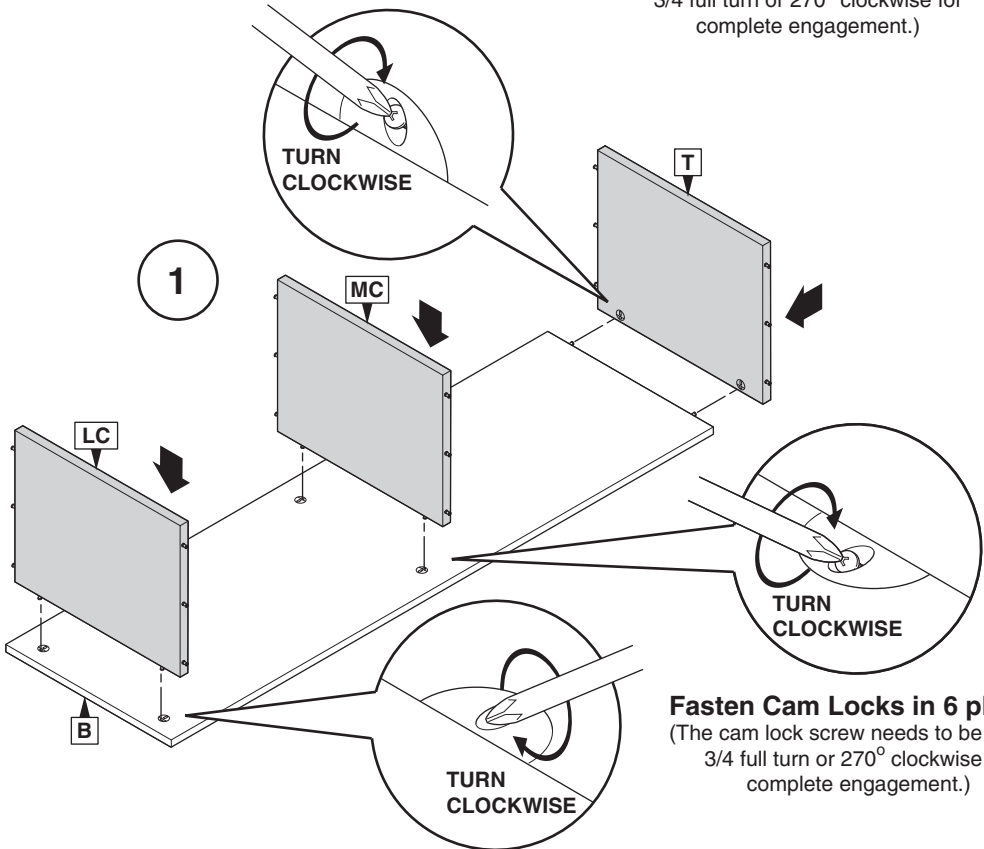

**Fasten Cam Locks in 6 places**  
(The cam lock screw needs to be turned 3/4 full turn or 270° clockwise for complete engagement.)

Cam locks can be seen on the topside of the bottom shelf when installing the bottom shelf.

3

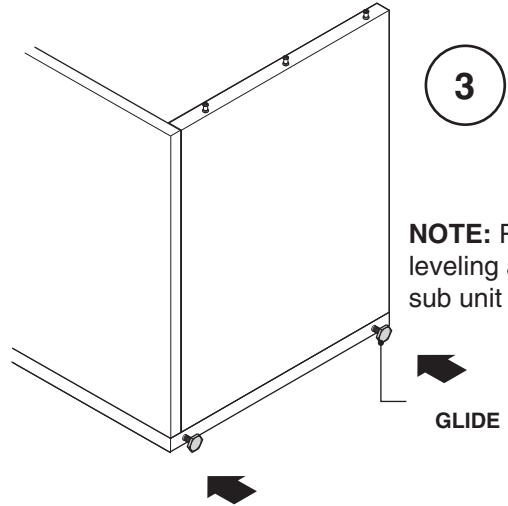

**NOTE:** Please adjust glides for leveling after assembling each sub unit (each opening).

**NOTE:** Before assembling each part, please make sure cams are parallel to the side of the surface & pins are nicely screwed with the collar touching the edge of the part. (See page 3 for proper alignment of parts)

Use mallet, before tightening cam screws, to bring parts together and avoid light leaks.

For optional items, please refer to the following:

**Adjustable Shelf Installation,**  
See page 9

**Moving a Back Panel from one Opening to Another,**  
See page 10 and 11

**Grommet Installation,**  
See page 12

**36" Door, 72" Door and Bar Pull Installation,**  
See Assembly Direction 939500262

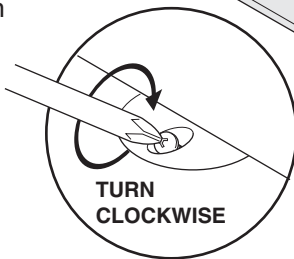

**Fasten Cam Locks in 6 places**  
(The cam lock screw needs to be turned 3/4 full turn or 270° clockwise for complete engagement.)

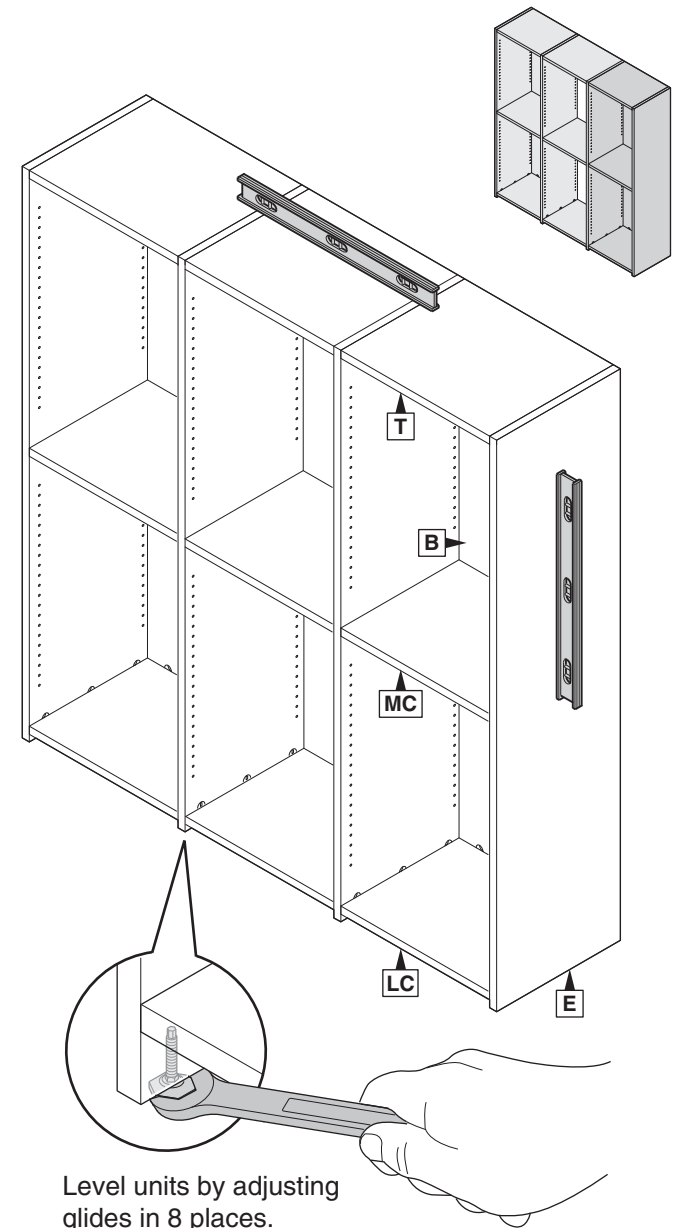
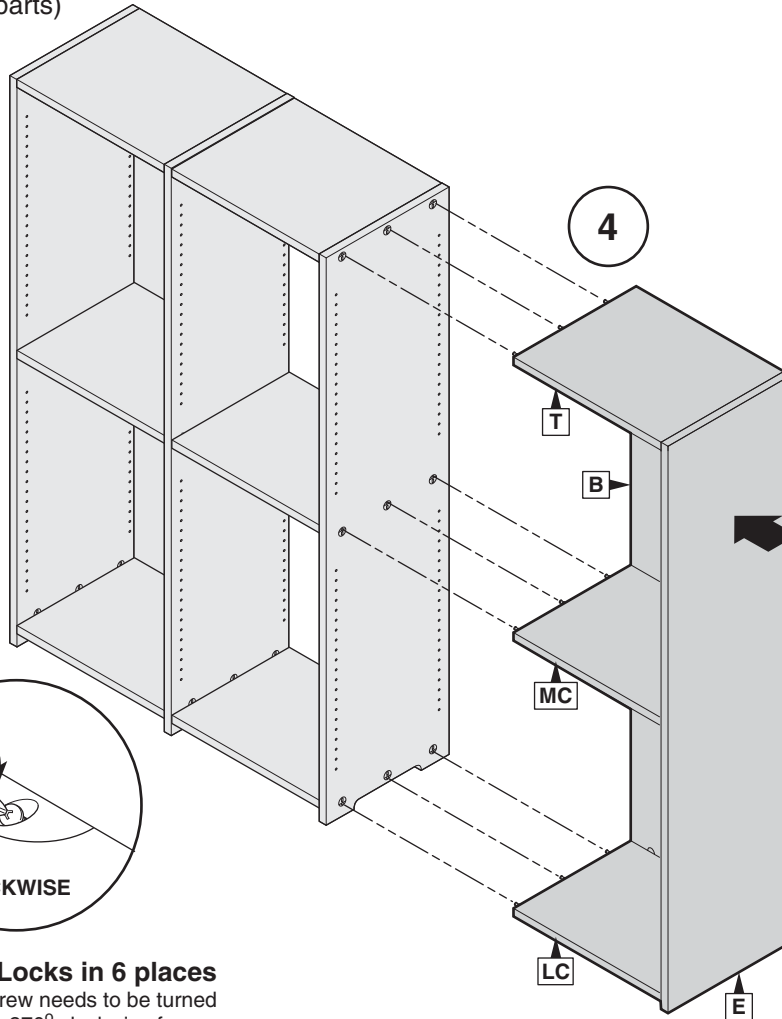

**NOTE:** When assembly has been **completed**, make sure to remove all of the E, B, I, ect. stickers from the surfaces of all the parts.

## Adjustable Shelf Installation

**NOTE:** The following is applicable to all scenarios. 3 unit is shown as an example.

- 1.** Insert shelf pins into side of wall. Repeat for other side.
- 2.** Before inserting shelf into unit, there are notches on the underside of the shelf which the pin fits into.
- 3.** Insert shelf.

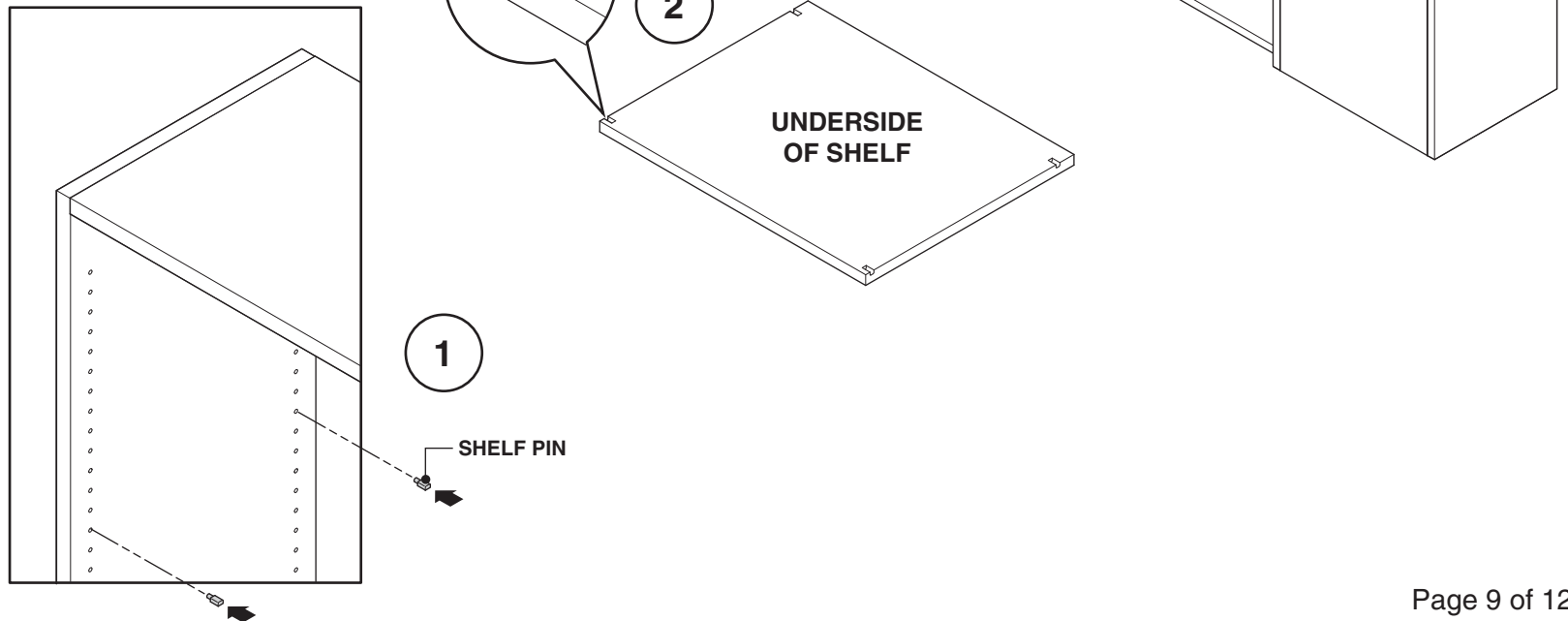

## Moving a Back Panel from one Opening to Another

**NOTE:** The following is applicable to all scenarios. 3 opening unit is shown as an example. All three (3) fixed shelves can be rotated 180° and the back panel can be installed on the other side.

**1.** In this scenario, panel B is being moved (1a). To begin to remove the panel, proceed to the other side of the unit and loosen the cam locks in six (6) places (1b).

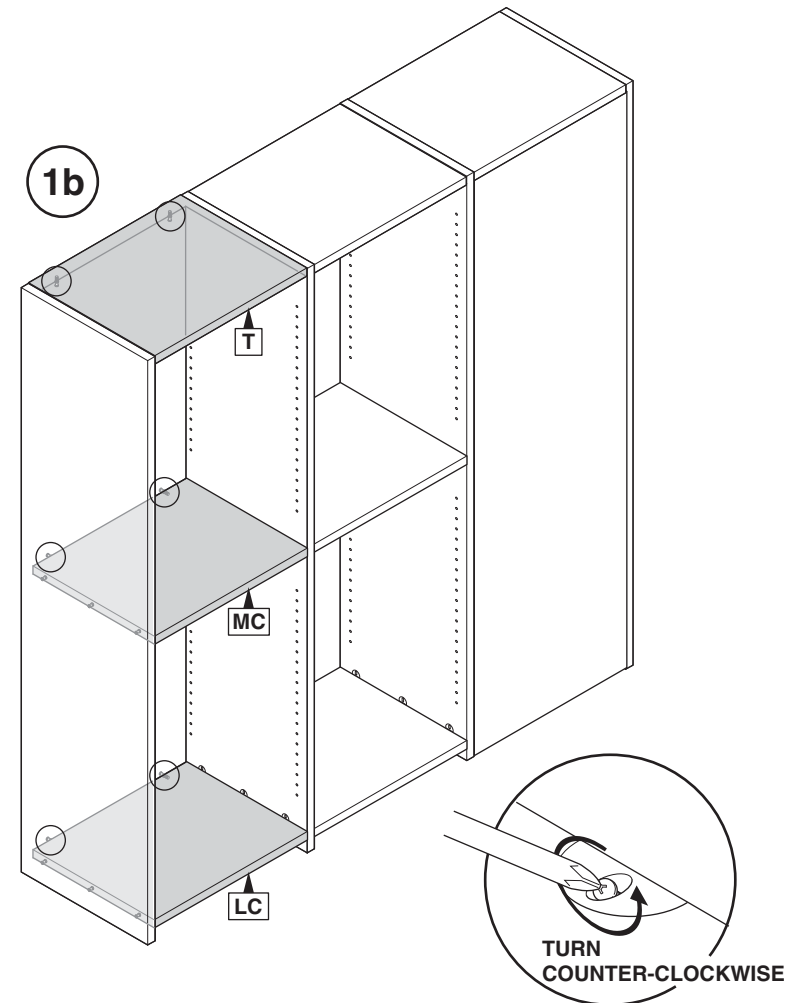
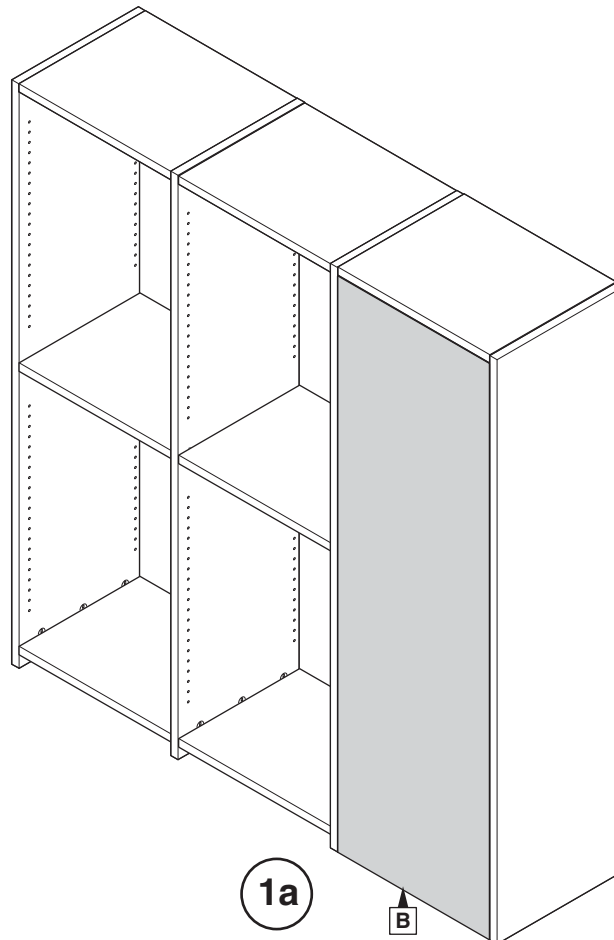

**Loosen Cam Locks in 6 places**  
(The cam lock screw needs to be turned 3/4 full turn or 270° counter-clockwise for complete removal.)

- 2.** Push panel B outward first (2a) and then pull downward (2b). Remove panel B (2c).

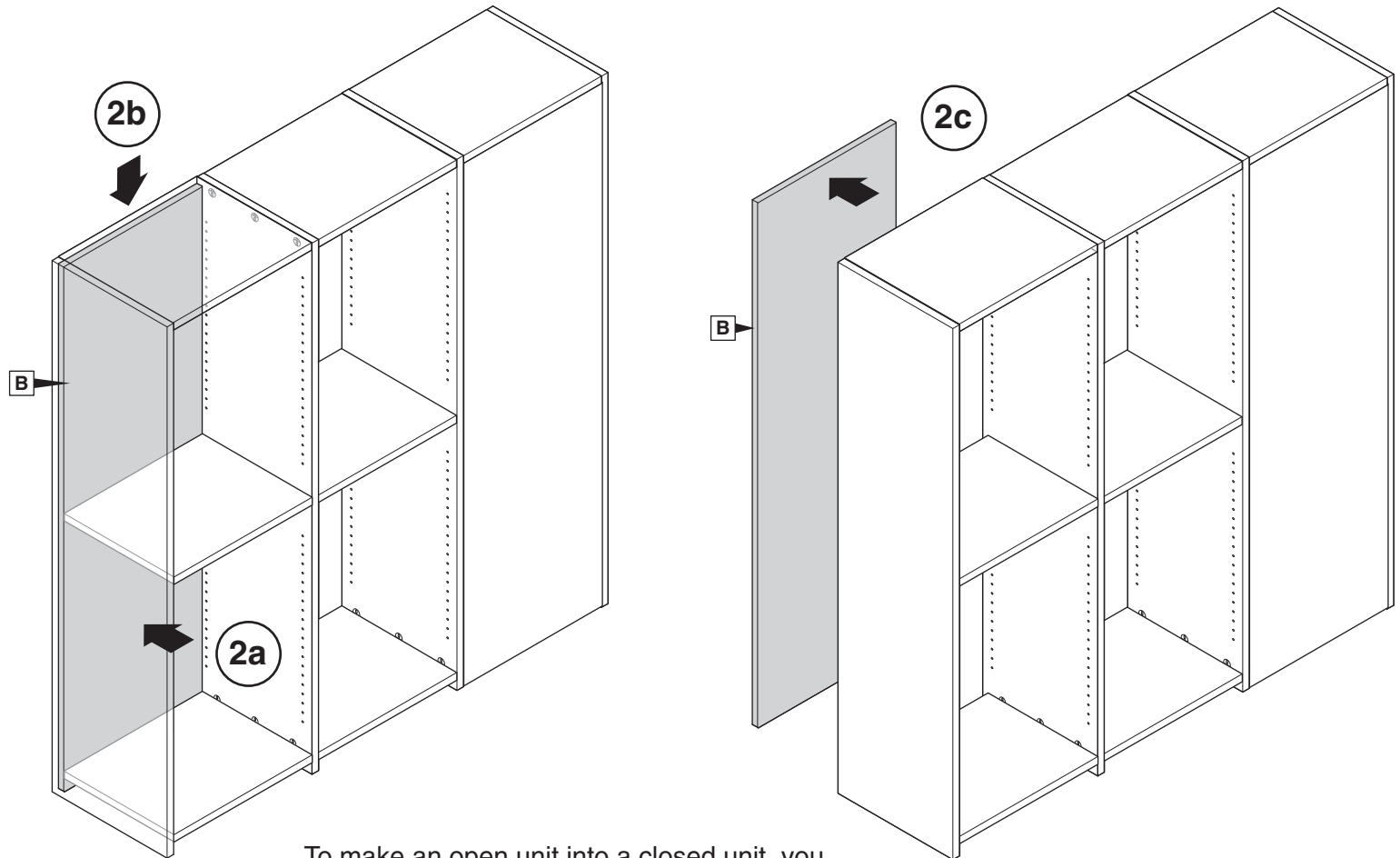

To make an open unit into a closed unit, you need to rotate the top shelf 180° and order a new middle and bottom fixed shelves.

## Grommet Installation

**NOTE:** The following is applicable to all scenarios. 3 unit is shown as an example.

**1.** Determine placement of grommet. Check under shelf for possible interference with bases or hardware. Make sure to stay 1-1/2" - 2" away from cams and pins that are used to assemble the unit.

**2.** Apply masking tape over area to avoid chipping of laminate.

**3.** Mark and drill a 1/8" dia. pilot hole through the shelf. Bore a hole with 3" (76.2 mm) dia. drill bit all the way through the shelf.

**4.** Carefully remove tape.

**5.** Slide grommet into hole.

**NOTE:** Grommet can be glued into hole if desired.

