

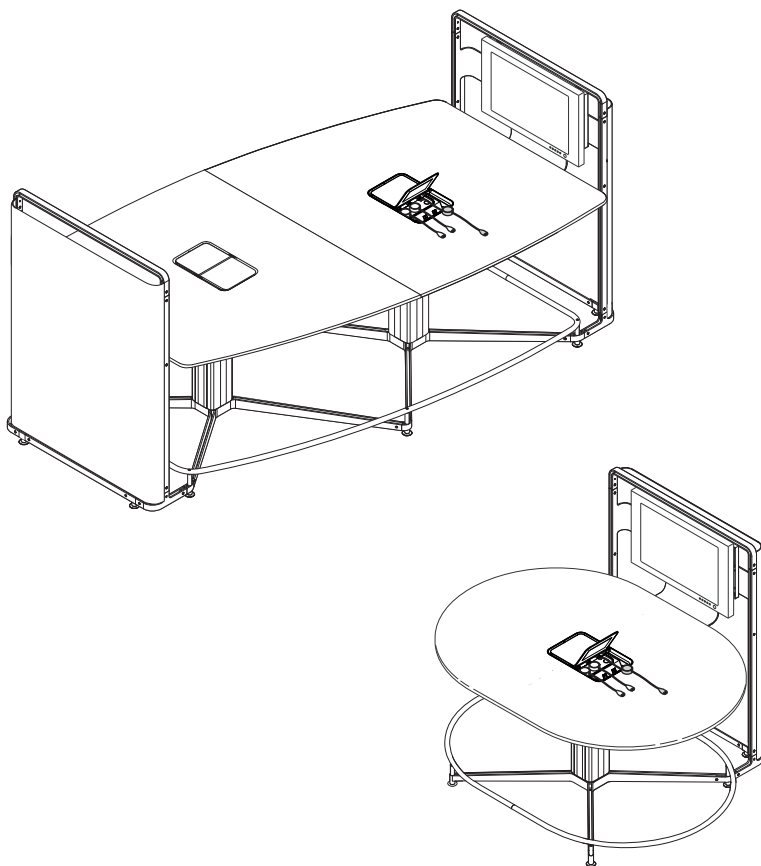

media:scape™

Puck Replacement



If you have a problem, question, or request, call
your local dealer, or Steelcase Line 1 at
888.STEELCASE (888.783.3522)
for immediate action by people who want to help you.
(Outside the U.S.A., Canada, Mexico, Puerto Rico,
and the U.S. Virgin Islands, call: 1.616.247.2500)
Or visit our website: www.steelcase.com

© 2010 Steelcase Inc.
Grand Rapids, MI 49501
U.S.A.

Printed in U.S.A.

939500513 Rev A

Table of Contents

Page	Topic
4	Bezel Removal
4	Removing the First PUCK Tray
5	Removing the Second PUCK Tray
5	Arranging and Examining the PUCK's
6	Removing the Cable Guide
6	Examining and Removing the Pulley
7-8	Removing Pyramid Covers
9	Releasing the PUCK Cable Below
9	Removing the PUCK Cable from the Switcher
10-11	Replacing the PUCK
11	Examining the Cable Pattern and PUCK Tray
12	Replacing the Cable Guide
13	Replacing the First PUCK Tray
13	Replacing the Second PUCK Tray
14	Replacing the Bezel
14	Positioning the PUCKs Prior to Securing Cables
15	Removing the Pedestal Cover
16	Applying and Securing the Pulley Bracket
16	Holding the PUCK from Moving
17	Pulling the Slack from the PUCK Cable

This is an fragment of the assembly directions. For the complete set of assembly directions, refer to <http://in2.steelcase.com>.

Tools Required

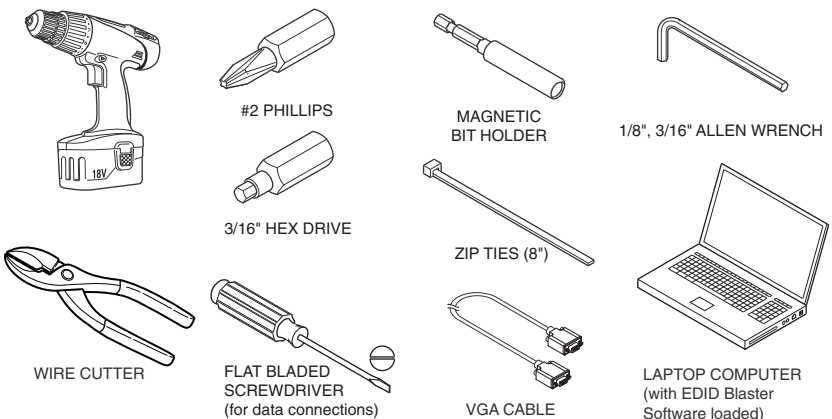

1. Bezel Removal

Loosen screws on each plate (1a). Push plates inward (1b). Remove bezel (1c) and prop on edge nearest cable (1d).

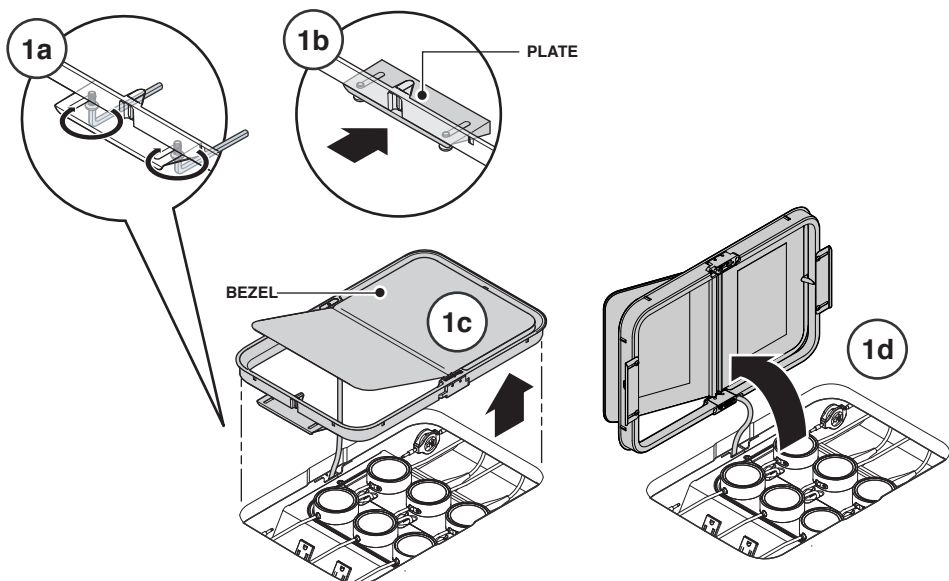

2. Removing the First PUCK Tray

Arrange PUCKs on one side of PUCK tray set (2a). Remove first PUCK tray (2b).

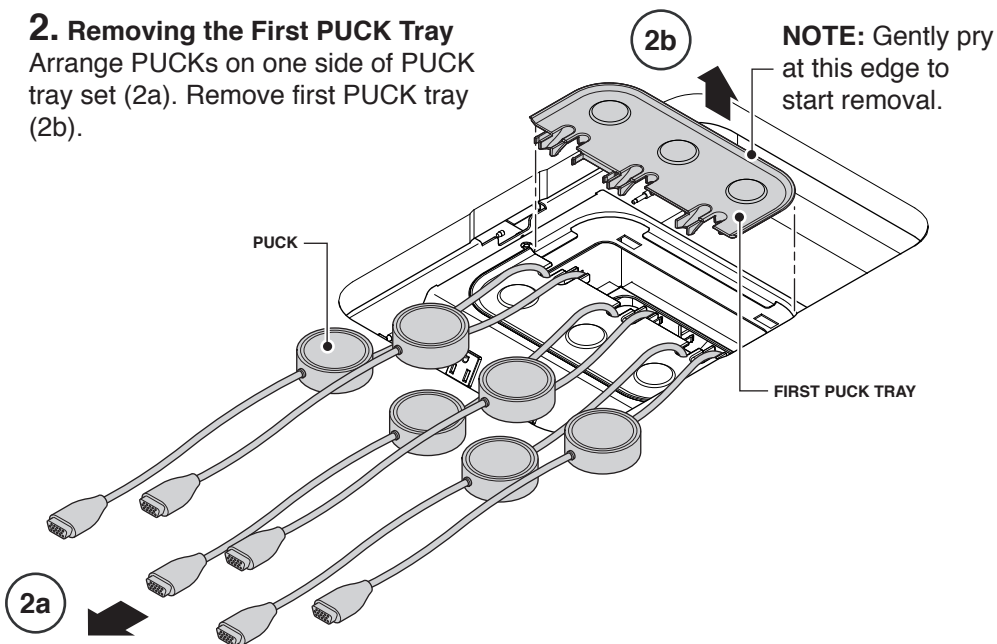

3. Removing the Second PUCK Tray

Arrange PUCKs on “empty” side (3a). Remove second PUCK tray (3b).

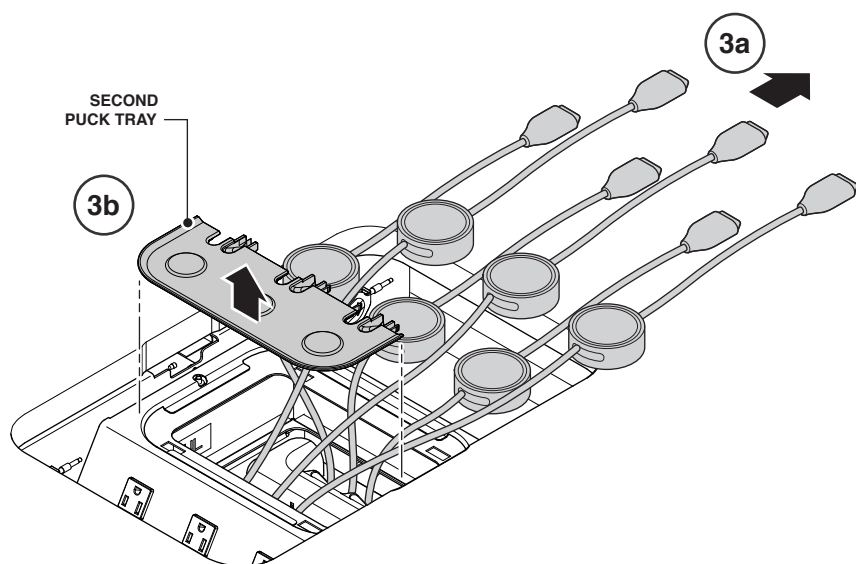

4. Arranging and Examining the PUCK's

Arrange PUCKs each side of the column opening. Carefully study the arrangement of cables exiting the molded cable guide.

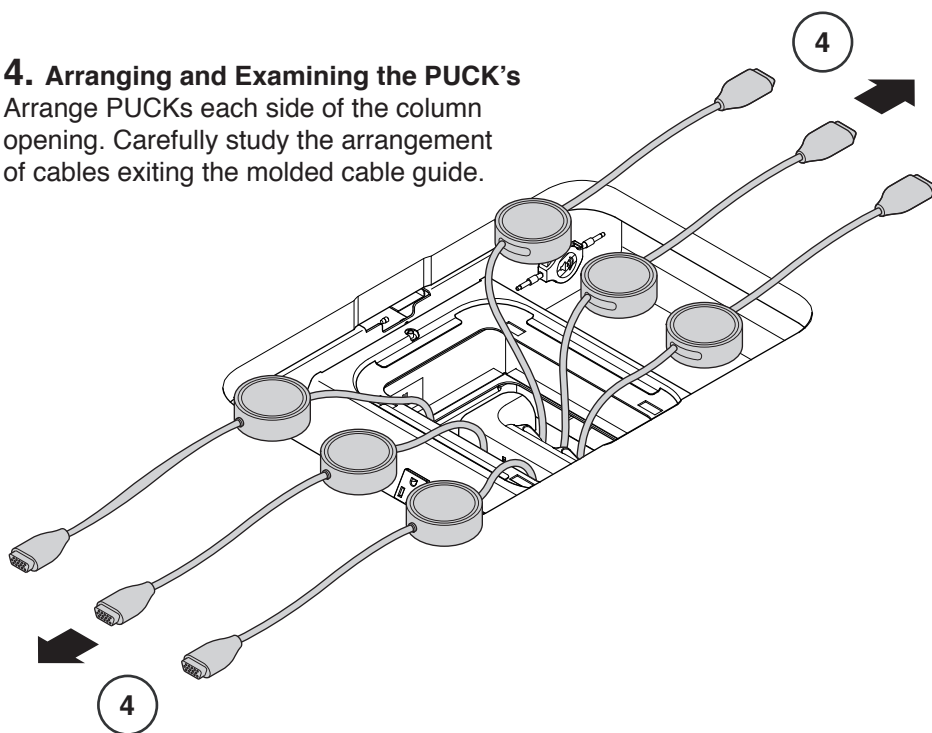

5. Removing the Cable Guide

To remove cable guide, loosen two (2) screw with an 3/16" Allen wrench and remove. Rotate and remove cable guide.

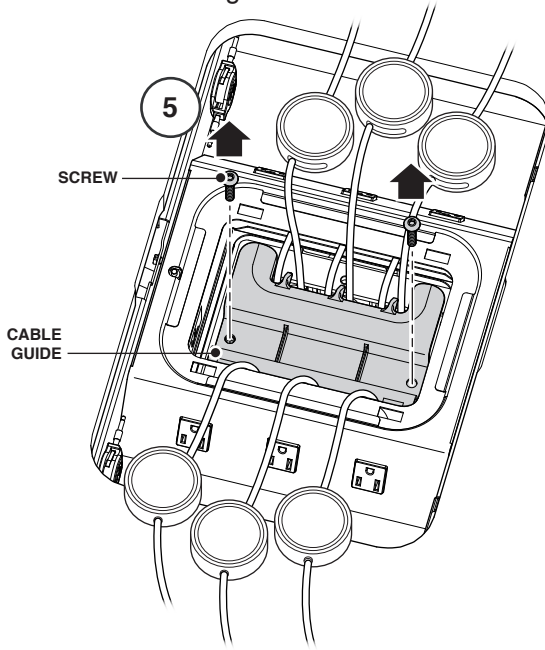

6. Examining and Removing the Pulley

For whatever puck you are replacing, remove its pulley by pulling the PUCK cable up. Remove aluminum pulley when it is at the top of the column.

NOTE: It is best to replace one **PUCK** at a time to minimize risk of improper cable routing.

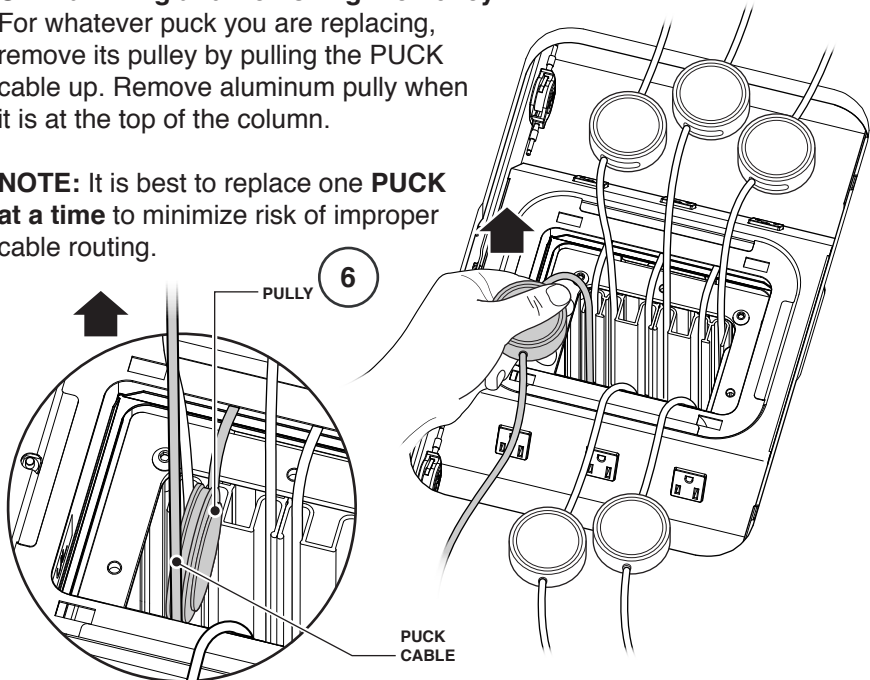

7. Removing Pyramid Covers

Locate pyramid cover "a" and remove seven (7) 5/16-18 x 3/4" button head screws (7a). Remove pyramid cover "a" (7b).

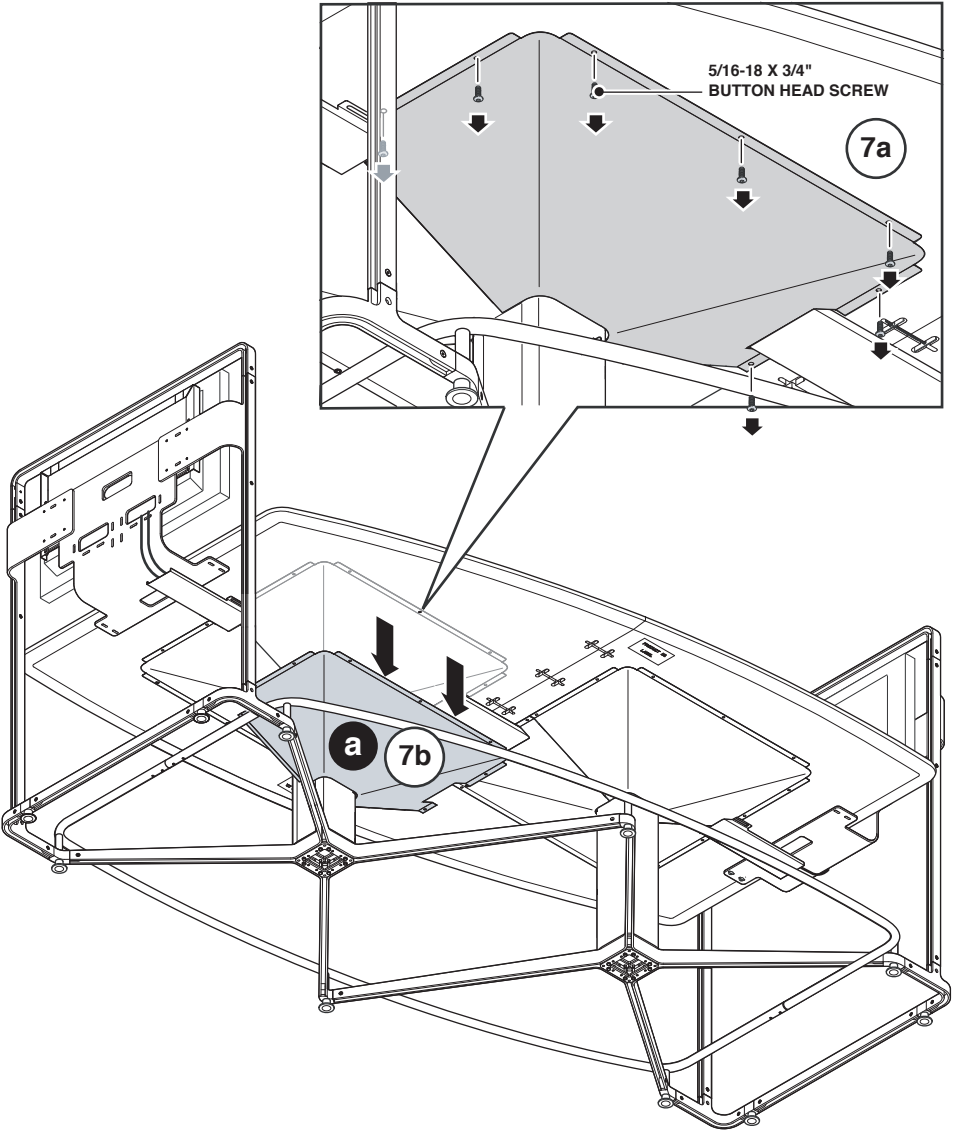

- 8.** Locate pyramid cover "b" and remove seven (7) 5/16-18 x 3/4" button head screws as performed for cover "a". Remove pyramid cover "b".

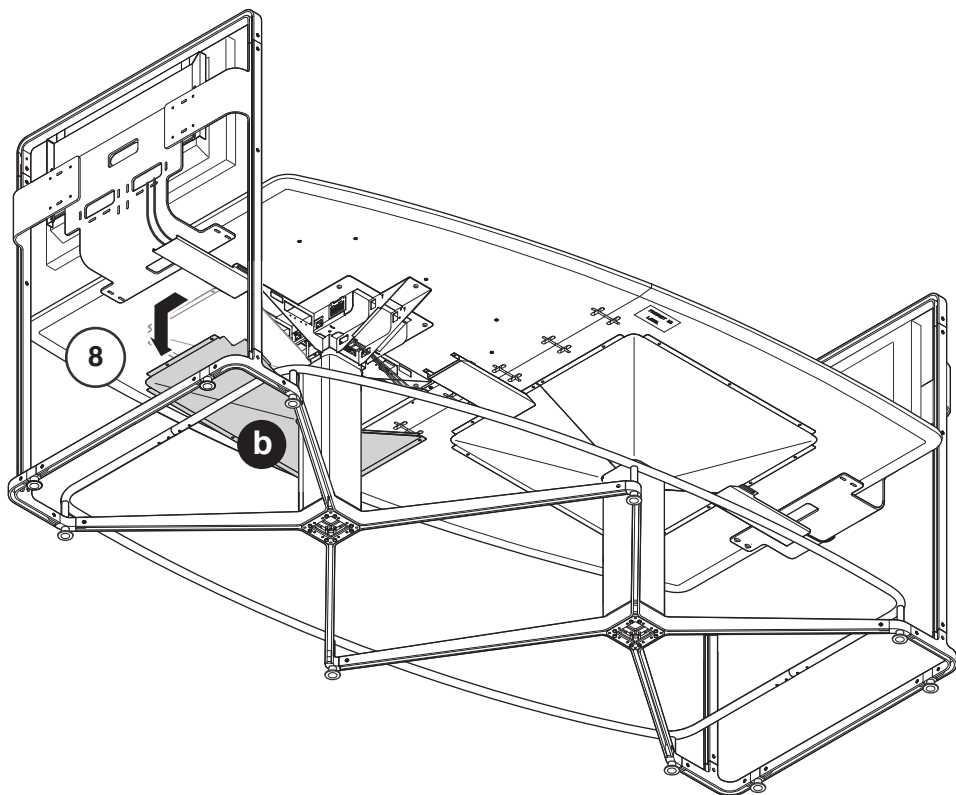

9. Releasing the PUCK Cable Below

Once pyramid covers are removed, the PUCK cables and switcher will be exposed underneath worksurface. On the side of the column where your PUCK cable feeds into the column weldment, carefully snip the zip tie that holds the PUCK cables tight to the feed-through slot. Snip in an area that is away from the cables themselves to avoid risk of cable damage.

UNDERSIDE OF WORKSURFACE

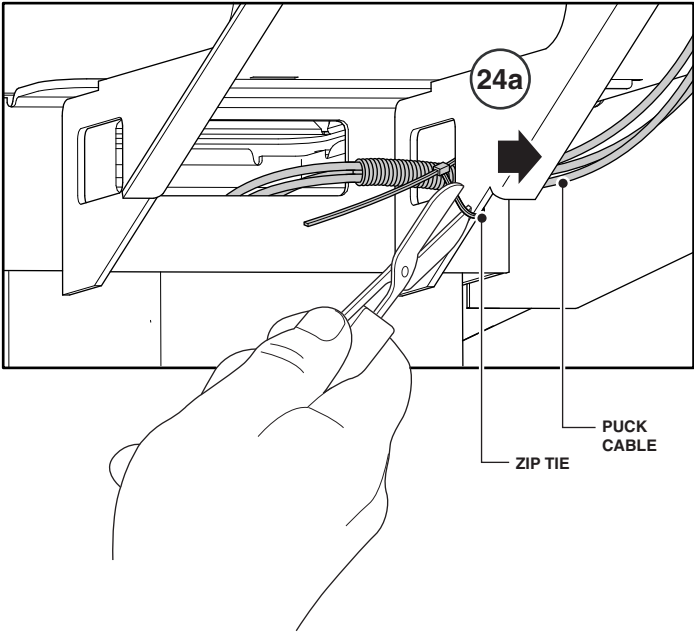

10. Removing the PUCK Cable from the Switcher

Locate the switcher and remove the PUCK connection. First, loosen the two (2) screws on the cable connector then unplug the cable connector.

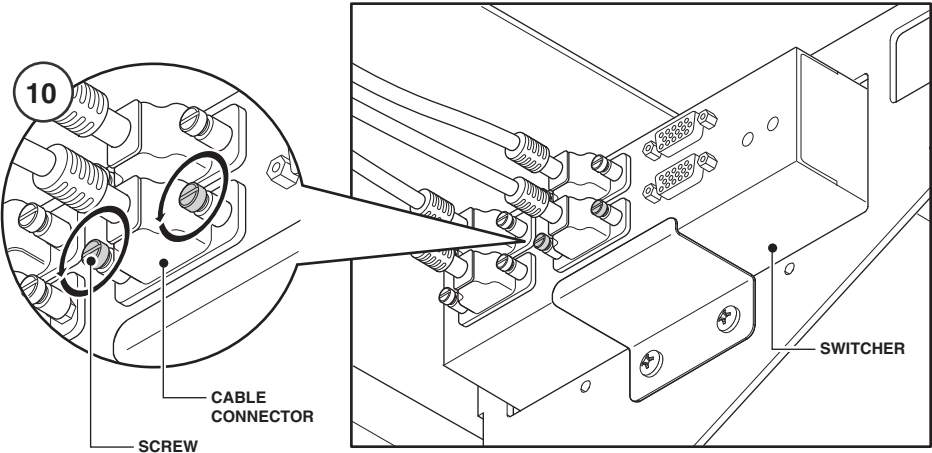

11. Replacing the PUCK

Now that the PUCK is completely disconnected, remove it from the column assembly by feeding the connector through the slots and out the top of the column assembly. **Relax the new PUCK cable by unwinding, straightening and massaging to eliminate the coil memory (11a).** Feed the new PUCK through the same path that it was removed (11b).

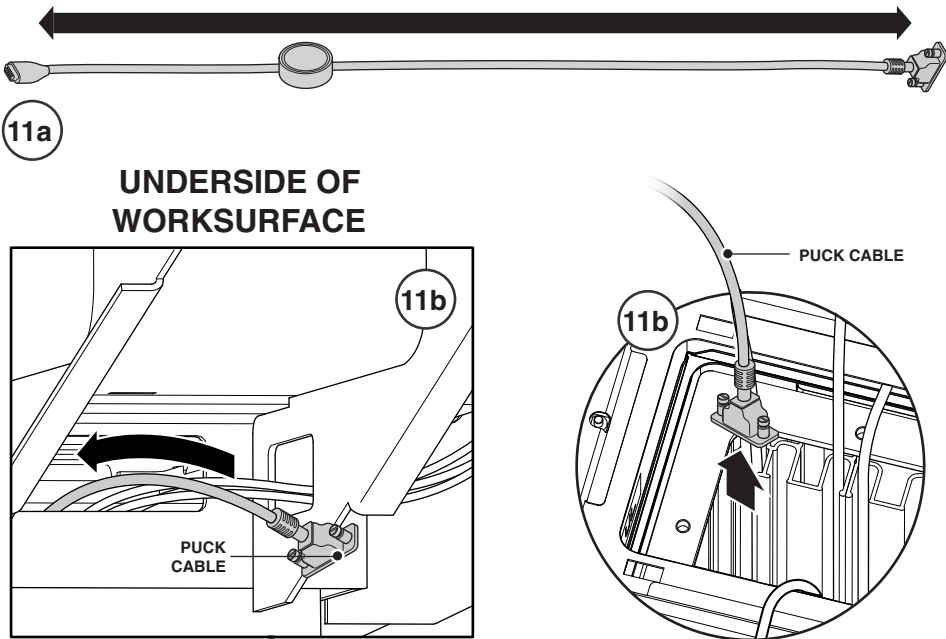

12. Connect the cable connector to the switcher (12a). Tighten the two (2) screws on the cable connector (12b).

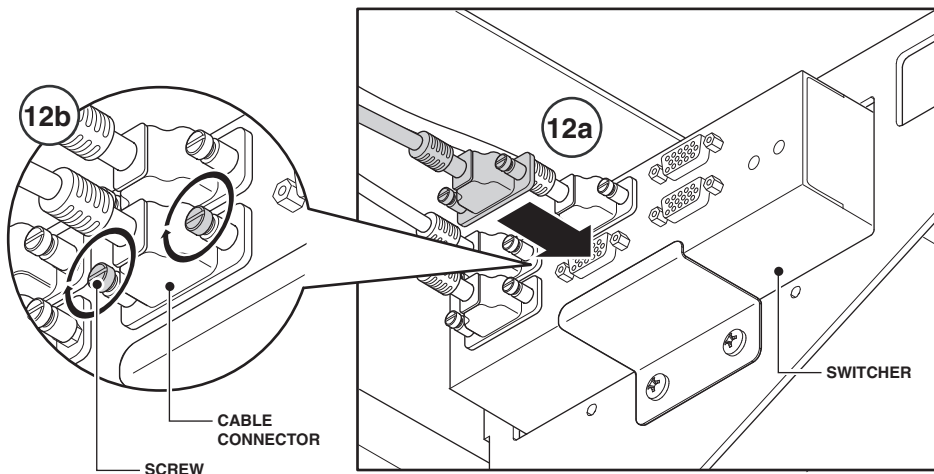

13. Align PUCK cable with groove in pulley as shown (13a). Insert the pulley and cable into the column assembly.

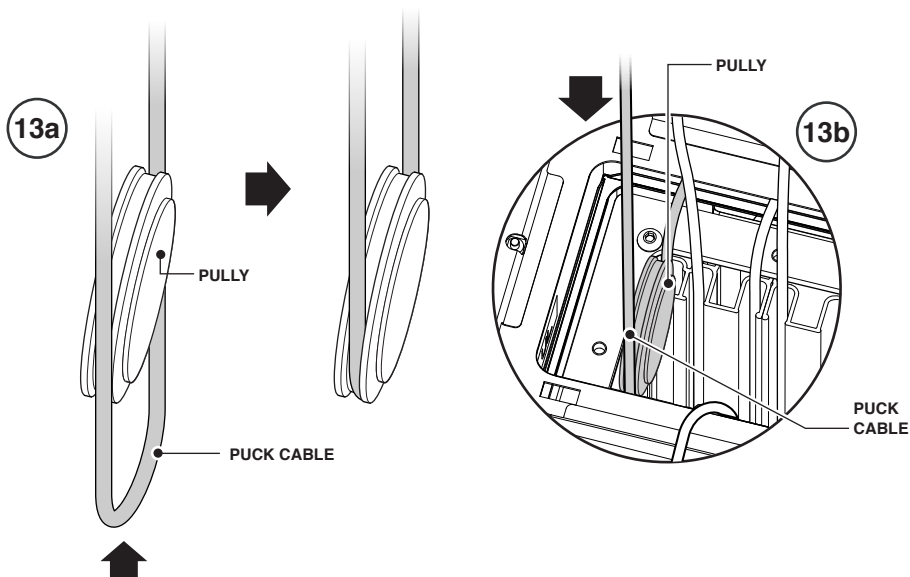

14. Examining the Cable Pattern and PUCK Tray

Look at the PUCK tray side by side with the column assembly. Notice the logic of the cable paths, what sides they exit from to line up with the PUCK tray slots (cable “1” is threaded through hole “1”, cable “2” is threaded through hole “2”, etc.)

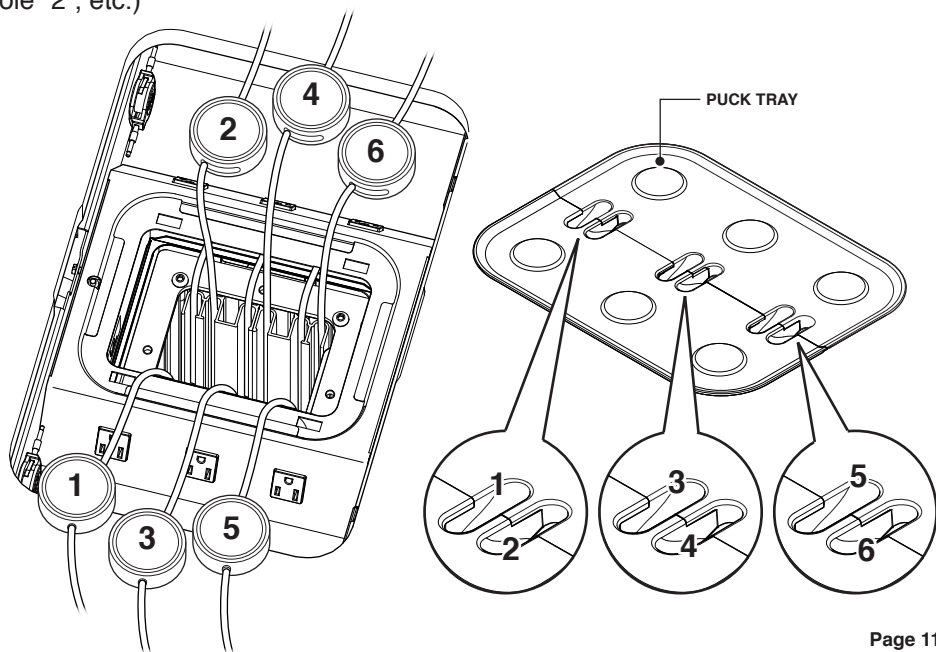

15. Replacing the Cable Guide

Replace the cable guide that was removed in step 5. Secure cable guide using two (2) screws (15a). Make sure to use the cable guide to separate the incoming and outgoing cables (15b). Pull cables to make sure they can be pulled without any major friction.

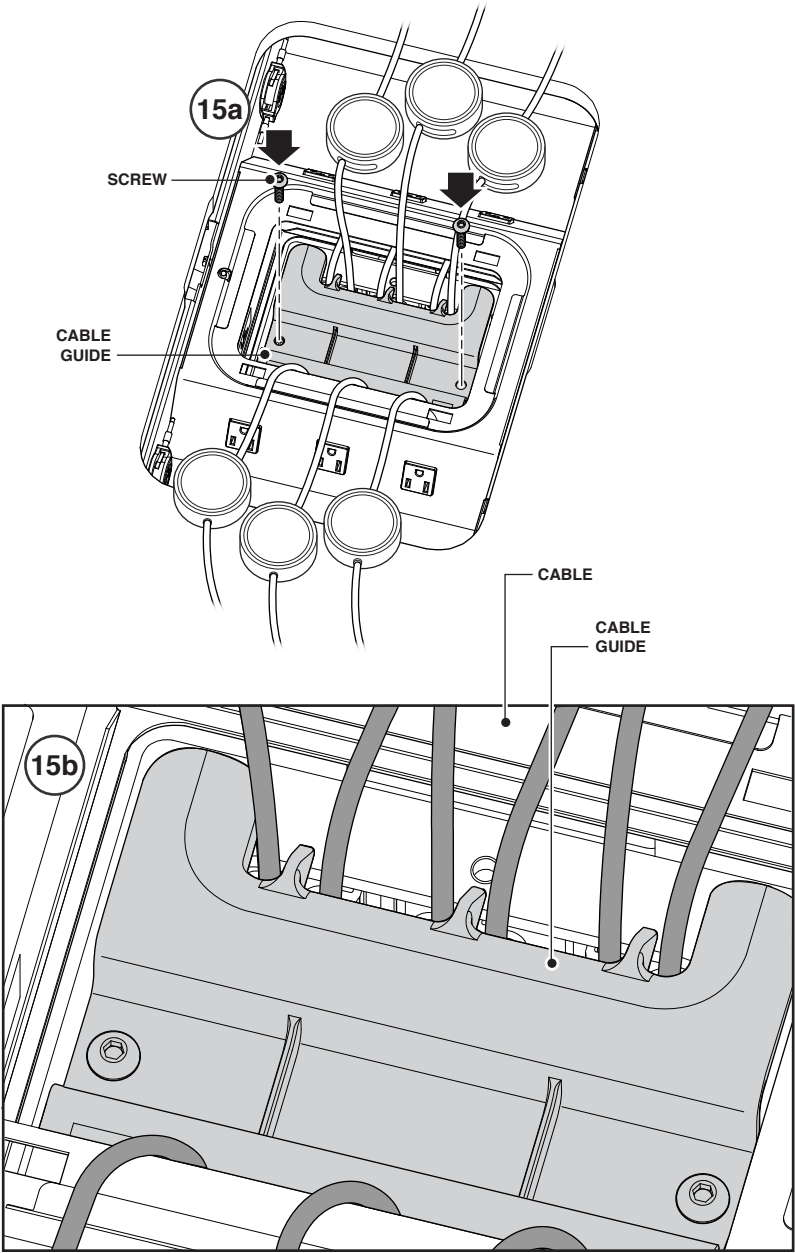

16. Replacing the First PUCK Tray

Replace the first by PUCK tray by positioning all PUCKs on that side of the tray (16a). Lower PUCK tray and snap into place (16b). Be careful not to cross the cables beneath the tray.

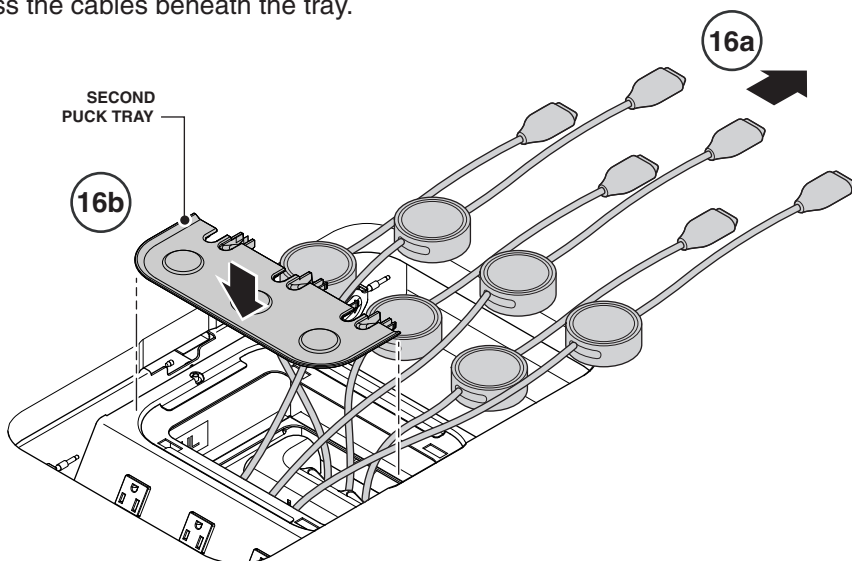

17. Replacing the Second PUCK Tray

Replace the second by PUCK tray by positioning all PUCKs on that side of the tray (17a). Lower PUCK tray and snap into place (17b). Be careful not to pinch cables where the trays join in the center. Make sure PUCK cables extract and retract freely.

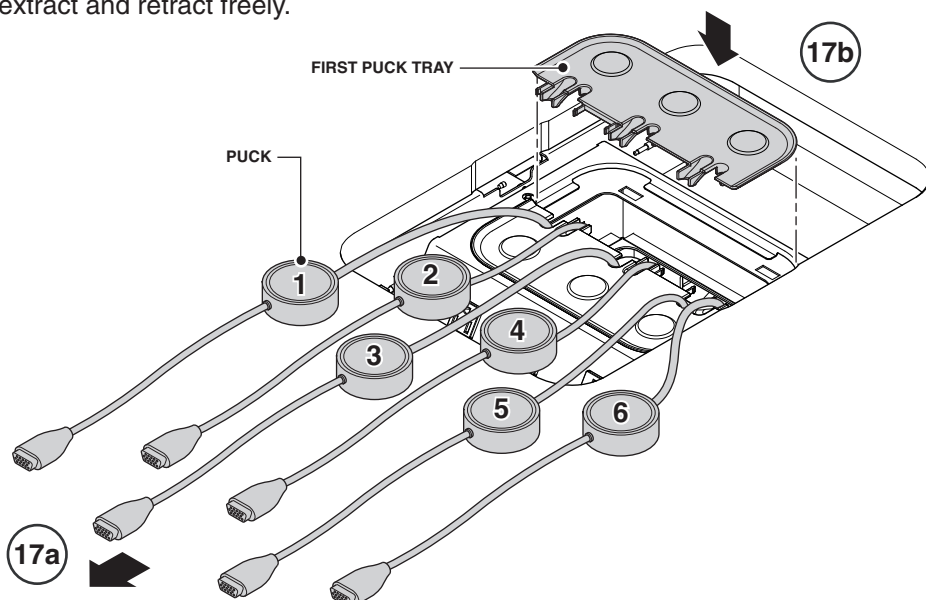

18. Replacing the Bezel

Position PUCKs into their docking locations. Rotate bezel and drop straight down into worksurface opening (18a). Slide bezel brackets to secure bezel to worksurface (18b). Tighten screws with allen wrench (18c).

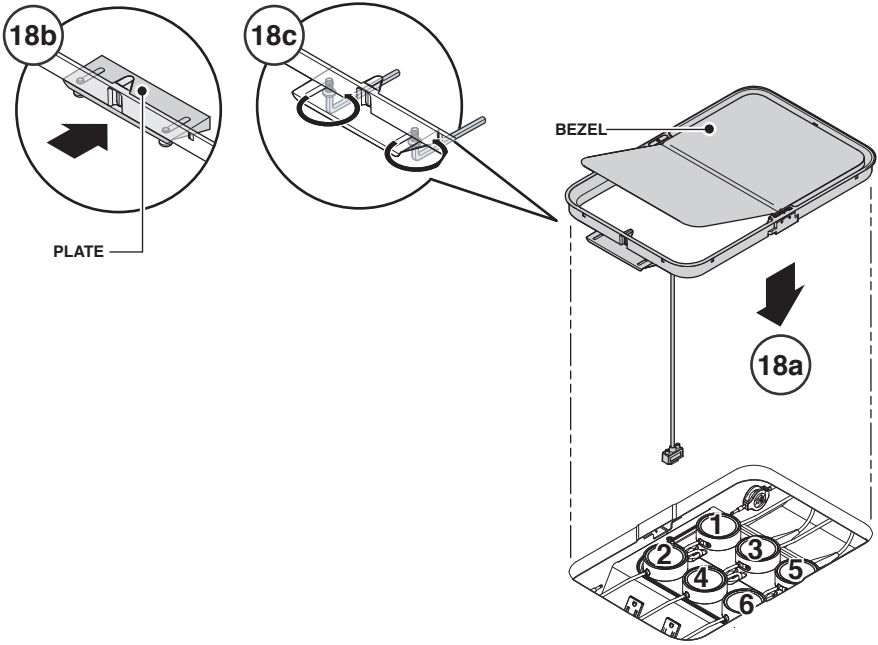

19. Positioning the PUCKs Prior to Securing Cables

Position PUCKs prior to securing cables. Place PUCK on the outside edge of the bezel frame as shown.

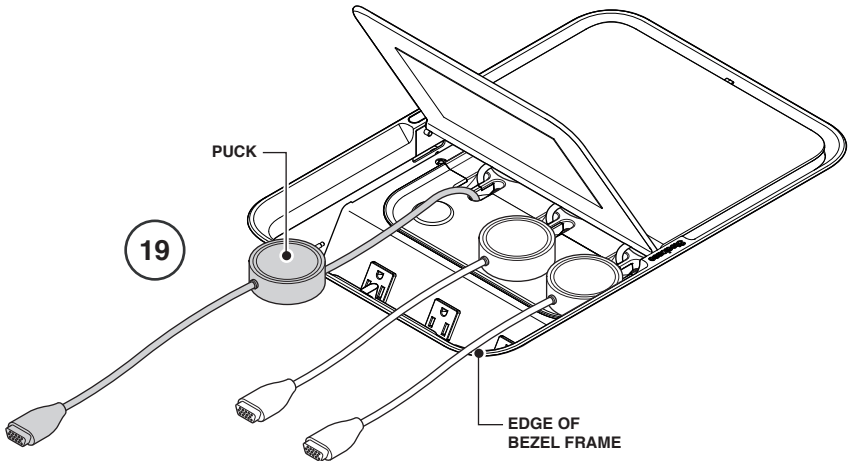

20. Position all pucks as shown.

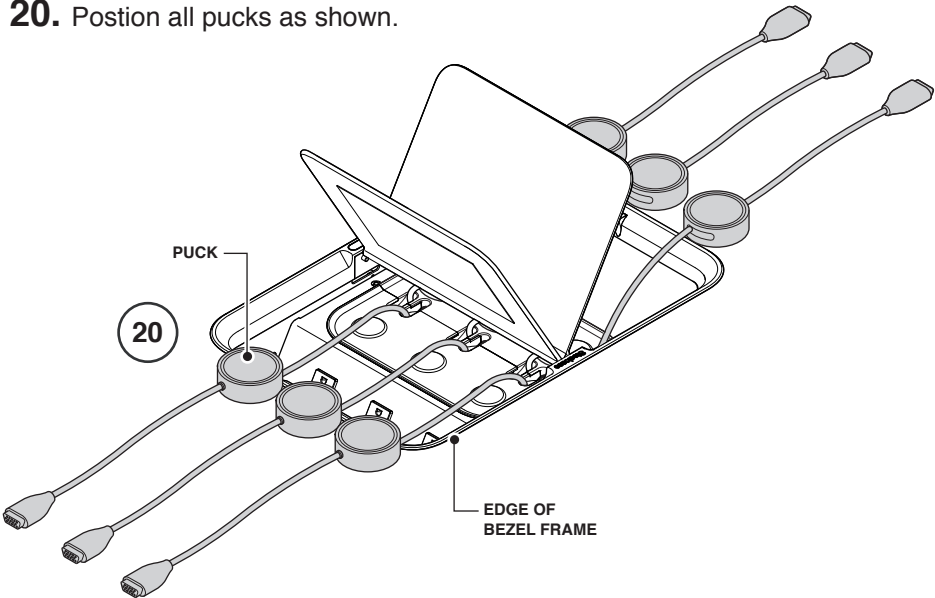

21. Removing the Pedestal Cover

Locate pedestal underneath worksurface. Remove cover. **NOTE:** Worksurface removed from illustration for clarity.

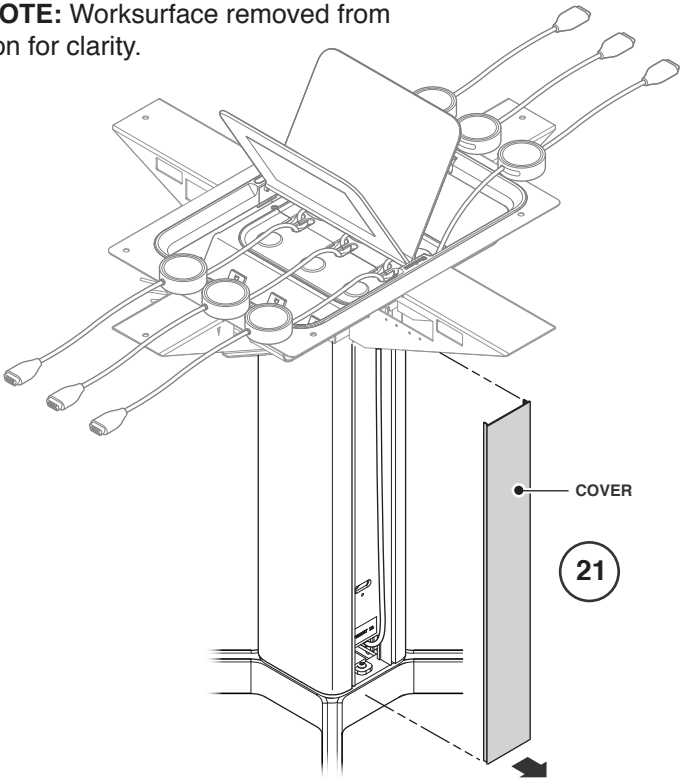

22. Applying and Securing the Pulley Bracket

Beaneath the table, insert pulley shipping bracket in slot. It should feed through the center of each pulley if the PUCKs are properly positioned on the bezel frame (22a) and if the correct amount of PUCK cable extends into the column assembly (see Fig. 11a). Secure the pulley shipping bracket using one (1) #10 sheet metal screw (22b).

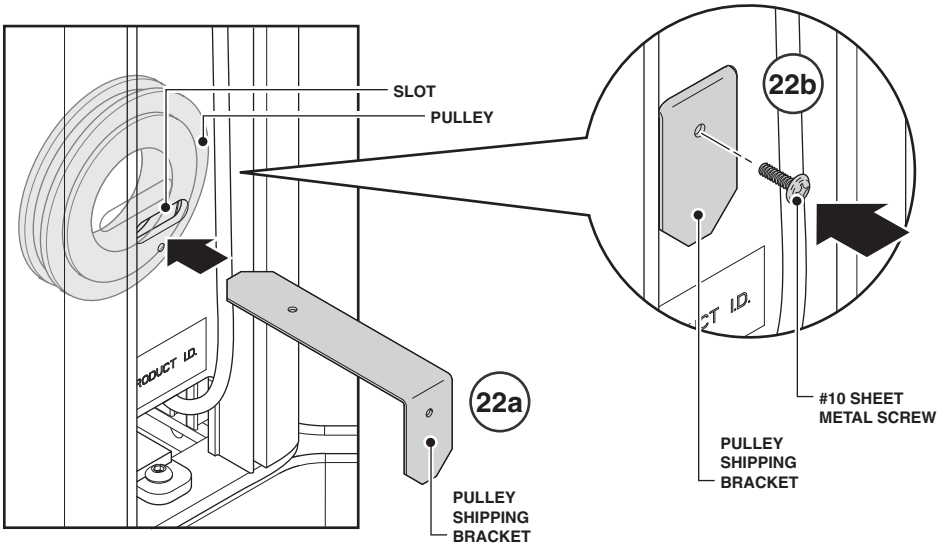

23. Holding the PUCK from Moving

Hold the replacement PUCK from moving on the worksurface.

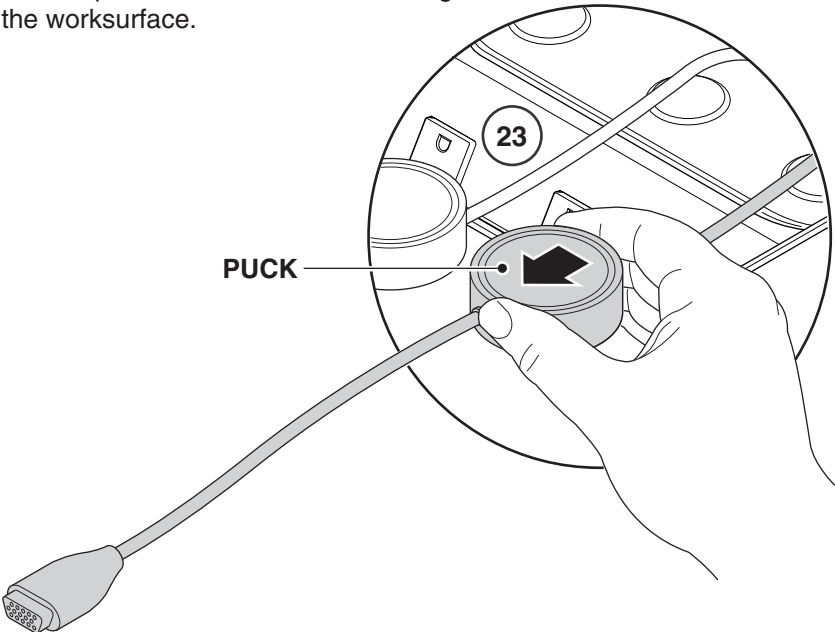

24. Pulling the Slack from the PUCK Cable

While holding the PUCKs on the top of the worksurface, pull the slack out of the cables on the bottom side (two people are needed for this) (24a). Use a new zip tie and a plastic slit-conduit strain relief (24b) to hold the cables tight to the feed-through slot. After PUCK cable lengths are set, remove the pulley shipping bracket. Check the operation of the PUCK retraction system for proper function.

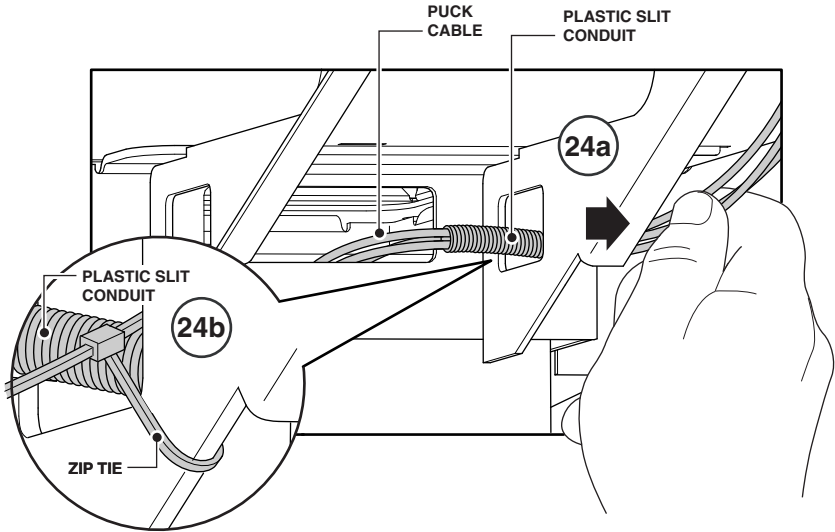

25. Replace cover that was removed from the pedestal in step 21.

26. Replace pyramid covers that were removed from the pedestal in steps 7 and 8.

Gather EDID (Extended Display Identification Data) code from the primary display device (open EDID Blaster software, reference instructions therein, and power up the display device):

- 1) Plug in laptop to primary output (monitor or projector) using a VGA cord.
- 2) Select "Refresh".
- 3) From the "Detected Monitors" drop down menu select the output device.
- 4) Select "Read EDID" in the lower left portion of the screen.
- 5) Disconnect the VGA cord from the laptop and output device.
- 6) Connect the PUCK to the laptop.
- 7) Confirm that the PUCK lights up white.
- 8) Select "Write EDID".
- 9) Select "OK" when EDID writing is complete.
- 10) Verify that the PUCK functions correctly (icons working, retracting properly).