

**⚠ CAUTION: TIP OVER HAZARD**

Install headrest *only* on chairs, no stools

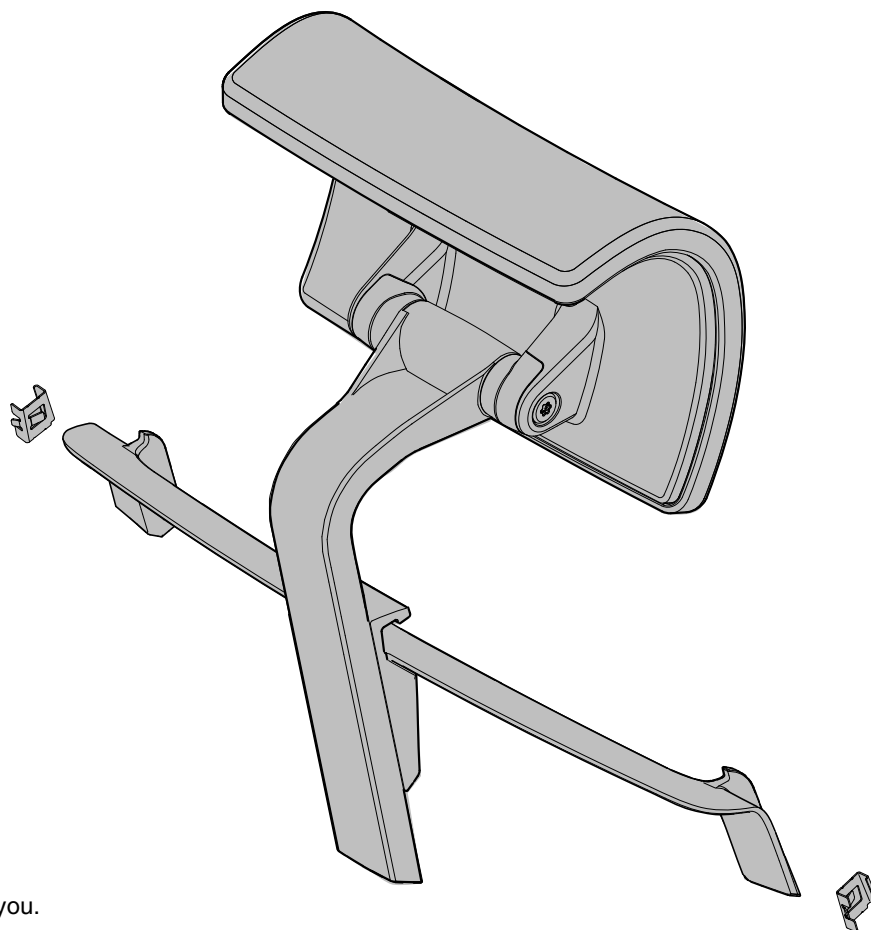

If you have a problem, question, or request, call  
your local dealer, or Steelcase Line 1 at  
**888.STEELCASE** (888.783.3522)  
for immediate action by people who want to help you.

(Outside the U.S.A., Canada, Mexico, Puerto Rico,  
and the U.S. Virgin Islands, call: 1.616.247.2500)

Or visit our website: [www.steelcase.com](http://www.steelcase.com)

© 2015 Steelcase Inc.  
Grand Rapids, MI 49501  
U.S.A.

Printed in U.S.A.

## ⚠ CAUTION: TIP OVER HAZARD

Install headrest *only* on chairs, no stools

**1.** Install LH and RH metal clips with tabs facing away from back of chair. One (1) tab at each side of chair. Slide clips down to rest on small bumps.

**NOTE:** Clips are handed. Indent in clip should face down and align with bump.

**2.** Center the headrest on top of the chair with the front edge of the headrest over the plastic edge on the top of the chair back.

**3.** Rotate the headrest backward and press the side wall hooks up to clip under each side, you should hear a small 'click' noise (3a). At the bottom of the mount, push inwards with a high force (3b). You will hear a distinct 'snap' when the tabs (installed in step 1) have clipped into the mount.

**4.** Visually check to verify the headrest is engaged. Gently pull headrest forward and back to confirm it is secured to the chair back.

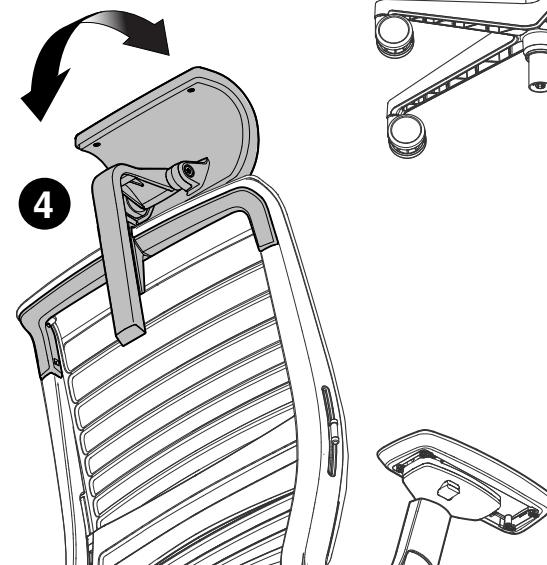
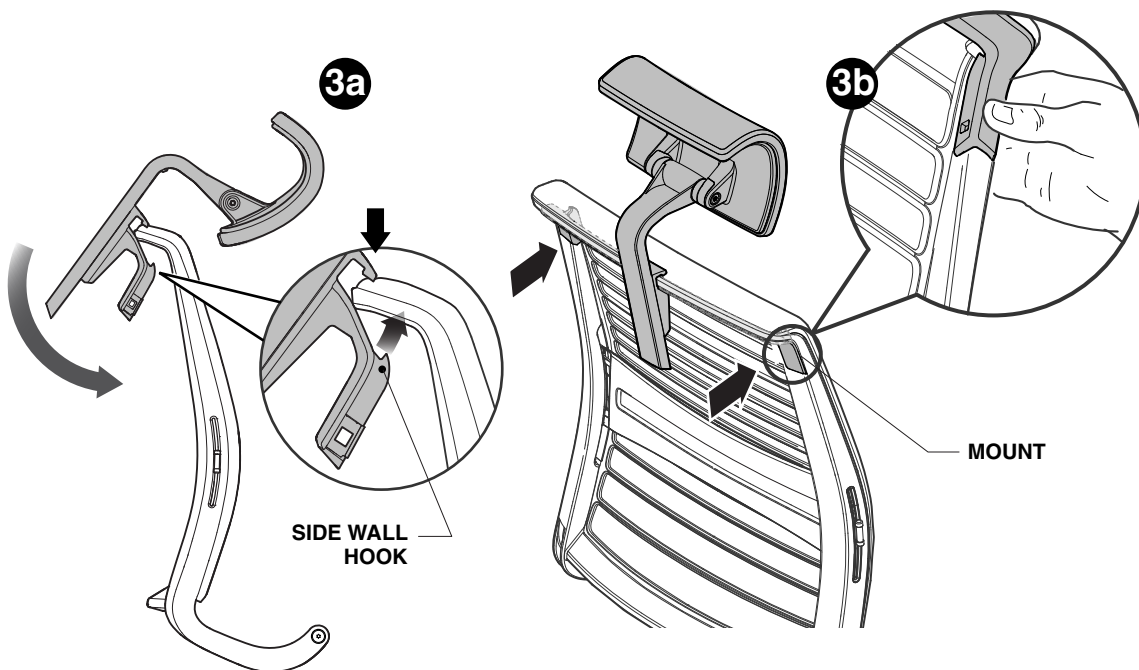
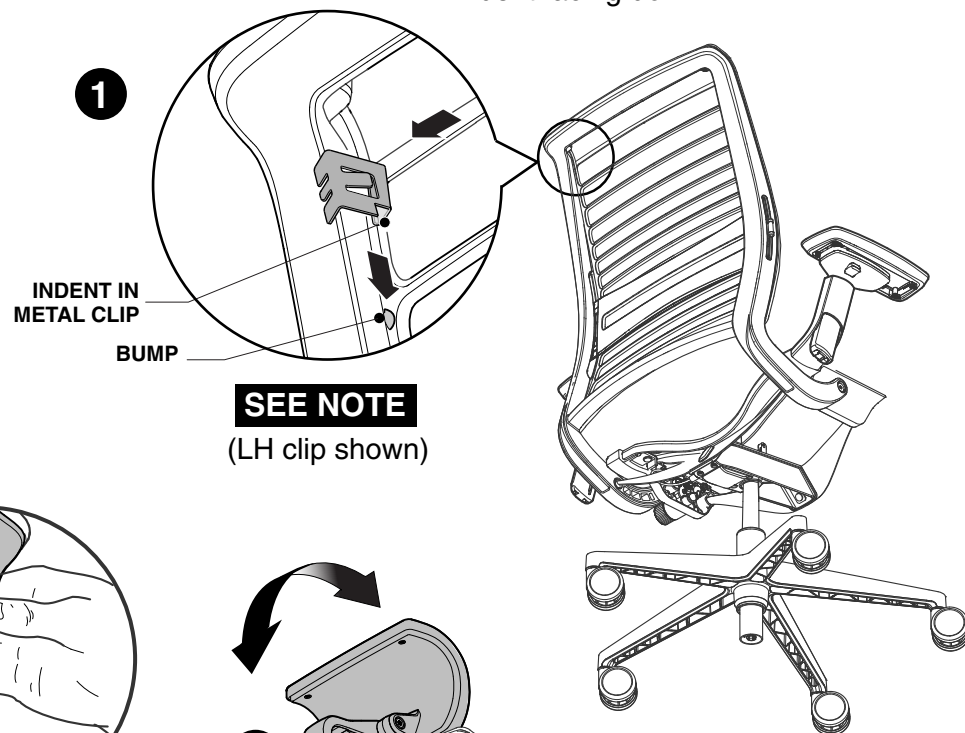
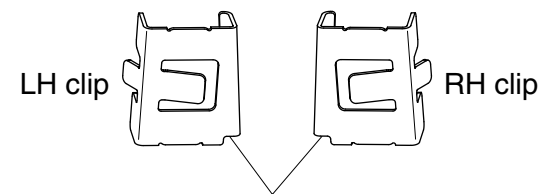

**NOTE:** Clips may break if headrest is removed from chair after successful installation.