

Universal Curved Front Bin Customer Service Package for Bins Manufactured Between February 8, 2004 and April 4, 2005

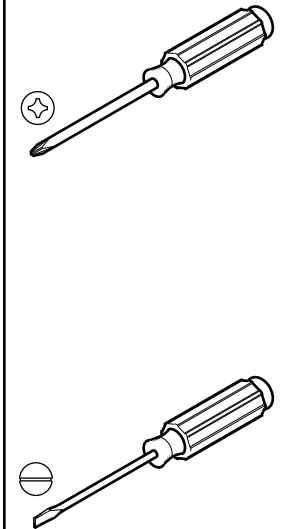
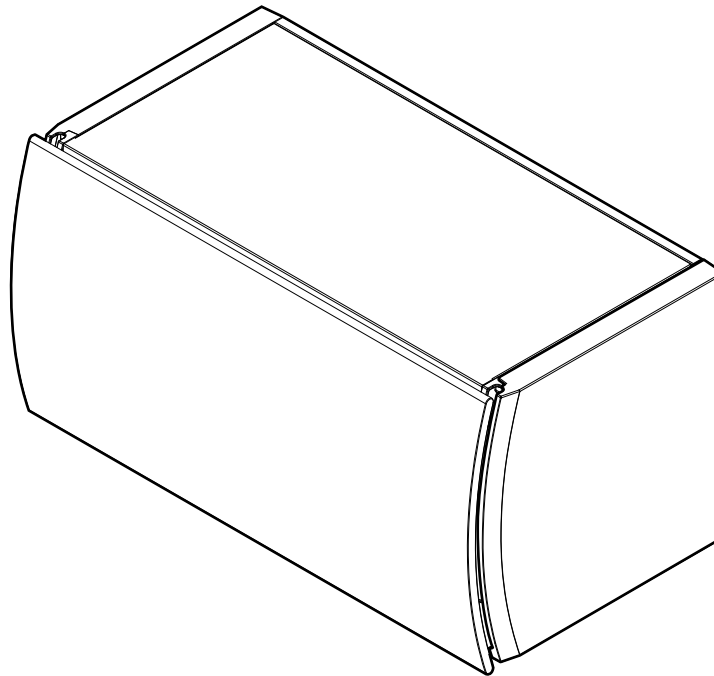

If you have a problem, question, or request, call
your local dealer, or Steelcase Line 1 at
888.STEELCASE (888.783.3522)
for immediate action by people who want to help you.

(Outside the U.S.A., Canada, Mexico, Puerto Rico,
and the U.S. Virgin Islands, call: 1.616.247.2500)

Or visit our website: www.steelcase.com

© 2005 Steelcase Inc.
Grand Rapids, MI 49501
U.S.A.

Printed in U.S.A.

1. Remove end cover by using a flat bladed screwdriver and prying the top/front corner of the end cover away from the bin (1a) and pushing the end cover to the rear of the bin (1b).

2. Remove existing (old style) spring.

3. Remove screws (3a) and remove spring bracket (3b).

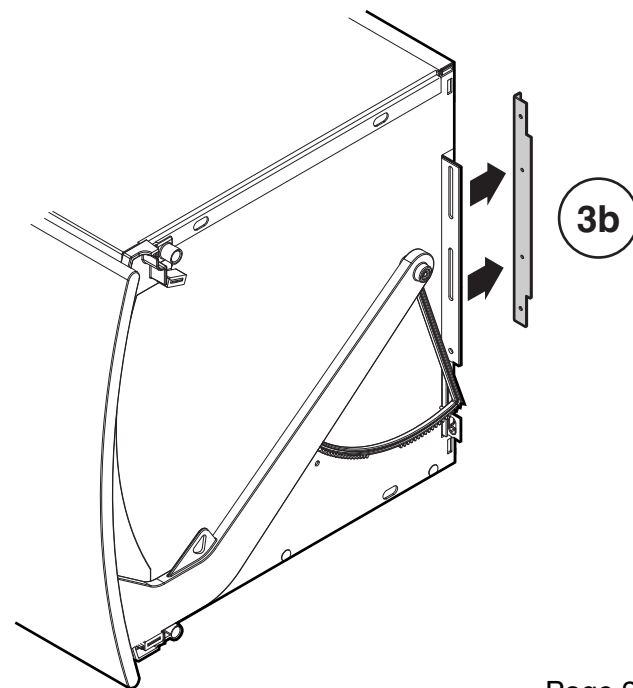
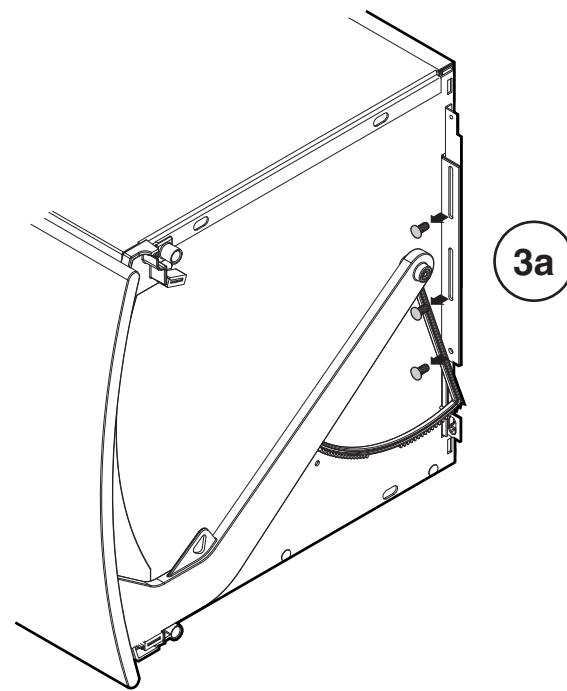
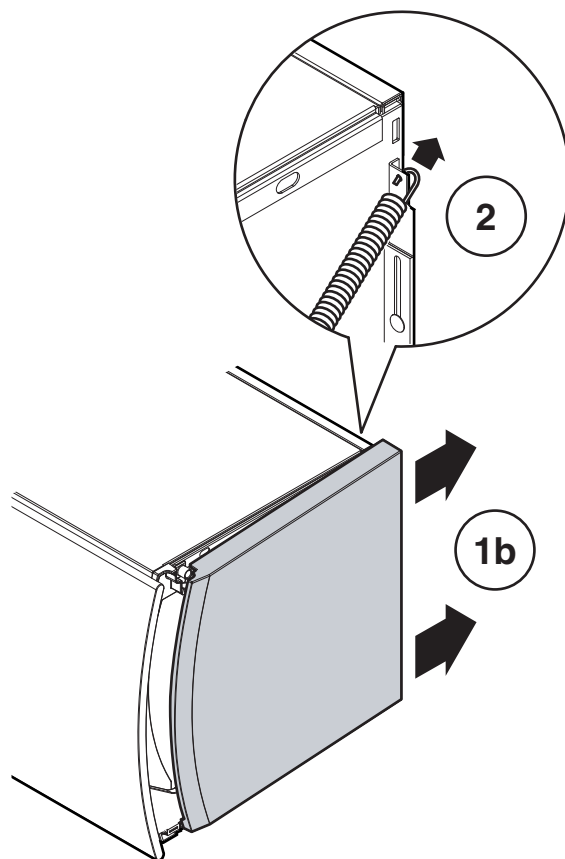
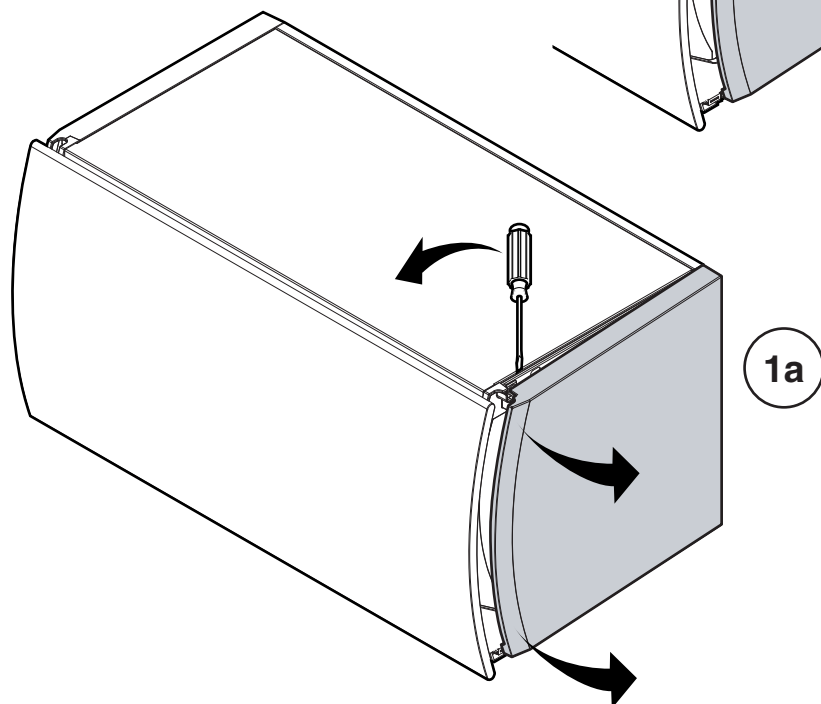

4. Flip spring bracket 180° (4a) and reinstall spring bracket with same screws (4b).

5. Install (new style) spring with 'Z' shaped end into the spring bracket.

6. Snap end cover back into its original position.

