

Universal Bookcase

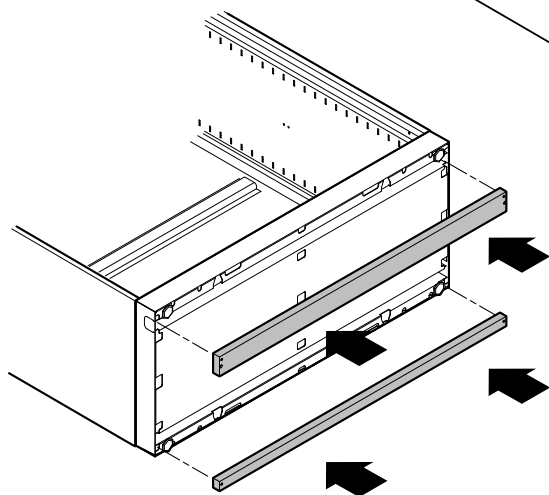

Stack and Rotate

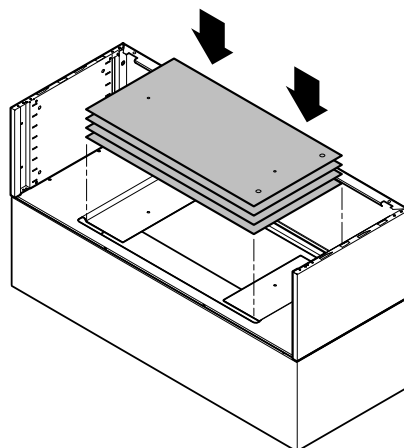

Cabinets/Towers

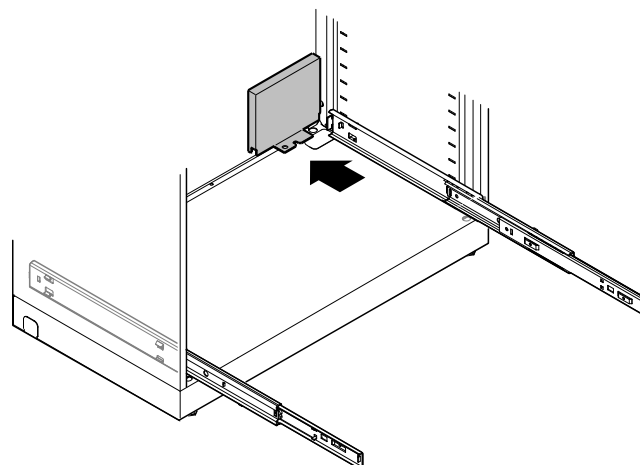

Table of Contents

Page	Topic
2	Attaching a Counterweight to a Universal Bookcase
3-4	Attaching a Counterweight to a Cabinet or Tower
5	Attaching a Counterweight to a Stack and Rotate

If you have a problem, question, or request, call your local dealer, or Steelcase Line 1 at **888.STEELCASE** (888.783.3522) for immediate action by people who want to help you.

(Outside the U.S.A., Canada, Mexico, Puerto Rico, and the U.S. Virgin Islands, call: 1.616.247.2500)

Or visit our website: www.steelcase.com

© 2003 Steelcase Inc.
Grand Rapids, MI 49501
U.S.A.

Printed in U.S.A.

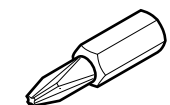
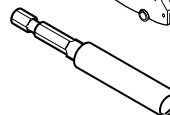
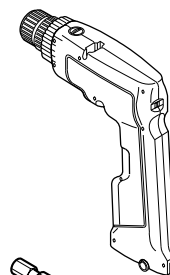

ACR2 BIT

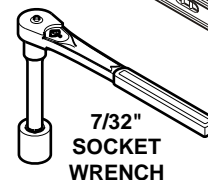
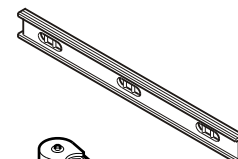

7/32" SOCKET WRENCH

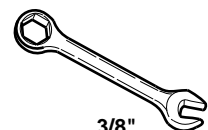

3/8" OPEN END WRENCH

Attaching a Counterweight to a Universal Bookcase

1. Place the bookcase on it's back.
2. Attach counterweights to underside of bookcase base using #10 self-drilling screws.
3. Place bookshelf upright.

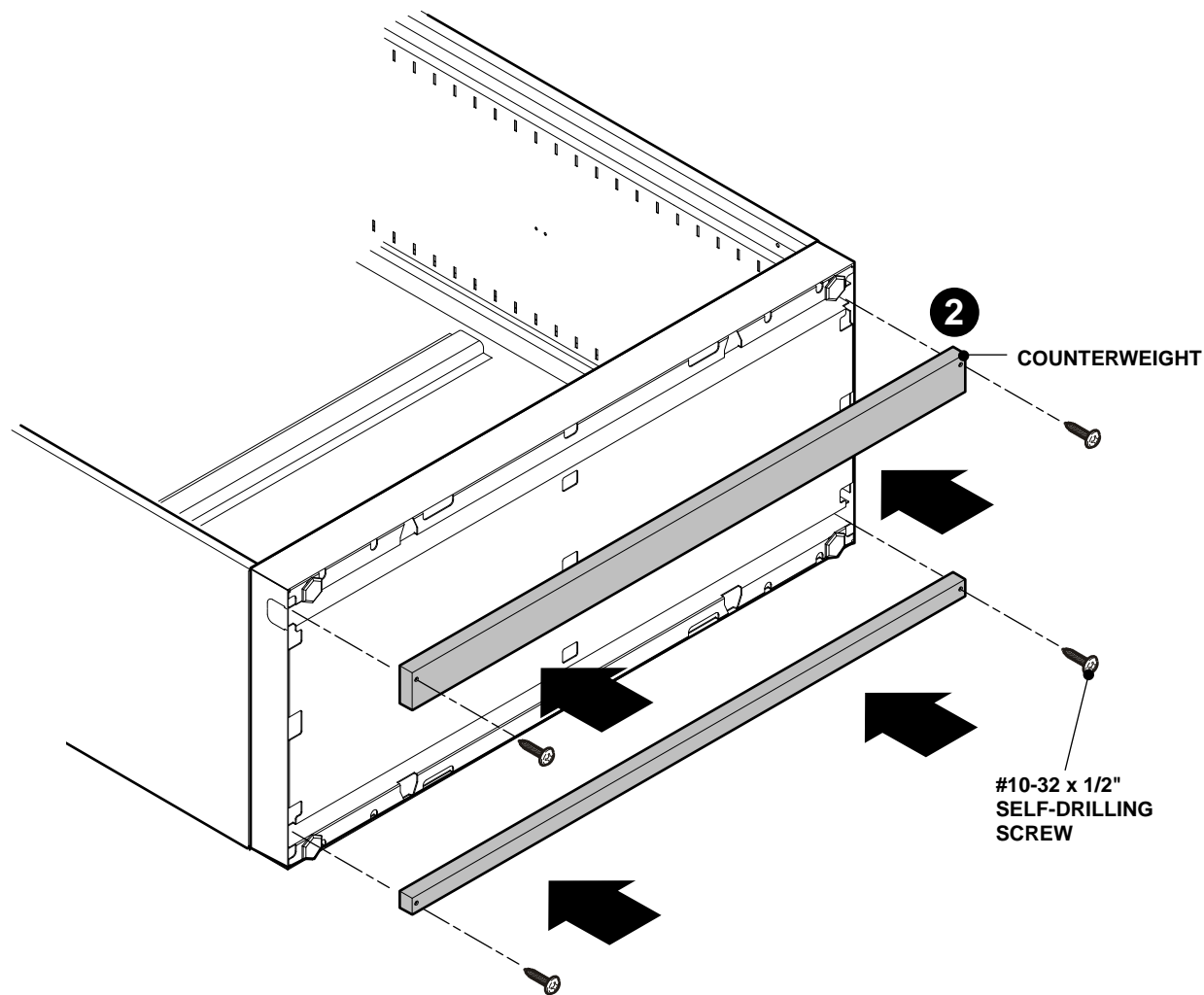
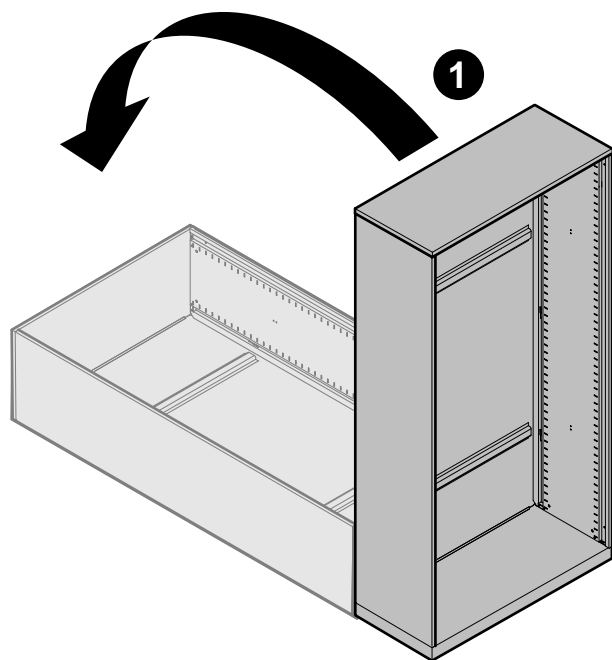

Attaching a Counterweight to a Cabinet or Tower

1. Remove screws in the front on both sides of the drawer (1a) or rollout (1b).
2. Pry out the suspension of the drawer (2a) or rollout (2b) at the eyebrow.
3. Lift drawer or rollout up and out of suspension belt loop.
4. Reverse for re-installation.

CAUTION:
Screws must be re-installed in drawers and roll-outs.

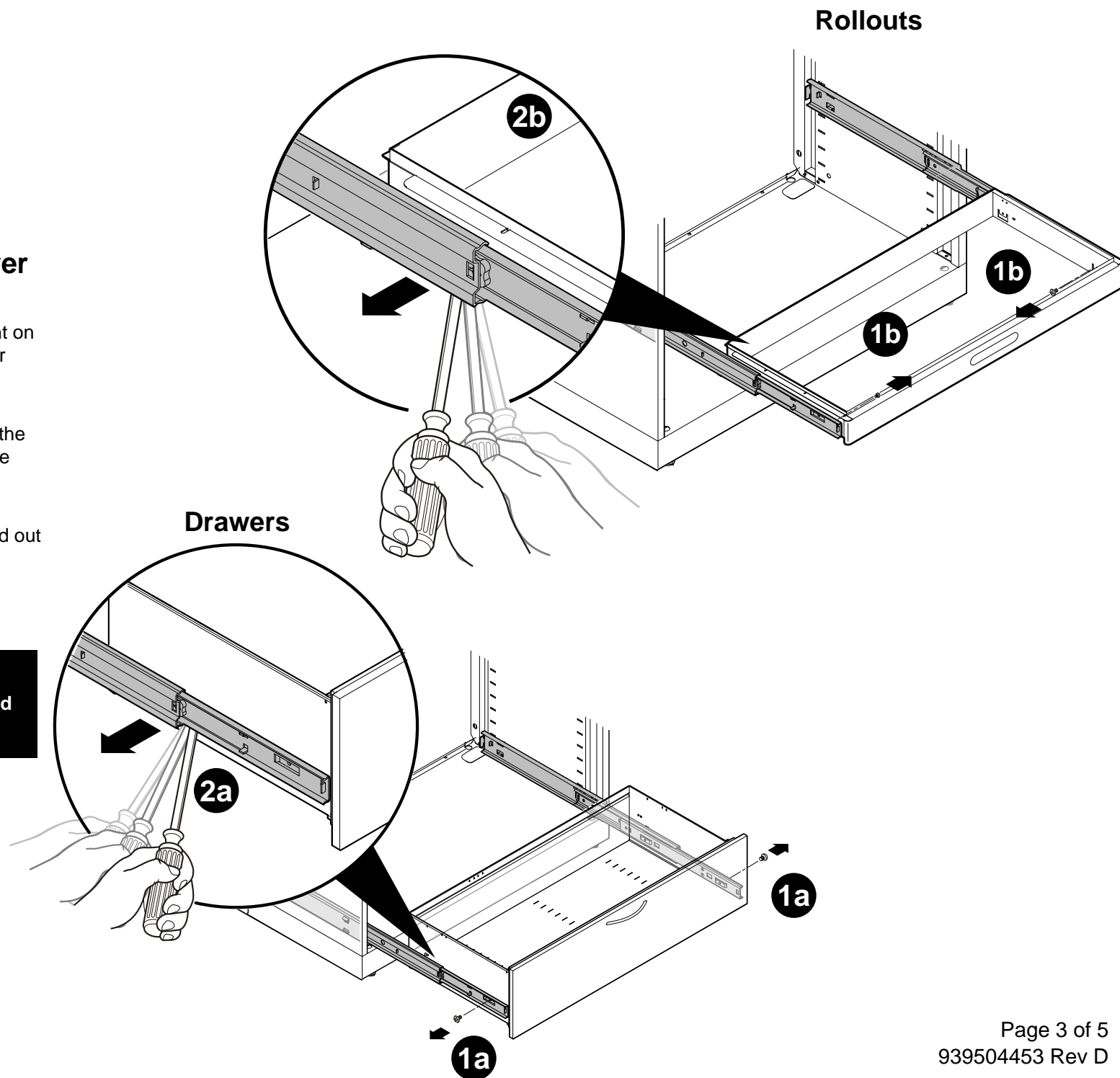

Attaching a Counterweight to a Cabinet or Tower (continued)

5. Set one (1) counterweight and cover on back ledge of cabinet base aligning with hole.
6. Secure the cover with one (1) #10-32 self-tapping screw.
7. Repeat steps 5 and 6 for each additional counterweight needed.
8. Replace drawers or rollouts by reversing steps 1-3 on page 3. Remember to put the screws back in.

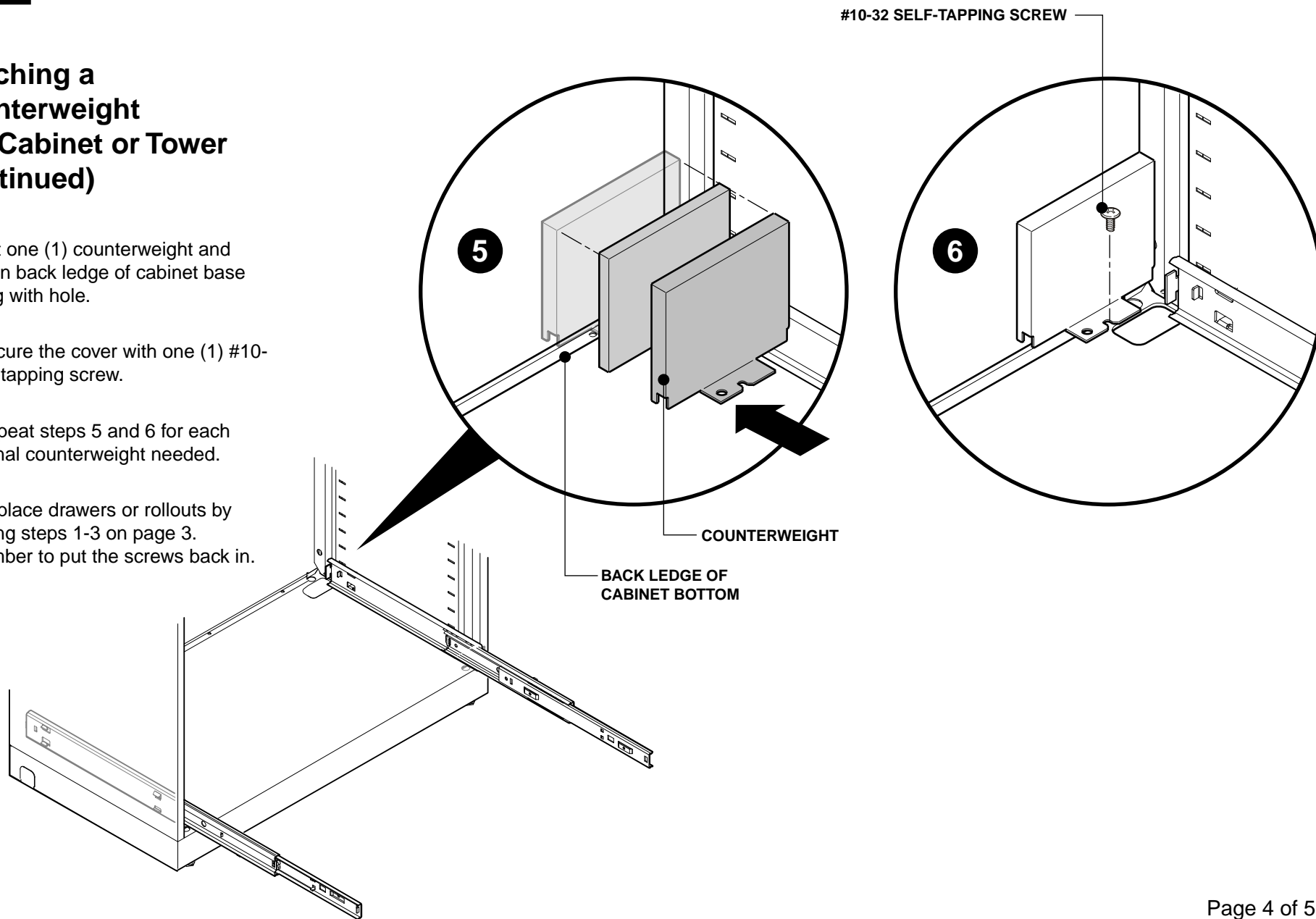

Attaching a Counterweight to a Stack and Rotate

1. Install counterweights

- a. Install counterweights onto shield.
- b. Install two (2) pan head screws into counterweights below shield.

