

(Footrest shown in the fully extended position)

If you have a problem, question, or request, call your local dealer, or Steelcase Line 1 at **888.STEELCASE** (888.783.3522) for immediate action by people who want to help you.

(Outside the U.S.A., Canada, Mexico, Puerto Rico, and the U.S. Virgin Islands, call: 1.616.247.2500)
Or visit our website: www.steelcase.com

© 2014 Steelcase Inc.
Grand Rapids, MI 49501
U.S.A.
Printed in U.S.A.

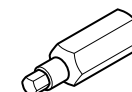
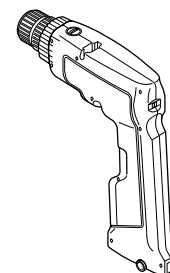

HEX DRIVE

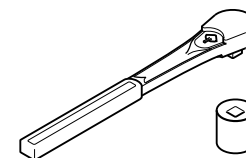
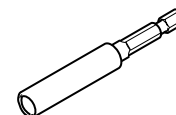

Standard or Trendelenburg Foot Tray Installation

1. Attach rear brackets to chassis.
2. Install front bracket to main slide frame with 1/4-20 x 1/2" button head cap screws.

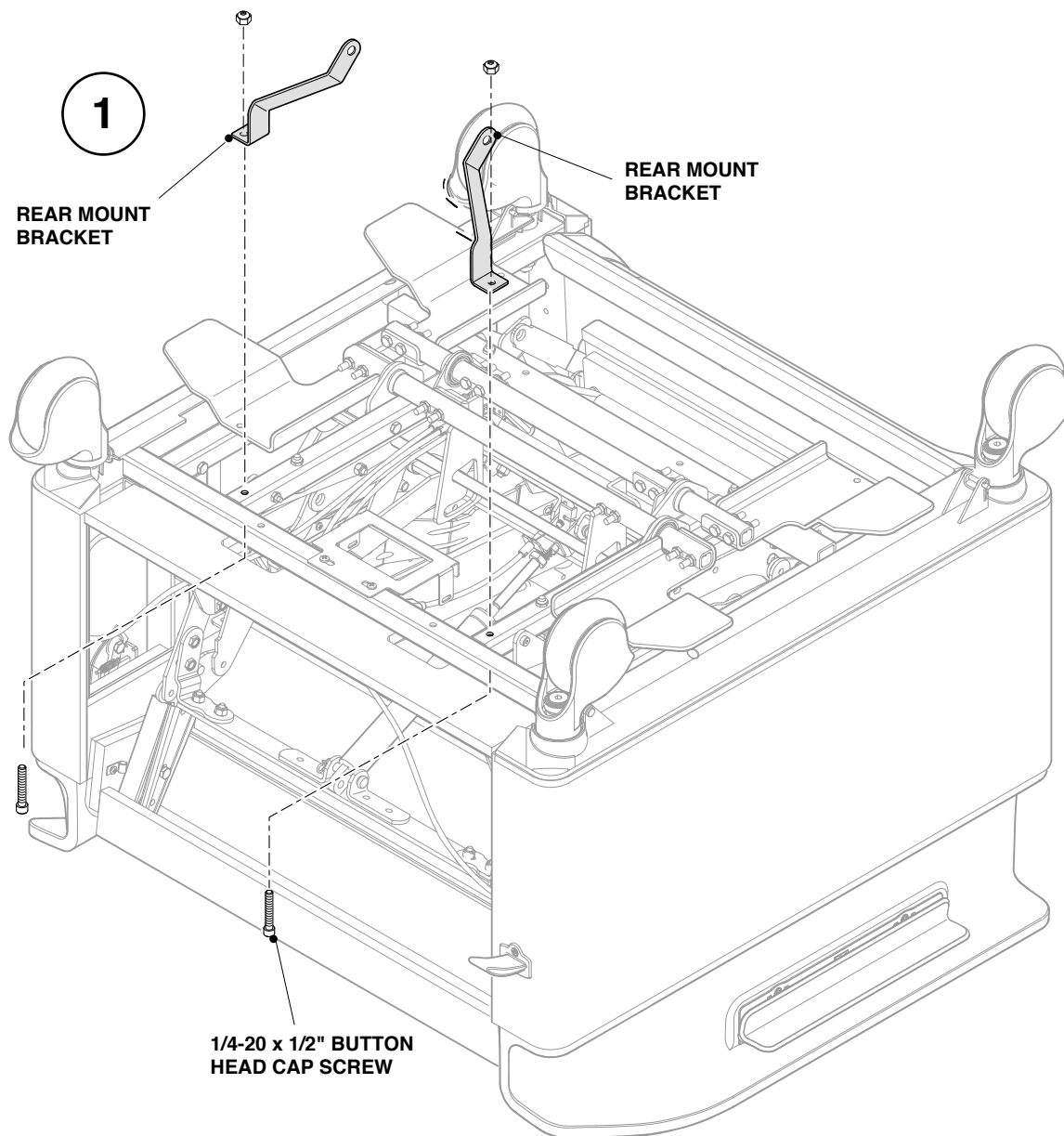
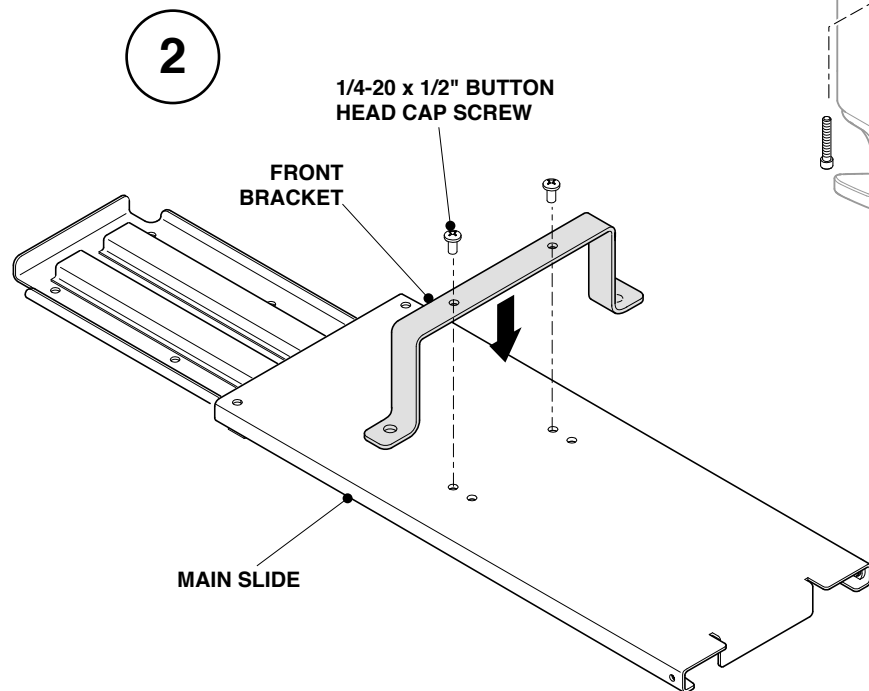

Standard or Trendelenburg Foot Tray Installation

- 3.** Position main slide frame assembly in the center of the chair frame.
- 4.** Fasten main slide frame to left and right hand rear mount brackets with 1/2-20 x 1/2 button head cap screws.
- 5.** Install front mount bracket with 1/4-20 x 3" hex bolt, spring, two (2) washers and nut as shown. Tighten bolt until the threads bottom out inside the nut. Tighten 1/4-20 x 1/2" button head cap screw after adjusting position. Repeat for the opposite side. Make sure all mounting brackets installed in step 1 are secured.
- 6.** Slide out tray (6a) and press in the direction of the arrow (6b). To ensure quiet operation, make sure hex bolts are tightened securely.

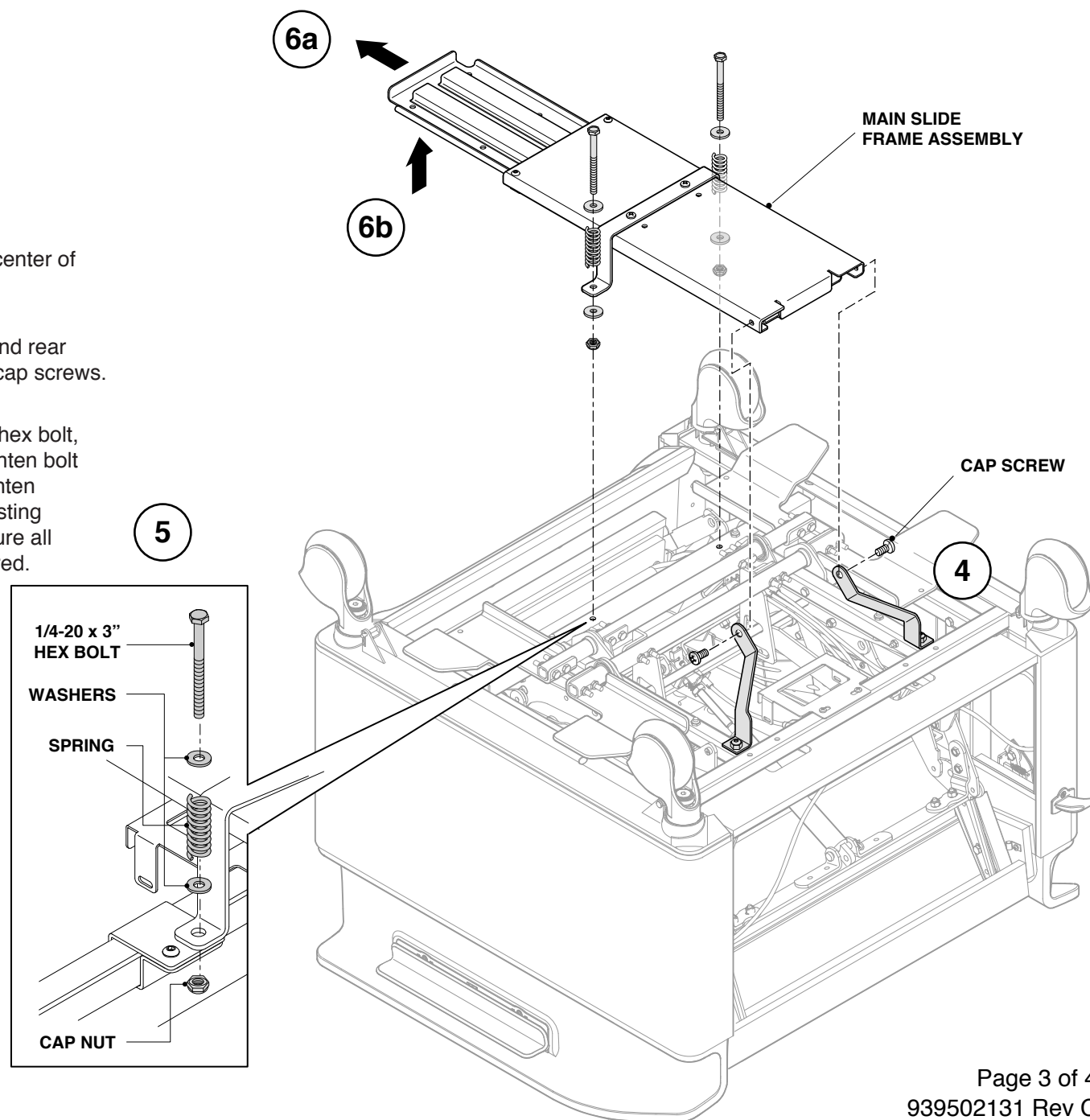

7. Position footrest, as shown, onto the slide frame assembly and install with four (4) 1/4-20 x 3/4" button head cap screws and four (4) spacers.

TEST FOOTREST

Check the tightness of the foot tray to ensure that the slide frame assembly is not loose when a person is in the standing or seated position. Tighten hex bolts, installed in step 5, until foot tray is no longer loose.

NOTE: Overtightening of hex bolts will also result in the foot tray not being able to actuate when stepped on. When this happens, please loosen the hex bolts until the foot tray is able to actuate and rest on the floor when stepped on.

