

If you have a problem, question, or request, call
your local dealer, or Steelcase Line 1 at
888.STEELCASE (888.783.3522)
for immediate action by people who want to help you.

(Outside the U.S.A., Canada, Mexico, Puerto Rico,
and the U.S. Virgin Islands, call: 1.616.247.2500)
Or visit our website: www.steelcase.com

© 2016 Steelcase Inc.
Grand Rapids, MI 49501
U.S.A.

Printed in U.S.A.

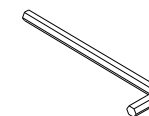

5/32" Allen Wrench

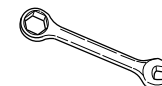

7/16" (.438") Wrench

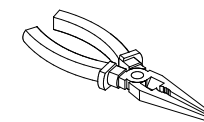

Needle Nose Pliers



Drill

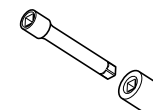

7/16" Socket & Extension

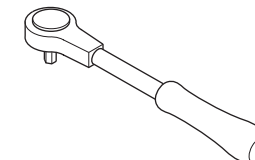

Torque Wrench

Steering Foot Pedal Replacement

1. Using 7/16 socket and wrench, remove the two (2) 1/4-20 bolts and lock nuts securing the foot pedal to the steering cross tube. Discard all removed items.
2. Install new foot pedal onto steering cross tube using the two (2) 1/4-20 bolts and lock nuts supplied. Torque lock nuts to 55 in-lbs.

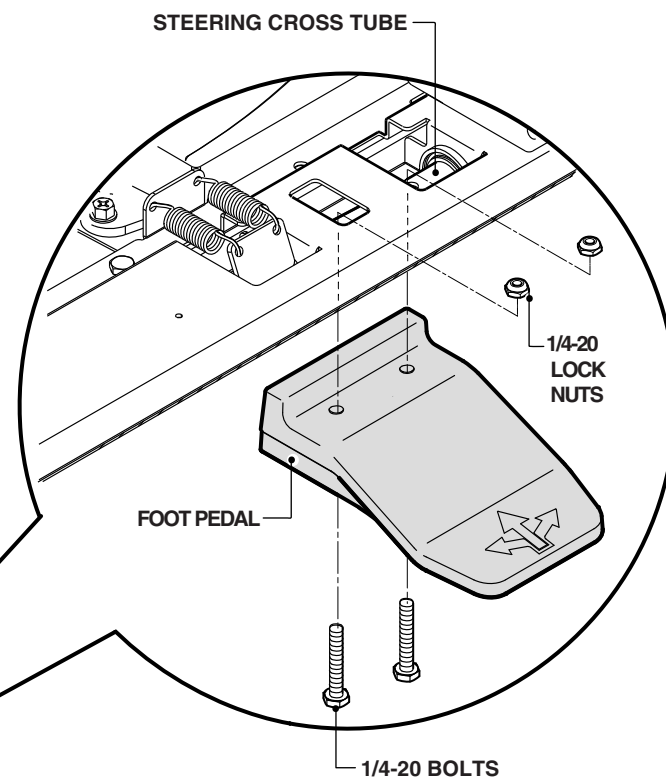
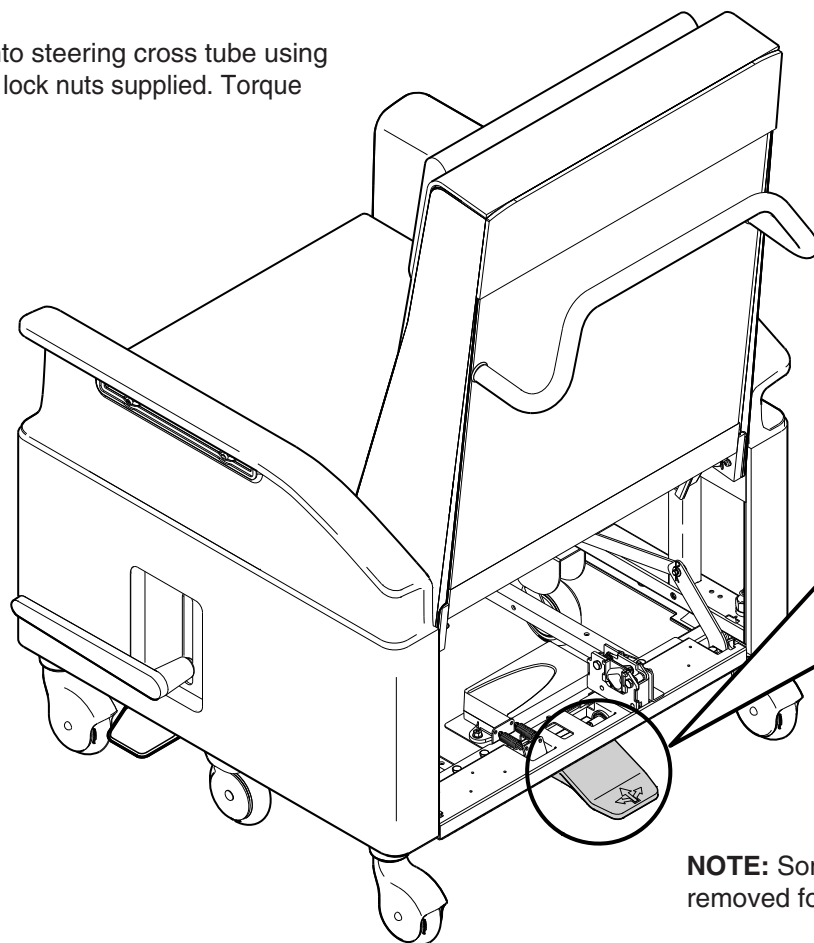

NOTE: Some detail removed for clarity.

Steering Pedal Assembly Replacement

1. Using needle nose pliers, remove and save retaining clip, washer and pin securing push rod to actuation arm at one end of the steering pedal assembly. Repeat for remaining push rod and actuation arm at the opposite end of the assembly.

2. Using 7/16 socket and wrench, remove the five (5) 1/4-20 bolts and lock nuts securing the steering pedal assembly to the chair frame. Discard pedal assembly and fasteners.

3. Align the new steering pedal assembly over the mounting holes in the chair frame and install the five (5) supplied 1/4-20 lock nuts and bolts. Torque lock nuts to 55 in-lbs.

4. Reconnect both push rods to actuation arms by reinstalling the pins, washers and retaining clips.

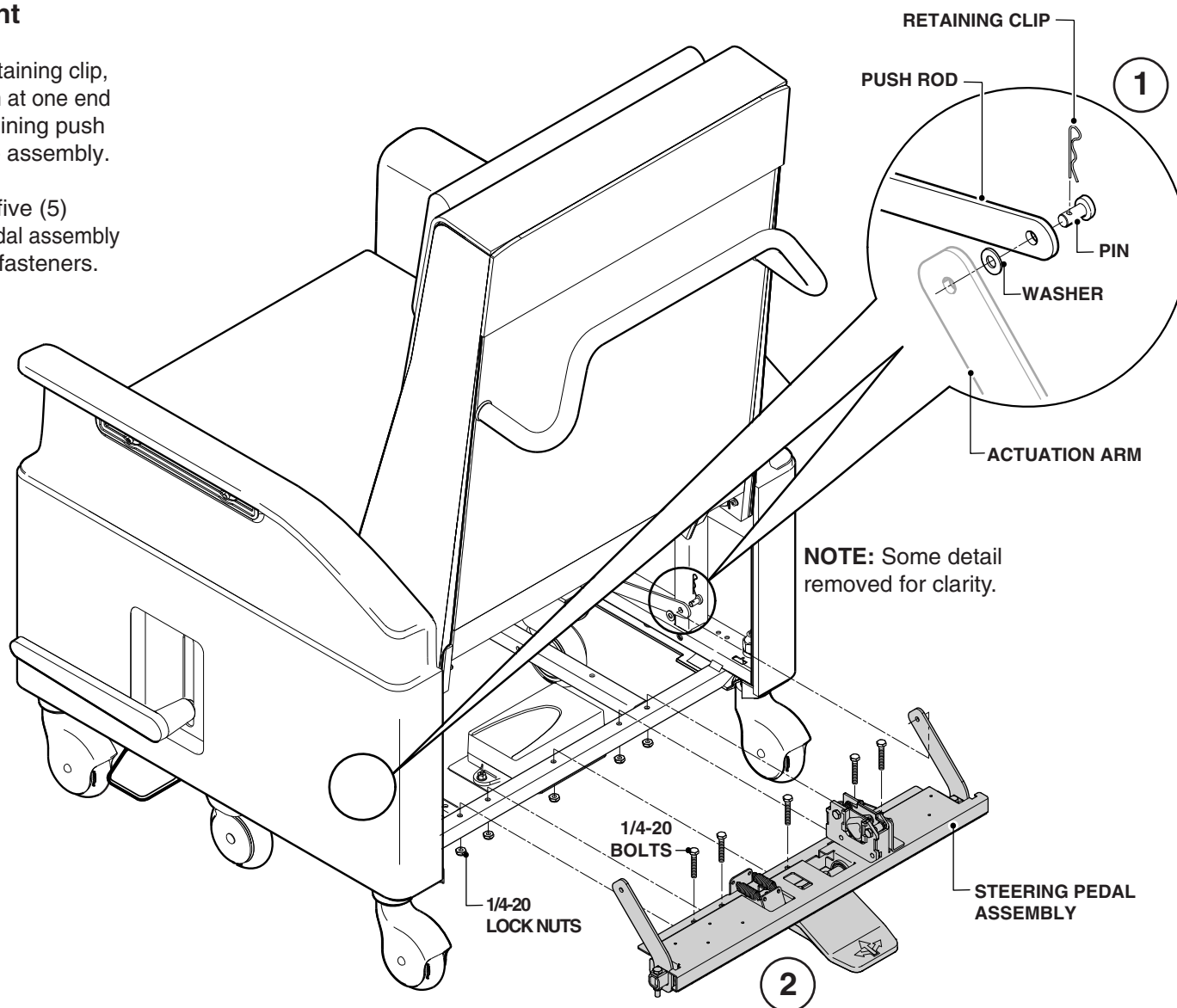

Steering Wheel Replacement

- 1.** Using 5/32" Allen wrench, remove button head screw from wheel axle shaft. Using the Allen wrench, push back through the opening in the wheel bracket to drive the remaining axle shaft out. Slight tapping may be required to help drive the axle shaft out.
- 2.** Remove the wheel and discard all parts removed.
- 3.** Align replacement wheel with mounting holes and install supplied axle shaft and button head screw. Torque fastener to approximately 30 in-lbs.

NOTE: Do not overtighten screw and ensure that wheel operates freely.

