

IMPORTANT SAFETY INSTRUCTIONS

For use with workware view Mobile Monitor Easel, EWV Series product only
For Commercial use only

When using an electrical furnishing, basic precautions should always be followed, including the following:

Read all instructions before using Mobile Monitor Easel.

DANGER - To reduce the risk of electric shock:

1. Always unplug this furnishing from the electrical outlet before cleaning.

WARNING - TO REDUCE THE RISK OF BURNS, FIRE, ELECTRIC SHOCK, OR INJURY TO PERSONS:

- Unplug from outlet before putting on or taking off parts.
- Close supervision is necessary when this furnishing is used by, or near children or people with mobility impairments.
- Use this furnishing only for its intended use as described in these instructions.
- Never operate this furnishing if it has a damaged cord or plug.
- Keep the cord away from heated surfaces.
- Do not allow the cord to fly unrestricted back into the reel.
- Do not use outdoors.
- Do not operate where aerosol (spray) products are being used or where oxygen is being administered.
- To disconnect, turn all controls to the off position, then remove plug from outlet.

WARNING: RISK OF ELECTRIC SHOCK - CONNECT THIS FURNISHING TO A PROPERLY GROUNDED OUTLET ONLY. SEE GROUNDING INSTRUCTIONS.

WARNING: RISK OF TIP OVER. DO NOT EXCEED MAXIMUM MONITOR SIZES & LOADS SPECIFIED IN TABLE 1 AND MAXIMUM SHELF LOADS SPECIFIED IN TABLE 2.

- For shelf loading, always put heavier items at the bottom to help prevent the possibility of tipping over.
- See **Figure 1**, **Figure 2** and **Figure 3** for separately orderable accessories.

SAVE THESE INSTRUCTIONS FOR OWNER/OPERATOR USE

GROUNDING INSTRUCTIONS

This product must be grounded. If it should malfunction or breakdown, grounding provides a reduction in the risk of electric shock. This product is equipped with a cord having an equipment-grounding conductor and a grounding plug. The plug must be plugged into an appropriate outlet that is properly installed and grounded in accordance with all National, State and local codes and ordinances.

DANGER - Improper connection of the equipment-grounding conductor can result in a risk of electric shock. Check with a qualified electrician if you are in doubt as to whether the product is properly grounded. Do not modify the plug provided with the product - if it will not fit the outlet, have a proper outlet installed by a qualified electrician.

This product is for use on a nominal 120-volt circuit and has a grounding plug that looks like the plug illustrated in sketch A (see **Figure 4**). Make sure that the product is connected to an outlet having the same configuration as the plug. No outlet adapter should be used with this product.

Electrical rating 120V, 60Hz, 12A.

OPERATOR INSTRUCTIONS FOR POWER REEL

1. Plug into any 120V (single phase), 3 conductor **NEMA 5-15R** outlet
2. **TO LATCH CORD** - Pull cord out to full length. Allow cord to retract 1-2 feet back into the reel. Pull cord out slowly - when a click is heard, cord will lock in place.
3. **TO RELEASE** - Pull cord out slowly until clicking stops. The lock will release and the cord can be guided back into the reel.
4. Do not overload or circuit breaker will cut off current. To restore power, remove overload, wait two minutes, then reset circuit breaker by pressing button on the side of the plug or receptacle.

MAINTENANCE INSTRUCTIONS FOR POWER REEL

1. Remove dirt and grime as soon as it accumulates on reel case by using a soft, damp cloth (a mild detergent may be used if needed), being careful not to wet the electrical plug. Never immerse any part of the unit in any slolution to clean. **DO NOT USE** solvents such as; gasoline, turpentine, etc. to clean unit.
2. Keep cord clean to assure smoothest automatic retraction. Simply pull cord to its full length and allow to retract through a dampened rag. Pull out full length again and sprinkle with talcum powder.

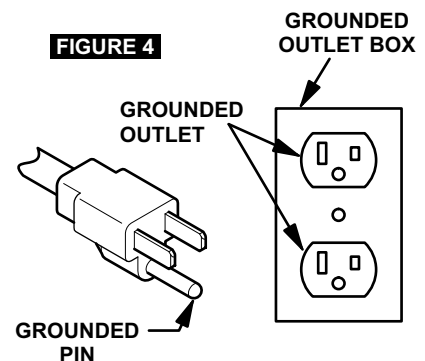

CUSTOMER SERVICE PHONE: 1-800-426-8562

HAWORTH®

E.C.O. No: 254-411

Page: 1 of 11

Part No: 7029-9839

Rev: A

TABLE 1
MAXIMUM MONITOR SIZE AND WEIGHT

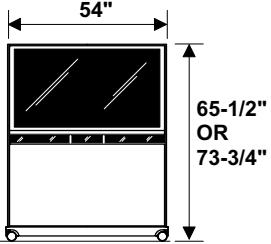
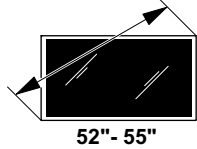
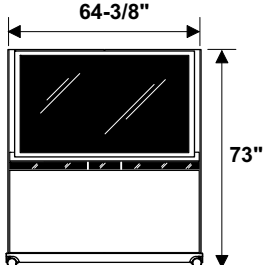
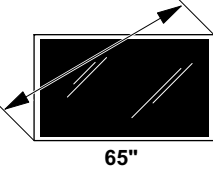
MONITOR EASEL SIZE	MAXIMUM MONITOR SIZE (Diagonal Screen Size)	MAXIMUM MONITOR LOAD (Monitor Weight)
		70 lbs 31 kg
		100 lbs 45 kg

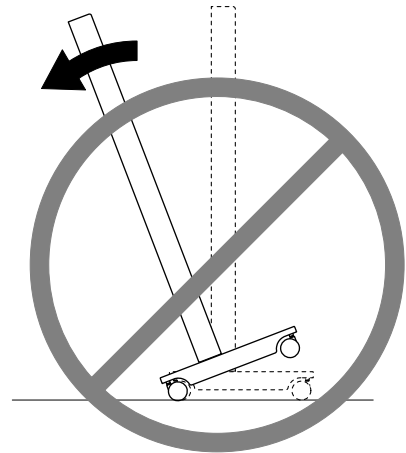
WARNING: RISK OF TIP OVER!

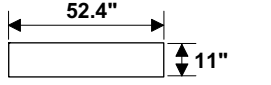
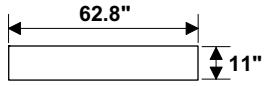
TABLE 2
**MAXIMUM LOAD FOR SEPARATELY
ORDERABLE PAINTED PANELS WITH
SHELVES**

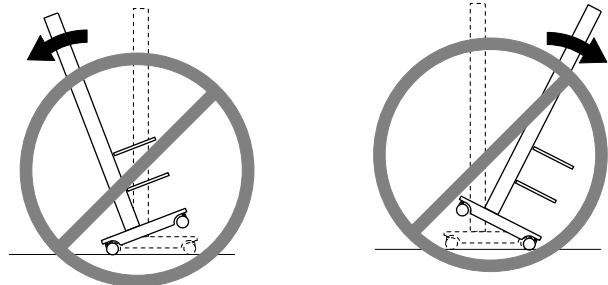
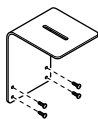
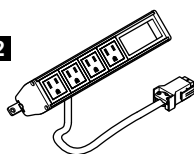
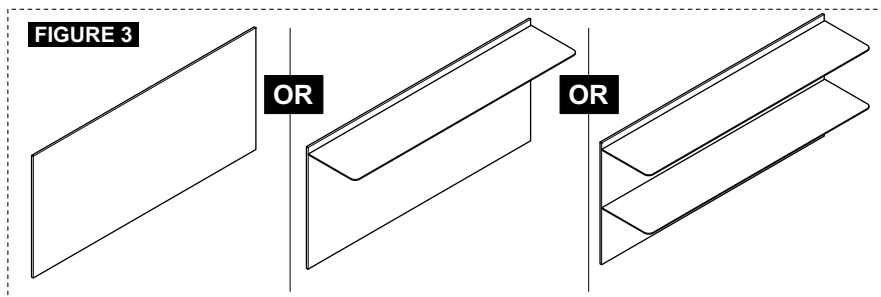
MONITOR EASEL SHELF SIZE	MAXIMUM SHELF LOAD (Weight)
	35 lbs 15 kg
	35 lbs 15 kg

WARNING: RISK OF TIP OVER!

SEPARATELY ORDERABLE ACCESSORIES
FIGURE 1

FIGURE 2

FIGURE 3

CUSTOMER SERVICE PHONE: 1-800-426-8562

HAWORTH®

E.C.O. No: 254-411

Page: 2 of 11

Part No: 7029-9839

Rev: A

workware view®
Mobile Monitor Easel
Installation Instructions

Tools Required

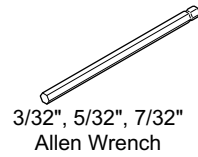
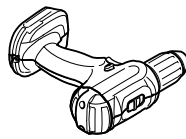
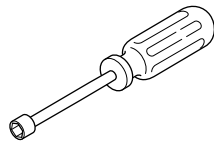
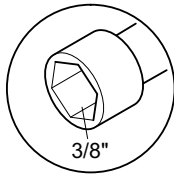
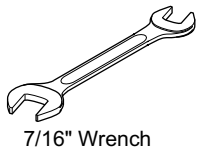

1

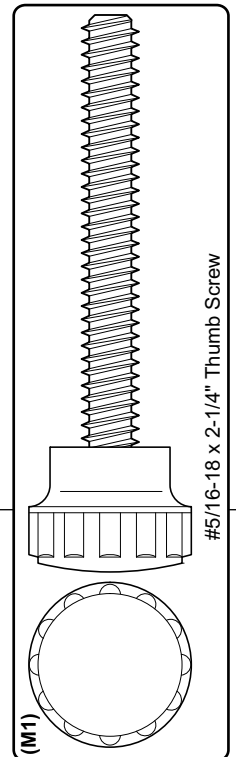
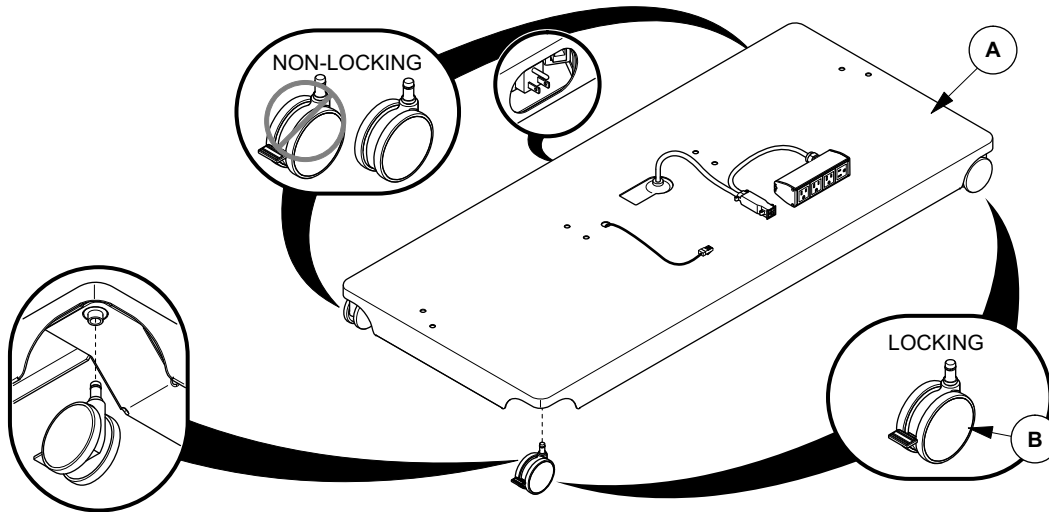

2

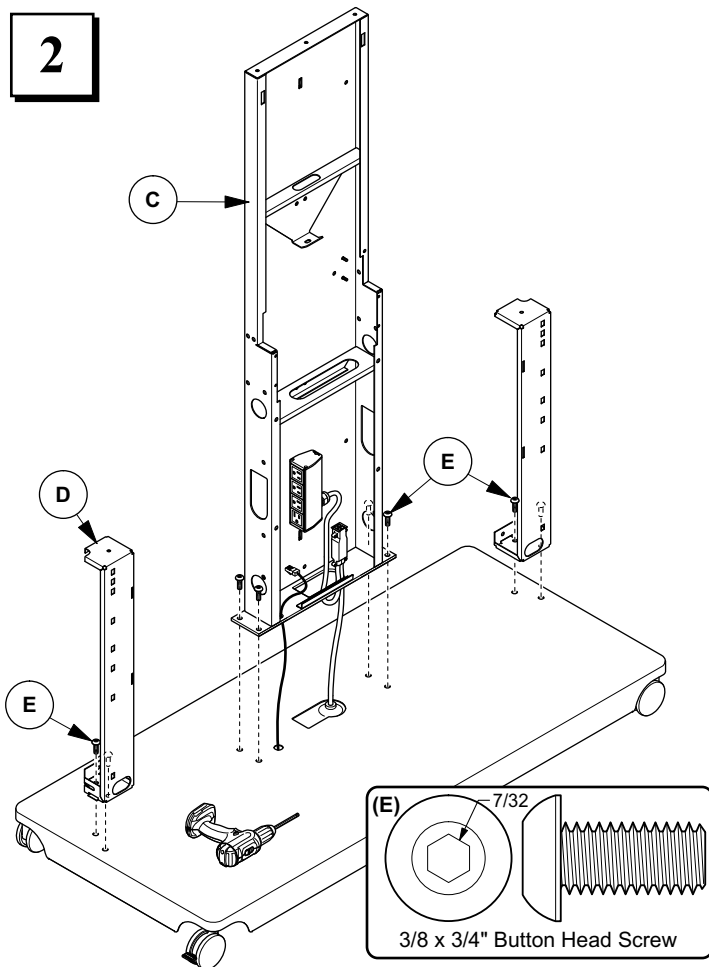

3

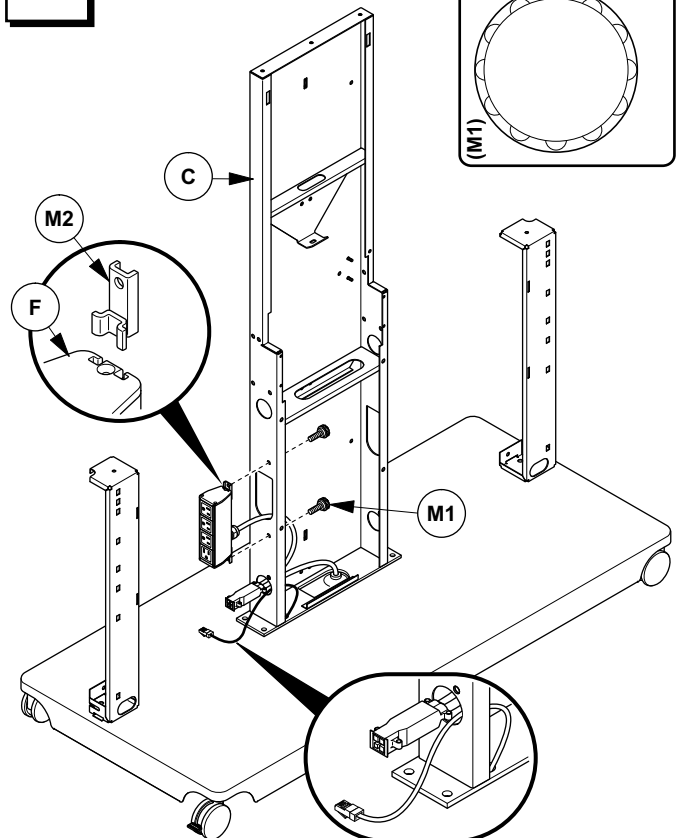

CUSTOMER SERVICE PHONE: 1-800-426-8562

HAWORTH®

E.C.O. No: 254-411

Page: 3 of 11

Part No: 7029-9839

Rev: A

FOR NON-POWER

4a

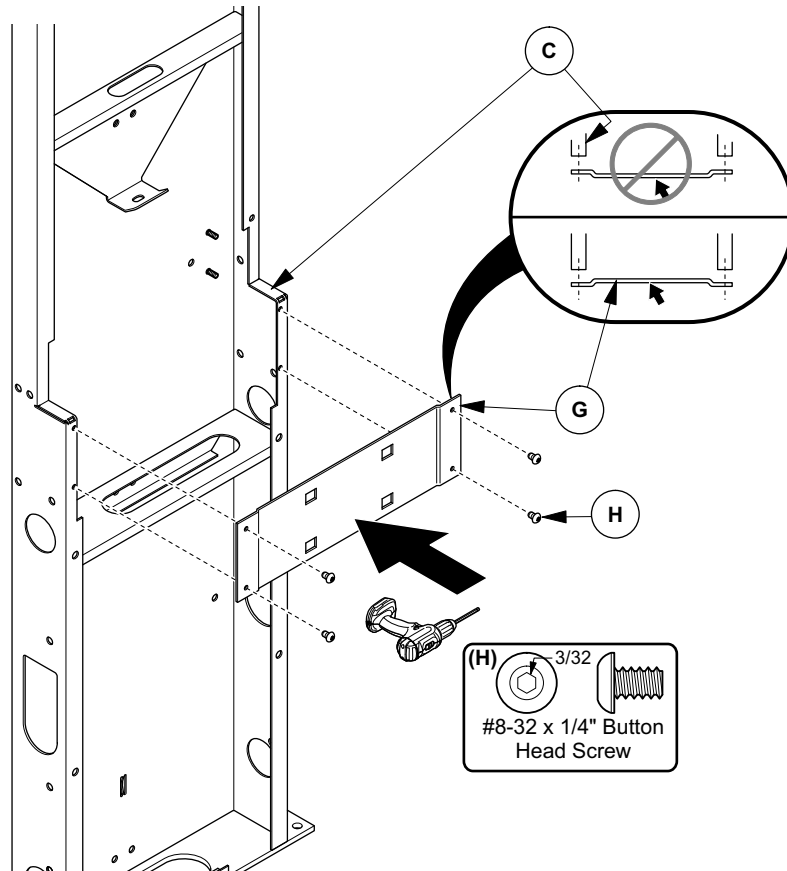

FOR POWER

4b

NOTE: Do not overtighten nuts onto studs.

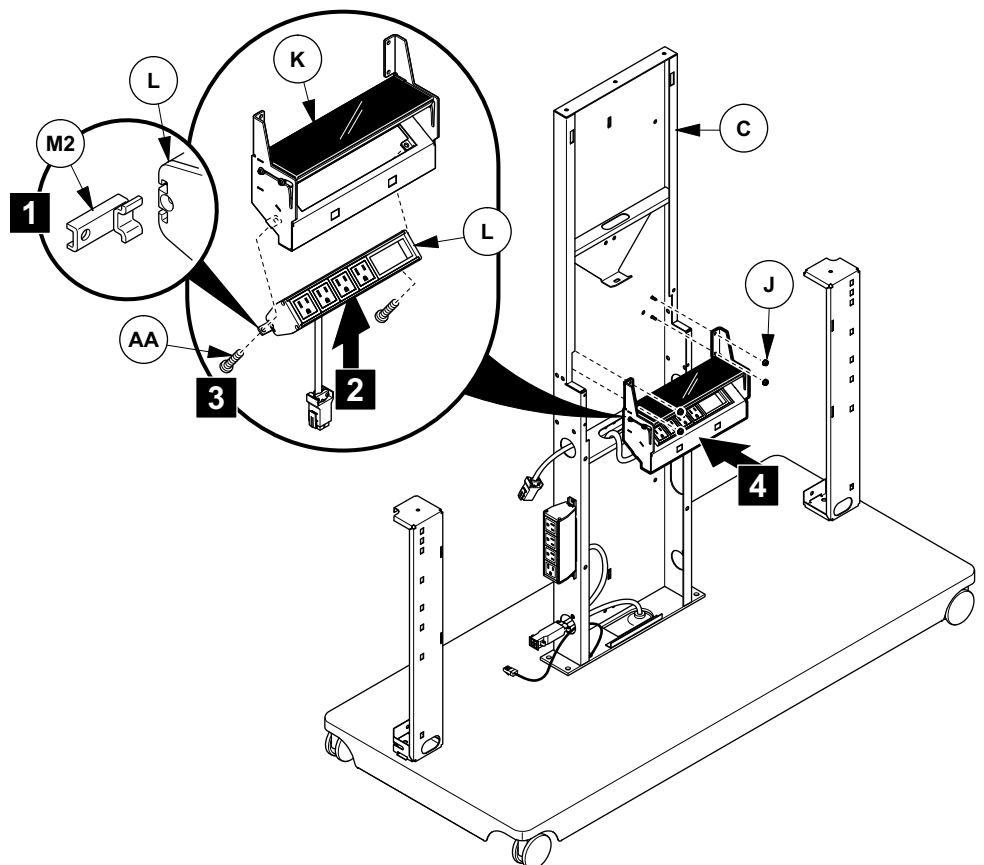
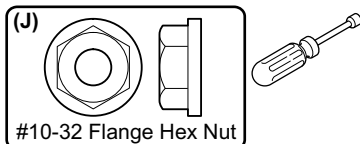
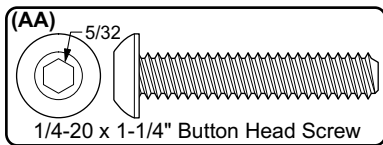
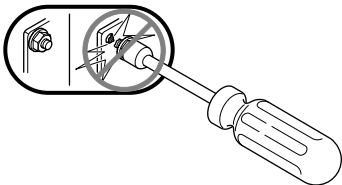

CUSTOMER SERVICE PHONE: 1-800-426-8562

HAWORTH®

E.C.O. No: 254-411

Page: 4 of 11

Part No: 7029-9839

Rev: A

NOTE: Install all screws loosely and tighten after step **3**.

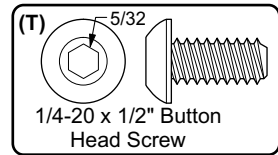

FOR POWER ONLY

Diagram 1 illustrates the assembly of the upper frame. The main structure consists of a motor unit and a control panel mounted on a frame. A callout shows the installation of a hex nut (P) and a washer (T) into the frame.

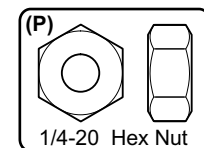
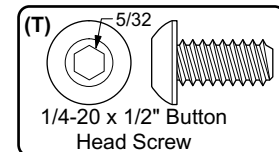

HAWORTH®

Rev: A

7

NOTE: Use caution not to damage aluminum threaded studs when placing shrouds (Q) on easel.

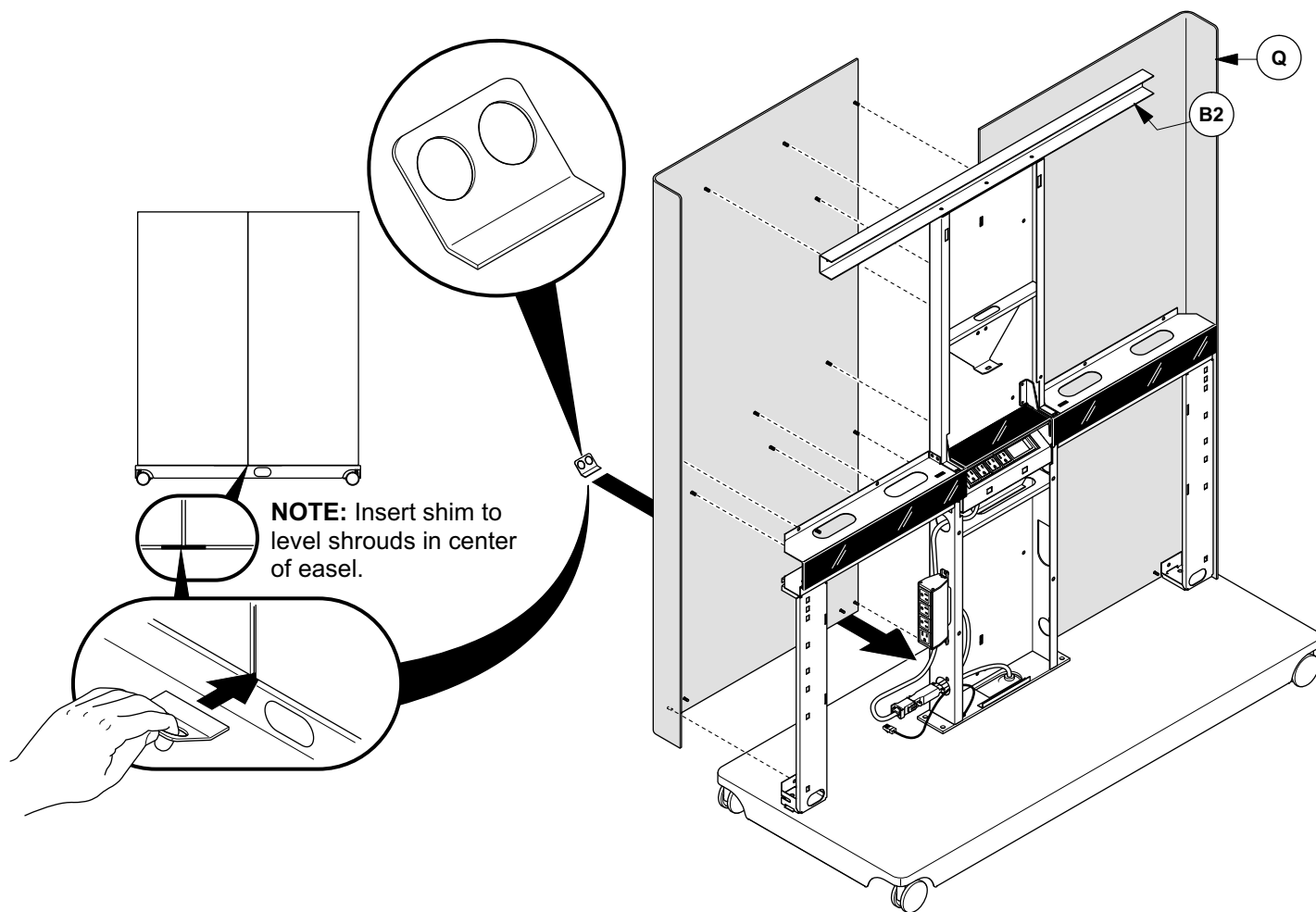

8

NOTE: Do not overtighten nuts onto aluminum studs (**10in lbs maximum**).

2

NOTE: Align shrouds (Q) vertically and horizontally.

1

NOTE: Push shrouds (Q) against stop.

3/32"

NOTE: Install nuts (J) to attach shrouds (Q). Use lubricant on threads as needed to ease assembly.

3

J

4

J

5

NOTE: Four extra studs are not required for assembly.

FOR WIDE UNITS ONLY (65")

NOTE: Install tie plate (A2) on wide units only!

7

A2

J

B2

CUSTOMER SERVICE PHONE: 1-800-426-8562

HAWORTH®

E.C.O. No: 254-411

Page: 7 of 11

Part No: 7029-9839

Rev: A

ROUTING POWER & COMMUNICATION CABLES

9

NOTE: Route all separately orderable power and communication cables (R & AB) now.

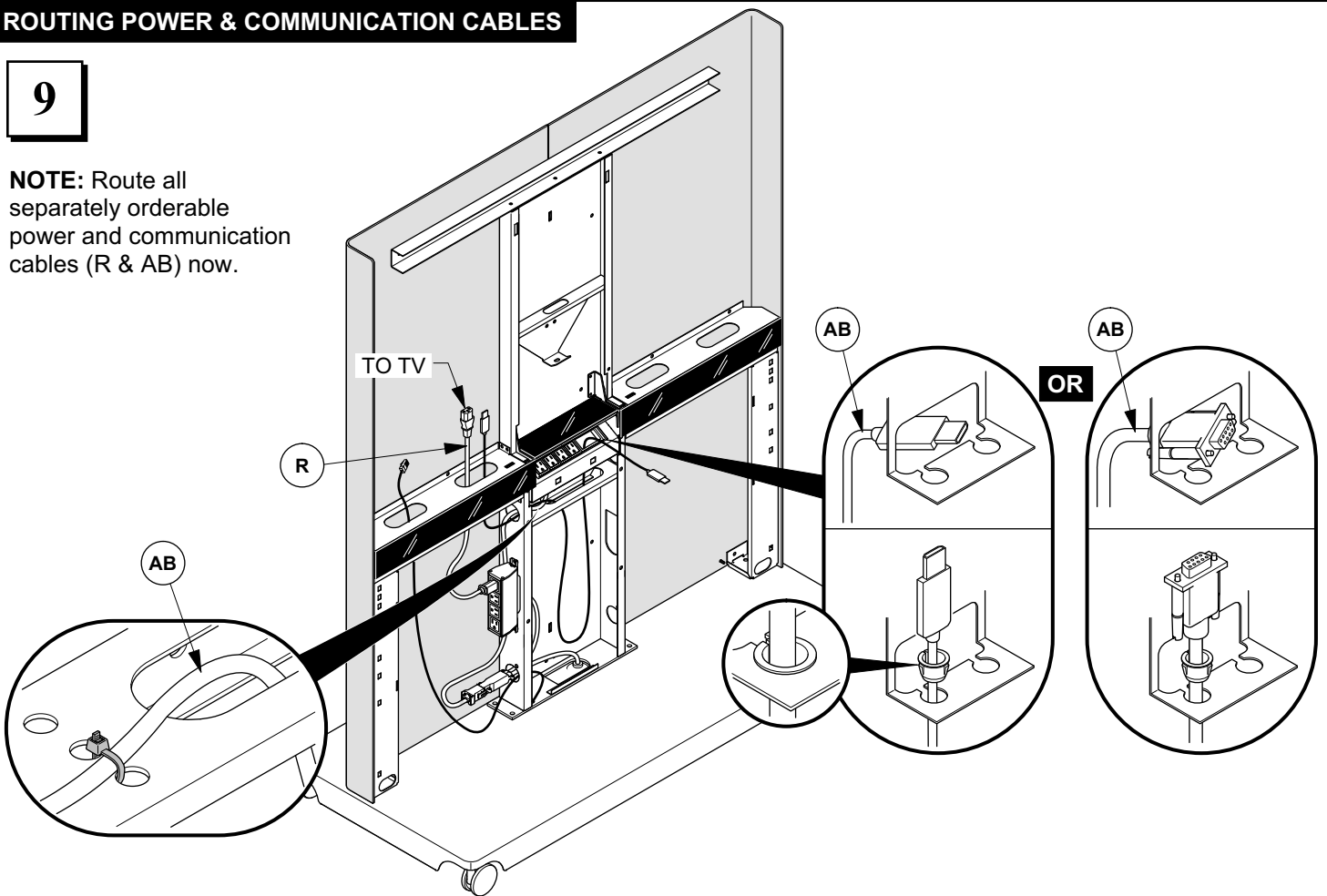

FOR STEEL PANELS WITH SHELVES

10

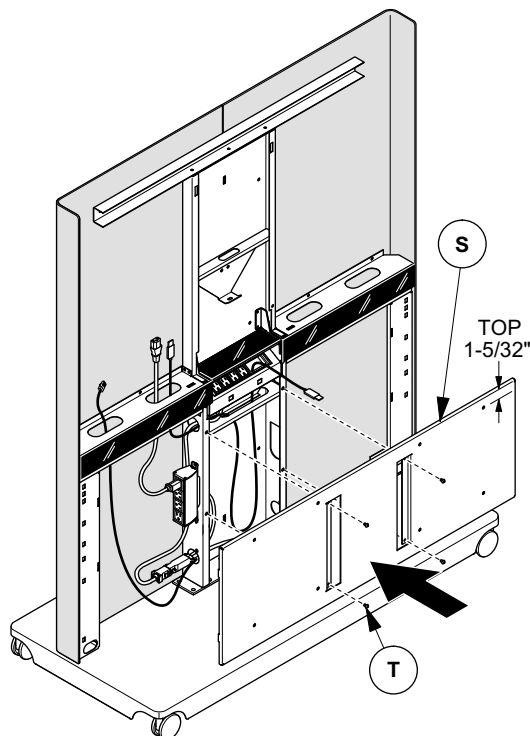
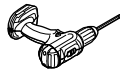
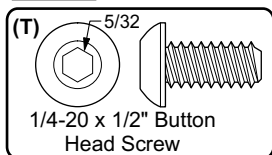

CUSTOMER SERVICE PHONE: 1-800-426-8562

HAWORTH®

E.C.O. No: 254-411

Page: 8 of 11

Part No: 7029-9839

Rev: A

11

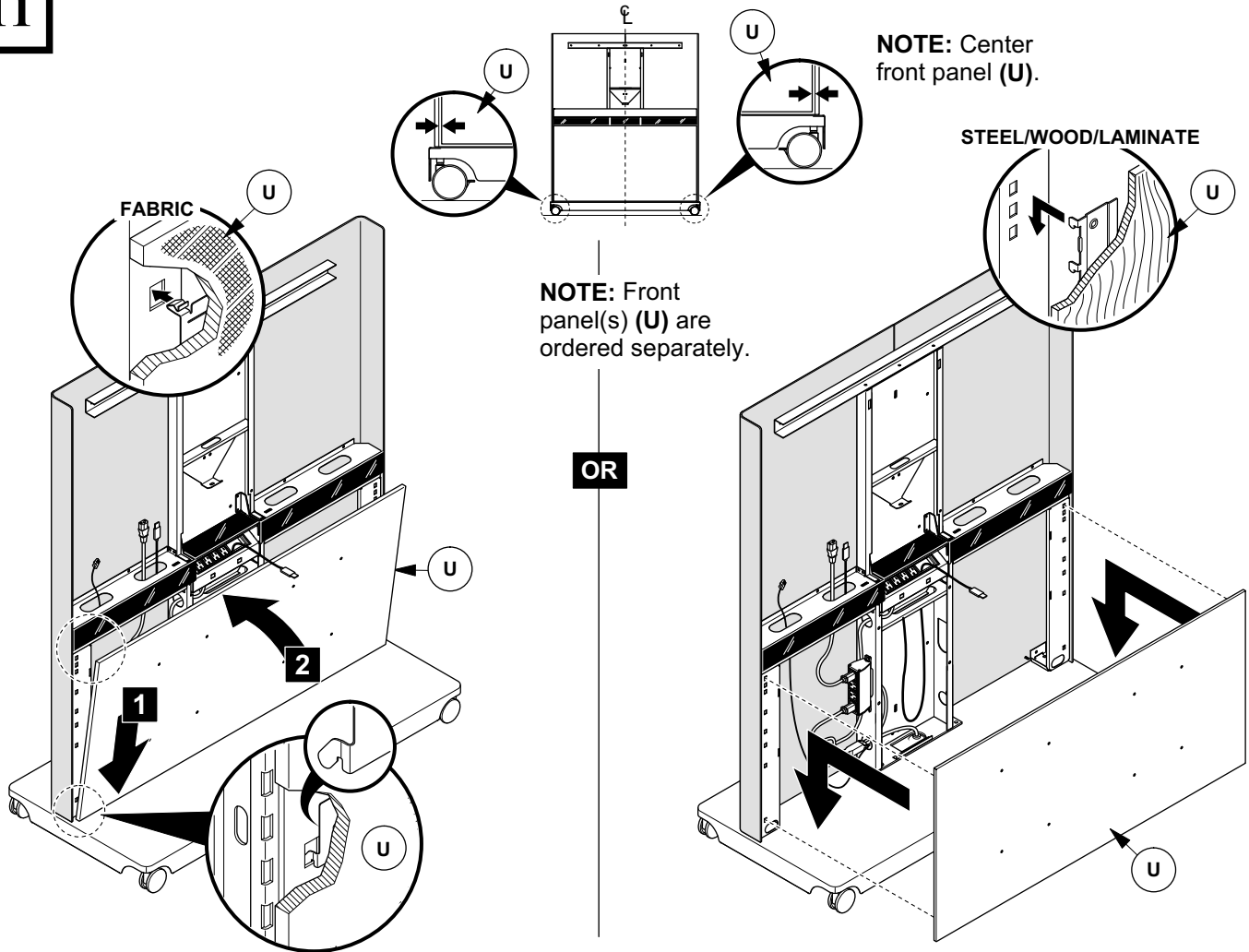

12

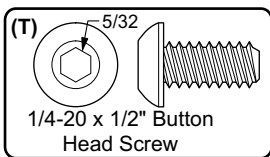

FOR STEEL PANELS WITH SHELVES

13

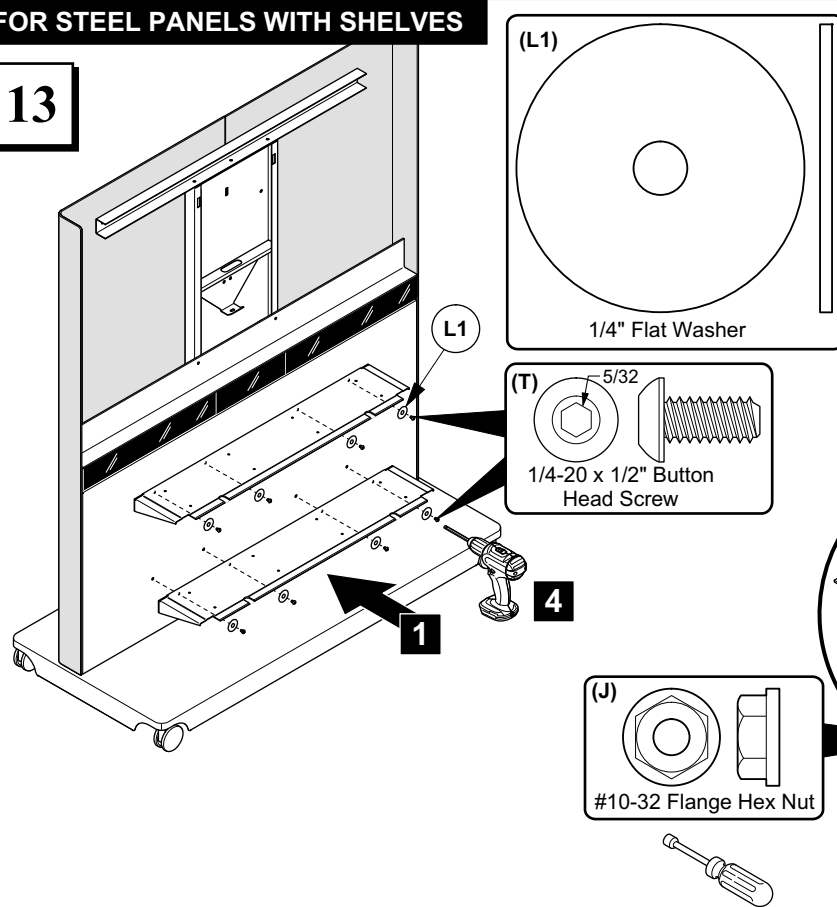

- 1 Install all screws (T) loosely
- 2 Install all nuts (J) loosely
- 3 Center shelves (W)
- 4 Tighten Screws (T)
- 5 Tighten nuts (W)

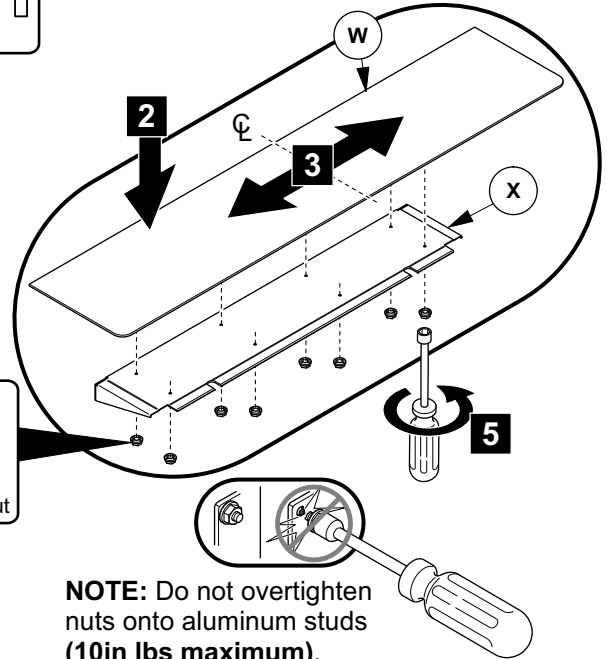
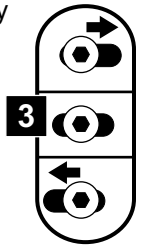

NOTE: Do not overtighten nuts onto aluminum studs (10in lbs maximum).

FOR STEEL PANELS WITH SHELVES

14

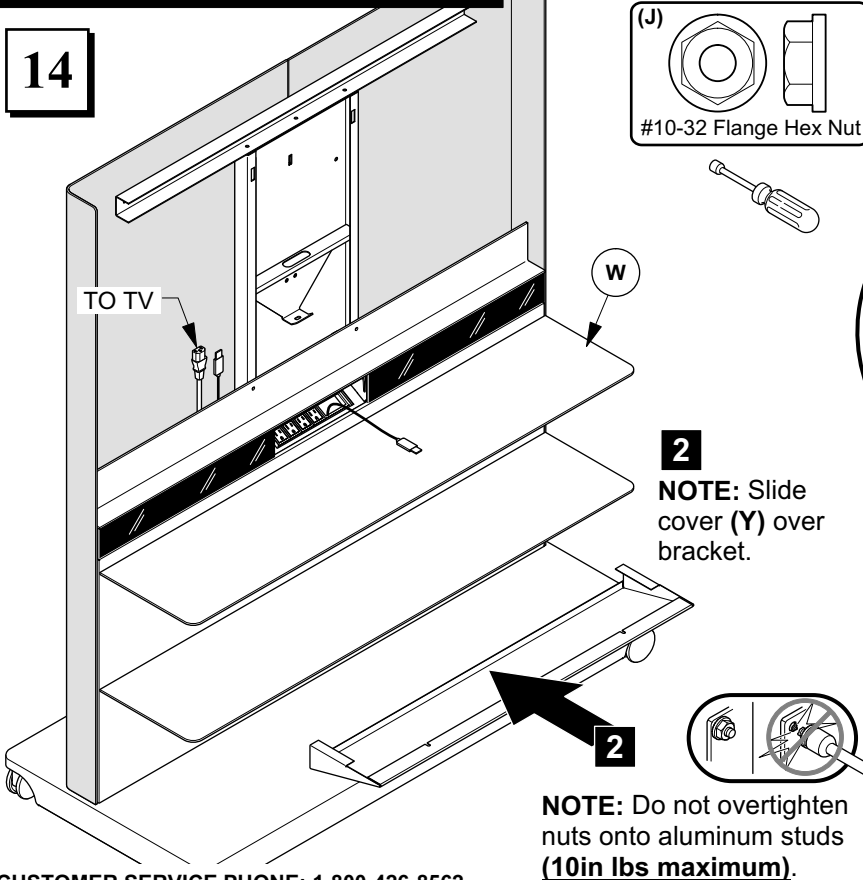

2 **NOTE:** Slide cover (Y) over bracket.

NOTE: Do not overtighten nuts onto aluminum studs (10in lbs maximum).

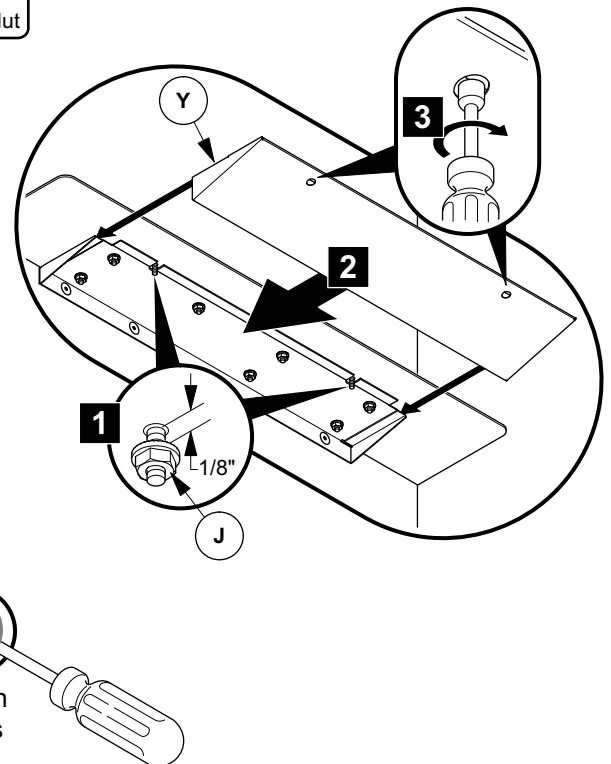

CUSTOMER SERVICE PHONE: 1-800-426-8562

HAWORTH®

E.C.O. No: 254-411

Page: 10 of 11

Part No: 7029-9839

Rev: A

15

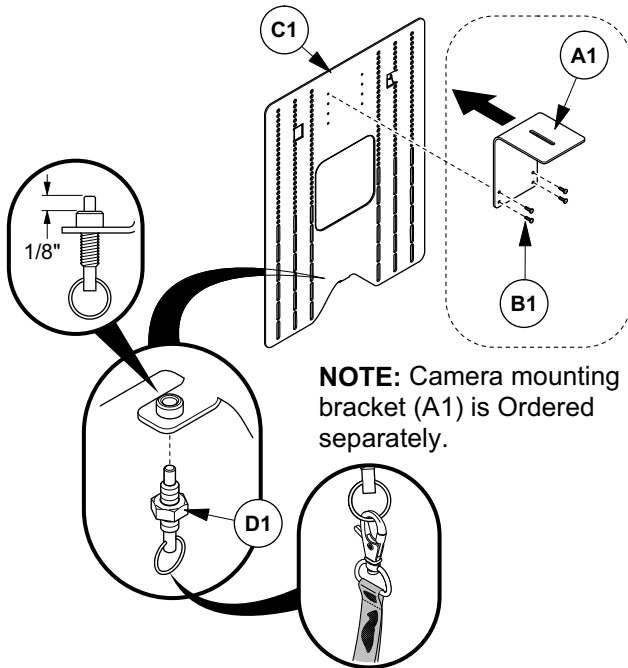
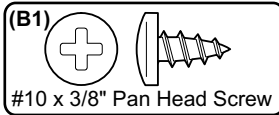

FOR TV MOUNTING

16

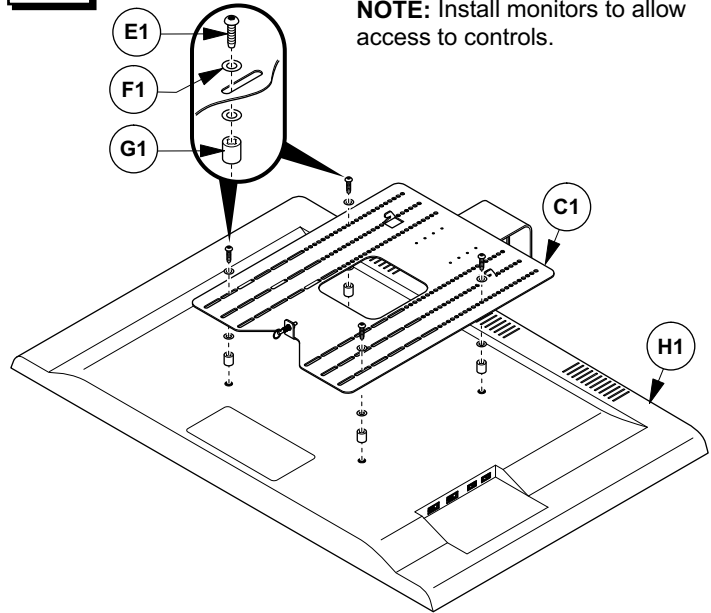

NOTE: A variety of screw (E1) sizes and spacers (G1) are provided to accommodate a wide range of TV's.

NOTE: Install monitors to allow access to controls.

17

NOTE: TV (H1) and Cable (K1) are field supplied.

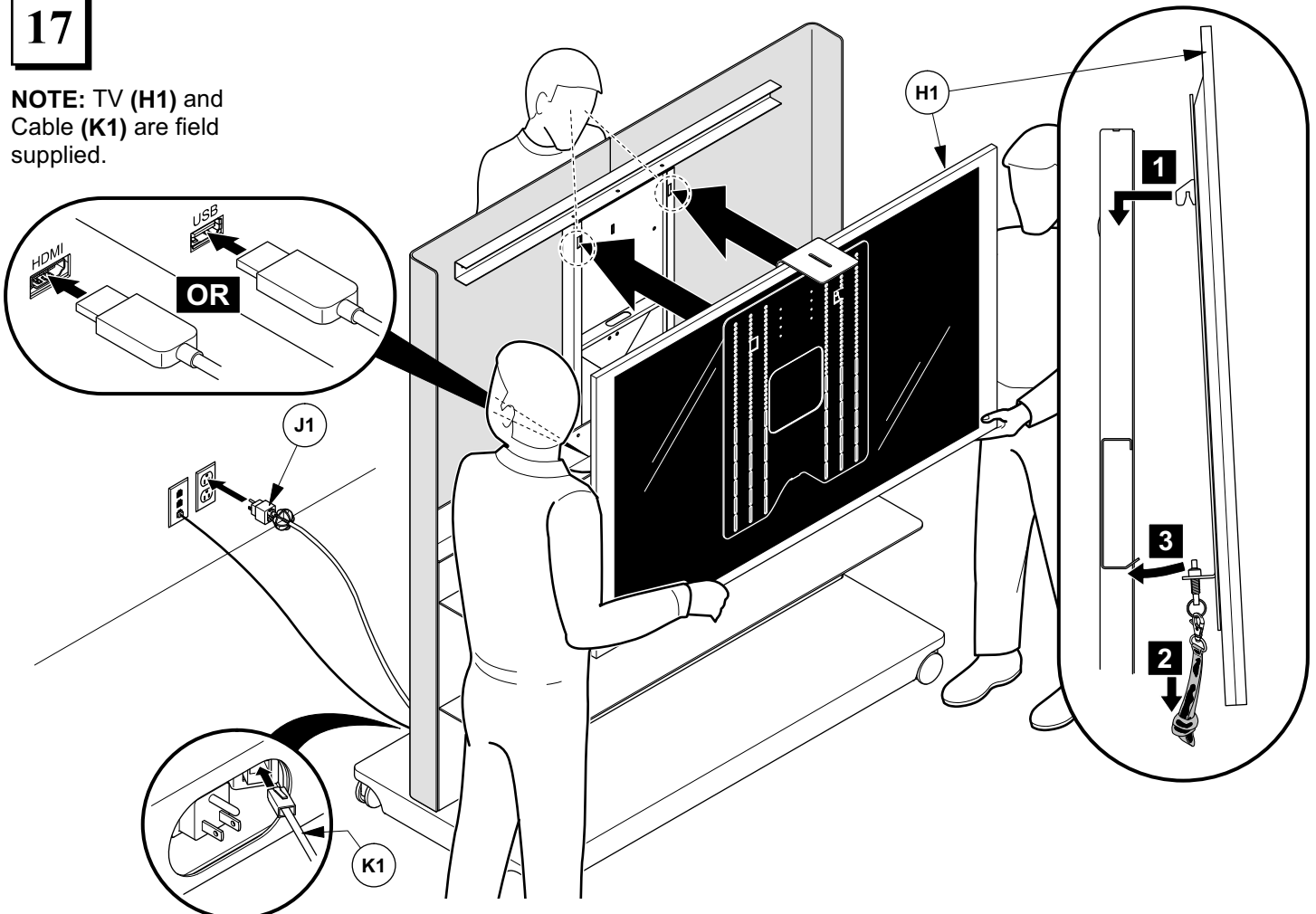

CUSTOMER SERVICE PHONE: 1-800-426-8562

HAWORTH®

E.C.O. No: 254-411

Page: 11 of 11

Part No: 7029-9839

Rev: A