

GC OCCUPANCY SENSOR

INSTALLATION INSTRUCTIONS



WARNING:

- This product must be installed in accordance with the applicable installation code by a person familiar with the construction and operation of the product and the hazards involved.
- Make sure all electrical power is turned off while installing the fixture.
- This luminaire must be adequately grounded for protection against shock hazards and to assure proper operation.
- Disconnect power before servicing.
- LEDs are ESD (Electro Static Discharge) sensitive devices that can be easily damaged if the proper ESD mitigating steps are not taken.
- LEDs are very sensitive to mechanical damage. Caution must be taken to avoid damage to the LEDs.
- ESD or mechanical damage voids all warranties.

IMPORTANT: REMOVE LABEL UNDER OCCUPANCY SENSOR LENS BEFORE INSTALLATION

FIXTURE DETAILS

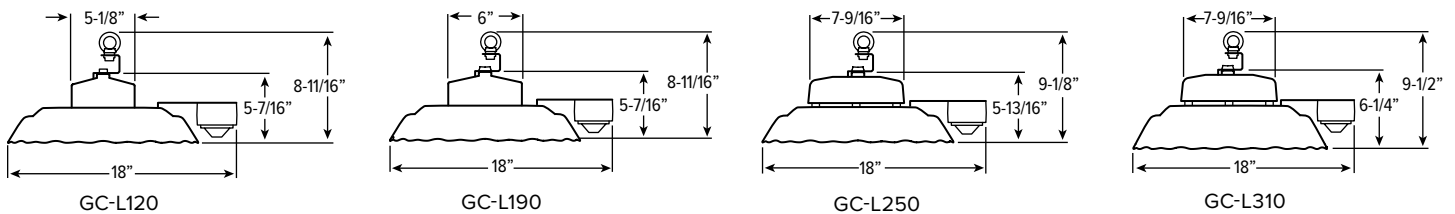

HOOK INSTALLATION

NOTE: Note: Maintain fixture balance with occupancy sensor by installing bracket to offset hook.

STEP 1: Unscrew hook to remove.

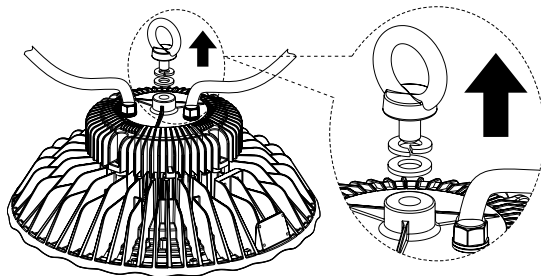

STEP 2:

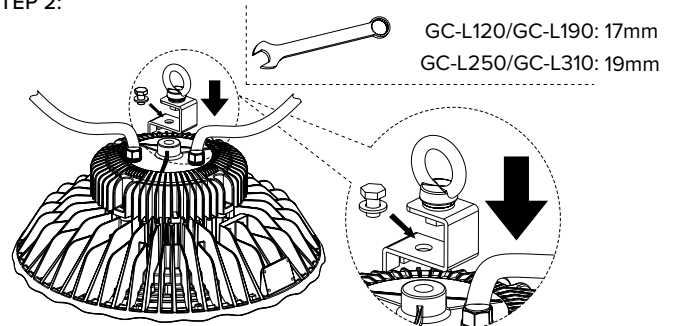

OCCUPANCY SENSOR INSTALLATION

STEP 3: Install bracket by fastening screws (A), then install PIR sensor to the bracket (B).

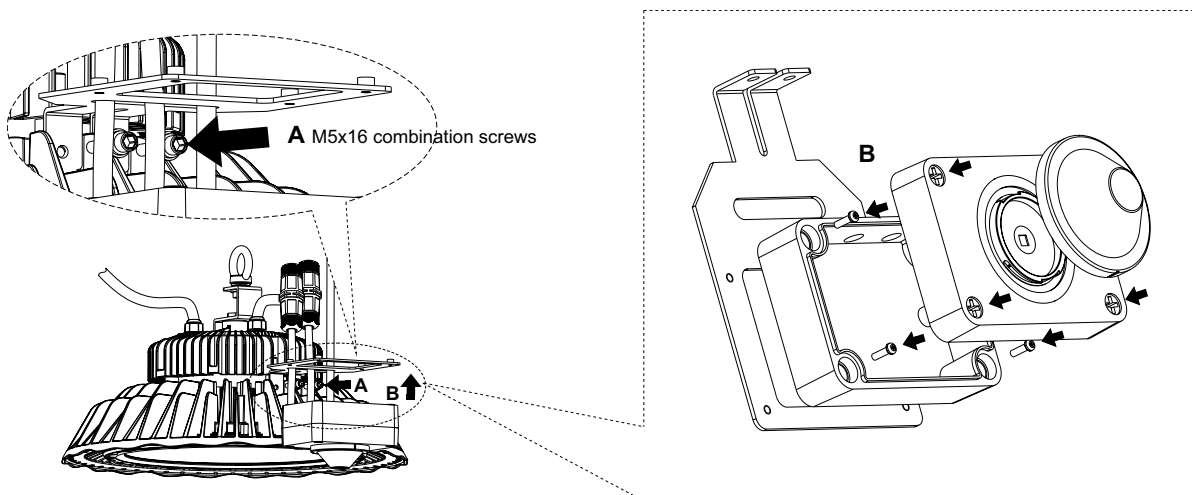

GC OCCUPANCY SENSOR

INSTALLATION INSTRUCTIONS

WIRING DIAGRAM

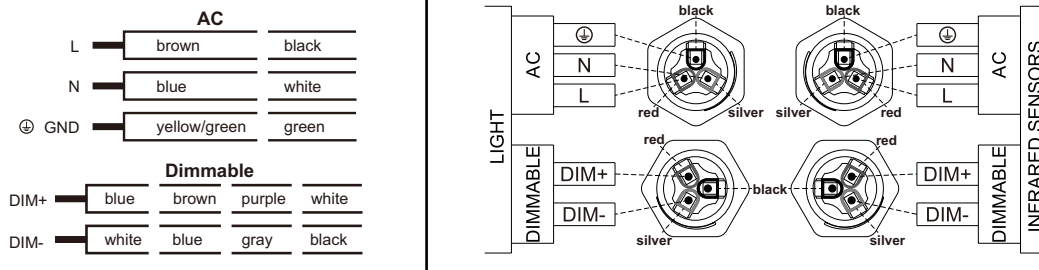

STEP 4:

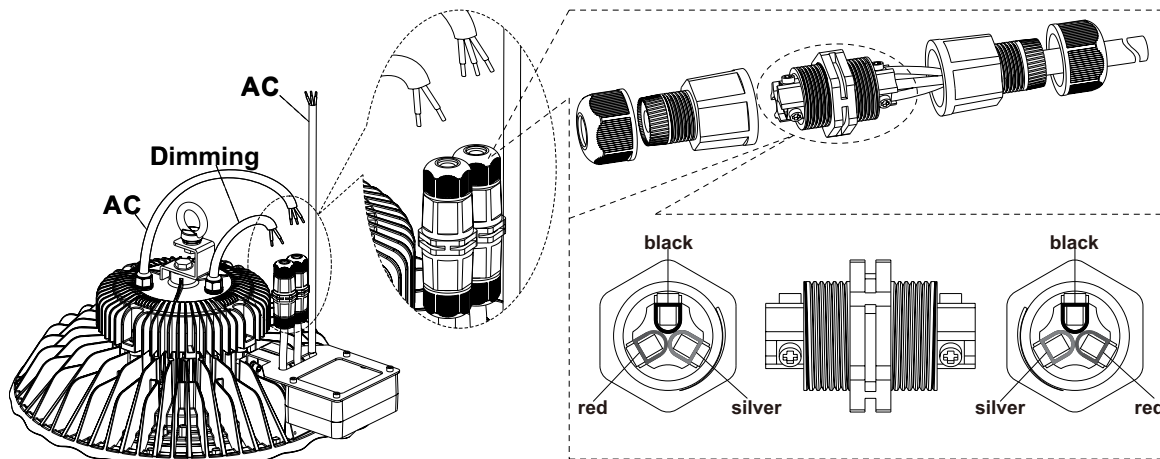

STEP 5:

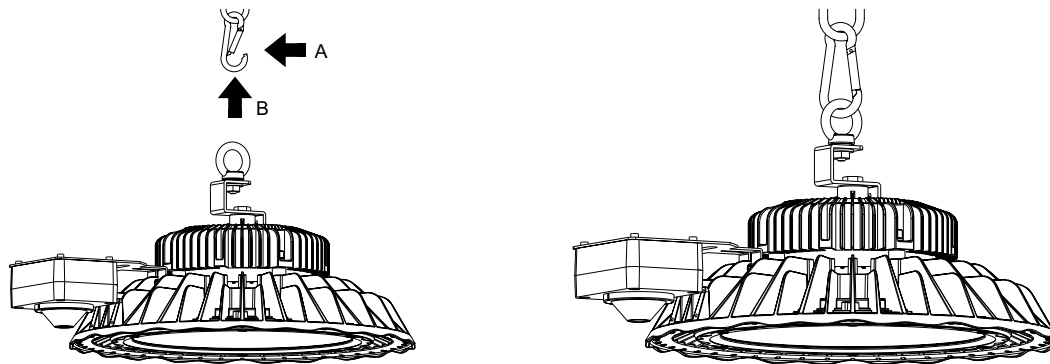

STEP 6: For GC Remote Sensor Programmer Instructions, see irtec.com