

IMPORTANT SAFETY INFORMATION for L-Base



Read the **ENTIRE IMPORTANT SAFETY INFORMATION** section at the beginning of this document including all text under subheadings therein before set up or use of this product

DANGER – To reduce the risk of electric shock:

1. Always unplug this furnishing from the electrical outlet before cleaning.

WARNING – To reduce the risk of burns, fire, electric shock, or injury to persons:

1. Unplug from outlet before putting on or taking off parts.

2. Close supervision is necessary when this furnishing is used by, or near children, invalids, or disabled persons.

3. Use this furnishing only for its intended use as described in these instructions. Do not use attachments not recommended by the manufacturer.

4. Never operate this furnishing if it has a damaged cord or plug, if it is not working properly, if it has been dropped or damaged, or dropped into water. Return the furnishing to a service center for examination and repair.

5. Keep the cord away from heated surfaces.

6. Never operate the furnishing with the air openings blocked. Keep the air openings free of lint, hair, and the like.

7. Never drop or insert any object into any opening.

8. Do not use outdoors.

9. Do not operate where aerosol (spray) products are being used or where oxygen is being administered.

10. To disconnect, turn all controls to the off position, then remove plug from outlet.

11. For chairs and similar furnishings with movable parts such as foot supports the following statement:

“WARNING: Risk of Injury – Keep children away from extended foot support (or other similar parts).”

12. For grounded products the following statement:

“WARNING: Risk of Electric Shock – Connect this furnishing to a properly grounded outlet only. See Grounding Instructions.”

13. For loading always put heavier items at the bottom and not near the top in order to help prevent the possibility of the furnishing tipping over.

14. If a surface is not intended to support video monitors such as televisions or computer monitors, one of the following statements:

‘Warning: Risk of Injury to Persons – do not place video equipment such as televisions or computer monitors on _____’ where the blank is filled in to identify the particular surface

“Warning: Risk of Injury to Persons – do not use this furnishing to support video equipment such as televisions or computer monitors.”

15. Each surface intended to support a load shall have a corresponding statement in the use instructions specifying the maximum intended load for that surface in pounds and (kilograms). Refer to 31.3.1.

IMPORTANT GROUNDING INFORMATION for L-Base

For a grounded furnishing, the instructions shall include those instructions in (a) – (c) applicable to the furnishing. For a double insulated furnishing the instructions shall include (d).

GROUNDING INSTRUCTIONS

a) For a grounded, cord-connected product rated max 15 amperes and intended for use on a nominal 120-volt supply circuit :

This product is for use on a nominal 120-volt circuit and has a grounding plug that looks like the plug illustrated in sketch A. Make sure that the product is connected to an outlet having the same configuration as the plug. No adapter should be used with this product.

b) For all other grounded, cord-connected products:

This product is for use on a circuit having a nominal rating more than 120 volts (or “This product is rated more than 15 amperes and is for use on a circuit having a nominal rating of 120 volts”) and is factory-equipped with specific electric plug to permit connection to a proper electric circuit. Make sure that the product is connected to an outlet having the same configuration as the plug. No adapter should be used with this product.

c) For a permanently connected product:

GROUNDING INSTRUCTIONS

This product must be connected to a grounded metal, permanent wiring system, or an equipment-grounding conductor must be run with the circuit conductors and connected to the equipment-grounding terminal or lead on the product.

d) For a double-insulated, cord-connected product:

SERVICING OF DOUBLE-INSULATED PRODUCTS

In a double-insulated product, two systems of insulation are provided instead of grounding. No grounding means is provided on a double-insulated product, nor is a means for grounding to be added to the product. Servicing a double-insulated product requires extreme care and knowledge of the system, and is to be done only by qualified service personnel. Replacement parts for a double-insulated product must be identical to the parts they replace. A double-insulated product is marked with the words “DOUBLE INSULATION” or “DOUBLE INSULATED.” The symbol (square within a square) is also able to be marked on the product.

SKETCH A

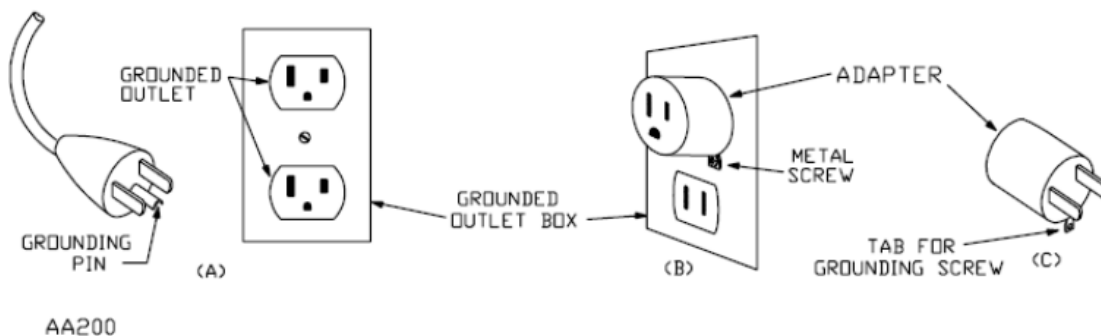

Xsede L-Base-Top Assembly

Tools Required

- Box Cutter/Utility Knife
- Cordless Drill w/#2 Phillips head bit drive
- M4 Allen Wrench key/drive (optional)
- M5 Allen Wrench key/drive (optional)

Parts Required (individual parts listed in point 2)

- 1 - L-base box (4 individual boxes)
- 1 - Work surface (60, 72)
- 1 - Work surface return (36, 42, 48)

Installation

1. Using a knife, cut straps and open box removing (4) individual boxes, 615 offset extension rails, & 810 extension rails. Unpack all components of each individual box. Each box is packed with hardware bags/components in no particular sequence. Remove work surfaces from boxes and place on non-marring surface. **See Figure A.**
2. **See parts in Figure B for shared leg attachment. Note: shared leg will be 1" longer in height.** The shared leg consists of leg, z-bracket, and z-bracket assembly. **See Figure B for attaching leg.** Use M4 Allen wrench key and 6 flat head screws to assemble shared leg. Set aside.
3. Lay mounting blade top down on a non-marring surface. Slide long tubes over top of U-bracket with cutouts atop tubes facing down. **Note: make sure brackets on tube face inward as tubes are "handed."** Drop leg in between tubes at the same time. **See Figure C.** Assemble legs and mounting blade together using M5 Allen wrench and provided mounting blade screws.
4. Using M5 Allen wrench key and (2) feet provided, attach hex bolts as show in **Figure D on next page.** Repeat steps 3 and 4 to complete both column legs assemblies.

Figure C

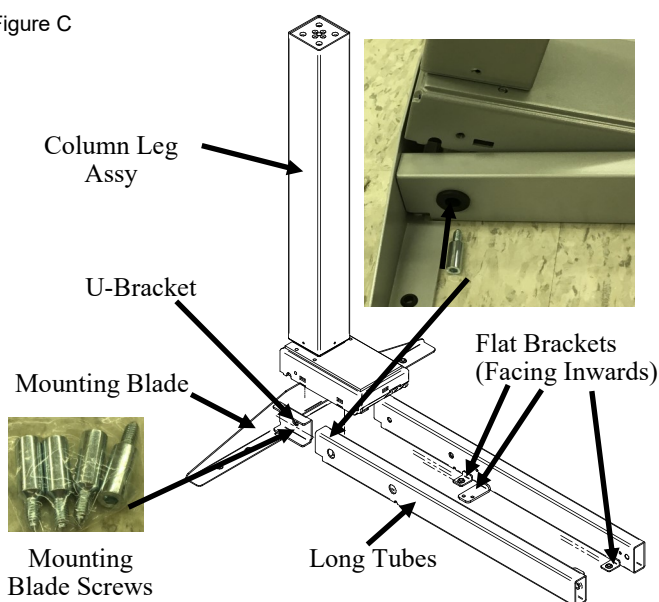
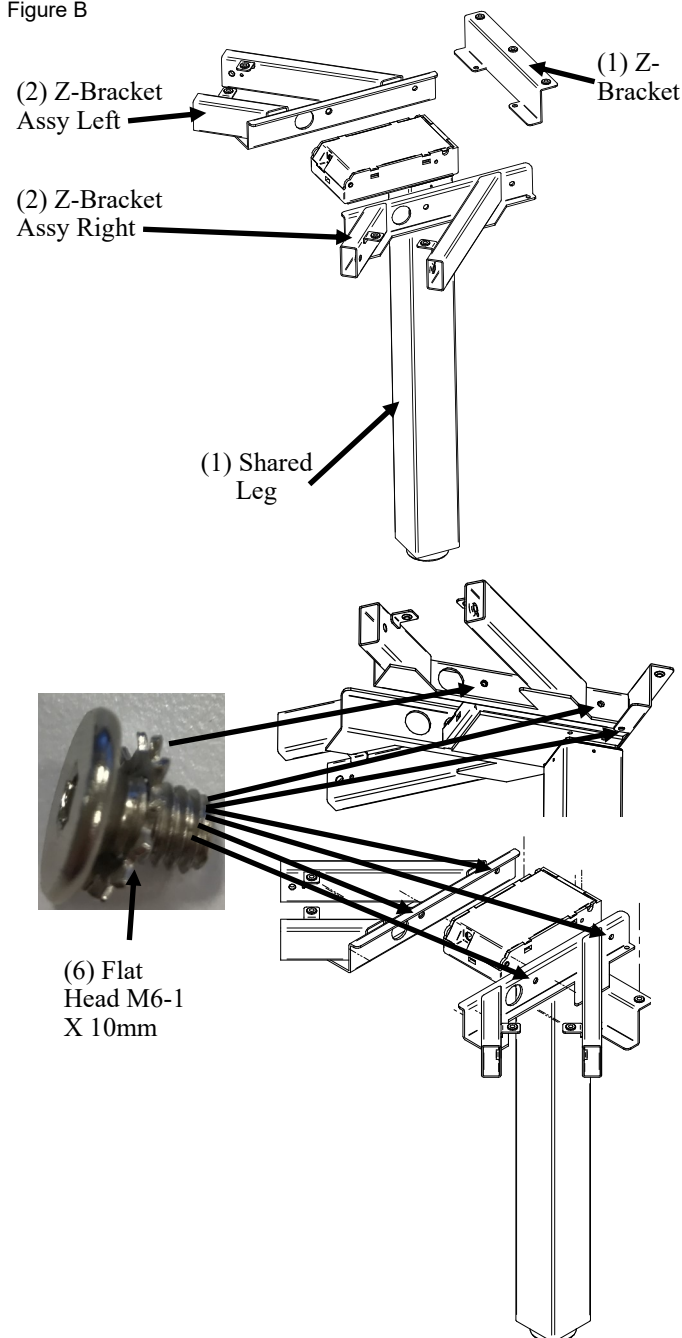

Figure A

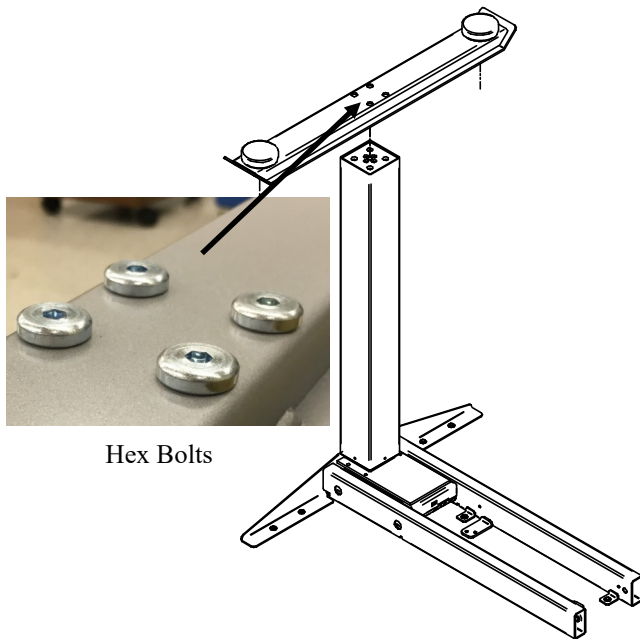

Figure B



Xsede™ Height Adjustable

Figure D



Hex Bolts

5. Place flat bracket centered along seam of return/work surface. Attach with provided work surface screws using drill/#2 Phillips drive. **See Figure E.**
6. Place shared leg at corner and both column legs near the ends of each work surface as shown in **Figure E**. Lift legs and slide correct extension rail into tubes as shown in **Figure E**. Use table below for correct extension rail to tops. Model number ie: 45F236036 equals 23" depth of work surface, 60 length of work surface, and 36" length of return work surface
10. Referring to next page, attach control box on either side of base in correct location with the provided (2) flat head screws using drill/#2 Phillips drive. After attaching control box, plug legs and shared leg into control box. **See Figure F**
Note: See KimballOffice.com, Xsede HA set up guide for resetting programmable and Up/Down switches.
5. Plug Up/Down switch into "Ethernet" looking port and use Up/Down switch cord management groove in tubes. Up/Down switch can be mounted in any location. **See Figure G.**
6. Plug power cord in opposite end of control box.
7. Refer to base locations in Figure H. Locate legs and shared legs according to base locations. Position extension rails in between tubes.
8. Using M4 Allen wrench, tighten set screws on the inside of tubes. **See Figure H.**
9. Attach work surfaces to base using drill/#2 Phillips drive and provided work surface screws packed in base box. **See Figure I.**

Figure E

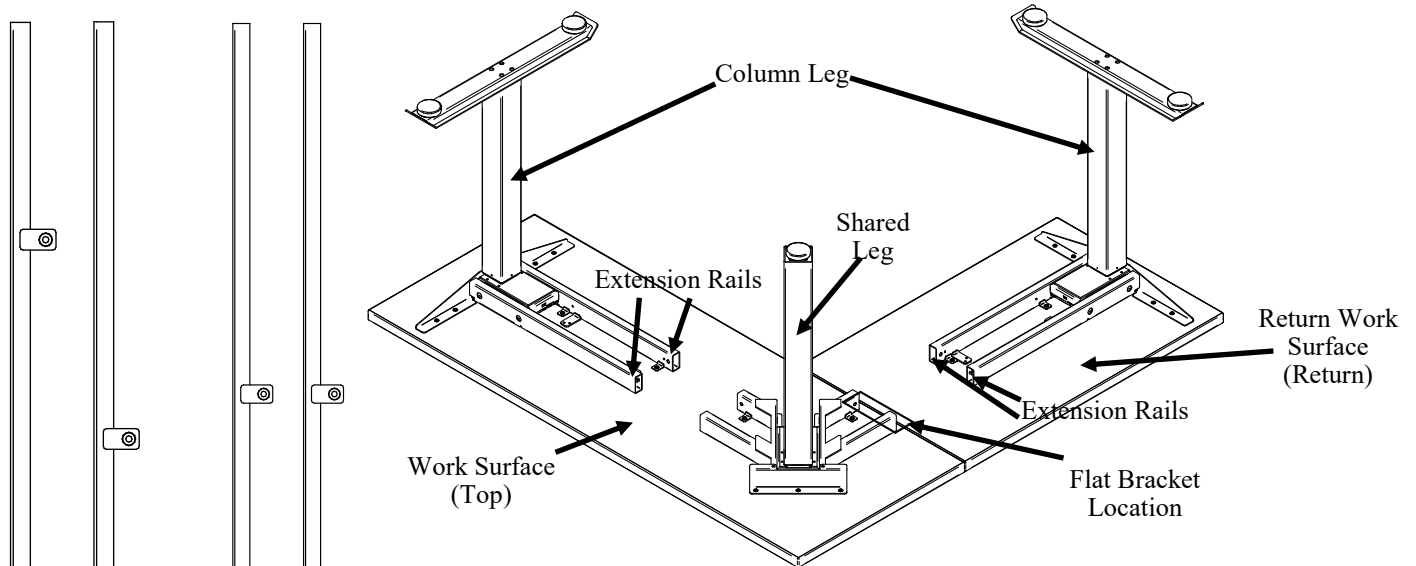

MODEL DESCRIPTION	EXTENSION RAIL TOP	EXTENSION RAIL RETURN
45F236036TBLSEL*	615 OFFSET RAIL	615 OFFSET RAIL
45F236042TBLSEL*	615 OFFSET RAIL	615 OFFSET RAIL
45F236048TBLSEL*	615 OFFSET RAIL	810 RAIL
45F237236TBLSEL*	810 RAIL	615 OFFSET RAIL
45F237242TBLSEL*	810 RAIL	615 OFFSET RAIL
45F237248TBLSEL*	810 RAIL	810 RAIL
45F296036TBLSEL*	615 OFFSET RAIL	615 OFFSET RAIL
45F296042TBLSEL*	615 OFFSET RAIL	810 RAIL
45F297236TBLSEL*	810 RAIL	615 OFFSET RAIL
45F297242TBLSEL*	810 RAIL	810 RAIL

Proper product installation, in accordance with these instructions, is the responsibility of the installing agent. If you have any questions concerning these instructions, please call Kimball Office Customer Care.

Kimball®Office

Figure F

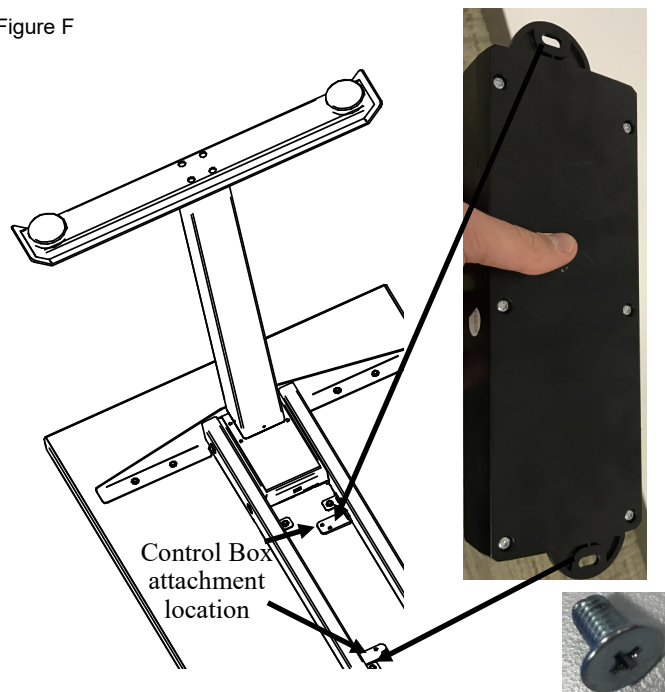

Figure G

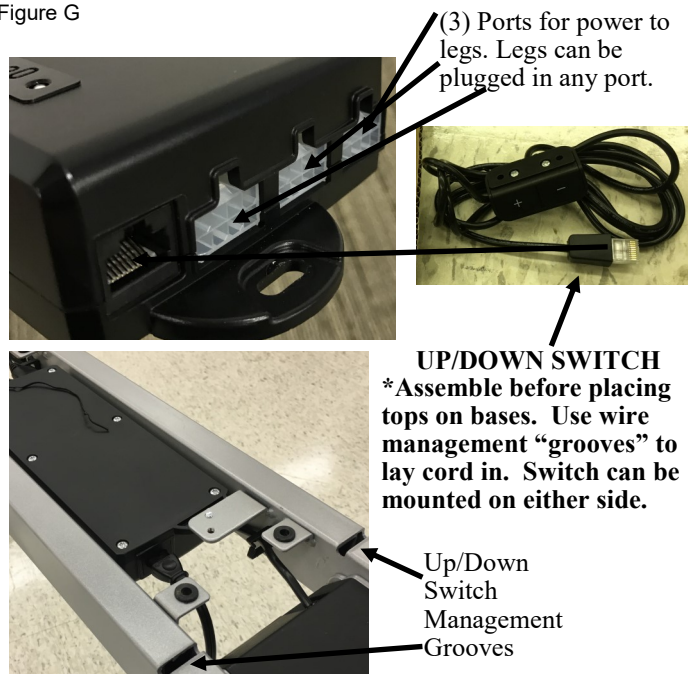

Figure H

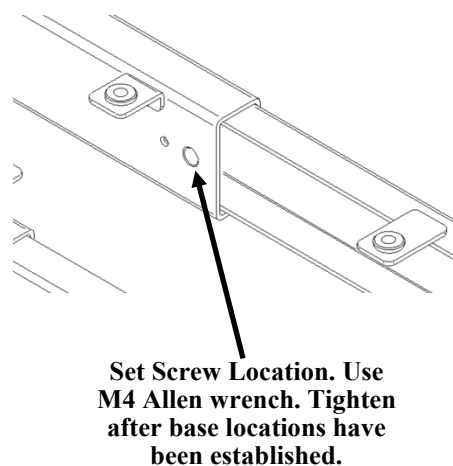

Figure I

