

● POWER FEED

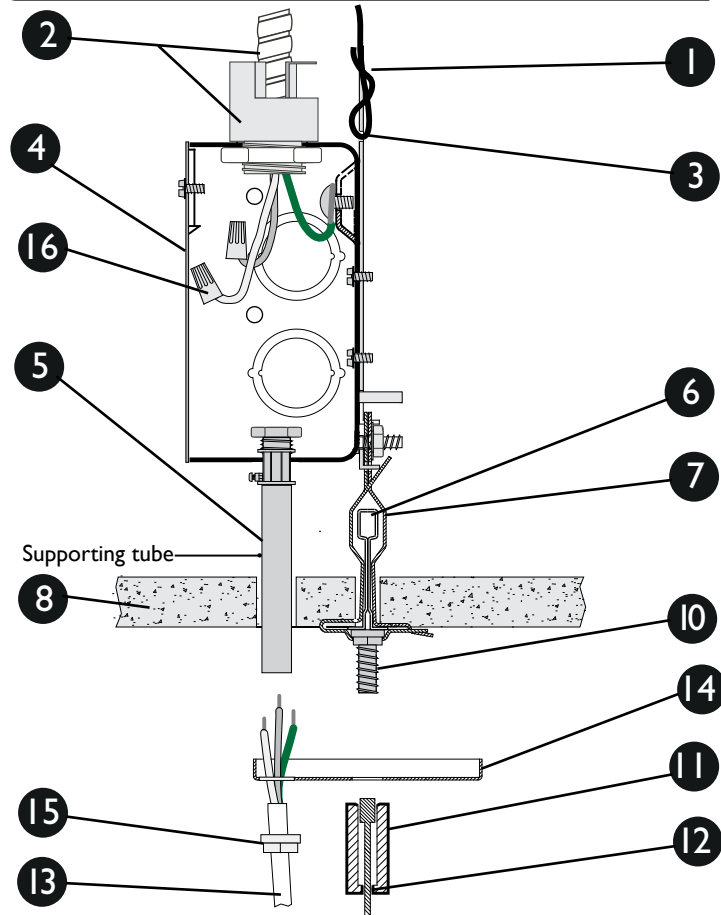

● NON POWER SUSPENSION

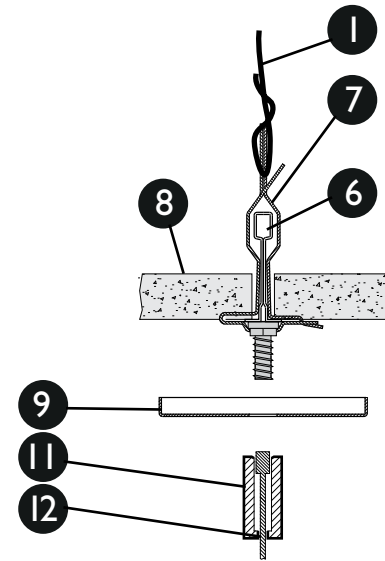

● PARTS LIST

- 1 Support wire (by others)
- 2 Armored cable & connector (by others)
- 3 Junction box adaptor bracket (by others)
- 4 4" octagon junction box (by others)
- 5 CTS Supporting tube
- 6 T-bar grid (by others)
- 7 Assembled T-bar clip
- 8 Ceiling tile (by others)
- 9 2" Canopy
- 10 1/4"-20 Crimp stud
- 11 1/4"-20 Cable holder
- 12 Aircraft cable
- 13 Power cord
- 14 2" Canopy power feed
- 15 Plastic grommet
- 16 Wire nut

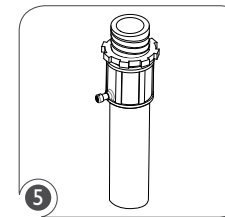

CTS Supporting tube

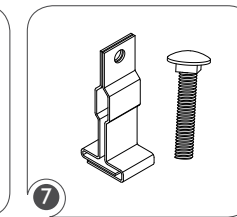

Assembled T-bar clip

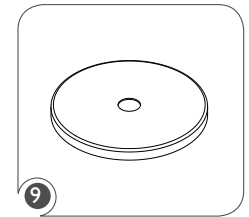

2" canopy

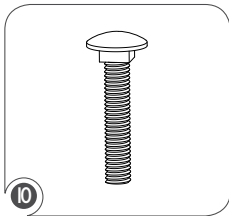

1/4"-20 crimp stud

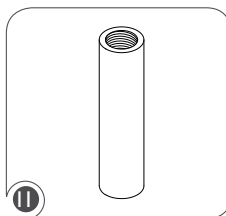

1/4"-20 cable holder

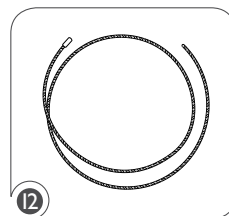

Aircraft cable

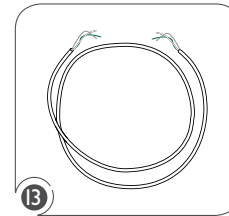

Power cord

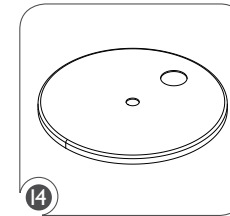

2" Canopy power feed

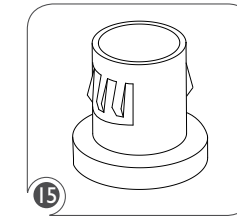

Plastic grommet

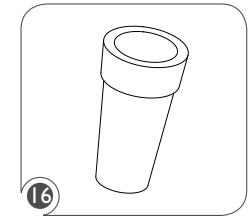

Wire nut

● POWER FEED

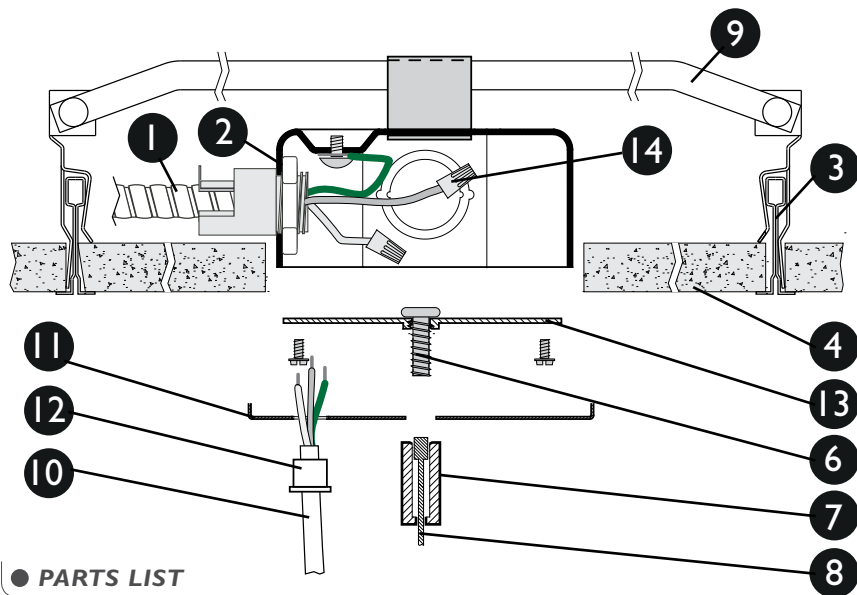

● PARTS LIST

- ① Armored cable & connector (by others)
- ② 4" octagon junction box (by others)
- ③ T-bar grid (by others)
- ④ Ceiling tile (by others)
- ⑥ 1/4"-20 crimp stud
- ⑦ 1/4"-20 cable holder
- ⑧ Aircraft cable
- ⑨ B-line J-box support (by others)
- ⑩ Power cord
- ⑪ 4 1/2" canopy power feed
- ⑫ Plastic grommet
- ⑬ Junction box crossbar
- ⑭ Wire nut
- ⑮ 4 1/2" canopy non-power

● NON POWER SUSPENSION

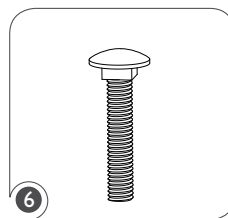
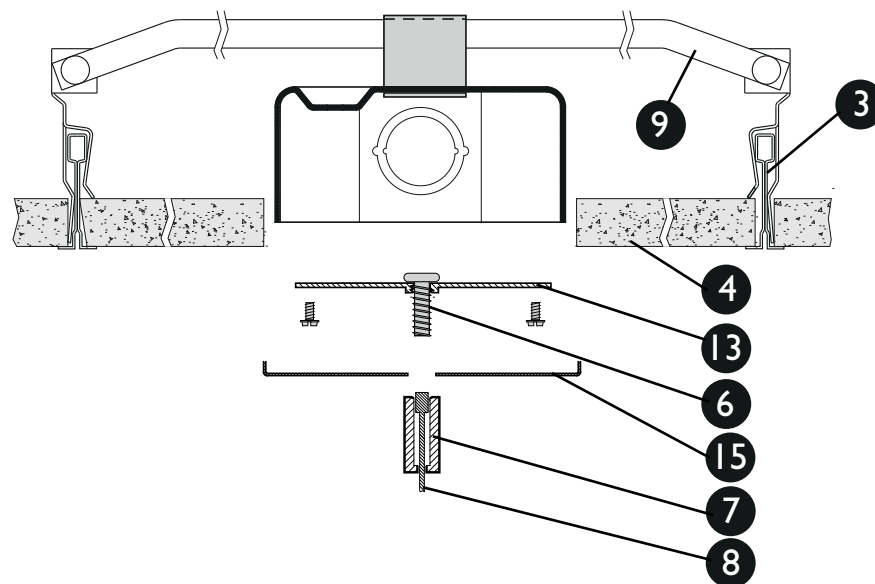

1/4"-20 crimp stud

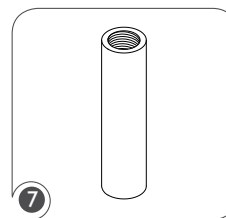

1/4"-20 cable holder

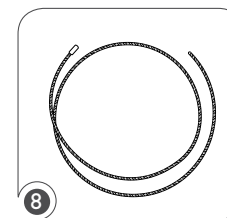

Aircraft cable

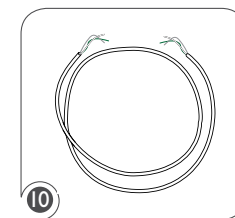

Power cord

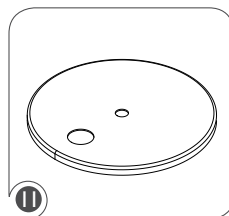

4 1/2" canopy power feed

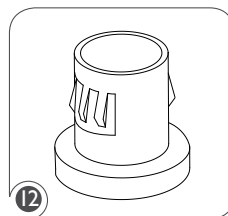

Plastic grommet

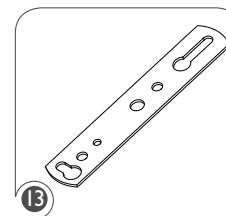

Junction box crossbar

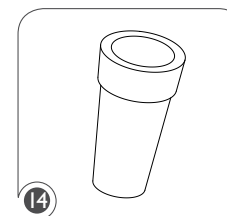

Wire nut

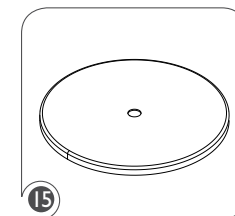

4 1/2" canopy non-power



● POWER FEED

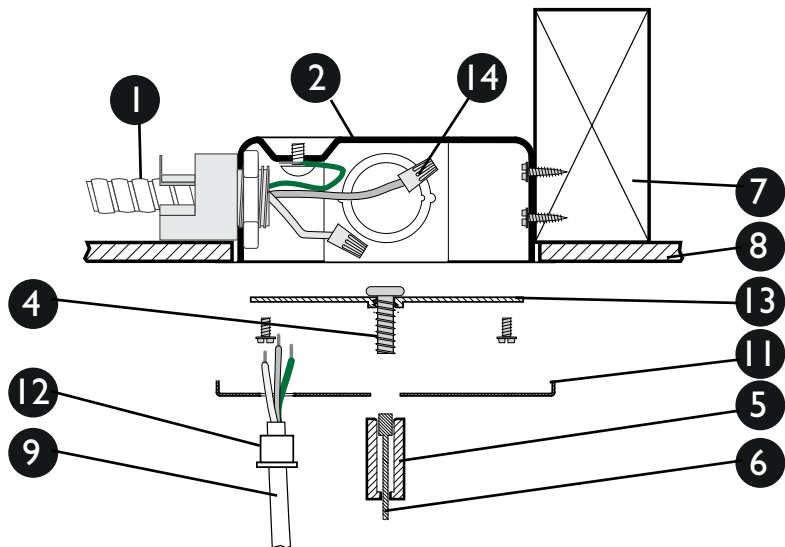

● PARTS LIST

- ① Armored cable & connector (by others)
- ② 4\" octagon junction box (by others)
- ③ 2\" canopy
- ④ 1/4\"-20 crimp stud
- ⑤ 1/4\"-20 cable holder
- ⑥ Aircraft cable
- ⑦ Ceiling structure (by others)
- ⑧ Ceiling surface material (by others)
- ⑨ Power cord
- ⑩ 1/4\"-20 Threaded rod (by others)
- ⑪ 4 1/2\" canopy power feed
- ⑫ Plastic grommet
- ⑬ Junction box crossbar
- ⑭ Wire nut

● NON POWER SUSPENSION

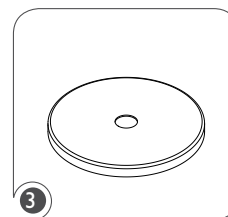
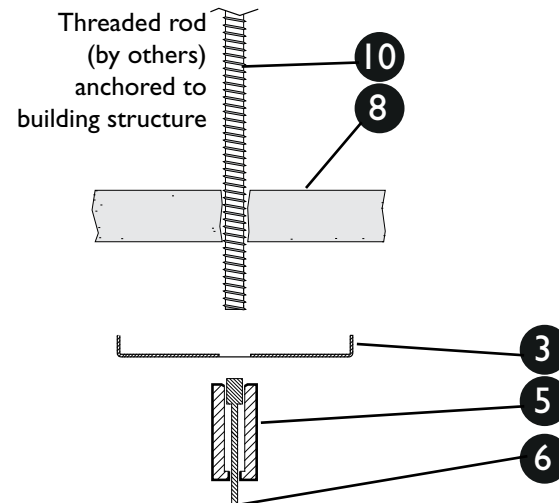

2\" canopy

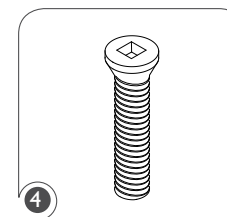

1/4\"-20 crimp stud

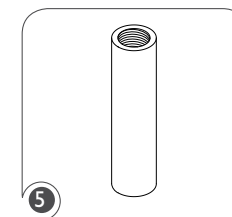

1/4\"-20 cable holder

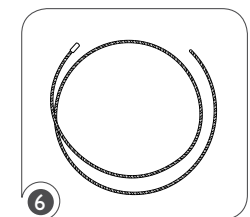

Aircraft cable

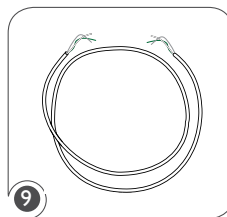

Power cord

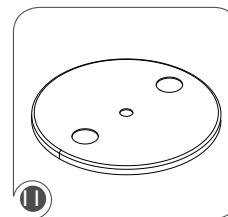

4 1/2\" canopy power feed

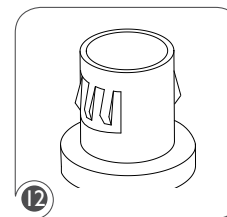

Plastic grommet

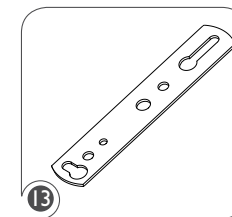

Junction box crossbar

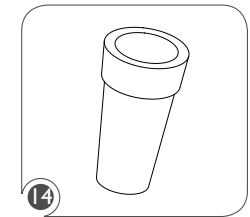

Wire nut

WARNING:



RISK OF FIRE AND ELECTRICAL SHOCK. FIXTURE MUST BE INSTALLED BY A QUALIFIED ELECTRICIAN ONLY IN ACCORDANCE WITH NATIONAL, LOCAL BUILDING AND ELECTRICAL CODES. DISCONNECT POWER AT ELECTRICAL PANEL BEFORE SERVICING.

PENDANT FIXTURES - CEILING MOUNTING GUIDE

SOLID CEILING

● POWER FEED

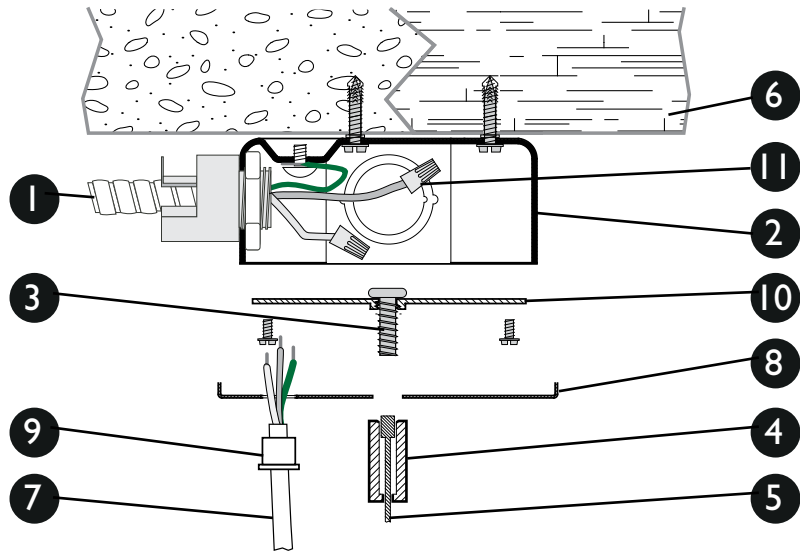

● PARTS LIST

- ① Armored cable & connector (by others)
- ② 4" octagon junction box (by others)
- ③ 1/4"-20 crimp stud
- ④ 1/4"-20 cable holder
- ⑤ Aircraft cable
- ⑥ Ceiling surface material (by others)
- ⑦ Power cord
- ⑧ 4 1/2" canopy power feed
- ⑨ Plastic grommet
- ⑩ Junction box crossbar
- ⑪ Wire nut
- ⑫ 4 1/2" canopy non-power

● NON POWER SUSPENSION

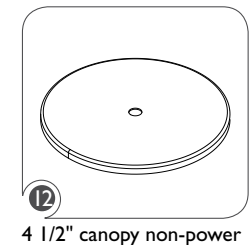
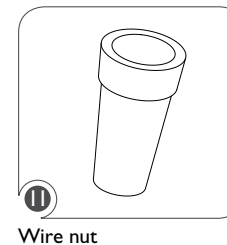
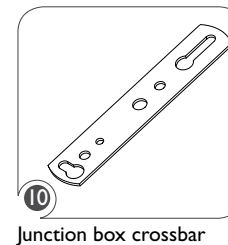
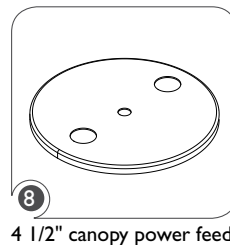
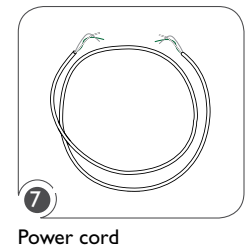
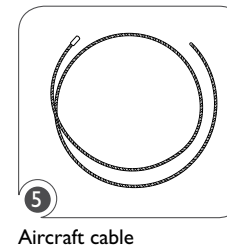
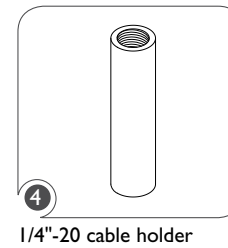
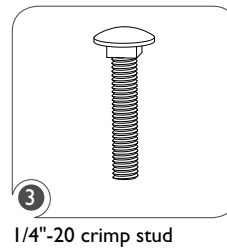
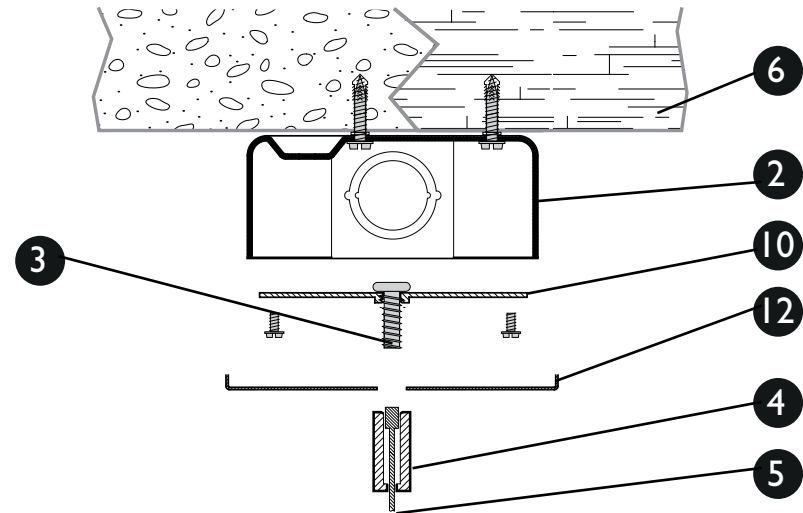

PENDANT FIXTURES - CEILING MOUNTING GUIDE

STEM MOUNT IN DRYWALL CEILING

● POWER FEED

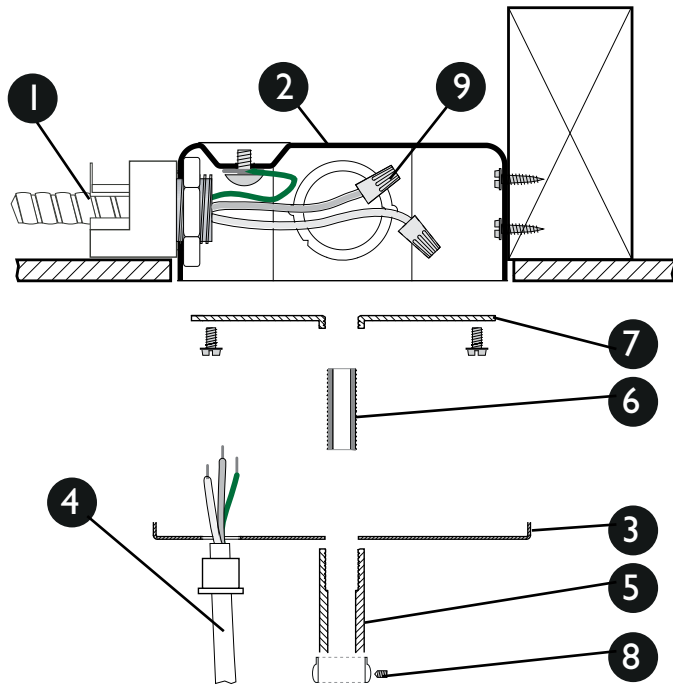

● PARTS LIST

- ① Armored cable & connector (by others)
- ② 4" octagon junction box (by others)
- ③ 4 1/2" canopy power feed
- ④ Power cord
- ⑤ Threaded Stem
- ⑥ 3/8" Threaded nipple
- ⑦ Junction box crossbar
- ⑧ Trim Ring & Set Screw
- ⑨ Wire nut
- ⑩ 4 1/2" canopy non-power

● NON POWER SUSPENSION

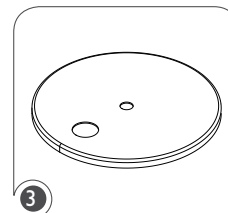
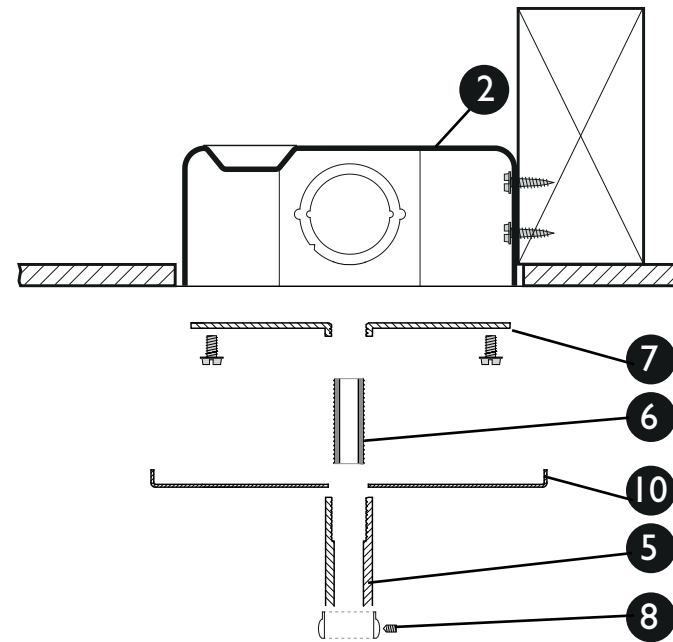

4 1/2" canopy power feed

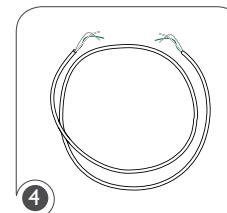

Power cord

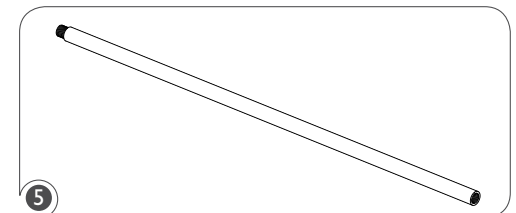

Threaded Stem

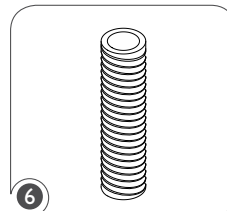

3/8" Threaded nipple

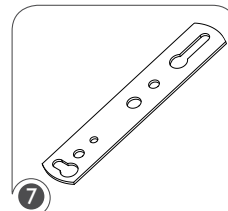

Junction box crossbar

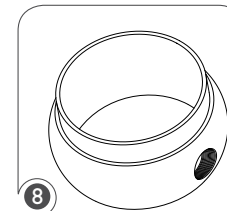

Trim Ring & Set Screw

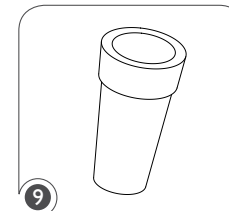

Wire nut

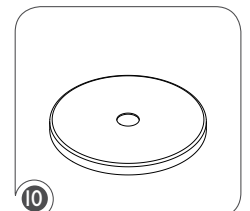

4 1/2" canopy non-power

FILE NAME: PENDANT.MOUNT.GUIDE May 15, 2018

ÉCLAIRAGE
axis
LIGHTING

1.800.263.AXIS
[T] 514.948.6272
[F] 514.948.6271
www.axislighting.com

PLEASE NOTE: GENERAL CONTRACTOR IS RESPONSIBLE FOR PROVIDING APPROPRIATE ANCHORING RODS TO SUPPORT LOAD OF FIXTURES DETAILED ON SHOP DRAWING. PLEASE CALL CUSTOMER SERVICE FOR ANY QUESTIONS.

WARNING:



RISK OF FIRE AND ELECTRICAL SHOCK. FIXTURE MUST BE INSTALLED BY A QUALIFIED ELECTRICIAN ONLY IN ACCORDANCE WITH NATIONAL, LOCAL BUILDING AND ELECTRICAL CODES. DISCONNECT POWER AT ELECTRICAL PANEL BEFORE SERVICING.



© 2011 Axis Lighting Inc.