

(F) Flat - (OC) Outside Corner

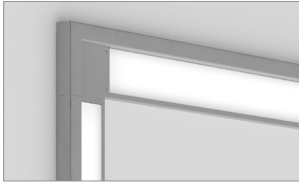

(F) Flat - (IC) Inside Corner

**NOTE:** See page 3 for more orientation information.

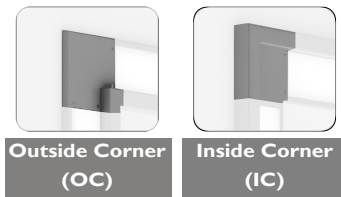

### Ordering Example

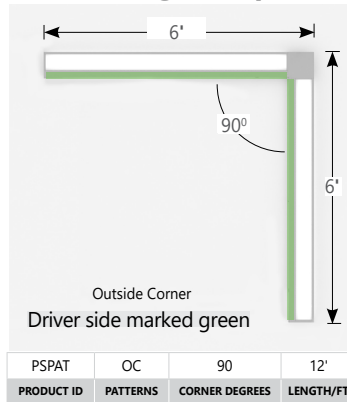

TOP VIEW - Square Corner Pattern  
**NOTE:** See page 2 for more ordering examples

Project \_\_\_\_\_

Type \_\_\_\_\_

Notes \_\_\_\_\_

Please provide sketch  
See page 3 for orientation options

**IMPORTANT – Must submit sketches to illustrate the pattern, mounting location, and luminaire lengths..**



### Ordering Guide

PSPAT					SF
PRODUCT ID	MOUNTING SIDE	CORNER TYPE	CORNER ANGLE	OPTIC-STEP SIDE	OPTIC-FLAT SIDE
PSPAT	Pose corners wall	OC outside corner IC inside corner	90 90 degree	AS asymmetric - step side LS lambertian - step side	SF solid - flat side
For wall mount, open pattern, only on one plane				See light distribution options on page 3.	

NOM. LUMENS/FT	CRI	COLOR TEMP.	LENGTH	FINISH	VOLTAGE	DRIVER
250 250 lm/ft - Min 1000 1000 lm/ft - Max	80 80 CRI 90 90 CRI	27 2700 K 30 3000 K 35 3500 K 40 4000 K	2 2' 3 3' 4 4' 5 5' 6 6' 7 7' 8 8' S(L) system run*	AP aluminum paint W white BLK black C custom	120 120 V 277 277 V 347 347 V* UNV universal DC low voltage**	DP dimming (0-10V) 1% - integral POE(##) POE drivers*
Outputs between listed min and max are available. Consult factory for outputs outside of the listed range.		Consult factory for other color temperatures	2 ft min, 1 ft increment, 8 ft max stand alone. *System runs contain joiners - see page 3 For all other lengths and related outputs, please consult factory.		* Remote driver only. ** Only available with POE drivers.	Integral driver * Please consult factory; see page 2

CIRCUITS	MOUNTING	ORIENTATION	REMOTE BATTERY (OPTIONAL)	OTHER (OPTIONAL)	CUSTOM (OPTIONAL)
1 1 circuit 2 2 circuits* +E(##) emergency circuit*	MT mounting track* DF drywall flange DS drywall spackle flange	FWOC flat wall outside corner FWIC flat wall inside corner	B(##) remote battery pack	F fuse* EF end feed**	C custom
* Specify quantity * Can not control up/down separately.	*For drywall and solid ceiling mounting. Please consult factory for power feed options available for your ceiling type and application.	*See page 3 for orientation options	Remote only	* Requires 120V or 277V **Not available with flex whip wiring.	Please specify

### ● ORDERING EXAMPLES

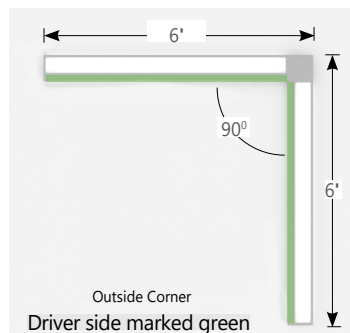

PSPAT	OC	90	12'
PRODUCT ID	PATTERNS	CORNER DEGREES	LENGTH/FT

FRONT VIEW - L Corner Pattern

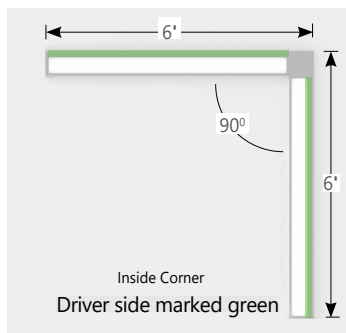

PSPAT	IC	90	12'
PRODUCT ID	PATTERNS	CORNER DEGREES	LENGTH/FT

FRONT VIEW - L Corner Pattern

### ● CORNER FEATURES

The corner system allows Pose<sup>™</sup> to be built into L-shaped patterns.

A non-illuminated corner element easily joins individual lengths of Pose<sup>™</sup> luminaires for a seamless look.

Choose the Wall Right Angle mount to connect luminaires from wall to wall, with either an inside or outside corner. Or build L-shaped patterns on a single wall surface with Wall Flat mount or Wall Step mount.

**IMPORTANT:** Provide sketches to illustrate the pattern, mounting location, and luminaire lengths.

Step - Wall mount shown

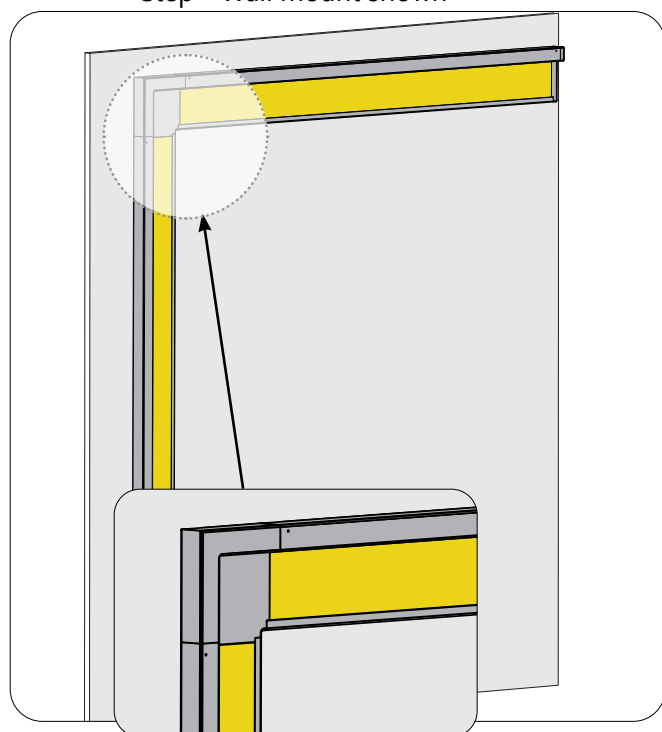

Inside Corner (IC)

Step - Wall mount shown

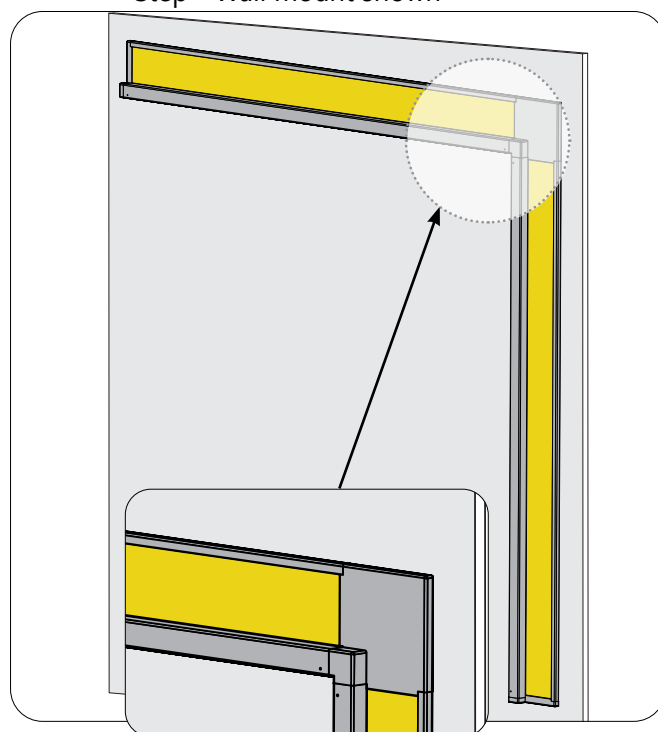

Outside Corner (OC)

### ● ORIENTATION OPTIONS

#### MOUNTING SIDE

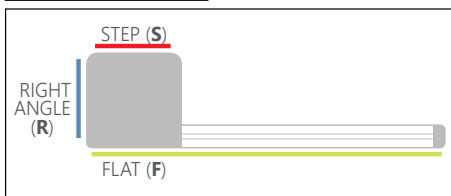

Pose™ is available for installation on all three of it's sides. See interactive table below for quick access to CORNER - STEP, and RIGHT ANGLE MOUNTS specification sheets, also available at [axislighting.com](http://axislighting.com)



	WALL			
	OUTSIDE CORNERS		INSIDE CORNERS	
<b>FLAT MOUNT (F)</b> (solid (SF) always on the flat side)  <b>NOTE:</b> Applicable only for same plane patterns	 Flat Wall Outside Corner <b>FWOC</b>		 Flat Wall Inside Corner <b>FWIC</b>	
<b>RIGHT ANGLE MOUNT (R)</b>  <b>NOTE:</b> Not applicable for same plane patterns	 Right Angle Wall Outside Corner Up <b>RWOCU</b>	 Right Angle Wall Outside Corner Down <b>RWOC</b>	 Right Angle Wall Inside Corner Up <b>RWICU</b>	 Right Angle Wall Inside Corner Down <b>RWICD</b>
<b>STEP MOUNT (S)</b> (recommend lambertian (LS) on the step side)  <b>NOTE:</b> Applicable only for same plane patterns	 Step Wall Outside Corner <b>SWOC</b>		 Step Wall Inside Corner <b>SWIC</b>	

#### LIGHT DISTRIBUTION

STEP SIDE	LUMENS %		LUMENS %	
	SF	LS	SF	AS
	lambertian on step side	100%	asymmetric on step side	100%
	solid on flat side	0%	solid on flat side	0%

**IMPORTANT – Must submit sketches to illustrate the pattern, mounting location, and luminaire lengths..**



A large grid of squares, intended for sketching. The grid consists of 30 columns and 30 rows, providing a total of 900 squares for drawing.