



(S) Step - (OC) Outside Corner



(S) Step - (IC) Inside Corner

**NOTE:** See page 3 for more orientation information.

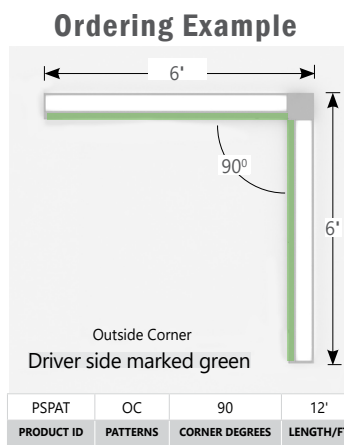
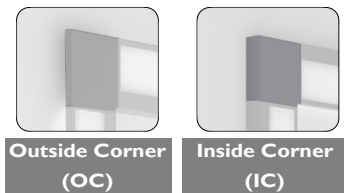

**NOTE:** See page 2 for more ordering examples

Project \_\_\_\_\_

Type \_\_\_\_\_

Notes \_\_\_\_\_

Please provide sketch  
See page 3 for orientation options

**IMPORTANT – Must submit sketches to illustrate the pattern, mounting location, and luminaire lengths.**



### Ordering Guide

PSPAT		MOUNTING SIDE		CORNER TYPE		CORNER ANGLE		OPTIC-STEP SIDE		OPTIC-FLAT SIDE	
PRODUCT ID											
PSPAT	Pose corners wall	S step		OC outside corner IC inside corner		90 90 degree		AS asymmetric - step side LS lambertian - step side SS solid - step side		AF asymmetric - flat side LF lambertian - flat side	
		For wall mount, open pattern, only on one plane						See light distribution options on page 3.		See light distribution options on page 3.	
NOM. LUMENS/FT		CRI		COLOR TEMP.		LENGTH		FINISH		VOLTAGE	
250 250 lm/ft - Min		80 80 CRI		27 2700 K		2 2'		AP aluminum paint		120 120 V	
1000 1000 lm/ft - Max		90 90 CRI		30 3000 K		3 3'		W white		277 277 V	
				35 3500 K		4 4'		BLK black		347 347 V*	
				40 4000 K		5 5'		C custom		UNV universal	
						6 6'				DC low voltage**	
						7 7'					
						8 8'					
						S(#) system run*					
Outputs between listed min and max are available. Consult factory for outputs outside of the listed range.		Consult factory for other color temperatures		2ft min, 1 ft increment, 6ft max stand alone. *System runs contain joiners For all other lengths and related outputs, please consult factory.				* Remote driver only. ** Only available with POE drivers.		Integral driver * Please consult factory; see page 2	
CIRCUITS		MOUNTING		ORIENTATION		REMOTE BATTERY (OPTIONAL)		OTHER (OPTIONAL)		CUSTOM (OPTIONAL)	
1 1 circuit 2 2 circuits* +E(#) emergency circuit *		MT mounting track* DF drywall flange DS drywall spackle flange		SWOC step wall outside corner SWIC step wall inside corner		B(#) remote battery pack		F fuse* EF end feed**		C custom	
*Specify quantity * Can not control up/down separately.		*For drywall and solid ceiling mounting. Please consult factory for power feed options available for your ceiling type and application.		*See page 3 for orientation options		Remote only		*Requires 120V or 277V * Not available with flex whip wiring.		Please specify	

### ● ORDERING EXAMPLES

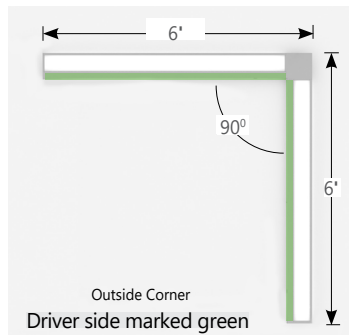

PSPAT	OC	90	12'
PRODUCT ID	PATTERNS	CORNER DEGREES	LENGTH/FT

FRONT VIEW - L Corner Pattern

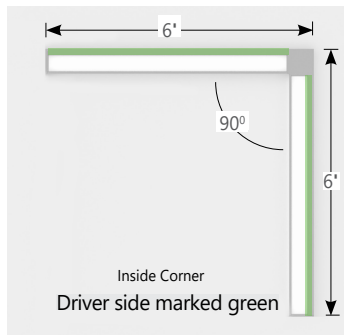

PSPAT	IC	90	12'
PRODUCT ID	PATTERNS	CORNER DEGREES	LENGTH/FT

FRONT VIEW - L Corner Pattern

### ● CORNER FEATURES

The corner system allows Pose<sup>™</sup> to be built into L-shaped patterns.

A non-illuminated corner element easily joins individual lengths of Pose<sup>™</sup> luminaires for a seamless look.

Choose the Wall Right Angle mount to connect luminaires from wall to wall, with either an inside or outside corner. Or build L-shaped patterns on a single wall surface with Wall Flat mount or Wall Step mount.

**IMPORTANT:** Provide sketches to illustrate the pattern, mounting location, and luminaire lengths.

Step - Wall mount shown

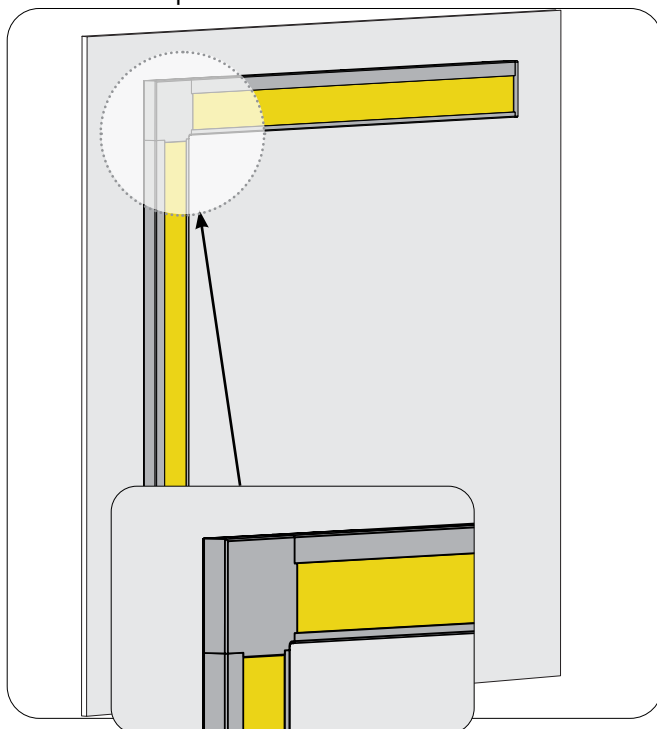

Inside Corner (IC)

Step - Wall mount shown

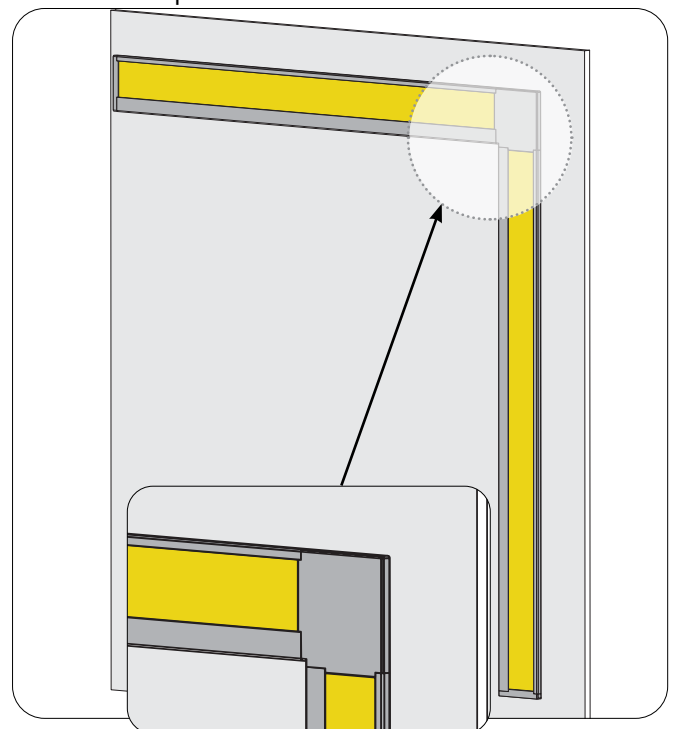

Outside Corner (OC)

### ● ORIENTATION OPTIONS

#### MOUNTING SIDE

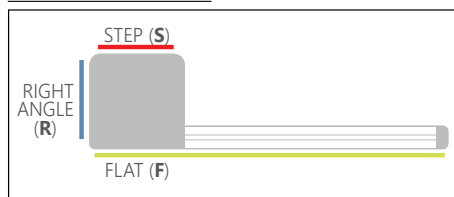

Pose™ is available for installation on all three of its sides. See interactive table below for quick access to CORNER - FLAT, and RIGHT ANGLE MOUNTS specification sheets, also available at [axislighting.com](http://axislighting.com)

	WALL			
	OUTSIDE CORNERS		INSIDE CORNERS	
<b>FLAT MOUNT (F)</b> (solid (SF) always on the flat side)  <b>NOTE:</b> Applicable only for same plane patterns	 Flat Wall Outside Corner <b>FWOC</b>		 Flat Wall Inside Corner <b>FWIC</b>	
<b>RIGHT ANGLE MOUNT (R)</b>  <b>NOTE:</b> Not applicable for same plane patterns	 Right Angle Wall Outside Corner Up <b>RWOCU</b>	 Right Angle Wall Outside Corner Down <b>RWOCD</b>	 Right Angle Wall Inside Corner Up <b>RWICU</b>	 Right Angle Wall Inside Corner Down <b>RWICD</b>
<b>STEP MOUNT (S)</b> (recommend lambertian (LS) on the step side)  <b>NOTE:</b> Applicable only for same plane patterns	 Step Wall Outside Corner <b>SWOC</b>		 Step Wall Inside Corner <b>SWIC</b>	

#### LIGHT DISTRIBUTION

<div><div></div><div>STEP SIDE</div><div>FLAT SIDE</div></div>	<div><div>AS</div><div>1</div><div>AF</div></div>	asymmetric on step side	LUMENS %	<div><div>LS</div><div>1</div><div>LF</div></div>	lambertian on step side	LUMENS %
		asymmetric on flat side	50%		lambertian on flat side	50%
	<div><div>AS</div><div>1</div><div>LF</div></div>	asymmetric on step side	LUMENS %	<div><div>LS</div><div>1</div><div>AF</div></div>	lambertian on step side	LUMENS %
		lambertian on flat side	60%		asymmetric on flat side	40%
	<div><div>SS</div><div>1</div><div>LF</div></div>	solid on step side	LUMENS %	<div><div>SS</div><div>1</div><div>AF</div></div>	solid on step side	LUMENS %
		lambertian on flat side	0%		asymmetric on flat side	100%
		100%				

\*See page 4 for photometry

**IMPORTANT – Must submit sketches to illustrate the pattern, mounting location, and luminaire lengths.**

