

NOMAD™

Interactive workspace

Charles Godbout & Luc Plante



nienkämper
International Inc.

BASE, SURFACE, EDGE DETAILS & CONNECTIVITY

Surface Shapes

Top is 1" thick with overall table height of 29" H and is available in three different shapes.



Rectangular



Nomad Boat



Square

Finishes

All standard Nienkämper veneer and laminates.

Edge Details

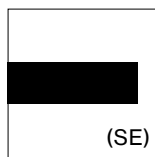

1" thick
Self Edge (SE)

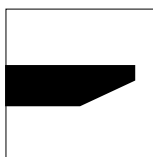

1" thick
Nomad Taper Edge

Sizes

Nomad® conference tables are available in standard sizes:

Width: 36", 42", 48", 54", 60"

Length: 60" to 240"

Conference table with multi section tops has one or two centre bases.

Nomad® training tables are available in standard sizes:

Width: 30", 36"

Length: 60", 72", 84"

Base Finish Options

Nomad® Table bases are available in either mirror polished or a variety of powder coat paint finish, see below options.



Aluminum Polished / AL-07



Cool White Powder Coat / PC-12



Yellow Powder Coat / PC-13



Pure Orange Powder Coat / PC-14



Red Powder Coat / PC-09



Green Powder Coat / PC-15



Lime Powder Coat / PC-16



Silver Powder Coat / PC-01



Sky Blue Powder Coat / PC-17



Cobalt Blue Powder Coat / PC-18



Black Powder Coat / PC-06



Pewter Grey Powder Coat / PC-19

Stretcher Rails Finish Options

The standard finish for Stretcher rails of Nomad® Table is silver anodized aluminum finish (AL-01) for bases in both mirror polished aluminum or powder coat paint finish. For Stretcher rails with same powder coat paint finish as the bases, there will be 5% upcharge on list price of the table.



Silver Anodized Aluminum / AL-01



Cool White Powder Coat / PC-12



Yellow Powder Coat / PC-13



Pure Orange Powder Coat / PC-14



Red Powder Coat / PC-09



Green Powder Coat / PC-15



Lime Powder Coat / PC-16



Silver Powder Coat / PC-01



Sky Blue Powder Coat / PC-17



Cobalt Blue Powder Coat / PC-18



Black Powder Coat / PC-06



Pewter Grey Powder Coat / PC-19



With the bright colour Stretcher rails matching with the Nomad® bases, Nomad® Table creates a very stunning architectural look featuring sleek and linear lines underneath the top.

BASE, SURFACE, EDGE DETAILS & CONNECTIVITY

Side Elevation of Table

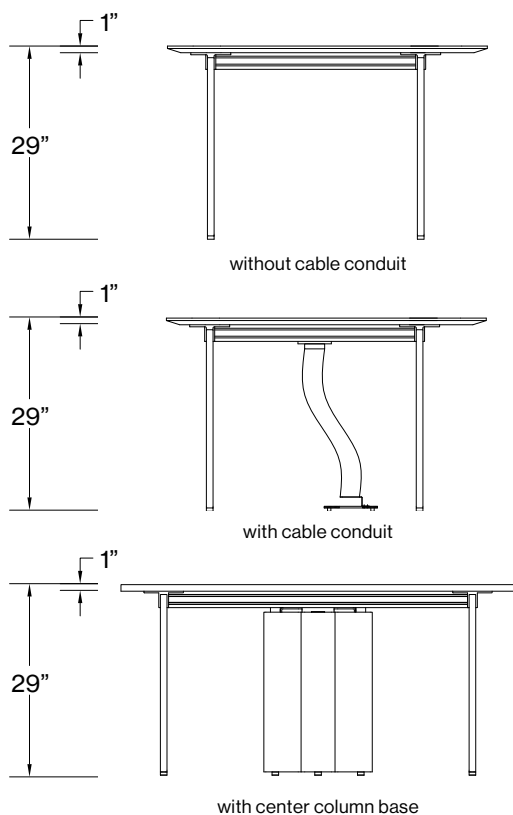

Center Column Base

The center column base of Nomad® table allows cables to be stored and pass through. The standard finish for the center base is silver powder coat paint finish (PC-01). Other powder coat paint colors with the center base are available for an upcharge of \$250 list per base.

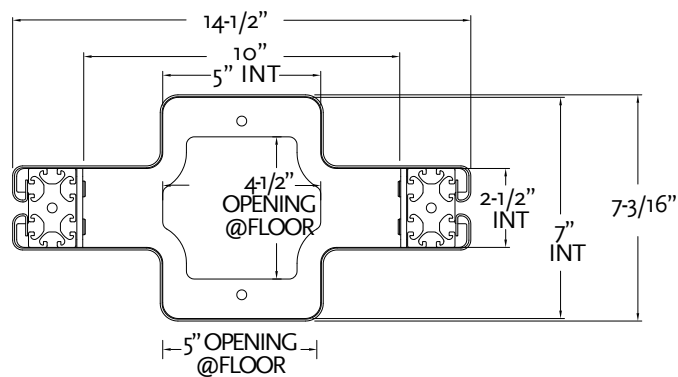

Plan View of Center Column base

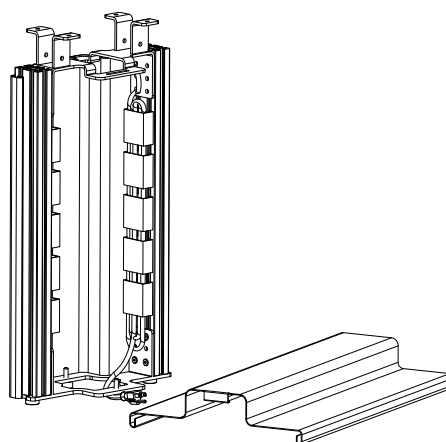

Connectivity

Nienkämper offers connectivity solutions for the Nomad® Table, our Vox® M or N Series Forum or SIMPLE Pop Up Forum with Vox® Cable Conduits provide a variety of power/data/AV options for your needs.



Vox® M Series Forum



Vox® N Series Forum



SIMPLE Pop-up Forum



CABLE CONDUIT, CENTER COLUMN BASE & WIRE MANAGEMENT

Table with Cable Conduit

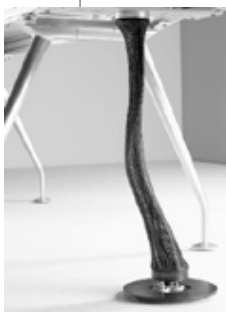
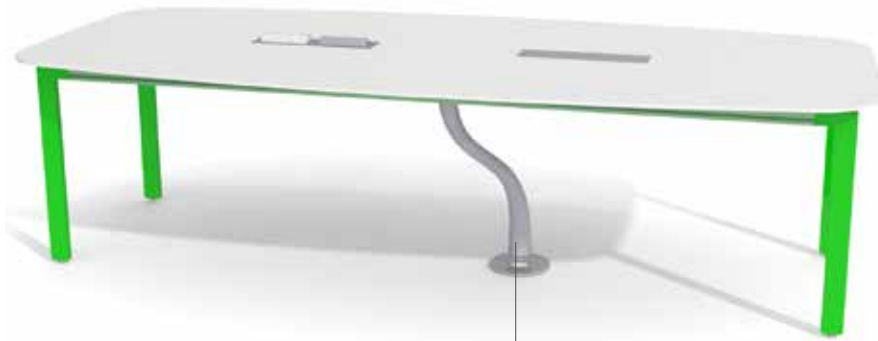

Expandable cable conduit



Linked cable conduit

Cables from our Vox® Forum or SIMPLE Pop Up Forum are directed to the floor with either an expandable or linked cable conduit. Both solutions accommodate core drills with their large base ring. Wire capacity is 2"-4" dia for the expandable cable conduit and eighteen 16 GA cables for the linked. Both models available in black, silver or clear color options. Please see page 24 for details.

Table with Column Base

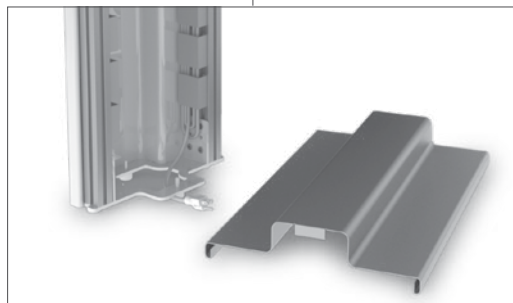

Center column base

Cables from our Vox Forum or SIMPLE Pop Up Forum are directed to the floor through center column base(s) for multi section of tops.

VENEERS

All wood surfaces are protected with a durable polyurethane clear laquer with UV inhibitor. This finish is known for its exceptional durability, as well as abrasion, chemical, impact and scratch resistance. Standard sheen level is 45 degrees. Optional 10 and 35 degree sheen levels are available on request at no additional cost.

Wood Species	Order Code	Veneer/Stain	Upcharge
Maple	F-01	Natural Maple	No upcharge applies.
	F-02	Natural Curly Maple - Rotary Cut	Add 15%.
	F-03	Natural Bird's Eye Maple - Rotary Cut	Call Customer Service for pricing.
	F-04	Maple Stained Pear	No upcharge applies.
Cherry	F-05	Natural Cherry	No upcharge applies.
	F-06	Standard Cherry	No upcharge applies.
	F-07	Cherry Stained Amber	No upcharge applies.
	F-08	Cherry Stained Auburn	No upcharge applies.
	F-09	Cherry Stained Burgundy	No upcharge applies.
Mahogany	F-10	Light Mahogany	No upcharge applies.
	F-11	Medium Mahogany	No upcharge applies.
	F-12	Dark Mahogany	No upcharge applies.
	F-13	Red Mahogany	No upcharge applies.
Anagre	F-14	Natural Figured Anagre - Qtr. Cut Book-Match	Add 15%.
	F-15	Figured Anagre Stained Amber - Qtr. Cut Book-Match	Add 15%.
Sycamore	F-16	Natural Figured Sycamore - Qtr. Cut Book-Match	Add 15%.
Walnut	F-17	Burnt Walnut	No upcharge applies.
	F-19	Natural Walnut	No upcharge applies.
	F-24	Carbon Grey Walnut	No upcharge applies.
White Oak	F-18	Natural White Oak - Flat Cut Book-Match (10° sheen)	No upcharge applies.
		Natural White Oak - Rift Cut Slip-Match (10° sheen)	Add 5%
Sapele – Ribbon Stripe	F-20	Natural Ribbon Strip Sepele - Qtr. Cut Slip-Match	No upcharge applies.
Moabe (Cherry substitute)	F-21	Natural Moabe - Quarter - Qtr. Cut Book-Match	No upcharge applies.
Cape Coast Walnut	F-22	Dark Cape Coast Walnut - Qtr. Cut Slip-Match	No upcharge applies.
	F-23	Natural Cape Coast Walnut - Qtr. Cut Slip-Match	No upcharge applies.
Ash	F-25	Slate Grey Ash - Qtr. Cut Slip-Match	No upcharge applies.

VENEER GRAIN OPTIONS

Nienkamper products utilize the best quality veneers available, and, combined with Nienkämper's patented veneering systems, create work environments of incredible quality and beauty.

All veneer furniture comes standard with flat cut book-match veneer; flat cut slip-match veneer can also be specified. Quarter cut slip-match and quarter cut book-match veneers are available at a 5% upcharge. Figured Anagre and Figured Sycamore veneers are Quarter cut book-matched. Bird's Eye Maple and Curly Maple are rotary cut.

Facet Edge, Taper edge and Flowform edge tops with veneer are manufactured with a solid wood edge. All edges are then veneer wrapped to create a seamless profile top.

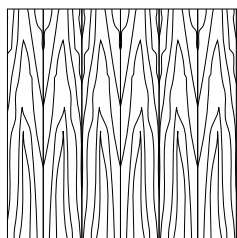

Standard
Flat Cut Book-Match V1

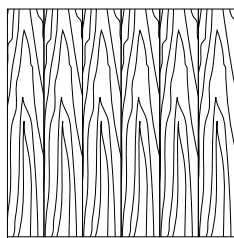

Flat Cut Slip-Match V2

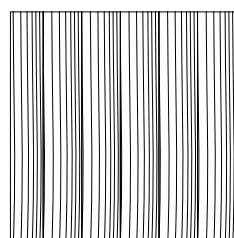

Quarter Cut Slip-Match
Add 5% V3

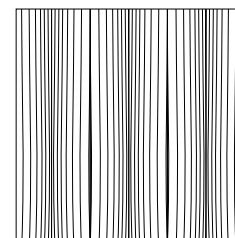

Quarter Cut Book-Match
Add 5% V4

LAMINATES

Wood grain plastic laminate surfaces are available on table tops with Self and Taper edges.

Nienkämper has pre-selected a number of standard wood grain plastic laminates that represent a cross section of both color and species. Simply include the order code with the model number to make these selections. Alternatively wood grain plastic laminates selected outside of Nienkämper's standard selection can be made by specifying the manufacturer as well as the description and model number of the laminate at the time of order.

Wood Edging

These tops are manufactured with a solid wood edge that is applied prior to the laminate top surface. This method conceals the thickness of the wood edge, while providing the durability required. Wood edges are selected that most closely resemble both the species and the color of the laminate chosen

Laminate Edging on Taper and Self edge tops. Edging will match the top surface and is applied prior to the surface laminate. By applying the laminate in this way the seam is positioned horizontally, is much less conspicuous as well as more durable.

Translucent edging on Taper and Self edge tops is applied after the surface laminate. The translucent edge is very durable. Clear translucent edge provides a good match with most white colored laminates, while silver translucent edge provides a metallic look and contrast to colored plastic laminates.

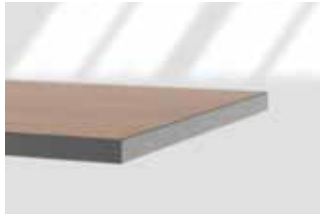

silver translucent (bottom)



clear translucent edge with white p-lam top



Birch ply exposed Self Edge in natural finish (5% upcharge)

Wood Grain Plastic Laminate Surfaces	Order Code	Manufacturer #	Finish
CHAMPAGNE SAGAWOOD	WL1	Nevamar WM8349T	Textured
HARDROCK MAPLE	WL2	Pionite WM791-SD	Textured/Suede
AMBER CURLY MAPLE	WL3	Pionite WM221-SD	Textured/Suede
ANAGRE	WL4	Pionite WX041-SD	Textured/Suede
MONTICELLO MAPLE	WL5	Wilsonart 7925-38	Fine Velvet Texture
MILLWORK CHERRY	WL7	Pionite WC431PV	PV-Polished Velvet
FIGURED ANAGRE	WL8	Formica7284-58	Matte
HUNTINGTON MAPLE	WL9	Wilsonart 7929-38	Fine Velvet Texture
WILD CHERRY	WL10	Formica 5904.43	Artisan
AMBER CHERRY	WL11	Wilsonart 7919.38	Fine Velvet Texture
FIGURED MAHOGANY	WL12	Wilsonart 7040A-60	Matte
FUSION MAPLE	WL13	Wilsonart 7909-78	Fine Grain
NEW AGE OAK	WL14	Wilsonart 7938-78	Fine Grain
NATURAL PEAR	WL15	Wilsonart 7061-78	Fine Grain
TUSCAN WALNUT	WL16	Wilsonart 7921-78	Fine Grain
NEPAL TEAK	WL17	Wilsonart 7209-78	Fine Grain
WILD CHERRY	WL18	Wilsonart 7054-78	Fine Grain
RIVER CHERRY	WL19	Wilsonart 7937-78	Fine Grain
MONTANA WALNUT	WL20	Wilsonart 7110-78	Fine Grain
SANARA	WL21	Wilsonart 7932-78	Fine Grain
WINDSOR MAHOGANY	WL22	Wilsonart 7039-78	Fine Grain
WILLIAMSBURG CHERRY	WL23	Wilsonart 7936-78	Fine Grain
FLORENCE WALNUT	WL25	Wilsonart 7993-78	Fine Grain
SKYLINE WALNUT	WL26	Wilsonart 7964K-12	Soft Grain
STERLING ASH	WL27	Wilsonart 7995-78	Fine Grain

To specify the wood grain laminate required simply add the Order Code WL_ to the model number of the product.

Wood grain laminate samples are available from your local sales representative or by calling Nienkämper's customer service department at 1-800-668-9318.

LAMINATES

COLOURED P-LAM

Both Taper and Self edge profiles are available with a colored laminate top.

Laminate edging on Taper and Self edge tops. Edging will match the top surface and is applied prior to the surface laminate. By applying the laminate in this way the seam is positioned horizontally, is much less conspicuous as well as more durable.

Wood edging on Taper and Self Edge tops is applied prior to the laminate. By applying the wood edge in this way the thickness of the wood edge is concealed, while providing the durability required. Wood species and finishes for edging, can be selected from page 5.

Translucent edging on Taper and Self edge tops is applied after the surface laminate. The translucent edge is very durable. Clear translucent edge provides a good match with most white colored laminates, while silver translucent edge provides a metallic look and contrast to colored plastic laminates.

For laminates specified outside of Nienkämper's standard selection, specify the manufacturer as well as the description and model number of the laminate selected at time of order.

Coloured Plastic Laminates Surface	Order Code	Manufacturer #	Finish
Grey (Nienkämper - Light Grey/Putty)	CL-01	Wilsonart 1500-60	Matte
Platinum Gray (Nienkämper - Medium Grey/Clay)	CL-02	Nevamar S6023T	Textured
Slate Grey (Nienkämper - Dark Grey)	CL-03	Wilsonart D91-60	Matte
Black	CL-04	Wilsonart 1595-60	Matte
Angel White	CL-05	Pionite SW-826SD	Textured/Suede
Frosty White	CL-06	Wilsonart 1573-60	Matte
White (for writable surface)	CL-07	Formica 949-90	Gloss

Add the order code behind the edge profile when specifying.

NIENKÄMPER COLOURED "FINGERPRINT RESISTANCE" P-LAM

Fingerprint Resistance Plastic Laminate is an innovative material created for interior design applications and is suitable for both vertical and horizontal interior applications on our Nienkämper furniture.

The external surface of Fingerprint Resistance Plastic Laminate involves the use of nanotechnology made possible by next generation acrylic resins.

The unique composition offers extraordinary features coupled with a unique user experience. These include an ultra matt surface (eliminating glare), an ultra sofa feel, an anti-fingerprint surface, thermal healing of micro-scratches, increased durability as well as anti-bacterial and mold-resistant properties.

Edgeband with matching color to the Fingerprint Resistance Plastic Laminate is only available on taper edge. For 1" thick top with self edge, same Fingerprint Resistance Plastic Laminate can be specified or it can be in clear/silver translucent edge.

There is a 10% upcharge on our standard plastic laminate table pricing for Fingerprint Resistance Plastic Laminate.

Colored "Fingerprint Resistance" Plastic Laminate Surface	Order Code	Finish
Black	RL-01	Matte
Gray	RL-02	Matte
Pure White	RL-03	Matte
Sand	RL-04	Matte
Bronze	RL-05	Matte

Edgeband to Match with Colored "Fingerprint Resistance" Plastic Laminate	Order Code
Black	RE-01
Gray	RE-02
Pure White	RE-03
Sand	RE-04
Bronze	RE-05

NOMAD TABLES - RECTANGLE

Rectangle shape

1" thick top, 29" H

Stretcher rails are silver anodized aluminum.

1" Nomad® Taper Edge



Self Edge (SE)

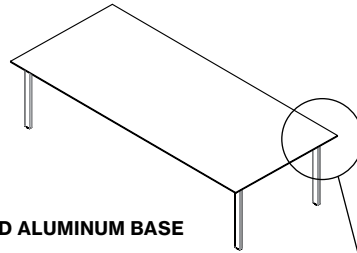
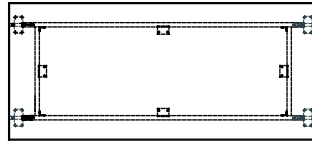

L"	X	D"	Sugg Seat Capacity	Top Finish	Top Sections	POWDER COAT BASE		POLISHED ALUMINUM BASE	
						Model Number	List Price	Model Number	List Price
60	36	4-6		Veneer	1	55501/2	3,175	55516/2	2,900
60	36	4-6		Laminate	1	55501/5	2,530	55516/5	2,250
60	42	4-6		Veneer	1	55502/2	3,430	55517/2	3,150
60	42	4-6		Laminate	1	55502/5	2,685	55517/5	2,410
60	48	4-6		Veneer	1	55503/2	3,685	55518/2	3,405
60	48	4-6		Laminate	1	55503/5	2,845	55518/5	2,560
72	36	4-6		Veneer	1	55504/2	3,535	55519/2	3,255
72	36	4-6		Laminate	1	55504/5	2,765	55519/5	2,485
72	42	4-6		Veneer	1	55505/2	3,830	55520/2	3,550
72	42	4-6		Laminate	1	55505/5	2,940	55520/5	2,655
72	48	4-6		Veneer	1	55506/2	3,795	55521/2	3,845
72	48	4-6		Laminate	1	55506/5	3,115	55521/5	2,830
84	36	6-8		Veneer	1	55507/2	3,770	55522/2	3,490
84	36	6-8		Laminate	1	55507/5	2,975	55522/5	2,695
84	42	6-8		Veneer	1	55508/2	4,160	55523/2	3,875
84	42	6-8		Laminate	1	55508/5	3,210	55523/5	2,930
84	48	6-8		Veneer	1	55509/2	4,530	55524/2	4,245
84	48	6-8		Laminate	1	55509/5	3,440	55524/5	3,155
96	36	6-8		Veneer	1	55510/2	4,130	55525/2	3,850
96	36	6-8		Laminate	1	55510/5	3,215	55525/5	2,935
96	42	6-8		Veneer	1	55511/2	4,455	55526/2	4,175
96	42	6-8		Laminate	1	55511/5	3,425	55526/5	3,145
96	48	6-8		Veneer	1	55512/2	4,710	55527/2	4,430
96	48	6-8		Laminate	1	55512/5	3,635	55527/5	3,350
108	42	8-10		Veneer	1	55513/2	4,860	55528/2	4,580
108	42	8-10		Laminate	1	55513/5	3,640	55528/5	3,355
108	48	8-10		Veneer	1	55514/2	5,255	55529/2	4,985
108	48	8-10		Laminate	1	55514/5	3,965	55529/5	3,680
108	54	8-10		Veneer	1	55515/2	5,775	55530/2	5,505
108	54	8-10		Laminate	1	55515/5	4,280	55530/5	4,000

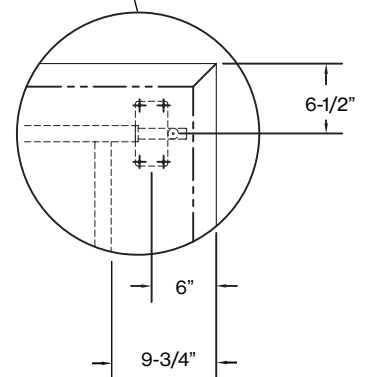

NOMAD TABLES - RECTANGLE

Rectangle shape with center column bases

1" thick top, 29" H

Stretcher rails are silver anodized aluminum.

1" Nomad® Taper Edge



Self Edge (SE)

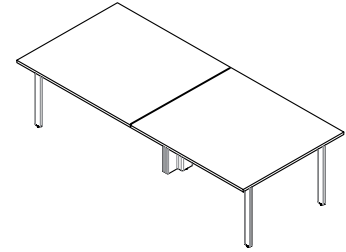
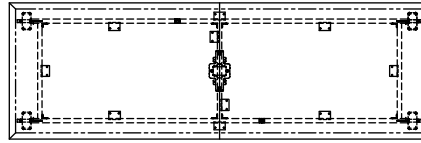

L"	X	D"	Sugg Seat Capacity	Top Finish	Top Sections	POWDER COAT BASE		POLISHED ALUMINUM	
						Model Number	List Price	BASE Model Number	List Price
120	48	8-10		Veneer	2	55901/2	7,495	55921/2	7,210
120	48	8-10		Laminate	2	55901/5	5,995	55921/5	5,725
120	54	8-10		Veneer	2	55902/2	7,940	55922/2	8,050
120	54	8-10		Laminate	2	55902/5	6,255	55922/5	5,965
120	60	8-10		Veneer	2	55903/2	8,250	55923/2	7,970
120	60	8-10		Laminate	2	55903/5	6,360	55923/5	6,085
144	48	10-12		Veneer	2	55904/2	8,980	55924/2	8,575
144	48	10-12		Laminate	2	55904/5	7,230	55924/5	6,950
144	54	10-12		Veneer	2	55905/2	9,535	55925/2	9,260
144	54	10-12		Laminate	2	55905/5	7,465	55925/5	7,185
144	60	10-12		Veneer	2	55906/2	9,970	55926/2	9,685
144	60	10-12		Laminate	2	55906/5	7,740	55926/5	7,455
168	48	12-14		Veneer	2	55907/2	9,830	55927/2	9,270
168	48	12-14		Laminate	2	55907/5	7,850	55927/5	7,570
168	54	12-14		Veneer	2	55908/2	10,415	55928/2	9,855
168	54	12-14		Laminate	2	55908/5	8,165	55928/5	7,880
168	60	12-14		Veneer	2	55909/2	11,080	55929/2	10,520
168	60	12-14		Laminate	2	55909/5	8,475	55929/5	8,190
180	48	12-14		Veneer	3	55910/2	10,320	55930/2	9,755
180	48	12-14		Laminate	3	55910/5	8,220	55930/5	7,940
180	54	14-16		Veneer	3	55911/2	10,940	55931/2	10,375
180	54	14-16		Laminate	3	55911/5	8,530	55931/5	8,140
180	60	14-16		Veneer	3	55912/2	11,565	55932/2	11,005
180	60	14-16		Laminate	3	55912/5	8,875	55932/5	8,600
216	48	14-16		Veneer	3	55913/2	12,820	55933/2	12,265
216	48	14-16		Laminate	3	55913/5	10,120	55933/5	9,840
216	54	16-18		Veneer	3	55914/2	13,555	55934/2	12,995
216	54	16-18		Laminate	3	55914/5	10,795	55934/5	10,510
216	60	16-18		Veneer	3	55915/2	14,265	55935/2	13,700
216	60	16-18		Laminate	3	55915/5	11,150	55935/5	10,865
240	48	14-16		Veneer	4	55916/2	14,390	55936/2	13,880
240	48	14-16		Laminate	4	55916/5	11,625	55936/5	11,375
240	54	16-18		Veneer	4	55917/2	15,140	55937/2	14,620
240	54	16-18		Laminate	4	55917/5	12,090	55937/5	11,830
240	60	18-20		Veneer	4	55918/2	16,020	55938/2	15,505
240	60	18-20		Laminate	4	55918/5	12,495	55938/5	12,245

Notes:

- (1) Table with 2 sections top consists of 4 bases and 1 center column base.
- (2) Table with 3 sections top consists of 4 bases and 2 center column bases.
- (3) Table with 4 sections top consists of 4 bases and 3 center column bases.

NOMAD TABLES - BOAT



Nomad Boat shape

1" thick top, 29" H

Stretcher rails are silver anodized aluminum.

1" Nomad® Taper Edge



Self Edge (SE)

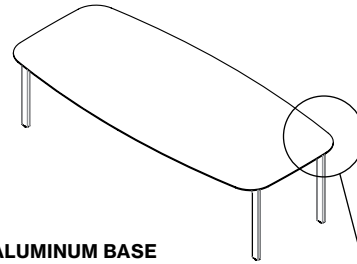
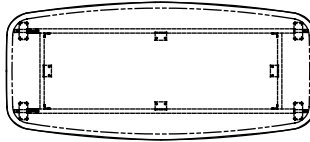

L"	X	D"	Sugg Seat Capacity	Top Finish	Top Sections	POWDER COAT BASE		POLISHED ALUMINUM BASE	
						Model Number	List Price	Model Number	List Price
60	36	4-6		Veneer	1	55531/2	3,420	55546/2	3,140
60	36	4-6		Laminate	1	55531/5	2,680	55546/5	2,395
60	42	4-6		Veneer	1	55532/2	3,705	55547/2	3,425
60	42	4-6		Laminate	1	55532/5	2,855	55547/5	2,570
60	48	4-6		Veneer	1	55533/2	3,995	55548/2	3,710
60	48	4-6		Laminate	1	55533/5	3,030	55548/5	2,755
72	36	4-6		Veneer	1	55534/2	3,815	55549/2	3,530
72	36	4-6		Laminate	1	55534/5	2,930	55549/5	2,645
72	42	4-6		Veneer	1	55535/2	4,155	55550/2	3,870
72	42	4-6		Laminate	1	55535/5	3,130	55550/5	2,850
72	48	4-6		Veneer	1	55536/2	4,105	55551/2	4,205
72	48	4-6		Laminate	1	55536/5	3,330	55551/5	3,050
84	36	6-8		Veneer	1	55537/2	4,075	55552/2	3,795
84	36	6-8		Laminate	1	55537/5	3,160	55552/5	2,885
84	42	6-8		Veneer	1	55538/2	4,510	55553/2	4,230
84	42	6-8		Laminate	1	55538/5	3,425	55553/5	3,145
84	48	6-8		Veneer	1	55539/2	4,940	55554/2	4,660
84	48	6-8		Laminate	1	55539/5	3,690	55554/5	3,410
96	36	6-8		Veneer	1	55540/2	4,470	55555/2	4,185
96	36	6-8		Laminate	1	55540/5	3,420	55555/5	3,140
96	42	6-8		Veneer	1	55541/2	4,845	55556/2	4,565
96	42	6-8		Laminate	1	55541/5	3,665	55556/5	3,380
96	48	6-8		Veneer	1	55542/2	5,135	55557/2	4,850
96	48	6-8		Laminate	1	55542/5	3,905	55557/5	3,625
108	42	8-10		Veneer	1	55543/2	5,295	55558/2	5,015
108	42	8-10		Laminate	1	55543/5	3,900	55558/5	3,620
108	48	8-10		Veneer	1	55544/2	5,755	55559/2	5,475
108	48	8-10		Laminate	1	55544/5	4,265	55559/5	3,985
108	54	8-10		Veneer	1	55545/2	6,335	55560/2	6,065
108	54	8-10		Laminate	1	55545/5	4,630	55560/5	4,350

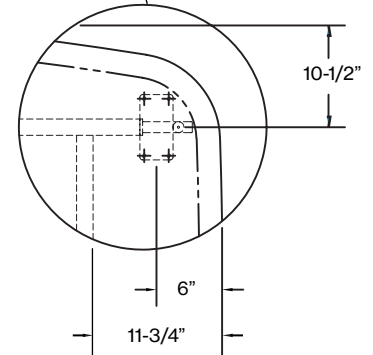

NOMAD TABLES - BOAT



Nomad Boat shape with center column bases

1" thick top, 29" H

Stretcher rails are silver anodized aluminum.

1" Nomad® Taper Edge



Self Edge (SE)

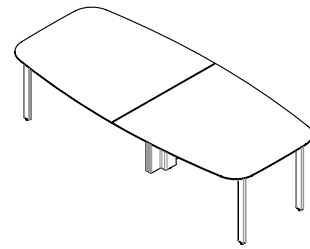
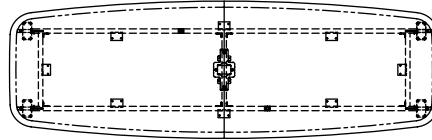

L"	X	D"	Sugg Seat Capacity	Top Finish	Top Sections	POWDER COAT BASE		POLISHED ALUMINUM BASE	
						Model Number	List Price	Model Number	List Price
120	48	8-10	Veneer	2	55941/2	8,040	55961/2	7,760	
120	48	8-10	Laminate	2	55941/5	6,330	55961/5	6,060	
120	54	8-10	Veneer	2	55942/2	8,540	55962/2	8,270	
120	54	8-10	Laminate	2	55942/5	6,620	55962/5	6,330	
120	60	8-10	Veneer	2	55943/2	8,900	55963/2	8,620	
120	60	8-10	Laminate	2	55943/5	6,745	55963/5	6,465	
144	48	10-12	Veneer	2	55944/2	9,625	55964/2	9,345	
144	48	10-12	Laminate	2	55944/5	7,620	55964/5	7,345	
144	54	10-12	Veneer	2	55945/2	10,265	55965/2	9,985	
144	54	10-12	Laminate	2	55945/5	7,895	55965/5	7,615	
144	60	10-12	Veneer	2	55946/2	10,745	55966/2	10,465	
144	60	10-12	Laminate	2	55946/5	8,200	55966/5	7,925	
168	48	12-14	Veneer	2	55947/2	10,575	55967/2	10,290	
168	48	12-14	Laminate	2	55947/5	8,305	55967/5	8,025	
168	54	12-14	Veneer	2	55948/2	11,235	55968/2	10,955	
168	54	12-14	Laminate	2	55948/5	8,660	55968/5	8,380	
168	60	12-14	Veneer	2	55949/2	11,990	55969/2	11,720	
168	60	12-14	Laminate	2	55949/5	9,020	55969/5	8,735	
180	48	12-14	Veneer	3	55950/2	11,105	55970/2	10,830	
180	48	12-14	Laminate	3	55950/5	8,710	55970/5	8,430	
180	54	14-16	Veneer	3	55951/2	11,815	55971/2	11,545	
180	54	14-16	Laminate	3	55951/5	9,070	55971/5	8,790	
180	60	14-16	Veneer	3	55952/2	12,525	55972/2	12,255	
180	60	14-16	Laminate	3	55952/5	9,460	55972/5	9,180	
216	48	14-16	Veneer	3	55953/2	13,775	55973/2	13,495	
216	48	14-16	Laminate	3	55953/5	10,690	55973/5	10,410	
216	54	16-18	Veneer	3	55954/2	14,615	55974/2	13,335	
216	54	16-18	Laminate	3	55954/5	11,455	55974/5	11,180	
216	60	16-18	Veneer	3	55955/2	15,425	55975/2	15,145	
216	60	16-18	Laminate	3	55955/5	11,870	55975/5	11,580	
240	48	14-16	Veneer	4	55956/2	15,45	55976/2	15,195	
240	48	14-16	Laminate	4	55956/5	12,295	55976/5	12,045	
240	54	16-18	Veneer	4	55957/2	16,300	55977/2	16,045	
240	54	16-18	Laminate	4	55957/5	12,820	55977/5	12,555	
240	60	18-20	Veneer	4	55958/2	17,310	55978/2	17,055	
240	60	18-20	Laminate	4	55958/5	13,285	55978/5	13,025	

Notes:

(1) Table with 2 sections top consists of 4 bases and 1 center column base.

(2) Table with 3 sections top consists of 4 bases and 2 center column bases.

(3) Table with 4 sections top consists of 4 bases and 3 center column bases.

NOMAD TABLES - SQUARE



Square shape

1" thick top, 29" H

Stretcher rails are silver anodized aluminum.

1" Nomad® Taper Edge



Self Edge (SE)

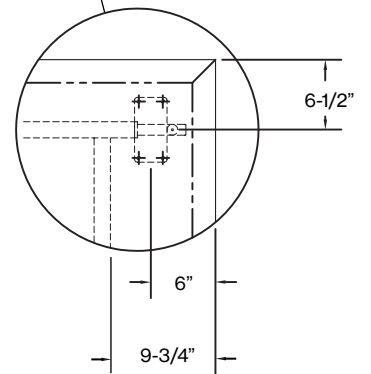
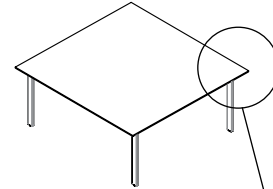
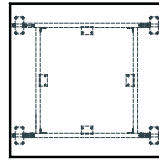

L"	X	D"	Sugg Seat Capacity	Top Finish	Top Sections	POWDER COAT BASE		POLISHED ALUMINUM BASE	
						Model Number	List Price	Model Number	List Price
42	42	2-4		Veneer	1	55561/2	3,030	55564/2	2,745
42	42	2-4		Laminate	1	55561/5	2,610	55564/5	2,330
48	48	2-4		Veneer	1	55562/2	3,375	55565/2	3,090
48	48	2-4		Laminate	1	55562/5	2,875	55565/5	2,595
54	54	4-6		Veneer	1	55563/2	4,075	55566/2	3,795
54	54	4-6		Laminate	1	55563/5	3,380	55566/5	3,100

NOMAD TABLES - TRAINING

Training Table

1" thick top, 29" H

Stretcher rails are silver anodized aluminum.

1" Nomad® Taper Edge



Self Edge (SE)

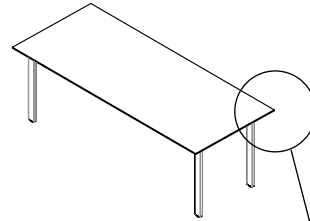
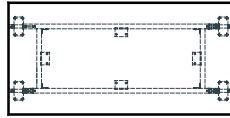

L"	X	D"	Sugg Seat Capacity	Top Finish	Top Sections	POWDER COAT BASE		POLISHED ALUMINUM BASE	
						Model Number	List Price	Model Number	List Price
60	30	4-6		Veneer	1	55571/2	2,930	55577/2	2,645
60	30	4-6		Laminate	1	55571/5	2,420	55577/5	2,140
60	36	4-6		Veneer	1	55572/2	3,175	55578/2	2,900
60	36	4-6		Laminate	1	55572/5	2,530	55578/5	2,250
72	30	4-6		Veneer	1	55573/2	3,295	55579/2	3,005
72	30	4-6		Laminate	1	55573/5	2,640	55579/5	2,355
72	36	4-6		Veneer	1	55574/2	3,535	55580/2	3,255
72	36	4-6		Laminate	1	55574/5	2,765	55580/5	2,485
84	30	6-8		Veneer	1	55575/2	3,585	55581/2	3,305
84	30	6-8		Laminate	1	55575/5	2,805	55581/5	2,530
84	36	6-8		Veneer	1	55576/2	3,770	55582/2	3,490
84	36	6-8		Laminate	1	55576/5	2,975	55582/5	2,695

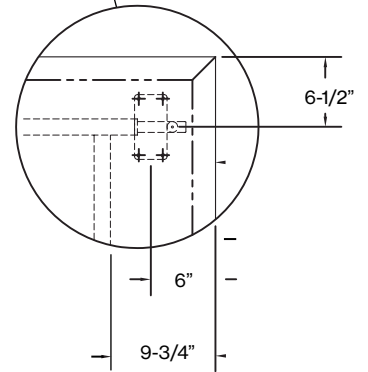

FORUMS

M & N SERIES FORUM

M & N Series Forum are available in a wide range of configurations for power, data and audio/video requirement. Configure your require M & N Series Forum on our web site at this link www.nienkamper.com/vfc



SIMPLE POP UP FORUM - Single sided (Surface mounted)

Pre-configured SIMPLE Pop Up Forum			List Price				
Model # 85190	pre-wired power (2 ports)	<table><tr><td>1P</td><td>1P</td></tr></table> cutout dimension: 5"W x 4"D 2 x pre-wired power with 10ft cord	1P	1P	\$515		
1P	1P						
Model # 85191	pre-wired power (3 ports)	<table><tr><td>1P</td><td>1P</td><td>1P</td></tr></table> cutout dimension: 6 1/2"W x 4"D 3 x pre-wired power with 10ft cord	1P	1P	1P	\$530	
1P	1P	1P					
Model # 85192	pre-wired power (3 ports)	<table><tr><td>1P</td><td>1P</td><td>A0</td></tr></table> cutout dimension: 6 1/2"W x 4"D 2 x pre-wired power with 10ft cord 1 x AMP CAT5E data with 9ft cord	1P	1P	A0	\$605	
1P	1P	A0					
Model # 85193	pre-wired power (3 ports)	<table><tr><td>1P</td><td>1P</td><td>A5</td></tr></table> cutout dimension: 6 1/2"W x 4"D 2 x pre-wired power with 10ft cord 1 x Siemon CAT6 data with 10ft cord	1P	1P	A5	\$640	
1P	1P	A5					
Model # 85197	pre-wired power (4 ports)	<table><tr><td>1P</td><td>1P</td><td>O</td></tr></table> cutout dimension: 6 1/2"W x 4"D 2 x pre-wired power with 10ft cord 1 x open port / data adapter to fit in client's own data fitting and cord	1P	1P	O	\$530	
1P	1P	O					
Model # 85194	pre-wired power (3 ports)	<table><tr><td>1P</td><td>1P</td><td>2U</td></tr></table> cutout dimension: 6 1/2"W x 4"D 2 x pre-wired power with 10ft cord 2 x USB-A charger (stacked)	1P	1P	2U	\$610	
1P	1P	2U					
Model # 85195	pre-wired power (4 ports)	<table><tr><td>1P</td><td>1P</td><td>A0</td><td>A0</td></tr></table> cutout dimension: 8"W x 4"D 2 x pre-wired power with 10ft cord 2 x AMP CAT5E data with 9ft cord	1P	1P	A0	A0	\$660
1P	1P	A0	A0				

Model # 85196	pre-wired power (4 ports)	<table><tr><td>1P</td><td>1P</td><td>A5</td><td>A5</td></tr></table> <p>cutout dimension: 8"W x 4"D 2 x pre-wired power with 10ft cord 2 x Siemon CAT6 data with 10ft cord</p>	1P	1P	A5	A5	\$735		
1P	1P	A5	A5						
Model # 85198	pre-wired power (4 ports)	<table><tr><td>1P</td><td>1P</td><td>O</td><td>O</td></tr></table> <p>cutout dimension: 8"W x 4"D 2 x pre-wired power with 10ft cord 2 x open port / data adapter to fit in client's own data fitting and cord</p>	1P	1P	O	O	\$555		
1P	1P	O	O						
Model # 85199	pre-wired power (4 ports)	<table><tr><td>1P</td><td>1P</td><td>2U</td><td>HD</td></tr></table> <p>cutout dimension: 8"W x 4"D 2 x pre-wired power with 10ft cord 2 x USB-A charger (stacked) 1 x HDMI coupler with 18" cord</p>	1P	1P	2U	HD	\$750		
1P	1P	2U	HD						
Model # 85200	pre-wired power (4 ports)	<table><tr><td>1P</td><td>1P</td><td>2U</td><td>O</td></tr></table> <p>cutout dimension: 8"W x 4"D 2 x pre-wired power with 10ft cord 2 x USB-A charger (stacked) 1 x open port / data adapter to fit in client's own data fitting and cord</p>	1P	1P	2U	O	\$655		
1P	1P	2U	O						
Model # 85201	pre-wired power (6 ports)	<table><tr><td>1P</td><td>1P</td><td>2U</td><td>HD</td><td>A0</td><td>A0</td></tr></table> <p>cutout dimension: 11"W x 4"D 2 x pre-wired power with 10ft cord 2 x USB-A charger (stacked) 1 x HDMI coupler with 18" cord 2 x AMP CAT5E data with 9ft cord</p>	1P	1P	2U	HD	A0	A0	\$940
1P	1P	2U	HD	A0	A0				
Model # 85202	pre-wired power (6 ports)	<table><tr><td>1P</td><td>1P</td><td>2U</td><td>HD</td><td>A5</td><td>A5</td></tr></table> <p>cutout dimension: 11"W x 4"D 2 x pre-wired power with 10ft cord 2 x USB-A charger (stacked) 1 x HDMI coupler with 18" cord 2 x Siemon CAT6 data with 10ft cord</p>	1P	1P	2U	HD	A5	A5	\$1,015
1P	1P	2U	HD	A5	A5				
Model # 85203	pre-wired power (6 ports)	<table><tr><td>1P</td><td>1P</td><td>2U</td><td>HD</td><td>O</td><td>O</td></tr></table> <p>cutout dimension: 11"W x 4"D 2 x pre-wired power with 10ft cord 2 x USB-A charger (stacked) 1 x HDMI coupler with 18" cord 2 x open port/ data adapter to fit in client's own data fitting and cord</p>	1P	1P	2U	HD	O	O	\$815
1P	1P	2U	HD	O	O				



SIMPLE POP UP FORUM – DOUBLE SIDED (SURFACE MOUNTED)

Pre-configured SIMPLE Pop Up Forum

List Price

Model # 85205 pre-wired power
(each side - 2 ports)

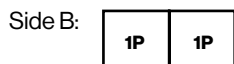

cutout dimension: 5"W x 7-11/16"D
 Side A: 2 x pre-wired power with 10ft cord
 Side B: 2 x pre-wired power with 10ft cord
 (Provides a total of 4 x pre wired power)

\$1,055

Model # 85206 pre-wired power
(each side - 3 ports)

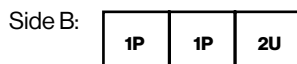
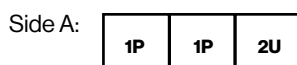

cutout dimension: 6-1/2"W x 7-11/16"D
 Side A: 2 x pre-wired power with 10ft cord
 2 x USB-A Charger (stacked)
 Side B: 2 x pre-wired power with 10ft cord
 2 x USB-A Charger (stacked)
 (Provides a total of 4 x pre wired power & 4 x USB Charger)

\$1,320

Model # 85207 pre-wired power
(each side - 4 ports)

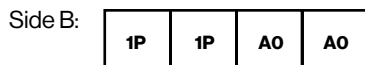
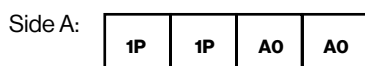

cutout dimension: 8"W x 7-11/16"D
 Side A: 2 x pre-wired power with 10ft cord
 2 x AMP CAT5E data with 10ft cord
 Side B: 2 x pre-wired power with 10ft cord
 2 x AMP CAT5E data with 10ft cord
 (Provides a total of 4 x pre wired power & 4 x AMP CAT5E data)

\$1,340

Model # 85208	pre-wired power (each side - 4 ports)	Side A: <table border="1"> <tr> <td>1P</td><td>1P</td><td>A5</td><td>A5</td></tr> </table> Side B: <table border="1"> <tr> <td>1P</td><td>1P</td><td>A5</td><td>A5</td></tr> </table> cutout dimension: 8"W x 7-11/16"D Side A: 2 x pre-wired power with 10ft cord 2 x Siemon CAT6 data with 10ft cord Side B: 2 x pre-wired power with 10ft cord 2 x Siemon CAT6 data with 10ft cord (Provides a total of 4 x pre wired power & 4 x Siemon CAT6 data)	1P	1P	A5	A5	1P	1P	A5	A5	\$1,495
1P	1P	A5	A5								
1P	1P	A5	A5								
Model # 85209	pre-wired power (each side - 4 ports)	Side A: <table border="1"> <tr> <td>1P</td><td>1P</td><td>O</td><td>O</td></tr> </table> Side B: <table border="1"> <tr> <td>1P</td><td>1P</td><td>O</td><td>O</td></tr> </table> cutout dimension: 8"W x 7-11/16"D Side A: 2 x pre-wired power with 10ft cord 2 x open port/data adapter to fit in client's own data fitting and cord Side B: 2 x pre-wired power with 10ft cord 2 x open port/data adapter to fit in client's own data fitting and cord (Provides a total of 4 x pre wired power & 4 x open ports)	1P	1P	O	O	1P	1P	O	O	\$1,085
1P	1P	O	O								
1P	1P	O	O								
Model # 85210	pre-wired power (each side - 4 ports)	Side A: <table border="1"> <tr> <td>1P</td><td>1P</td><td>2U</td><td>O</td></tr> </table> Side B: <table border="1"> <tr> <td>1P</td><td>1P</td><td>2U</td><td>O</td></tr> </table> cutout dimension: 8"W x 7-11/16"D Side A: 2 x pre-wired power with 10ft cord, 2 x USB-A Charger (stacked) 1 x open port/ data adapter to fit in client's own data fitting and cord Side B: 2 x pre-wired power with 10ft cord, 2 x USB-A Charger (stacked) 1 x open port/ data adapter to fit in client's own data fitting and cord (Provides a total of 4 x pre wired power, 4 x USB Charger & 2 x open ports)	1P	1P	2U	O	1P	1P	2U	O	\$1,335
1P	1P	2U	O								
1P	1P	2U	O								

FORUMS - SIMPLE POP UP FORUM



SIMPLE POP UP FORUM – side to side (SURFACE MOUNTED)

Model # 85211 pre-wired power
(each side - 4 ports)

Side 1:

1P	1P	A0	A0
----	----	----	----

Side 2:

1P	1P	A0	A0
----	----	----	----

\$1,425

cutout dimension: 16.19"W x 4"D

Side #1: 2 x pre-wired power with 10ft cord
2 x AMP CAT5E data with 10ft cord

Side #2: 2 x pre-wired power with 10ft cord
2 x AMP CAT5E data with 10ft cord

(Provides a total of 4 x pre wired power & 4 x AMP CAT5E data)

Model # 85212 pre-wired power
(each side - 4 ports)

Side 1:

1P	1P	A5	A5
----	----	----	----

Side 2:

1P	1P	A5	A5
----	----	----	----

\$1,580

cutout dimension: 16.19"W x 4"D

Side #1: 2 x pre-wired power with 10ft cord
2 x Siemon CAT6 data with 10ft cord

Side #2: 2 x pre-wired power with 10ft cord
2 x Siemon CAT6 data with 10ft cord

(Provides a total of 4 x pre wired power & 4 x Siemon CAT6 data)

Model # 85213 pre-wired power
(each side - 4 ports)

Side 1:

1P	1P	O	O
----	----	---	---

Side 2:

1P	1P	O	O
----	----	---	---

\$1,165

cutout dimension: 16.19"W x 4"D

Side #1: 2 x pre-wired power with 10ft cord
2 x open port/data adapter to fit in client's own data fitting and cord

Side #2: 2 x pre-wired power with 10ft cord
2 x open port/data adapter to fit in client's own data fitting and cord

(Provides a total of 4 x pre wired power & 4 x open ports)

Model # 85214 pre-wired power
(each side - 4 ports)

Side 1:

1P	1P	2U	O
----	----	----	---

Side 2:

1P	1P	2U	O
----	----	----	---

\$1,415

cutout dimension: 16.19"W x 4"D

Side #1: 2 x pre-wired power with 10ft cord
2 x USB-A Charger (stacked)
1 x open port/data adapter to fit in client's own data fitting and cord

Side #2: 2 x pre-wired power with 10ft cord
2 x USB-A Charger (stacked)
1 x open port/data adapter to fit in client's own data fitting and cord

(Provides a total of 4 x pre wired power, 4 USB Charger & 2 x open ports)

FORUMS - SIMPLE POP UP FORUM

- Note:
- Finish is standard in clear anodized aluminum.
 - For power cord with 6ft long, please add a letter "B" at the end of model #.
 - Site-wired / hard-wired power with 72" metallic shielded cable is available with an upcharge of \$60 list per 2 power. Please add a letter "H" at the end of model #.
-

Each open port selected will be supplied with one set of data adapter kit contains 2 "AA", 2 "BB", 2 "CC", 2 "DD", 2 "EE", 2 "FF", 1 "GG" and 1 "HH". adapter. The data adapter can accommodate the following data fitting from manufacturer:

Adapter "AA"

Systimax/CommScope
Uniprise/CommScope

Adapter "BB"

L-Com Keystone Modular
Tyco SL/110 Connect Series Modular Jacks
Siemon Keystone Style
Allen Tel Versa Tap Series
Leviton Quick Port® Series
Nordx Keystone Style
Tyco SL Conpler Series

Adapter "CC"

Krone 6000 Series/ADC
Hubbell Xcelerator™ Keystone
Series

Adapter "DD"

blank

Adapter "EE"

Ortronics TracJack Series

Adapter "FF"

Panduit Mini-Com Series

Adapter "GG"

microphone jack / 3pin XLR, solder type
only

Adapter "HH"

Adapter "HH" - video monitor jack / DB-15,
panel mount solder type.

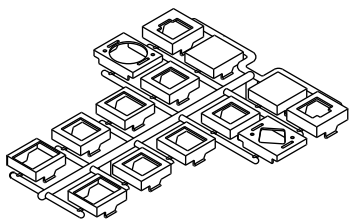

- Snap in fitting adapters are also provide for 3-pin XLR microphone jack (solder type only) and DB-15 video monitor jack (panel mount solder style only)

FORUMS - SIMPLE POP UP FORUM

List Price

Client can configure their own SIMPLE Pop Up Forum by selecting a base model and require elements.

Base Model For Simple Pop Up Forum

(4 Ports)

Model #: CX4P - _____

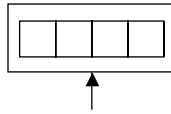

\$450

Base Model For Simple Pop Up Forum

(6 Ports)

Model #: CX6P - _____

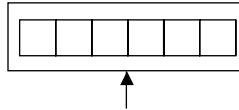

\$505

Base Model For Simple Pop Up Forum – Double Sided

(Each Side – 4 Ports)

Model #: CX8PD-A _____ (Side A)

CX8PD-B _____ (Side B)

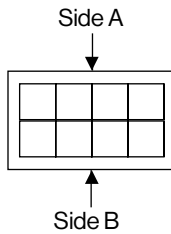

\$960

Base Model For Simple Pop Up Forum – Side By Side

(Each Side – 4 Ports)

Model #: CX8PS-1 _____ (Side 1)

CX8PS-2 _____ (Side 2)

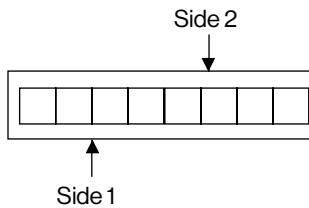

\$1,000

Select the elements as per below:



1P - 1 power receptacle with 10' white cord

\$110



1P-SW - 1 power receptacle hard wired with a 6' whip

\$130



A0- AMP CAT5E data fitting with 9' connector cable
A5 - SIEMON CAT 6 data fitting with 10' connector cable

\$125

\$145



C - Audio- 3.5mm Mini stereo Jack with 10' cord

\$70



H - USB port 3.0 with 10ft cord

\$100



2U - Stacked USB charger

\$135



G - DB15HD, VGA connector, 10' cord

\$160



HD - HDMI Coupler with 18' cord

\$160



B - Blank plate

\$45



O - Open port, for client's own data fitting. Each port selected will be supplied with one set of data adapter kit (see page 43)

\$45



L - Belay 1' dia. hole opening rubber strain relief pass through cords

\$45

GROMMETS & CABLE CONDUITS

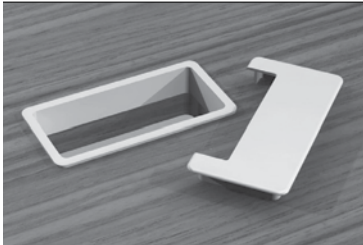
	Model Number	List Price	Product Description
VOX® PLASTIC GROMMET			
	70286 (black)	\$60	This large rectangular plastic grommet has capacity for the most demanding wire management needs. When not in use the hinged cover swings up to close the grommet. Overall dimension is 4" L x 2" W (interior clearance - 3 ⁵ / ₈ " L x 1 ⁵ / ₈ " W).
	70287 (cool grey)	\$60	
	70288 (warm grey)	\$60	
			Available in three colours to coordinate with a variety of top finishes.

VOX® ALUMINUM GROMMET

Grommet for Power Cable

23416

\$270



- Flush aluminum grommet accommodates two 16 gauge power cables and plugs, or 6 data/voice cables and plugs.
- Finished outside diameter 1⁵/₈", inside diameter is 1¹/₄".
- Available in five anodized aluminum colours: silver, champagne, light bronze, bronze and black.

Grommet for Large Power Cable

23418

\$365



- Flush aluminum grommet accommodates three 16 gauge power cables and plugs, or 10 data/voice cables and plugs.
- Finished outside diameter 2⁷/₈", inside diameter is 2¹/₄".
- Suitable for international power plugs.
- Available in five anodized aluminum colours: silver, champagne, light bronze, bronze and black.

GROMMETS & CABLE CONDUITS

	Model Number	List Price	Product Description
	70277	\$290	<ul style="list-style-type: none"> • A high quality grommet option that offers a nice contrast to any top surface and are built to withstand many years of use. Made of a heavy gauge aluminum extrusion with a large access hole. • Covers will not pull out during use. Overall dimension is 5^{1/4}" L x 2^{1/4}" W (interior clearance – 4^{3/4}" L X 2^{1/4}" W). • Available in five anodized aluminum colours: silver, champagne, light bronze, bronze and black.

VOX® CABLE CONDUIT

Vox® Expandable Cable Conduit



55024-B black	\$970
55024-S silver	\$970
55024-C clear	\$970

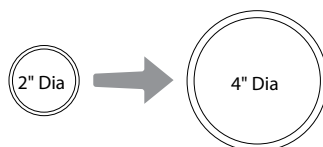

The Vox® Expandable Cable Conduit is made of woven, flexible plastic wire. Its unique properties allow it to expand and contract to allow for different cable capacities.

A "U" bracket at the top attaches to the support rail. An 8" diameter counter weight is incorporated at the base which can be positioned to accommodate core drills or receptacle positions. Inside hole diameter is 3.5".

Cable capacity range is from two inches to four inches.

Shipped with extra length, the Vox expandable cable conduit can easily be shortened on site if required.

Vox® Linked Cable Conduit



55025-B black	\$1,055
55025-S silver	\$1,055
55025-C clear	\$1,055

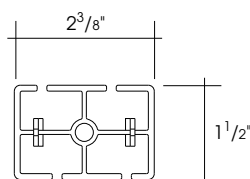

The Vox® Linked Cable Conduit is comprised of a series of plastic elements that are divided into 4 cavities.

As an assembly it bends in a single direction but may also be rotated about its top mount.

A "U" bracket at the top attaches to the support rail.

An 8" diameter counter weight is incorporated at the base which can be positioned to accommodate core drills or receptacle positions. Inside hole diameter is 3.5".

- 2" long segments can be removed to desired length.
- Wire capacity: eighteen 16 gauge cables.





Conference Table: Rectangular

D: 36", 42", 48", 54", 60"
W: 60" - 240"

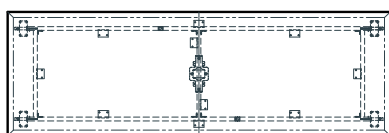
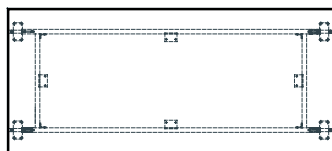

Conference Table: Nomad Boat

D: 36", 42", 48", 54", 60"
W: 60" - 240"

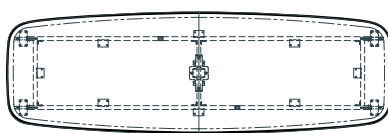

**Meeting Table:
Square**

D: 42", 48", 54"

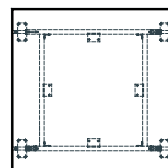

Training Table

D: 30", 36"
W: 60", 72", 84"

