

TS312 Shortcut® Seat Cushion Installation for All Shortcut® Chairs and Stools

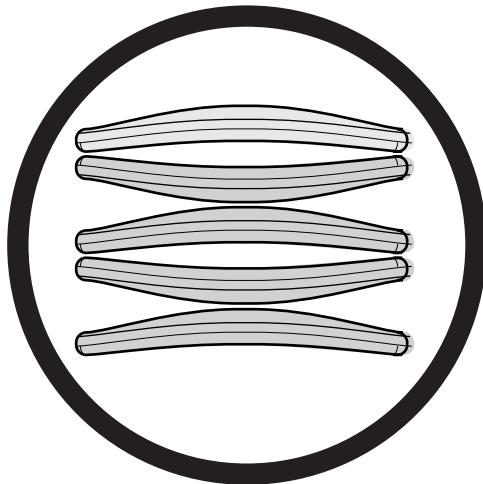

YES

CAUTION
If stacking several cushions,
avoid damaging them by
stacking plastic to plastic
and fabric to fabric.
Do not stack in a
nested arrangement

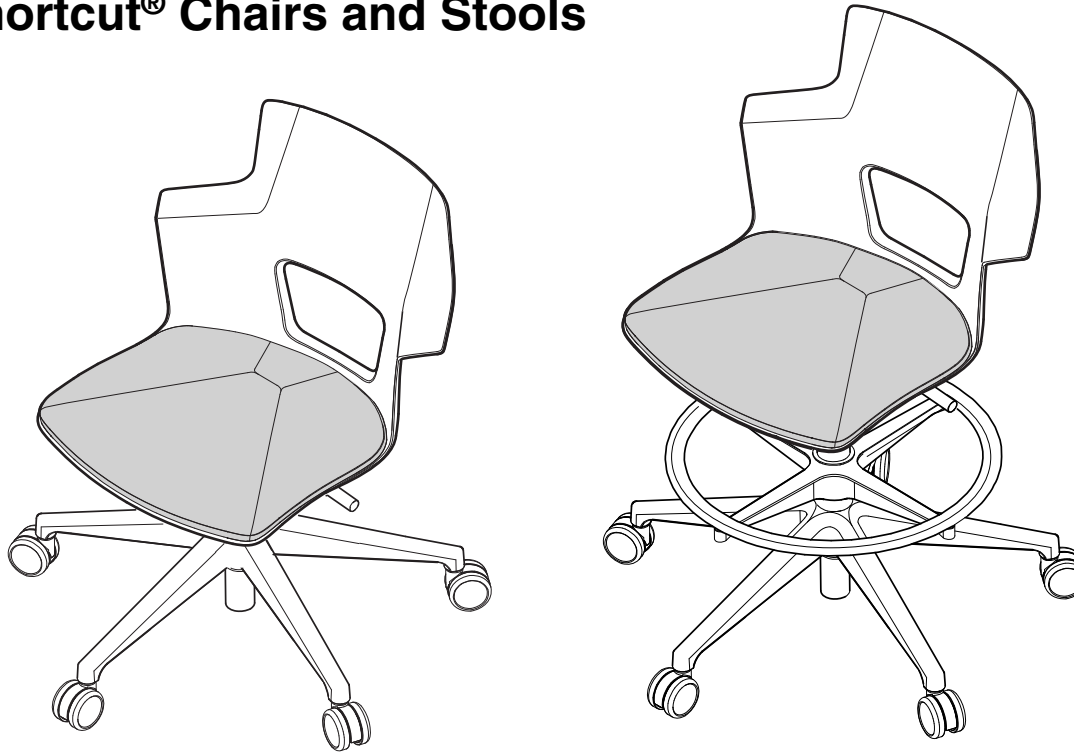
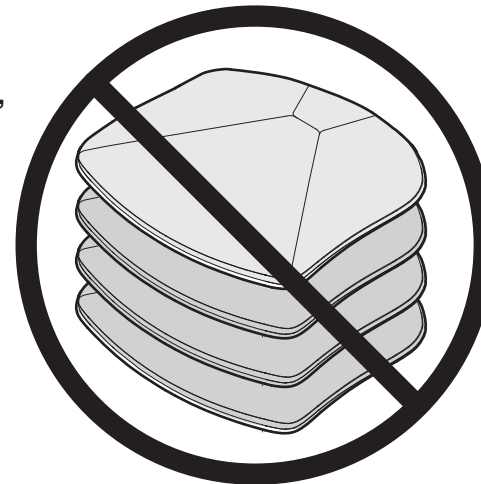

NO

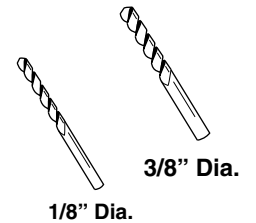
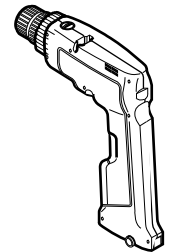

1/8" Dia.

3/8" Dia.

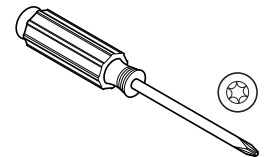

T-30
SCREWDRIVER

1. Extend height of chair and place it upside-down on a support surface that will not scratch the shell (such as a desk).

2. Drill pilot hole at each pilot point (6X) with an approximately 1/8" drill bit.

3. Use a 3/8" bit to enlarge hole to proper diameter.

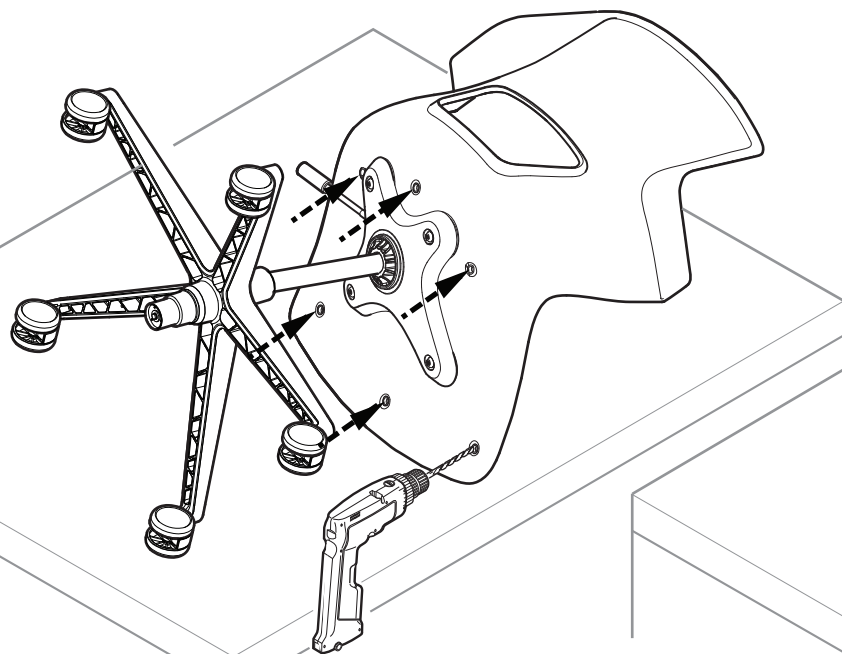

CAUTION:
Do not drill into (or damage)
your support surface.

4. Align cushion to chair shell so that the bosses of the cushion fit inside the holes of the chair shell.

5. With a T-30 hand driver, loose secure the cushion in one of the corners.

6. Tightly secure (16 in-lbs) a screw in the opposite corner. If power drill is used, do not have your drive in "drill" mode.

7. Secure all other screws, including the loose screw from Step 5.

8. Return chair to upright position on floor.

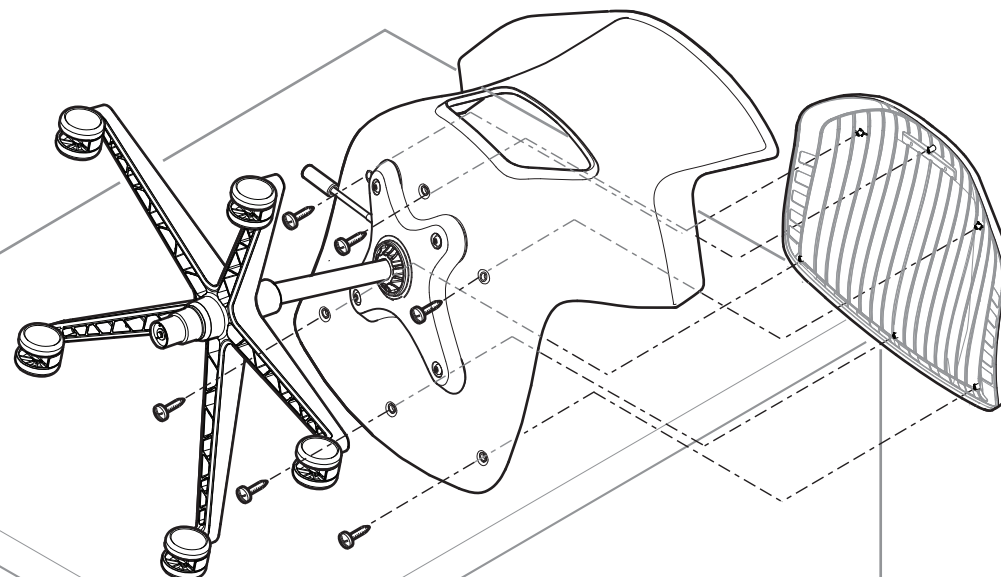

CAUTION:
Torque screws to 16 in-lbs. Hand
driver recommended. If power driver
is used, do not use "drill" mode.