



Product data sheet

Back support, Series 801 801.51B9163

HEWI



Back support, Series 801 801.51B9163

- back rest with rectangular rods and fixing rosettes on both sides
- used to support the back on the WC
- wall-mounted with rosettes
- 650 to 750 mm wide, 150 mm deep, back rest 334 mm high and 370 mm wide, rod diameter 33 mm, rosette diameter 70 mm
- with continuous, corrosion-protected steel core
- back rest made of synthetic material in HEWI colour 90 (jet black)
- connection made of high-quality, matt polyamide in HEWI colours 99 (pure white), 98 (signal white), 97 (light grey), 95 (rock grey) and 92 (anthracite grey)
- meets the requirements according to DIN 18040 and ÖNORM B1600/1601

Article no.: HEWI 801.51B9163

Dimensions

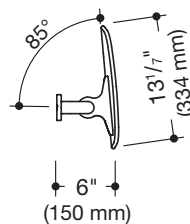
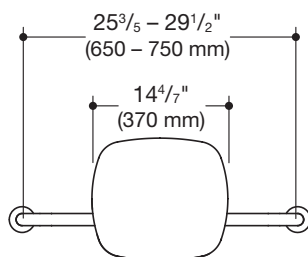

Colors



Polyamide, mat



Backrest

Technical information subject to alteration, March 6th, 2021

HEWI Inc.
350 Fifth Avenue, Suite 5220 Phone: 866 853-8003
New York, NY 10118

hewi@hewi.us
www.hewi.com