

- ENG WARNING – RISK OF FIRE AND ELECTRIC SHOCK. THIS PRODUCT IS BEST INSTALLED BY A QUALIFIED ELECTRICIAN. INSTALL IN ACCORDANCE WITH CURRENT NEC WIRING REGULATIONS. SUITABLE FOR DRY LOCATIONS ONLY. THE FITTING MUST BE GROUNDED. TURN OFF POWER AT THE MAIN FUSE BEFORE COMMENCING INSTALLATION.
- FR ATTENTION – RISQUE D’INCENDIE, RISQUE DE CHOC. CE PRODUIT DOIT ÊTRE INSTALLÉ SELON LE CODE D’INSTALLATION PERTINENT, PAR UNE PERSONNE QUI CONNAÎT BIEN LE PRODUIT ET SON FONCTIONNEMENT AINSI QUE LES RISQUES INHÉRENTS. POUR EMPLACEMENT SECS SEULEMENT L’APPAREIL DOIT ÊTRE MIS À LA TERRE. COUPEZ LE FUSIBLE PRINCIPAL AVANT DE COMMENCER L’INSTALLATION.
1. Prepare the fitting for installation, consulting the instructions and diagrams on the inside pages. Once the desired drop of pendant is established, the wire & luminaire flex length may be shortened. If the fitting is at the desired drop already, then skip to instruction point number 3.

2. To shorten the luminaire flex:-

a. Establish required length of flex (ensuring there is some slack) before using wire cutters to remove excess.

b. Remove the outer jacket from the last 6” of the flex, then remove the last 1/4” of inner jacket from both cores to expose the bare wire.

c. Take care not to damage the interior of the flex when removing the outer jacket.

Wire support assembly: use supplied hex key to loosen the screws of the grip, pull wire through and fully tighten ensuring a firm grip on the wire once desired length achieved. Wire must be shorter than the cable to avoid straining the luminaire flex.

3. This fitting should be installed on a 4” junction box (not supplied).

4. Open your existing junction box (if you do not have one in the desired position you will need to get an electrician to install one). If removing an existing fitting first, note all wiring connections: record which of the house wires is connected to the live, neutral and earth (ground) terminals.

5. In your junction box there should be two supply wires and one ground wire. Connect your new lamp to the electrical supply using UL-approved wire nuts. Connect the live (hot) black wire from the power supply to the black conductors on the luminaire flex, then the white (neutral) wire to the white conductors on the luminaire flex and bare copper or green/yellow ground wire to the green conductors on the luminaire flex and green/yellow conductor attached to the ceiling rose.
- KEY

L = Live (hot)

N = Neutral

⊕ = Earth (ground)

Fitting

BLACK

GRN/YEL

WHITE

⊗ L ⊗

⊗ ⊕ ⊗

⊗ N ⊗

BLACK

\*

WHITE

Mains Supply

\*check installation
6. Support the fitting so that no strain is applied to the wiring when making the electrical connections. If necessary get a colleague to help.

7. See hanging instructions inside to complete the installation.

8. Fit the correct type and wattage of lamp (or less). Be careful not to overtighten the lamp.

9. Switch on at the fuse-board. Your light fitting is now ready for use.

**Other Important Information**

Switch off at mains before changing lamp(s). Never fit a lamp of greater wattage than recommended. Ensure children do not play with the light fitting. Dispose of old lamps carefully. Never leave a fitting without a lamp in position (or someone can accidentally touch the contacts). Adjust fitting only when power to the fitting is off and has been left to cool. If the electrical flex or electrical components become damaged at any point, power to the fitting should be disconnected immediately and not operated until the damaged parts are fixed/replaced. For use in dry, indoor environment only. Ensure the fitting does not come into contact with any liquids.

**Cleaning and Maintenance**

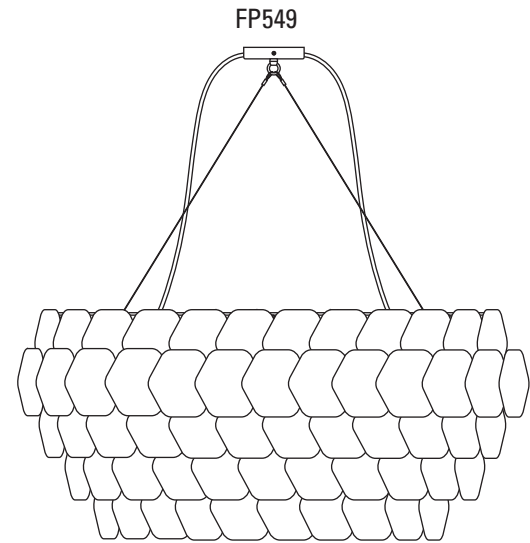

Metal finishes should only be cleaned with a soft, dry cloth. Do not use polishes or abrasives. Bone china can be cleaned with a soft damp cloth, with some mild diluted detergent if necessary. Switch off the power to the fitting before cleaning.



# Cranton Oval Pendant Light

| 120V AC 60Hz | IP20

US-FP549 Cranton Oval Pendant

LAMP GUIDANCE				
BASE	SHAPE		TYPE*	WATTAGE**
 E26	 A	 BALL	INCANDESCENT	✓
			CFL	✓
			ECO-HALOGEN	✓
			LED	✓
				FP549
				6 x 100W MAX
				6 x 24W
				6 x 70W
				6 x 18W

\* Warm white (2700k) low energy lamps recommended.

\*\* Wattage value provided as a guide to suitable lamps. Lower wattage than stated may be used.

## Contents

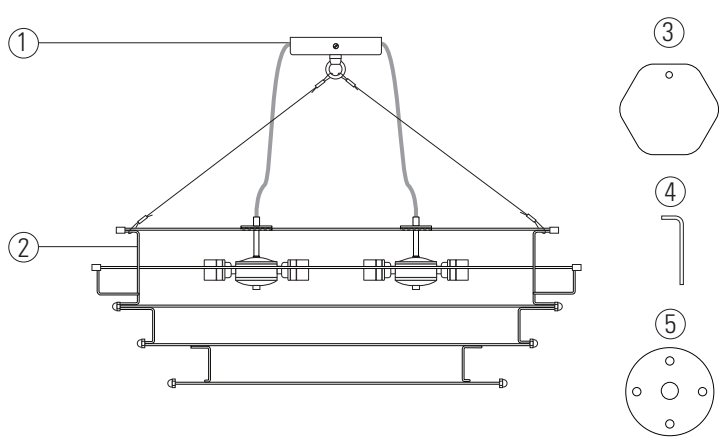

## Contents

- 1 Ceiling rose
- 2 Luminaire frame
- 3 144 x Ceramic discs
- 4 1 x Hex key
- 5 1 x J-box cover disc

## Tools Required

- Cross head screwdriver
- Small flat-head screwdriver
- Drill (if holes are required)
- Junction box
- Wire nuts

## Assembly

Please ensure your hands are clean before you start.  
We recommend the discs are fitted after the light is hanging (when discs are attached, the fittings is very heavy). When attaching the discs, complete each tier one at a time. Work up from the bottom of the light ensuring that each disc overlaps the one before. We strongly recommend the help of a second person when installing.

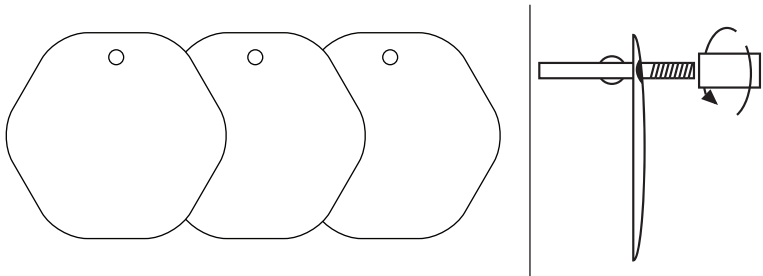

## Installation Diagram

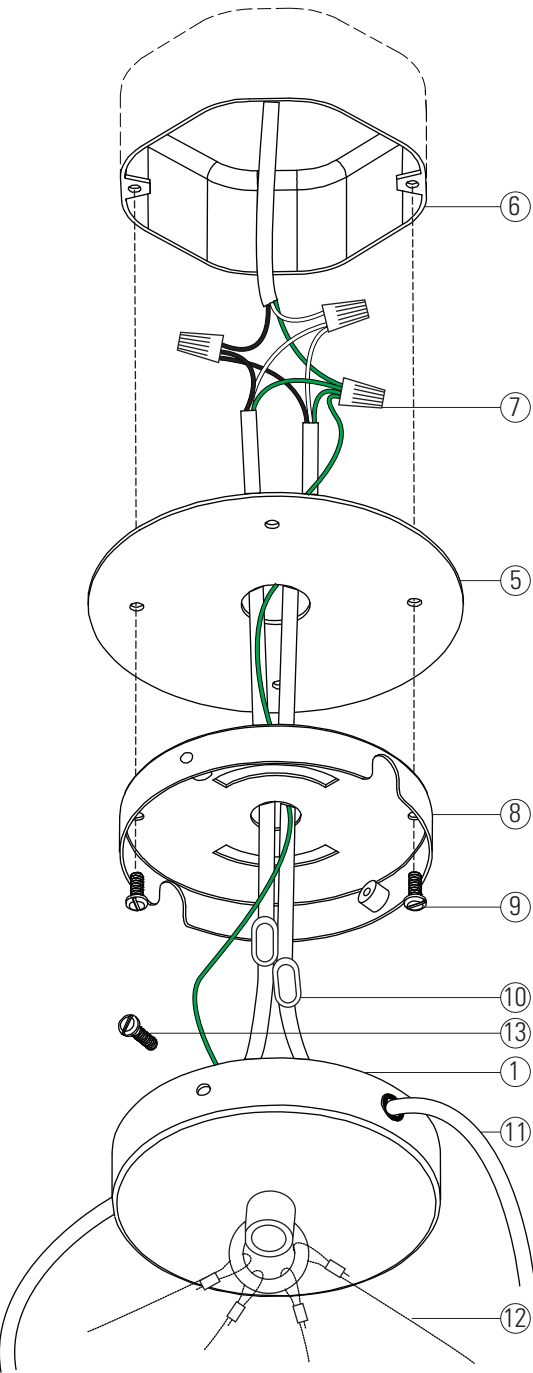

## KEY

- 1 Ceiling rose
- 5 J-box cover disc
- 6 J-box
- 7 Wire nut
- 8 Steel mounting disc
- 9 J-box screw
- 10 Cord grip
- 11 Luminaire flex
- 12 Wire support
- 13 Side screw

STEP 1 - Determine the drop of your luminaire and adjust the wire support (12) accordingly. Use the supplied hex key (4) to adjust the wire grips and remove any excess wire with wire cutters.

STEP 2 - Adjust the length of the luminaire flex (11), following point 2 overleaf, leaving at least 6" to make the connections inside the J-box (6). Note that the weight of the fitting is to be supported by the wire support, NOT the luminaire flex. The luminaire flex MUST be longer than the wire support, with some slack in the luminaire flex.

STEP 3 - Feed the luminaire flex through the grommated side entries of the ceiling rose (1) and then through the cord grips (10) to prevent the flex from being pulled loose.

STEP 4 - While supporting the weight of the fitting, feed the flex through the steel mounting disc (8) and J-box cover disc (5) before making the connections to the main supply using UL-approved wire nuts (7), suitable for the number of connections, wire gauge and core type. Refer to point 5 overleaf for details.

STEP 5 - Attach the J-box cover and steel mounting disc to the J-box using the existing J-box screws (9)

STEP 6 - Secure the ceiling rose (1) to the steel mounting disc (8) using the two side screws (13).

STEP 7 - Attach the ceramic discs (3) to the frame, referring to the diagram and instructions opposite.