

Parts Diagram

Strive® Seating

4-Leg Armless Stack Chair & Cafe Stool

September 2020

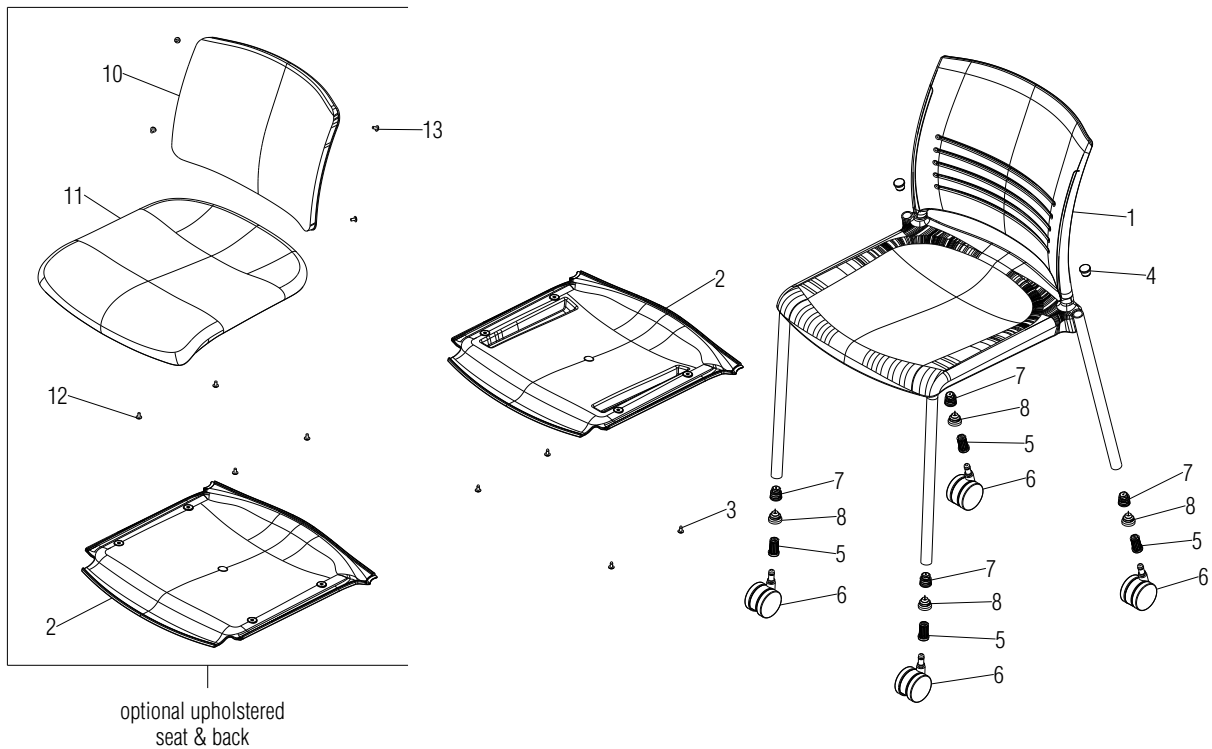

.XX = Select Color

Note: Casters may not be retrofitted to chair frames manufactured with glides.

Item 1 is a replacement chair that includes all parts (seat/back/frame are not servicable).

Items 5 & 6 are for the caster chair model only. Not available on stools.

10.0220.X & 10.0222.X glides use caps that are replaced when worn. Use item 8, caps to replace.

Item 9 glide cap removal tool (not shown) is used to remove old glide caps for replacement on 10.0220.X & 10.0222.X. See KI-RR-000030 for instruction.

Item	Part Number	Item Description	Req Qty	Item	Part Number	Item Description	Req Qty
1	SRFP	Replacement Chair, Poly	1	7	10.0220.X	Glide, Swivel Poly (includes item 9 cap)	4
	SRFU	Replacement Chair, Upholstered Seat	1		10.0190.X	Glide, Steel (used before 9/26/18)	4
	SRFB	Replacement Chair, Upholstered Seat & Back	1		53.6550.XX.X	Glide, Plastic (used before 9/26/18)	4
2	46.2240.BL.X	Shroud, Seat with Bumpers (poly chair)	1		10.0222.X	Glide, Swivel Felt (includes item 9 cap)	4
	46.2228.BL.X	Shroud, Seat (upholstered chair)	1		10.0192.X	Glide, Swivel Steel	4
3	12.0011.X	Screw, M6 x 18mm PPH BosScrew	4	8	10.0221.X	Cap, Swivel Poly Glide (used on 10.0220.X) (see note)	4
4	53.6550.XX.X	Arm Cap, Plastic	2		10.0223.X	Cap, Swivel Felt Glide (used on 10.0222.X) (see note)	4
5	46.5397.BL.X	Assembly, Caster Bushing (caster chair only)	4	9	10.0138.X	Removal Tool, Swivel Glide Cap (not shown) (see note)	4
6	09.0440.XX.X	Caster, 60mm Diameter Carpet (caster chair only)	4	10	STRBC	Assembly, Upholstered Backrest Cushion	1
	09.0441.BL.X	Caster, 60mm Diameter Hard Floor (caster chair only)	4	11	STRRC	Assembly, Upholstered Seat Cushion	1
				12	12.0055.CZ.X	Screw, #10-16 x 1/2" Type AB T/F BLK ZC	4
				13	12.0111.XX.X	Screw, #10-24 x 3/8" PTH M/S ZC x/ PATCH	4

