

Parts Diagram

Strive® Seating

4-Leg Stack Armchair & Cafe Stool

September 2020

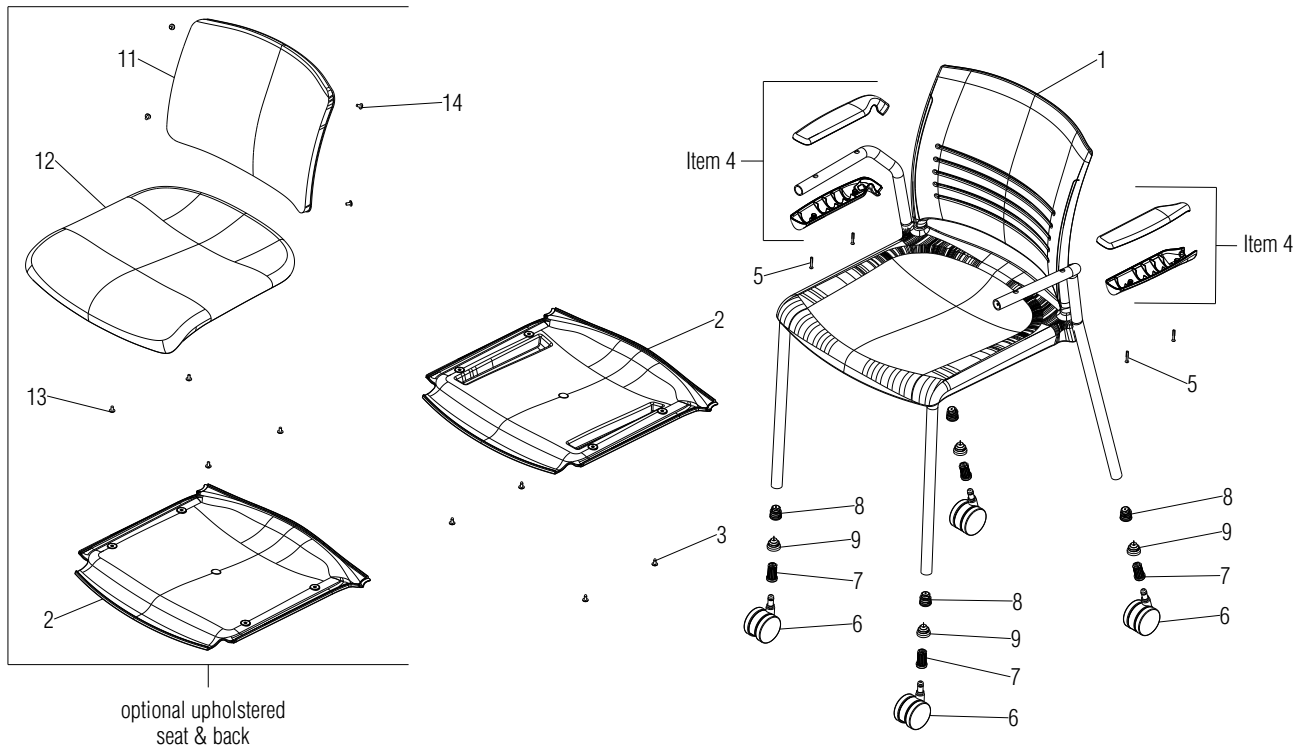

.XX = Select Color

Note: Casters may not be retrofitted to chair frames manufactured with glides.

Item 1 is a replacement chair that includes all parts (seat/back/frame are not servicable).

Items 6 & 7 are for the caster chair model only. Not available on stools.

10.0220.X & 10.0222.X glides use caps that are replaced when worn. Use item 9, caps to replace.

Item 10 glide cap removal tool (not shown) is used to remove old glide caps for replacement on 10.0220.X & 10.0222.X. See KI-RR-000030 for instruction.

Item	Part Number	Item Description	Req Qty	Item	Part Number	Item Description	Req Qty
1	SRFP	Replacement Armchair, Poly	1	8	10.0220.X	Glide, Swivel Poly (includes item 9 cap)	4
	SRFU	Replacement Armchair, Upholstered Seat	1		10.0190.X	Glide, Steel (used before 9/26/18)	4
	SRFB	Replacement Armchair, Upholstered Seat & Back	1		53.6550.XX.X	Glide, Plastic (used before 9/26/18)	4
2	46.2240.BL.X	Shroud, Seat with Bumpers (poly chair)	1		10.0222.X	Glide, Swivel Felt (includes item 9 cap)	4
	46.2228.BL.X	Shroud, Seat (upholstered chair)	1		10.0192.X	Glide, Swivel Steel	4
3	12.0011.X	Screw, M6 x 18mm PPH BosScrew	4	9	10.0221.X	Cap, Swivel Poly Glide (used on 10.0220.X) (see note)	4
4	STV.CA.XX.X	Arm Cap Set, Right & Left Hand	1		10.0223.X	Cap, Swivel Felt Glide (used on 10.0222.X) (see note)	4
5	13.6022.X	Screw, #8 x 7/8" PH OVL HD T-AB T/SCZ	4	10	10.0138.X	Removal Tool, Swivel Glide Cap (not shown) (see note)	1
6	09.0440.XX.X	Caster, 60mm Diameter Carpet (caster chair only)	4	11	STRBC	Assembly, Upholstered Backrest Cushion	1
	09.0441.BL.X	Caster, 60mm Diameter Hard Floor (caster chair only)	4	12	STRRC	Assembly, Upholstered Seat Cushion	1
7	46.5397.BL.X	Assembly, Caster Bushing (caster chair only)	4	13	12.0055.CZ.X	Screw, #10-16 x 1/2" Type AB T/F BLK ZC	4
				14	12.0111.XX.X	Screw, #10-24 x 3/8" PTH M/S ZC w/ PATCH	4

