

Disassembly Instructions

Katera Guest Chair (with or without arms)

Material Type: A. Steel B. Wood C. Foam/Fabric D. Plastic E. Aluminum

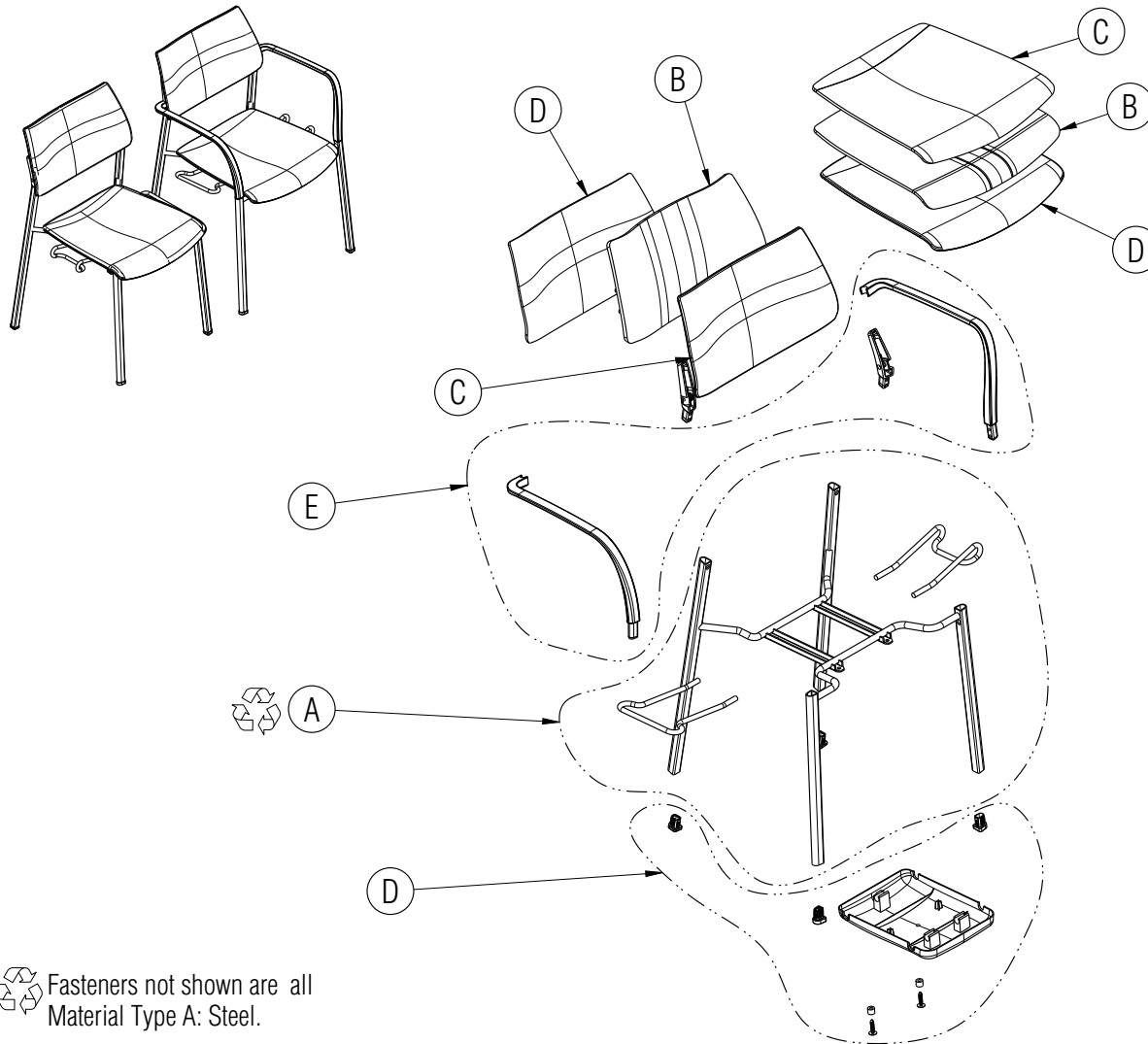

Procedure:

1. Pry off the bottom plastic seat cover with the pry bar.
2. Using the hex driver, remove the backrest from the frame and the aluminum backrest mounting blocks.
3. Remove the seat from the frame using the hex driver.
4. Remove the arms if present, from the frame using the hex driver.
5. If upholstered, cut away the fabric and scrape the foam from the wood seat shell.
6. Pry or pull the glides from the legs.
7. If gangers are present, leave them attached to the steel leg frame.

General Notes:

1. Disassembly time: 15-20 minutes
2. This procedure assumes basic familiarity with hand tools and furniture terminology: no specialized training is required
3. All materials removed and disassembled shall be sorted and segregated with like materials and disposed of or recycled according to recycling availability or waste acceptance
4. For items to be recycled, refer to KI's End of Life Recycling Matrix and KI's End of Life Recovery Options Matrix, available at www.ki.com

Fasteners not shown are all Material Type A: Steel.

Required Tools



Gloves



Safety Glasses

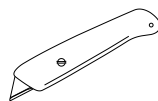

Utility Knife

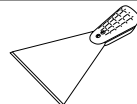

Putty Knife

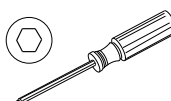

Metric Hex Driver



Pry Bar



Pliers