

Parts Diagram ■

LimeLite™ Seating
High-Density Armless Chair

June 2022

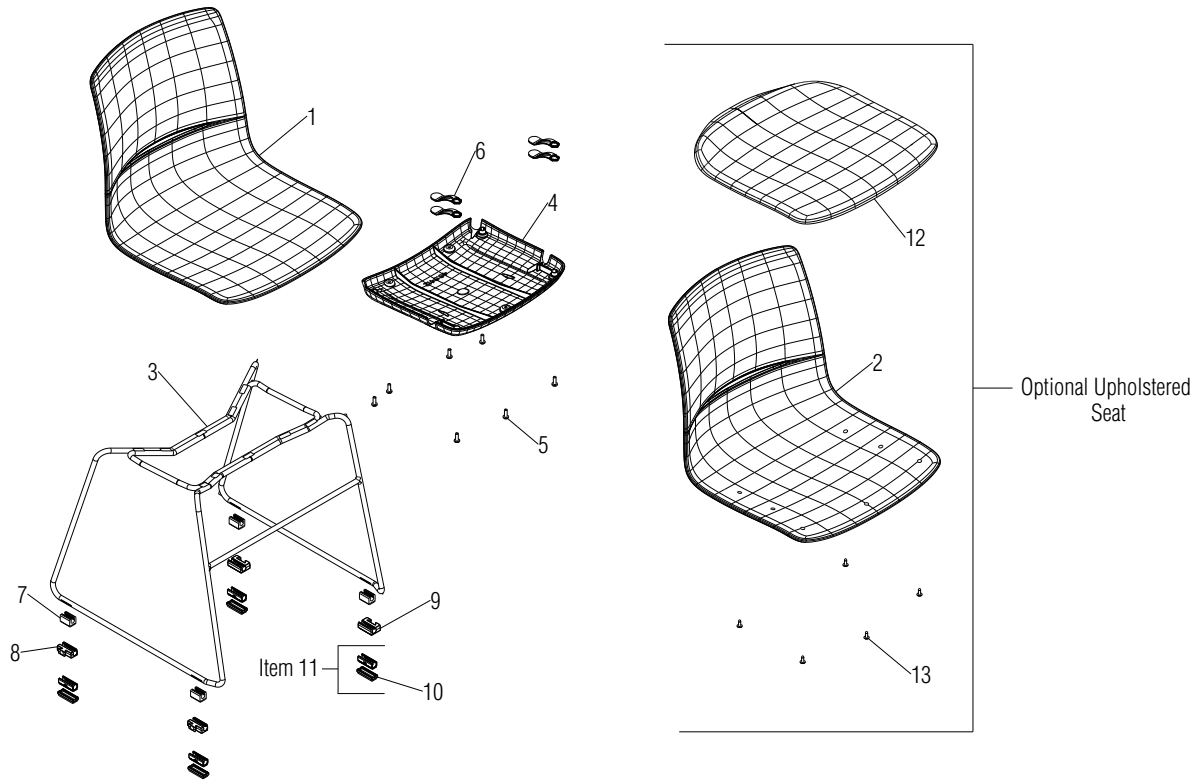

.XX = Select Color

Item 3 includes either Item 7, Items 8 & 9, or item 11.

Item 11 includes Item 10.

Item 14 glide cap removal tool (not shown) is used to remove old glide caps for replacement. See KI-RR-000037 for Item 11 glide or glide cap replacement.

Item	Part Number	Item Description	Req Qty	Item	Part Number	Item Description	Req Qty
1	46.6401.XX.X	Shell, Poly Seat and Back One Piece	1	10	46.4331.X	Glide Cap, Sled Base Snap-Fit Felt	4
2	46.6401.U.XX.X	Shell, Uph. Seat and Poly Back One Piece	1		46.4338.X	Glide Cap, Sled Base Snap-Fit Steel	4
3	LLRF	Weldment, Wire Frame Chair (see note)	1		46.4337.X	Glide Cap, Sled Base Snap-Fit Poly	4
4	46.6412.XX.X	Shroud, Stacking Chairs Under Seat	1		46.4339.X	Glide Cap, Sled Base Snap-Fit Non-Skid	4
5	12.0011.X	Screw, M6 x 18mm Phillips Pan Head BosScrew	7	11	46.4330.X	Assembly, Snap-Fit Felt Glide (see note)	4
6	46.6508.X	Shim, Front Leg Shroud	4		46.4342.X	Assembly, Snap-Fit Steel Glide (see note)	4
7	46.3281.X	Glide, PVC Non-Skid	4		46.4344.X	Assembly, Snap-Fit Poly Glide (see note)	4
8	06.0490.M.X	Glide, Polycarbonate, Male Ganging	2		46.4343.X	Assembly, Snap-Fit Non-Skid Glide (see note)	4
	06.0495.M.X	Glide, Stainless Steel, Male Ganging	2	12	LLRSC	Seat, Upholstered	1
9	06.0490.F.X	Glide, Polycarbonate, Female Ganging	2	13	12.0838.X	Screw, #12-16 x .38" Truss Head	5
	06.0495.F.X	Glide, Stainless Steel, Female Ganging	2	14	10.0138.X	Removal Tool, Glide Cap (not shown) (see note)	1