

KEILHAUER

Juxta Rectangle Table Assembly Guide



Tools Required

Pneumatic
Driver Gun

Hex Bit

Hex Allen Key

Safety Gloves



Juxta Rectangle Assembly Instructions

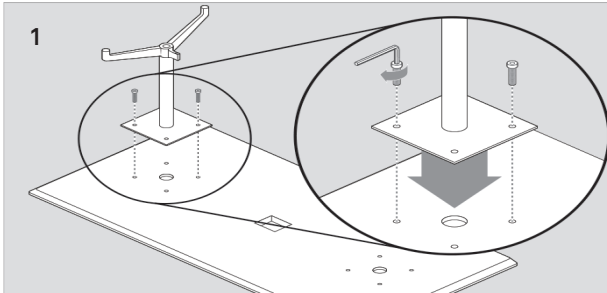

Line up the first base plate with the 4 screw inserts.
Lightly fasten (2) 1/4 - 20 x 5/8\"

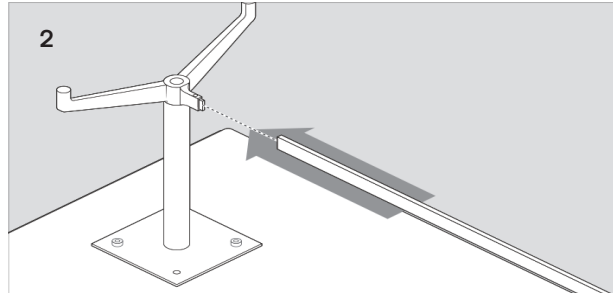

Slide the crossbar extrusion over the base insert, but do not secure.

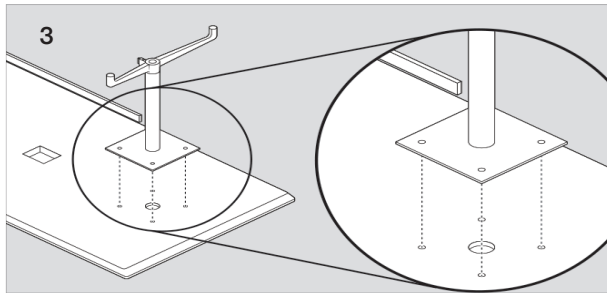

Line up the second base plate with the 4 screw inserts on the underside of the table top.
Lightly fasten (2) 1/4 - 20 x 5/8\"

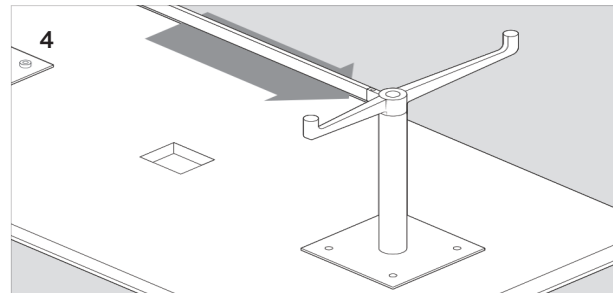

Slide in the cross bar extrusion to the second base to connect the structure, but do not secure.

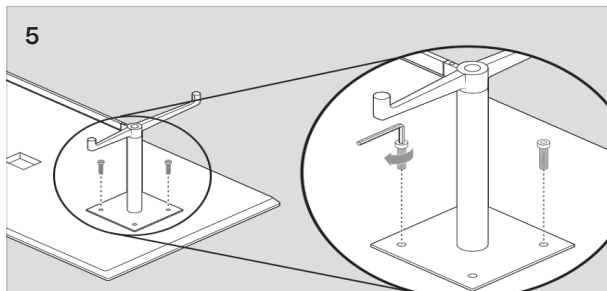

Lightly fasten (2) 1/4 - 20 x 5/8\"

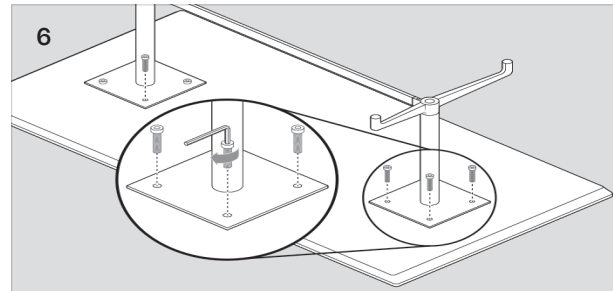

Fasten both base plates to the table top with the remaining (4) 1/4 - 20 x 5/8\"

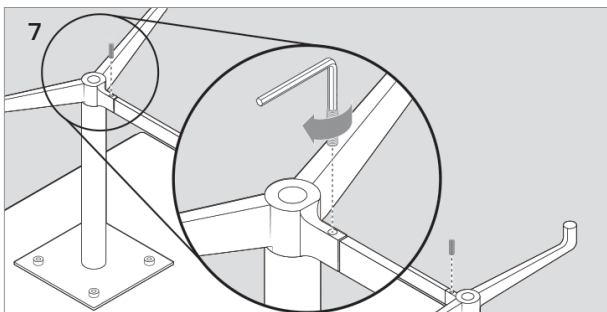

Secure the cross bar extrusion by fastening the (2) 5/16 - 18 x 1\"

Hardware Included

(8) 1/4 - 20 x
5/8" hex socket
cap screws

(8) 1/4 - 20 x
1/2" hex socket
cap screws

(8) 5/16 - 18 x
1" hex socket
head set
screws

(4) 6-18 x 1/4"
pan head
wood screws



Tables with Power

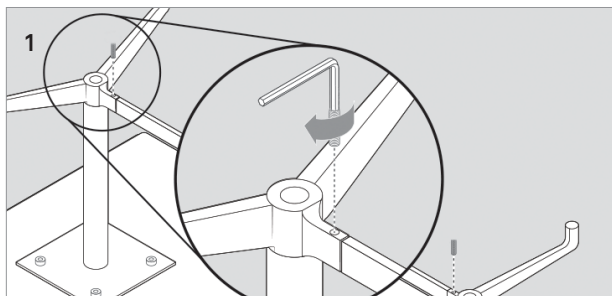

Connect the 2 halves of the base together with the crossbar extrusion using the (2) 5/16 - 18 x 1" set screws, but do not fasten the base to the top.

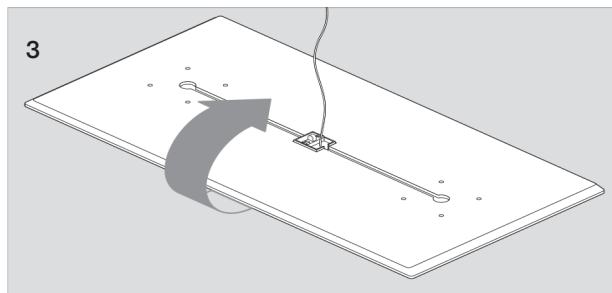

Place the table top face down on a soft surface.

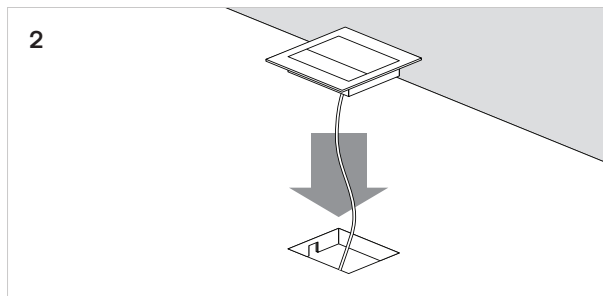

Feed the power cord through the center of the table top and fit the power box into the cut out.

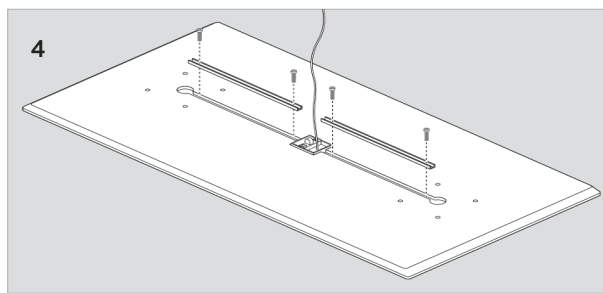

Fasten the 2 plastic cord management pieces into the corresponding channels using 4 wood screws.

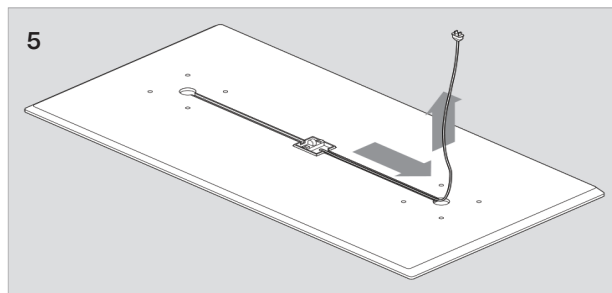

Depending on the location of the power source, run the power cord through the appropriate channel of the plastic cord management piece.

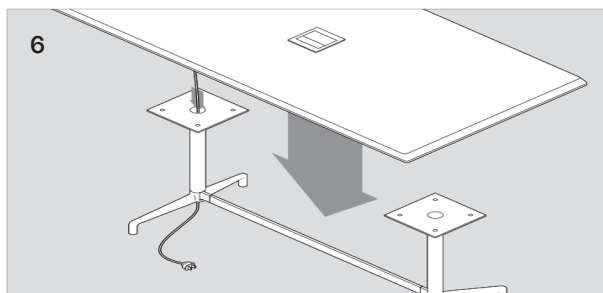

Before the connected base is fastened to the table top, feed the cord through the leg and out the bottom of the base.

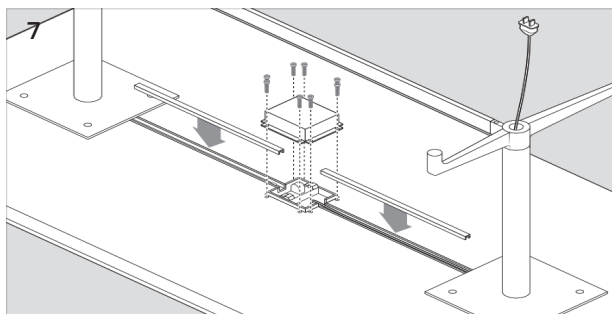

To hide the power box and cord, screw the power enclosure over the power box using the (8) 1/4 - 20 x 1/2" screws, and clip the smaller plastic cord management piece over the cord into the channel.

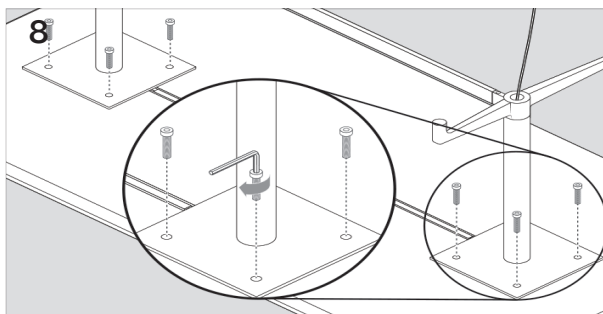

Ensure the base plates are lined up properly to the holes on the underside of the table and use the (8) 1/4 - 20 x 5/8" screws to secure the base to the top.

Juxta Designed by EOOS

keilhauer.com

1450 Birchmount Road
Toronto, Ontario, Canada
M1P 2E3

T 416 759 5665

F 416 759 5723

1 800 724 5665

