

TAILOR Lounge Collection - MODULAR



PRODUCT CODE

91 01 MC - NA

Series

91 : Tailor

Number of Seats

1 : Single Seat
 2 : Two Seat
 3 : Three Seat

Type

MC : Mid-Back Connected
 MIC : Mid-Back, Inside Curve, Connected
 MOC : Mid-Back, Outside Curve, Connected
 MBC : Bench, Connected

Arms

na : No Arm
 L : Left Arm
 R : Right Arm

OPTIONS

ARM GAP



ARM CAP



TABLET ARM



POWER



In table



In seat

FINISHES

FRAME



Select from one of our 76 standard Spectone colors

FABRIC

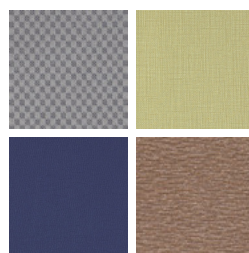

Select fabrics from one of our textile partners

LAMINATE

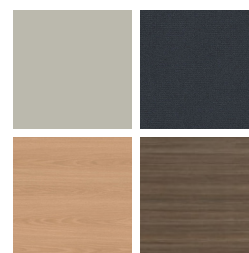

Select from 15 standard laminates or choose any standard Wilsonart, Nevamar, Formica, Arborite and Pionite matte finish laminates for no extra charge

EDGE

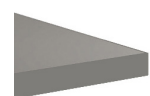

SE

ARM CAPS



Polyurethane

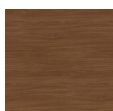

Wood*

*Wood arms are available in 9 standard stains or stain-to-match for no extra charge.

TAILOR Lounge Collection - MODULAR

HOW TO ORDER

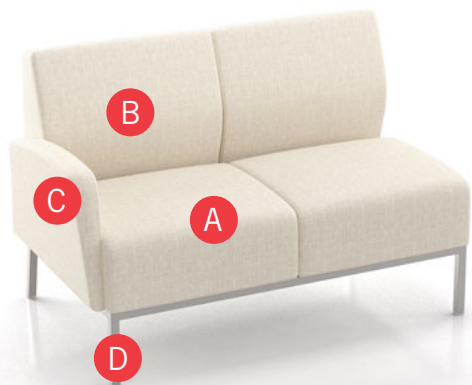

Specify Model

- A** Specify Fabric - Seat¹
Manufacturer, Pattern Name, Color
- B** Specify Fabric - Back¹
Manufacturer, Pattern Name, Color
- C** Specify Fabric - Arms¹
Manufacturer, Pattern Name, Color
- D** Specify Frame Finish

Optional: CAL 133, Moisture Barrier, 1" Gap Between Seat and Arm, Arm Caps, Tablet Arm, Sled Base, *Connecting and Freestanding Tables, Power

Restrictions may apply. See price list tables below for more information.

¹ When multiple fabrics are specified on two and three seat chairs, please provide a drawing and legend for fabric placement.

*Except Corner seat.

Model	Fabric - Seat 1	Fabric - Seat 2	Fabric - Back 1	Fabric - Back 2	Fabric - Arm 1	Frame Finish
9102MC-L	Momentum, Beeline, Canvas	Momentum, Beeline, Canvas	Momentum, Beeline, Canvas	Momentum, Beeline, Canvas	Momentum, Beeline, Canvas	Silver

TAILOR Lounge Collection - MODULAR

LAYOUTS

To configure Tailor Modular, please specify left to right facing the configuration.

Tailor has two arm styles - end arms which are tapered, and connecting arms which are straight. Please provide a layout drawing with your purchase order or quote request and Customer Service will determine the appropriate arm (end or connecting) depending on their position within the layout. Arms are shipped assembled on the chair.



Tapered End Arm



Straight Connecting Arm



- A** Choose from one-, two-, three-seat and bariatric modular designs.

Note: Single seat configuration is shown in the example below.

- B** Tapered End Arms are installed at the ends of the layout run.

Note: Exceptions apply, see next page for more information.

- C** When arms are specified between seats or seat-to-table, a Straight Connecting Arm will be used.

- D** To complete your configuration, choose from end of run, spacer or corner connecting tables.

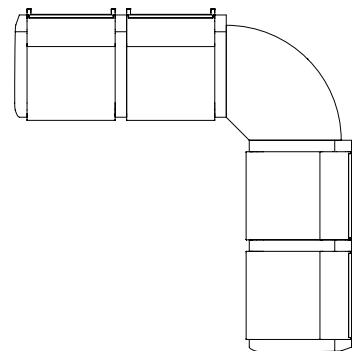
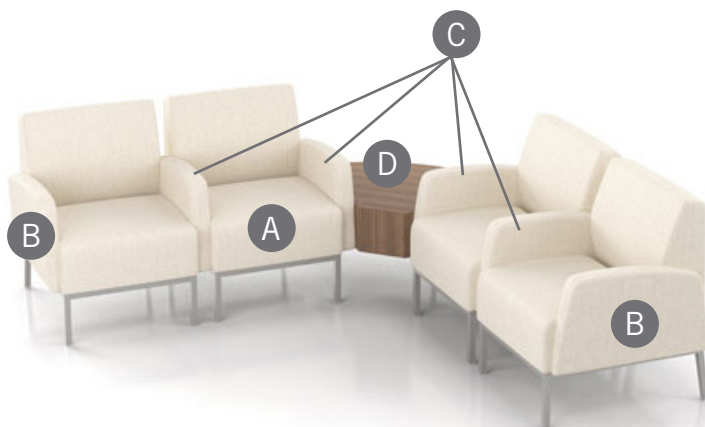

The configuration above can be specified as:

9101MC	Single Seat, Two Arms (one Tapered End, one Straight Connecting)
9101MC-R	Single Seat, With Right Arm Only (Straight Connecting)
91RC	Corner Table - Radius Corner
9101MC	Single Seat, Two Arms (two Straight Connecting)
9101MC-R	Single Seat, With Right Arm Only (Tapered End)

TAILOR Lounge Collection - MODULAR

TAPERED END ARMS ON BOTH ENDS

Configurations with **arms on both ends** will have Tapered End Arms as standard.



Configuration above shows Tapered End Arms on outside of chairs, Straight Connecting Arms in center. Regardless of its complexity, when a configuration is ending in arms on both ends, the configuration will be specified with a Tapered End Arm as standard.

- A Tapered End Arm
- B Straight Connecting Arm

STRAIGHT CONNECTING ARM ON ONE END

Configurations with an **arm on one end** will have Straight Connecting Arm as standard.



Configuration above is ending in a table on one end, and an arm on the other end of the run. Regardless of its complexity, when a configuration is ending in one arm only, the configuration will be specified with a Straight Connecting Arm as standard. Customers may specify Tapered End Arm at the end of such run, but a special note must be given to Customer Service at the time of quote/order. Note that the arm beside the table will always be a Straight Connecting Arm.

TAILOR Lounge Collection - MODULAR

FOUR SEAT DESIGN, EXAMPLE 1

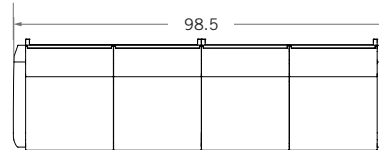
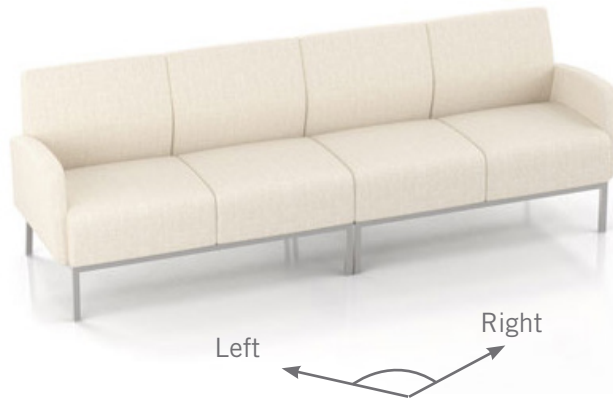

A four-seat configuration may be specified as two two-seat sofas.

9102MC-L Two Seat, With Left Arm Only
(Tapered End)

9102MC-R Two Seat, With Right Arm Only
(Tapered End)

FOUR SEAT DESIGN, EXAMPLE 2

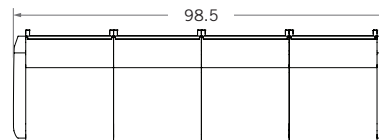

A four-seat configuration may also be specified as four single seat chairs. Please note that the number of legs in this case is double than in the example above.

Note: Specifying with single seats allows for higher flexibility, but this also increases the number of legs.

9101MC-L Single Seat, With Left Arm Only
(Tapered End)

9101MC-NA Single Seat, Without Arms

9101MC-NA Single Seat, Without Arms

9101MC-R Single Seat, With Right Arm Only
(Tapered End)

FOUR SEAT DESIGN, EXAMPLE 3

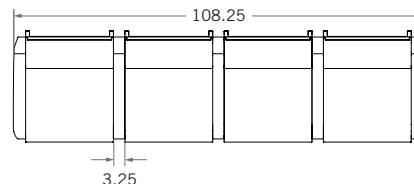

Arms may be added between each seat, increasing the gap between each chair base, as well as the overall width of the configuration.

9101MC Single Seat, Two Arms
(one Tapered End, one Straight Connecting)

9101MC-R Single Seat, With Right Arm Only
(Straight Connecting)

9101MC-R Single Seat, With Right Arm Only
(Straight Connecting)

9101MC-R Single Seat, With Right Arm Only
(Tapered End)

TAILOR Lounge Collection - MODULAR

END TABLE ON BOTH ENDS, EXAMPLE

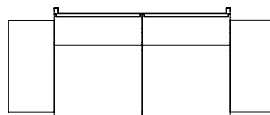
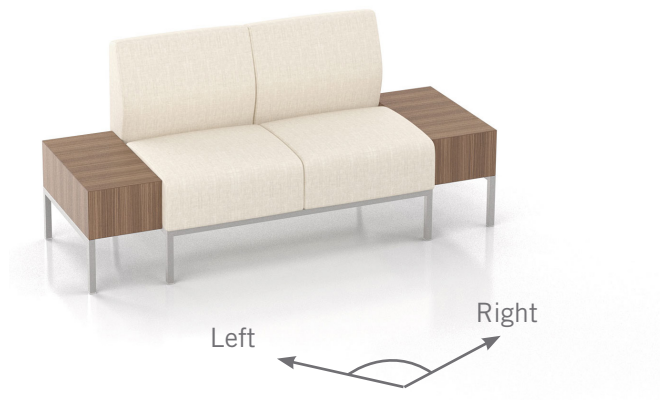

91ERC - 24 x 12

9102MC-NA

91ERC - 24 x 12

End of Run Table Closed - Half Size

Two Seat, Without Arms

End of Run Table Closed - Half Size

SPACER TABLE BETWEEN SEATS, EXAMPLE

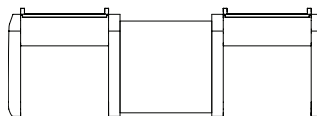
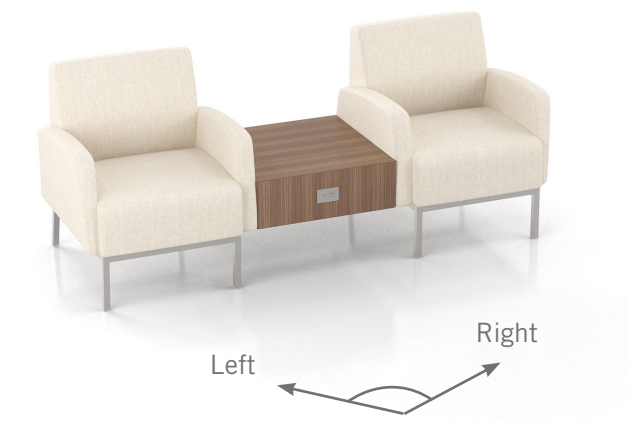

9101MC

91STC - 24 x 24

COV-1U-S

9101MC

Single Seat, Two Arms

(one Tapered End, one Straight Connecting)

Spacer Table Closed - Full Size

Cove, 1 power, 2USB, Silver

Single Seat, Two Arms

(one Straight Connecting, one Tapered End)

TAILOR Lounge Collection - MODULAR

Standard Features

- Separate seat and back
- Meets seating durability test to 500 lbs per chair
- Standard without a wall-saving frame, optional wall-saving frame available (to be specified on order)
- Clear, non-marring glides
- One connecting plate per unit
- Ships assembled, 1/carton 24 cu ft

For fabrics you wish railroaded or repeats larger than 5" x 5", please contact the factory with repeat information, and yardage requirement will be provided.

To ensure proper configuration please provide a layout drawing.



Tapered End Arm

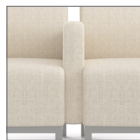

Straight Connecting Arm



Power (Optional)

Options

- Polyurethane arm caps available in Black (B), Taupe RAL 7006 (T) or Sterling Grey (G), add **\$140** List per arm
- For wood arm caps, select from 9 standard stains, or stain-to-match for no extra charge, add **\$165** List per arm
- 1" gap between seat and arm available at **\$57** List per arm
- Swivel tablet arm (TA), add **\$650** List each. Cannot be installed between seats. Choose 12"x12" Square (SQ) or 16-1/2"x 11-1/2" Oval (OVAL). Height above floor is 27-1/2"
- Sled base (non wall-saving), add **\$120** List
- Upholstered arms/seat/back can match or contrast
- Cove Mini power module centered in the seat front is available in Black, Silver and White. Add **\$508** List per seat per module
- Antibacterial and antimicrobial fabrics available
- Connecting and freestanding tables available
- CAL 133 for 9101MC-NA, add **\$265** List per unit. CAL 133 for 9101MC, add **\$408** List per unit.

Single Seat, Without Arms

COM 2.75 yds

1.25 yds COM per single seat

1.5 yds COM per single back

MODEL	COM	GR 1	GR 2	GR 3	GR 4	GR 5	GR 6
9101MC-NA	1219	1405	1464	1593	1783	1933	2124

Dimensions (inches)

seat H	18.0	seat W	23.0		
total H	33.0	total W	23.0	depth	29.0



9101MC-NA
47 lbs

Single Seat, Two Arms

COM 4.25 yds

1.25 yds COM per single seat

1.5 yds COM per single back

0.75 yds COM per arm

MODEL	COM	GR 1	GR 2	GR 3	GR 4	GR 5	GR 6
9101MC	1860	2152	2246	2447	2744	2973	3272

Dimensions (inches)

seat H	18.0	seat W	23.0	arm H	24.5
total H	33.0	total W	29.5	depth	29.0



9101MC
71 lbs

TAILOR Lounge Collection - MODULAR

Standard Features

- Separate seat and back
- Meets seating durability test to 500 lbs per chair
- Standard without a wall-saving frame, optional wall-saving frame available (to be specified on order)
- Clear, non-marring glides
- One connecting plate per unit
- Ships assembled, 1/carton 24 cu ft

For fabrics you wish railroaded or repeats larger than 5" x 5", please contact the factory with repeat information, and yardage requirement will be provided.

To ensure proper configuration please provide a layout drawing.



Tapered End Arm



Straight Connecting Arm



Power (Optional)

Options

- Polyurethane arm caps available in Black (B), Taupe RAL 7006 (T) or Sterling Grey (G), add **\$140** List per arm
- For wood arm caps, select from 9 standard stains, or stain-to-match for no extra charge, add **\$165** List per arm
- 1" gap between seat and arm available at **\$57** List per arm
- Swivel tablet arm (TA), add **\$650** List each. Cannot be installed between seats. Choose 12"x12" Square (SQ) or 16-1/2"x 11-1/2" Oval (OVAL). Height above floor is 27-1/2"
- Sled base (non wall-saving), add **\$120** List
- Upholstered arms/seat/back can match or contrast
- Cove Mini power module centered in the seat front is available in Black, Silver and White. Add **\$508** List per seat per module
- Antibacterial and antimicrobial fabrics available
- Connecting and freestanding tables available
- CAL 133, add **\$337** List per unit

Single Seat, With Right Arm Only

COM 3.5 yds

1.25 yds COM per single seat

1.5 yds COM per single back

0.75 yds COM per arm

MODEL	COM	GR 1	GR 2	GR 3	GR 4	GR 5	GR 6
9101MC-R	1540	1778	1855	2022	2264	2451	2699

Dimensions (inches)

seat H	18.0	seat W	23.0	arm H	24.5
total H	33.0	total W	26.25	depth	29.0



9101MC-R
59 lbs

Single Seat, With Left Arm Only

COM 3.5 yds

1.25 yds COM per single seat

1.5 yds COM per single back

0.75 yds COM per arm

MODEL	COM	GR 1	GR 2	GR 3	GR 4	GR 5	GR 6
9101MC-L	1540	1778	1855	2022	2264	2451	2699

Dimensions (inches)

seat H	18.0	seat W	23.0	arm H	24.5
total H	33.0	total W	26.25	depth	29.0



9101MC-L
59 lbs

TAILOR Lounge Collection - MODULAR

Standard Features

- Separate seat and back
- Meets seating durability test to 500 lbs per chair
- Standard without a wall-saving frame
- Clear, non-marring glides
- One connecting plate per unit
- Ships assembled, 1/carton 24 cu ft

For fabrics you wish railroaded or repeats larger than 5" x 5", please contact the factory with repeat information, and yardage requirement will be provided.

To ensure proper configuration please provide a layout drawing.

Options

- Upholstered seat/back can match or contrast
- Antibacterial and antimicrobial fabrics available
- Connecting and freestanding tables available
- CAL 133, add \$ 423 List per unit



Single Seat, Corner Unit, Armless

COM 4.15 yds

1.75 yds COM per single seat

2.4 yds COM per single back

MODEL	COM	GR 1	GR 2	GR 3	GR 4	GR 5	GR 6
9101MCCRNR	2873	3114	3189	3351	3591	3778	4015

Dimensions (inches)

seat H	18.0	seat W	19.75		
total H	33.0	total W	27.5	depth	27.5



9101MCCRNR
65 lbs

TAILOR Lounge Collection - MODULAR

Standard Features

- Separate seat and back
- Meets seating durability test to 750 lbs per chair
- Standard without a wall-saving frame, optional wall-saving frame available (to be specified on order)
- Clear, non-marring glides
- One connecting plate per unit
- Ships assembled, 1/carton 32 cu ft

For fabrics you wish railroaded or repeats larger than 5" x 5", please contact the factory with repeat information, and yardage requirement will be provided.

To ensure proper configuration please provide a layout drawing.



Tapered End Arm



Straight Connecting Arm



Power (Optional)

Options

- Polyurethane arm caps available in Black (B), Taupe RAL 7006 (T) or Sterling Grey (G), add **\$140** List per arm
- For wood arm caps, select from 9 standard stains, or stain-to-match for no extra charge, add **\$165** List per arm
- 1" gap between seat and arm available at **\$57** List per arm
- Swivel tablet arm (TA), add **\$650** List each. Cannot be installed between seats. Choose 12"x12" Square (SQ) or 16-1/2"x 11-1/2" Oval (OVAL). Height above floor is 27-1/2"
- Sled base (non wall-saving), add **\$120** List
- Upholstered arms/seat/back can match or contrast
- Cove Mini power module centered in the seat front is available in Black, Silver and White. Add **\$508** List per seat per module
- Antibacterial and antimicrobial fabrics available
- Connecting and freestanding tables available
- CAL 133, add **\$483** List per unit.

Bariatric Single Seat, Two Arms

COM 5 yds

1.5 yds COM per single seat

2 yds COM per single back

0.75 yds COM per arm

MODEL	COM	GR 1	GR 2	GR 3	GR 4	GR 5	GR 6
9101GC	2031	2353	2469	2709	3062	3334	3693

Dimensions (inches)

seat H	18.0	seat W	30.0	arm H	24.5
total H	33.0	total W	36.5	depth	29.0



9101GC
75 lbs

TAILOR Lounge Collection - MODULAR

Standard Features

- Separate seat and back
- Meets seating durability test to 570 lbs per chair
- Standard without a wall-saving frame, optional wall-saving frame available (to be specified on order)
- Clear, non-marring glides
- One connecting plate per unit
- Ships assembled, 1/carton 43 cu ft

For fabrics you wish railroaded or repeats larger than 5" x 5", please contact the factory with repeat information, and yardage requirement will be provided.

To ensure proper configuration please provide a layout drawing.

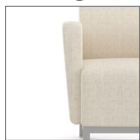

Tapered End Arm

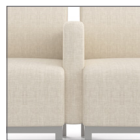

Straight Connecting Arm



Power (Optional)

Options

- Polyurethane arm caps available in Black (B), Taupe RAL 7006 (T) or Sterling Grey (G), add **\$140** List per arm
- For wood arm caps, select from 9 standard stains, or stain-to-match for no extra charge, add **\$165** List per arm
- 1" gap between seat and arm available at **\$57** List per arm
- Swivel tablet arm (TA), add **\$650** List each. Cannot be installed between seats. Choose 12"x12" Square (SQ) or 16-1/2"x 11-1/2" Oval (OVAL). Height above floor is 27-1/2"
- Sled base (non wall-saving), add **\$120** List
- Upholstered arms/seat/back can match or contrast
- Cove Mini power module centered in the seat front is available in Black, Silver and White. Add **\$508** List per seat per module
- Antibacterial and antimicrobial fabrics available
- Connecting and freestanding tables available
- CAL 133 for 9102MC-NA, add **\$530** List per unit. CAL 133 for 9102MC, add **\$674** List per unit.

Two Seat, Without Arms

COM 5.5 yds

1.25 yds COM per single seat

1.5 yds COM per single back

MODEL	COM	GR 1	GR 2	GR 3	GR 4	GR 5	GR 6
9102MC-NA	2117	2490	2613	2870	3251	3542	3930

Dimensions (inches)

seat H	18.0	seat W	23.0				
total H	33.0	total W	46.0	depth	29.0		



9102MC-NA
100 lbs

Two Seat, With Two Arms

COM 7 yds

1.25 yds COM per single seat

1.5 yds COM per single back

0.75 yds COM per arm

MODEL	COM	GR 1	GR 2	GR 3	GR 4	GR 5	GR 6
9102MC	2759	3237	3394	3723	4210	4582	5078

Dimensions (inches)

seat H	18.0	seat W	23.0	arm H	24.5		
total H	33.0	total W	52.5	depth	29.0		



9102MC
124 lbs

TAILOR Lounge Collection - MODULAR

Standard Features

- Separate seat and back
- Meets seating durability test to 570 lbs per chair
- Standard without a wall-saving frame, optional wall-saving frame available (to be specified on order)
- Clear, non-marring glides
- One connecting plate per unit
- Ships assembled, 1/carton 43 cu ft

For fabrics you wish railroaded or repeats larger than 5" x 5", please contact the factory with repeat information, and yardage requirement will be provided.

To ensure proper configuration please provide a layout drawing.



Tapered End Arm



Straight Connecting Arm



Power (Optional)

Options

- Polyurethane arm caps available in Black (B), Taupe RAL 7006 (T) or Sterling Grey (G), add **\$140** List per arm
- For wood arm caps, select from 9 standard stains, or stain-to-match for no extra charge, add **\$165** List per arm
- 1" gap between seat and arm available at **\$57** List per arm
- Swivel tablet arm (TA), add **\$650** List each. Cannot be installed between seats. Choose 12"x12" Square (SQ) or 16-1/2"x 11-1/2" Oval (OVAL). Height above floor is 27-1/2"
- Sled base (non wall-saving), add **\$120** List
- Upholstered arms/seat/back can match or contrast
- Cove Mini power module centered in the seat front is available in Black, Silver and White. Add **\$508** List per seat per module
- Antibacterial and antimicrobial fabrics available
- Connecting and freestanding tables available
- CAL 133, add **\$604** List per unit

Two Seat, With Right Arm Only

COM 6.25 yds
1.25 yds COM per single seat
1.5 yds COM per single back
0.75 yds COM per arm

MODEL	COM	GR 1	GR 2	GR 3	GR 4	GR 5	GR 6
9102MC-R	2440	2863	3002	3297	3729	4064	4505

Dimensions (inches)

seat H	18.0	seat W	23.0	arm H	24.5
total H	33.0	total W	49.25	depth	29.0



9102MC-R
112 lbs

Two Seat, With Left Arm Only

COM 6.25 yds
1.25 yds COM per single seat
1.5 yds COM per single back
0.75 yds COM per arm

MODEL	COM	GR 1	GR 2	GR 3	GR 4	GR 5	GR 6
9102MC-L	2440	2863	3002	3297	3729	4064	4505

Dimensions (inches)

seat H	18.0	seat W	23.0	arm H	24.5
total H	33.0	total W	49.25	depth	29.0



9102MC-L
112 lbs

TAILOR Lounge Collection - MODULAR

Standard Features

- Separate seat and back
- Meets seating durability test to 750 lbs per chair
- Standard without a wall-saving frame, optional wall-saving frame available (to be specified on order)
- Clear, non-marring glides
- One connecting plate per unit
- Ships assembled, 1/carton 62 cu ft

For fabrics you wish railroaded or repeats larger than 5" x 5", please contact the factory with repeat information, and yardage requirement will be provided.

To ensure proper configuration please provide a layout drawing.



Tapered End Arm



Straight Connecting Arm



Power (Optional)

Options

- Polyurethane arm caps available in Black (B), Taupe RAL 7006 (T) or Sterling Grey (G), add **\$140** List per arm
- For wood arm caps, select from 9 standard stains, or stain-to-match for no extra charge, add **\$165** List per arm
- 1" gap between seat and arm available at **\$57** List per arm
- Swivel tablet arm (TA), add **\$650** List each. Cannot be installed between seats. Choose 12"x12" Square (SQ) or 16-1/2"x 11-1/2" Oval (OVAL). Height above floor is 27-1/2"
- Sled base (non wall-saving), add **\$120** List
- Upholstered arms/seat/back can match or contrast
- Cove Mini power module centered in the seat front is available in Black, Silver and White. Add **\$508** List per seat per module
- Antibacterial and antimicrobial fabrics available
- Connecting and freestanding tables available
- CAL 133 for 9103MC-NA, add **\$795** List per unit. CAL 133 for 9103MC, add **\$942** List per unit

Three Seat, Without Arms

COM 8.25 yds

1.25 yds COM per single seat

1.5 yds COM per single back

MODEL	COM	GR 1	GR 2	GR 3	GR 4	GR 5	GR 6
9103MC-NA	3019	3576	3759	4146	4715	5155	5735

Dimensions (inches)

seat H	18.0	seat W	23.0		
total H	33.0	total W	69.0	depth	29.0



9103MC-NA
149 lbs

Three Seat, With Two Arms

COM 9.75 yds

1.25 yds COM per single seat

1.5 yds COM per single back

0.75 yds COM per arm

MODEL	COM	GR 1	GR 2	GR 3	GR 4	GR 5	GR 6
9103MC	3659	4322	4540	4999	5675	6196	6884

Dimensions (inches)

seat H	18.0	seat W	23.0	arm H	24.5
total H	33.0	total W	75.5	depth	29.0



9103MC
173 lbs

TAILOR Lounge Collection - MODULAR

Standard Features

- Separate seat and back
- Meets seating durability test to 750 lbs per chair
- Standard without a wall-saving frame, optional wall-saving frame available (to be specified on order)
- Clear, non-marring glides
- One connecting plate per unit
- Ships assembled, 1/carton 62 cu ft

For fabrics you wish railroaded or repeats larger than 5" x 5", please contact the factory with repeat information, and yardage requirement will be provided.

To ensure proper configuration please provide a layout drawing.

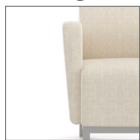

Tapered End Arm

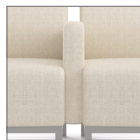

Straight Connecting Arm



Power (Optional)

Options

- Polyurethane arm caps available in Black (B), Taupe RAL 7006 (T) or Sterling Grey (G), add **\$140** List per arm
- For wood arm caps, select from 9 standard stains, or stain-to-match for no extra charge, add **\$165** List per arm
- 1" gap between seat and arm available at **\$57** List per arm
- Swivel tablet arm (TA), add **\$650** List each. Cannot be installed between seats. Choose 12"x12" Square (SQ) or 16-1/2"x 11-1/2" Oval (OVAL). Height above floor is 27-1/2"
- Sled base (non wall-saving), add **\$120** List
- Upholstered arms/seat/back can match or contrast
- Cove Mini power module centered in the seat front is available in Black, Silver and White. Add **\$508** List per seat per module
- Antibacterial and antimicrobial fabrics available
- Connecting and freestanding tables available
- CAL 133, add **\$867** List per unit

Three Seat, With Right Arm Only

COM 9 yds

1.25 yds COM per single seat

1.5 yds COM per single back

0.75 yds COM per arm

MODEL	COM	GR 1	GR 2	GR 3	GR 4	GR 5	GR 6
9103MC-R	3338	3950	4152	4573	5196	5674	6308

Dimensions (inches)

seat H	18.0	seat W	23.0	arm H	24.5
total H	33.0	total W	72.25	depth	29.0



9103MC-R
161 lbs

Three Seat, With Left Arm Only

COM 9 yds

1.25 yds COM per single seat

1.5 yds COM per single back

0.75 yds COM per arm

MODEL	COM	GR 1	GR 2	GR 3	GR 4	GR 5	GR 6
9103MC-L	3338	3950	4152	4573	5196	5674	6308

Dimensions (inches)

seat H	18.0	seat W	23.0	arm H	24.5
total H	33.0	total W	72.25	depth	29.0



9103MC-L
161 lbs

TAILOR Lounge Collection - MODULAR - SERPENTINE

HOW TO ORDER

Specify Model

- A** Specify Fabric - Seat
Manufacturer, Pattern Name, Color
- B** Specify Fabric - Back
Manufacturer, Pattern Name, Color
- C** Specify Frame Finish

Optional: CAL 133, Moisture Barrier, Arms, Tablet Arm, Sled Base, Connecting and Freestanding Tables

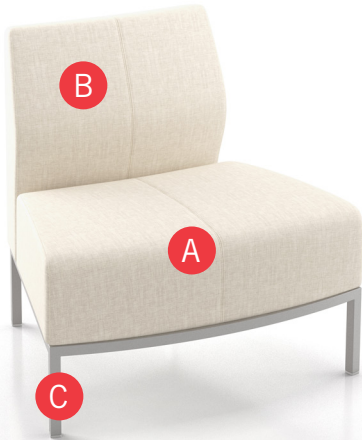

Model	Fabric - Seat 1	Fabric - Back 1	Frame Finish
9101MOC	Momentum, Beeline, Canvas	Momentum, Beeline, Canvas	Silver

SEAMS

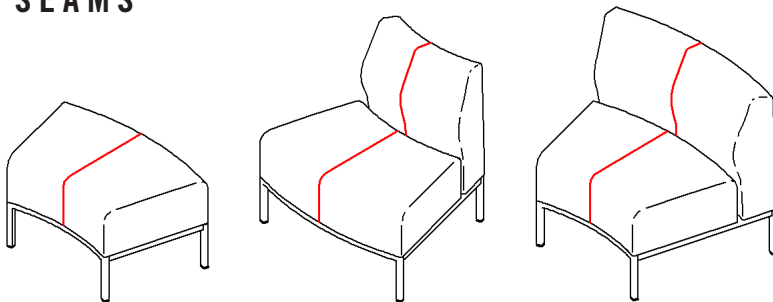

Please note that all Tailor Serpentine models feature a centered vertical seam (red line). If patterned fabric is being used, the patterns may not line up along the seams or between chairs.

30 DEGREE ANGLE



Bench

Chair, Inside Curve

Chair, Outside Curve

All Tailor Serpentine models are designed at a 30° angle. To create a 90° corner, use three units of the same orientation (i.e., inside curve or outside curve). The bench, depending on how it's specified, can be used as either inside curve or outside curve unit.

TAILOR Lounge Collection - MODULAR - SERPENTINE

Standard Features

- 30° angle
- Separate seat and back
- Meets seating durability test to 500 lbs per chair
- Non wall-saving frame
- **NOTE:** If ordering with other Tailor Modular designs, specify all connected seating within the configuration as non wall-saving.
- Clear, non-marring glides
- One connecting plate per unit
- Ships assembled, 1/carton 24 cu ft

For fabrics you wish railroaded or repeats larger than 5" x 5", please contact the factory with repeat information, and yardage requirement will be provided.

To ensure proper configuration please provide a layout drawing.

Options

- Tapered or Straight connecting arm
- Polyurethane arm caps available in Black (B), Taupe RAL 7006 (T) or Sterling Grey (G), add **\$140** List per arm
- For wood arm caps, select from 9 standard stains, or stain-to-match for no extra charge, add **\$165** List per arm
- 1" gap between seat and arm available at **\$57** List per arm
- Swivel tablet arm (TA), add **\$650** List each. Cannot be installed between seats. Choose 12"x12" Square (SQ) or 16-1/2"x 11-1/2" Oval (OVAL). Height above floor is 27-1/2"
- Sled base (non wall-saving), add **\$120** List
- Upholstered arms/seat/back can match or contrast
- Antibacterial and antimicrobial fabrics available
- Connecting and freestanding tables available
- CAL 133 for 9101MIC-NA, add **\$312** List per unit. CAL 133 for 9101MIC, add **\$457** List per unit



Tapered End Arm



Straight Connecting Arm



Non Wall-saving Frame

Tailor Serpentine, Inside Curve, Without Arms

COM 3.25 yds

1.5 yds COM per single seat

1.75 yds COM per single back

MODEL	COM	GR 1	GR 2	GR 3	GR 4	GR 5	GR 6
9101MIC-NA	2144	2376	2452	2607	2844	3019	3256

Dimensions (inches)

seat H	18.0	seat W	22.0/33.0				
total H	33.0	total W	37.0	depth	29.5		



9101MIC-NA
54 lbs

Tailor Serpentine, Inside Curve, Two Arms

COM 4.75 yds

1.5 yds COM per single seat

1.75 yds COM per single back

0.75 yds COM per arm

MODEL	COM	GR 1	GR 2	GR 3	GR 4	GR 5	GR 6
9101MIC	2773	3120	3235	3470	3822	4085	4445

Dimensions (inches)

seat H	18.0	seat W	22.0/33.0				
total H	33.0	total W	43.5	depth	29.5		



9101MIC
78 lbs

TAILOR Lounge Collection - MODULAR - SERPENTINE

Standard Features

- 30° angle
- Separate seat and back
- Meets seating durability test to 500 lbs per chair
- Non wall-saving frame
- **NOTE:** If ordering with other Tailor Modular designs, specify all connected seating within the configuration as non wall-saving
- Clear, non-marring glides
- One connecting plate per unit
- Ships assembled, 1/carton 24 cu ft

For fabrics you wish railroaded or repeats larger than 5" x 5", please contact the factory with repeat information, and yardage requirement will be provided.

To ensure proper configuration please provide a layout drawing.

Options

- Tapered or straight connecting arm
- Polyurethane arm caps available in Black (B), Taupe RAL 7006 (T) or Sterling Grey (G), add **\$140** List per arm
- For wood arm caps, select from 9 standard stains, or stain-to-match for no extra charge, add **\$165** List per arm
- 1" gap between seat and arm available at **\$57** List per arm
- Swivel tablet arm (TA), add **\$650** List each. Cannot be installed between seats. Choose 12"x12" Square (SQ) or 16-1/2"x 11-1/2" Oval (OVAL). Height above floor is 27-1/2"
- Sled base (non wall-saving), add **\$120** List
- Upholstered arms/seat/back can match or contrast
- Antibacterial and antimicrobial fabrics available
- Connecting and freestanding tables available
- CAL 133, add **\$384** List per unit



Tapered End Arm



Straight Connecting Arm



Non Wall-saving Frame

Tailor Serpentine, Inside Curve, With Right Arm Only

COM 4.0 yds

1.5 yds COM per single seat

1.75 yds COM per single back

0.75 yds COM per arm

MODEL	COM	GR 1	GR 2	GR 3	GR 4	GR 5	GR 6
9101MIC-R	2460	2748	2844	3038	3334	3553	3853

Dimensions (inches)

seat H	18.0	seat W	22.0/33.0				
total H	33.0	total W	40.25	depth	29.5		



9101MIC-R
66 lbs

Tailor Serpentine, Inside Curve, With Left Arm Only

COM 4.0 yds

1.5 yds COM per single seat

1.75 yds COM per single back

0.75 yds COM per arm

MODEL	COM	GR 1	GR 2	GR 3	GR 4	GR 5	GR 6
9101MIC-L	2460	2748	2844	3038	3334	3553	3853

Dimensions (inches)

seat H	18.0	seat W	22.0/33.0				
total H	33.0	total W	40.25	depth	29.5		



9101MIC-L
66 lbs

TAILOR Lounge Collection - MODULAR - SERPENTINE

Standard Features

- 30° angle
- Separate seat and back
- Meets seating durability test to 500 lbs per chair
- Non wall-saving frame
- **NOTE:** If ordering with other Tailor Modular designs, specify all connected seating within the configuration as non wall-saving
- Clear, non-marring glides
- One connecting plate per unit
- Ships assembled, 1/carton 24 cu ft

For fabrics you wish railroaded or repeats larger than 5" x 5", please contact the factory with repeat information, and yardage requirement will be provided.

To ensure proper configuration please provide a layout drawing.

Options

- Tapered or Straight connecting arm
- Polyurethane arm caps available in Black (B), Taupe RAL 7006 (T) or Sterling Grey (G), add **\$140** List per arm
- For wood arm caps, select from 9 standard stains, or stain-to-match for no extra charge, add **\$165** List per arm
- 1" gap between seat and arm available at **\$57** List per arm
- Swivel tablet arm (TA), add **\$650** List each. Cannot be installed between seats. Choose 12"x12" Square (SQ) or 16-1/2"x 11-1/2" Oval (OVAL). Height above floor is 27-1/2"
- Sled base (non wall-saving), add **\$120**List
- Upholstered arms/seat/back can match or contrast
- Antibacterial and antimicrobial fabrics available
- Connecting and freestanding tables available
- CAL 133 for 9101MOC-NA, add **\$308**List per unit. CAL 133 for 9101MOC, add **\$453** List per unit.



Tapered End Arm



Straight Connecting Arm



Non Wall-saving Frame

Tailor Serpentine, Outside Curve, Without Arms

COM 3.2 yds

1.5 yds COM per single seat

1.7 yds COM per single back

MODEL	COM	GR 1	GR 2	GR 3	GR 4	GR 5	GR 6
9101MOC-NA	2029	2262	2337	2493	2729	2904	3145

Dimensions (inches)

seat H	18.0	seat W	33.0/22.0				
total H	33.0	total W	37.0	depth	29.5		



9101MOC-NA
46 lbs

Tailor Serpentine, Outside Curve, Two Arms

COM 4.7 yds

1.5 yds COM per single seat

1.7 yds COM per single back

0.75 yds COM per arm

MODEL	COM	GR 1	GR 2	GR 3	GR 4	GR 5	GR 6
9101MOC	2659	3006	3120	3356	3709	3971	4331

Dimensions (inches)

seat H	18.0	seat W	33.0/22.0				
total H	33.0	total W	43.5	depth	29.5		



9101MOC
70 lbs

TAILOR Lounge Collection - MODULAR - SERPENTINE

Standard Features

- 30° angle
- Separate seat and back
- Meets seating durability test to 500 lbs per chair
- Non wall-saving frame
- NOTE: If ordering with other Tailor Modular designs, specify all connected seating within the configuration as non wall-saving
- Clear, non-marring glides
- One connecting plate per unit
- Ships assembled, 1/carton 24 cu ft

For fabrics you wish railroaded or repeats larger than 5" x 5", please contact the factory with repeat information, and yardage requirement will be provided.

To ensure proper configuration please provide a layout drawing.

Options

- Tapered or straight connecting arm
- Polyurethane arm caps available in Black (B), Taupe RAL 7006 (T) or Sterling Grey (G), add \$140 List per arm
- For wood arm caps, select from 9 standard stains, or stain-to-match for no extra charge, add \$165 List per arm
- 1" gap between seat and arm available at \$57 List per arm
- Swivel tablet arm (TA), add \$650 List each. Cannot be installed between seats. Choose 12"x12" Square (SQ) or 16-1/2"x 11-1/2" Oval (OVAL). Height above floor is 27-1/2"
- Sled base (non wall-saving), add \$120 List
- Upholstered arms/seat/back can match or contrast
- Antibacterial and antimicrobial fabrics available
- Connecting and freestanding tables available
- CAL 133, add \$380 List per unit.



Tapered End Arm



Straight Connecting Arm



Non Wall-saving Frame

Tailor Serpentine, Outside Curve, With Right Arm Only

COM 3.95 yds

1.5 yds COM per single seat

1.7 yds COM per single back

0.75 yds COM per arm

MODEL	COM	GR 1	GR 2	GR 3	GR 4	GR 5	GR 6
9101MOC-R	2346	2635	2729	2925	3219	3439	3739

Dimensions (inches)

seat H	18.0	seat W	33.0/22.0				
total H	33.0	total W	40.25	depth	29.5		



9101MOC-R
58 lbs

Tailor Serpentine, Outside Curve, With Left Arm Only

COM 3.95 yds

1.5 yds COM per single seat

1.7 yds COM per single back

0.75 yds COM per arm

MODEL	COM	GR 1	GR 2	GR 3	GR 4	GR 5	GR 6
9101MOC-L	2346	2635	2729	2925	3219	3439	3739

Dimensions (inches)

seat H	18.0	seat W	33.0/22.0				
total H	33.0	total W	40.25	depth	29.5		



9101MOC-L
58 lbs

TAILOR Lounge Collection - MODULAR - SERPENTINE

Standard Features

- 30° angle
- Meets seating durability test to 500 lbs per bench
- Non wall-saving frame
 - NOTE:** If ordering with other Tailor Modular designs, specify all connected seating within the configuration as non wall-saving
- Clear, non-marring glides
- One connecting plate per unit
- Ships assembled, 1/carton 11 cu ft

For fabrics you wish railroaded or repeats larger than 5" x 5", please contact the factory with repeat information, and yardage requirement will be provided.

To ensure proper configuration please provide a layout drawing.

Options

- Swivel tablet arm (TA), add \$ **650** List each. Cannot be installed between seats. Choose 12"x12" Square (SQ) or 16-1/2"x 11-1/2" Oval (OVAL). Height above floor is 27-1/2"
- Sled base (non wall-saving), add \$ **120** List
- Antibacterial and antimicrobial fabrics available
- CAL 133, add \$ **145** List per unit



Non Wall-saving Frame

Tailor Serpentine, Bench

COM 1.5 yds
1.5 yds COM per single seat

MODEL	COM	GR 1	GR 2	GR 3	GR 4	GR 5	GR 6
9101MBC	1280	1388	1422	1497	1606	1689	1801

Dimensions (inches)

seat H	18.0	seat W	22.0/33.0				
total H	18.0	total W	33.0	depth	22.0		



9101MBC
32 lbs

TAILOR Lounge Collection - MODULAR

TABLES

Standard Features

- Tables in laminate or veneer
- Select laminate tops from 15 standard laminates or choose any standard Wilsonart, Nevamar, Formica, Arborite and Pionite matte finish laminates for no extra charge
- 9 standard veneers. Stain-to-match available for no extra charge
- Tables available with Self Edge (SE) only
- Steel table legs available in any Spectone color
- Tops utilize NU Green earth friendly core
- Clear, non-marring glides
- One connecting plate per unit
- Ships KD
- 17" height

Options

- To add Cove Mini, clamp mounted with 1 power, 2 USB (charging only), and a 108" long cord to Tailor modular tables, add **\$436** List. Cove will be located on the flat front face of the closed tables as standard. It is not recommended to specify power on open tables or curved surfaces of closed tables. Specify separately at time of order.



Black **COVSMC1P1U-B**
 Silver **COVSMC1P1U-S**
 White **COVSMC1P1U-W**

*To ensure proper configuration
 please provide a layout drawing.*

Corner and Spacer Connecting Tables

Model		Laminate SE	Veneer SE	Weight	Cu.Ft.
91STC - 24X24	SPACER TABLE CLOSED - FULL SIZE	1052	1473	32	11
91STO - 24X24	SPACER TABLE OPEN - FULL SIZE	1079	1511	30	11
91STC - 24X12	SPACER TABLE CLOSED - HALF SIZE	986	1377	20	7
91STO - 24X12	SPACER TABLE OPEN - HALF SIZE	1011	1415	20	7
91ERC - 24X24	END OF RUN TABLE CLOSED - FULL SIZE	1269	1777	33	11
91ERO - 24X24	END OF RUN TABLE OPEN - FULL SIZE	1296	1814	31	11
91ERC - 24X12	END OF RUN TABLE CLOSED - HALF SIZE	1201	1682	21	7
91ERO - 24X12	END OF RUN TABLE OPEN - HALF SIZE	1227	1719	21	7
91ERB	END OF RUN TABLE - BULLET	1381	1934	36	14
91HM	END OF RUN TABLE - HALF-MOON	1846	2827	75	25
91RC	CORNER TABLE - 90 RADIUS CORNER	1381	1934	45	16
91RC45	CORNER TABLE - 45 RADIUS CORNER	1381	1934	32	12



91STC - 24 x 24
32 lbs



91STO - 24 x 24
30 lbs



91STC - 24 x 12
20 lbs



91STO - 24 x 12
20 lbs



91RC
45 lbs



91RC45
32 lbs



91ERC - 24 x 24
33 lbs



91ERO - 24 x 24
31 lbs



91ERC - 24 x 12
21 lbs



91ERO - 24 x 12
21 lbs



91ERB
36 lbs



91HM
75 lbs