



Shower Valve TMVT1 Thermostatic Mixing Valves

- Digital Temperature Display
- Durable Construction from Brass and Stainless Steel
- Reliable Wax-Filled Thermostat
- Responds to Changes of Incoming Pressure or Temperature
- ASSE 1016, Type T Listed
- Check Stops on Inlets
- Adjustable Set Point within Temperature Range
- Easy Installation and Serviceability
- Dirt and Lime Resistant
- Factory Assembled and Tested
- Standard NPT Plumbing

Specification

Digital temperature display toggles between Fahrenheit and Celsius (powered by AAA alkaline batteries). Outlet temperature is displayed on LCD screen in either Fahrenheit or Celsius. Thermostatic water mixing valve shall consist of a piston control mechanism with positive shut-off of hot water when cold water supply is lost. Construction shall be bronze body and cap with replaceable corrosion resistant components, including stainless steel piston and liner. Valve shall be certified to ASSE 1016, Type T. Thermostatic valve shall be Bradley Model S59-2005T1.

Operation

Control handle rotates from off through cold to hot. Volume is constant. Outlet temperature is displayed on LCD screen in either Fahrenheit or Celsius. Maximum temperature is controlled by an adjustable limit stop which restricts the amount of hot water entering the valve. The wax filled thermostat adjusts to changes in incoming temperature and pressure to maintain the set temperature.

Valve Specifications

Maximum Operating Pressure

125 PSI (860 kPa)

Maximum Inlet Temperature

180° F (82° C)

Temperature Range*

Std. Cold to 110° F (43° C)

Set Point

110° F (43° C)

Flow Capacities – GPM

Model	Pressure Drop – PSI						
	5	10	15	20	30	45	60
S59-2005T1 Suffix TMVT1	1.5	2.0	2.25	2.5	3.0	4.0	4.5

Flow Capacities – L/Min

Model	Pressure Drop – Bar						
	.5	1.0	1.5	2.0	2.5	3.0	4.0
S59-2005T1 Suffix TMVT1	6.0	8.0	10.0	11.5	13.0	14.5	16.5

* Temperature range is based on a hot water inlet of at least 125° F (53° C).
Exact temperature range may vary slightly.

Engineer's Approval _____

NAVIGATOR

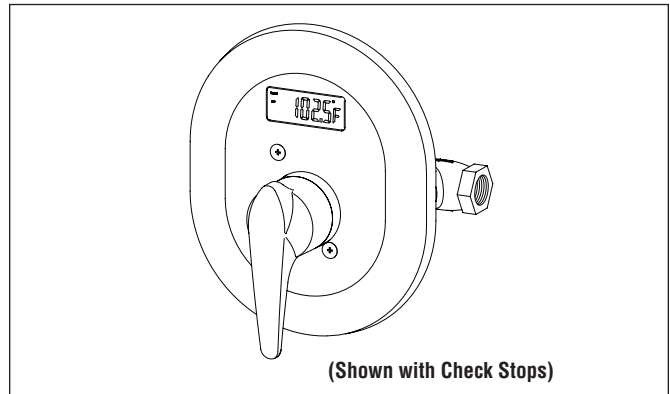

Product Compliance

Listed by IAPMO R&T to

- ASSE 1016-2017/ASME A112.1016-2017/CSA B125.16-17
- Uniform Plumbing Code (UPC)
- National Plumbing Code of Canada
- International Plumbing Code (IPC)



Listed by ASSE International to

- ASSE 1016

Dimensions

(mm)

