

# Parts Diagram ■

Soltice® Metal  
Bariatric Chair Guest Seating SOMB/SPMB

August 2014

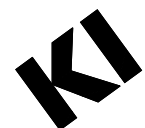
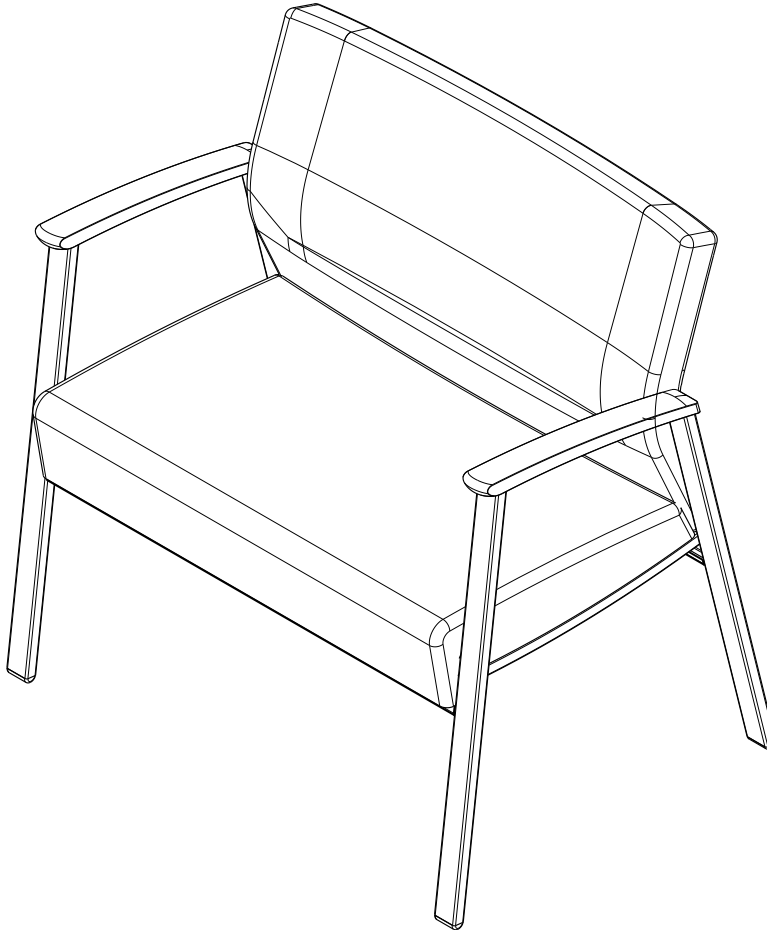

■ Soltice® Metal - Bariatric Chair Guest Seating SOMB/SPMB  
Parts Diagram

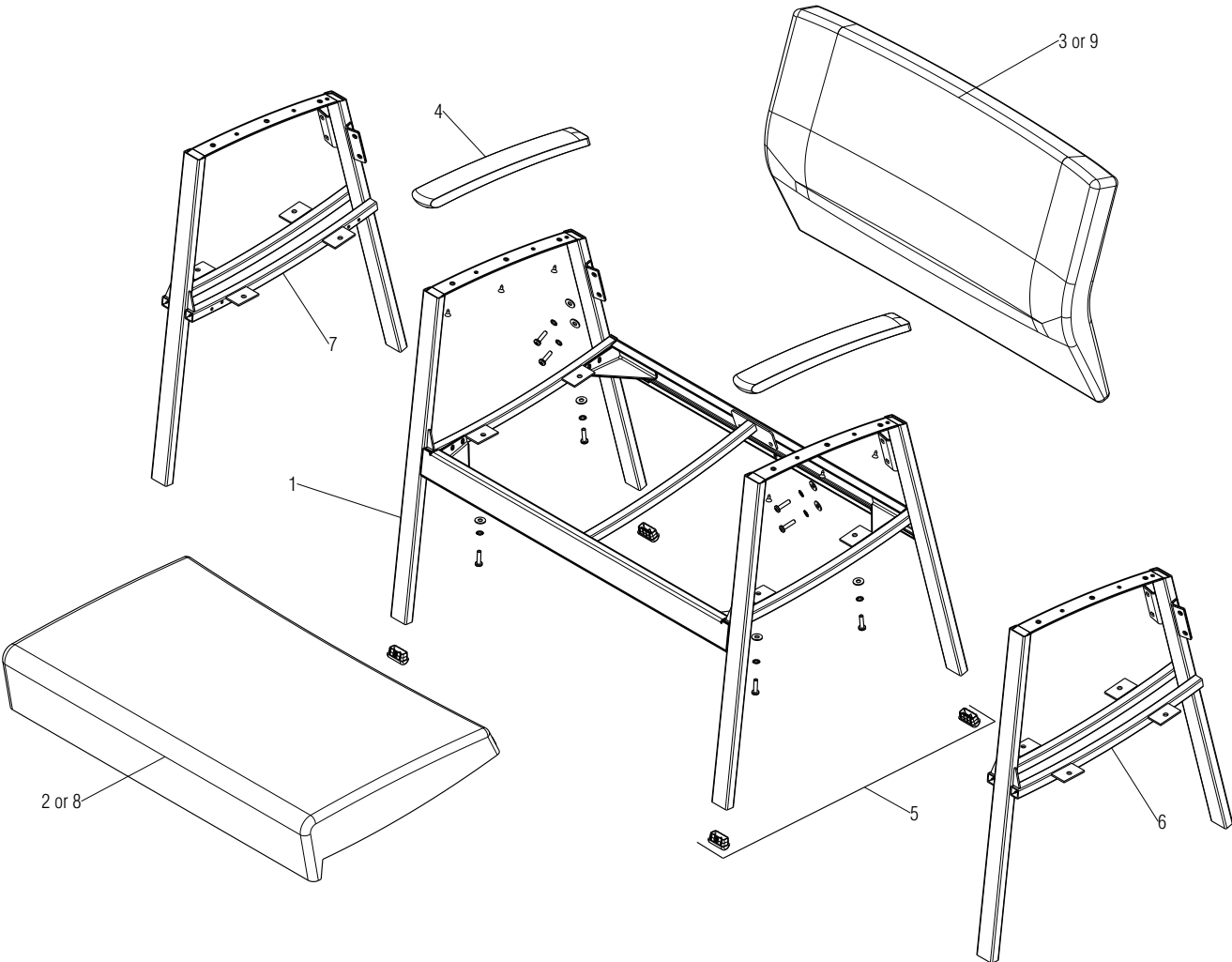

.XX = Specify Color  
 Quantities in bill of materials table are "per single Bariatric Chair" configuration. Increase quantities for every seating position as needed.  
 Shared Arms 24024.XX and 24025.XX are shared between seat positions that have been added to the Bariatric Chair.  
 All Replacement Arms include Glides and Hardware.  
 All other Replacement items include Hardware.

Item	Part Number	Item Description	Qty
1	SMRBF.XX	Assembly, Replacement Bariatric Chair Frame	1
2	SMRBSC	Cover, Replacement Bariatric Seat (Cover only)	1
3	SMRBBC	Cover, Replacement Bariatric Back (Cover only)	1
4	SMLRWAC.XX	Cap, Wood Replacement Lounge Chair Arm	2
5	SMRMSG.XX	Glide, Guest Chair Replacement (4 Glides incl)	1
6	24024.XX	Arm, Right Facing Shared/Center	1
7	24025.XX	Arm, Left Facing Shared/Center	1
8	SMRBS	Assembly, Replacement Seat fully Upholstered	1
9	SMRBB	Assembly, Replacement Back fully Upholstered	1

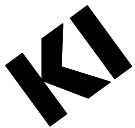

Soltice<sup>®</sup> Metal - Bariatric Chair Guest Seating SOMB/SPMB - Optional Armcaps and Arm Panel

Parts Diagram

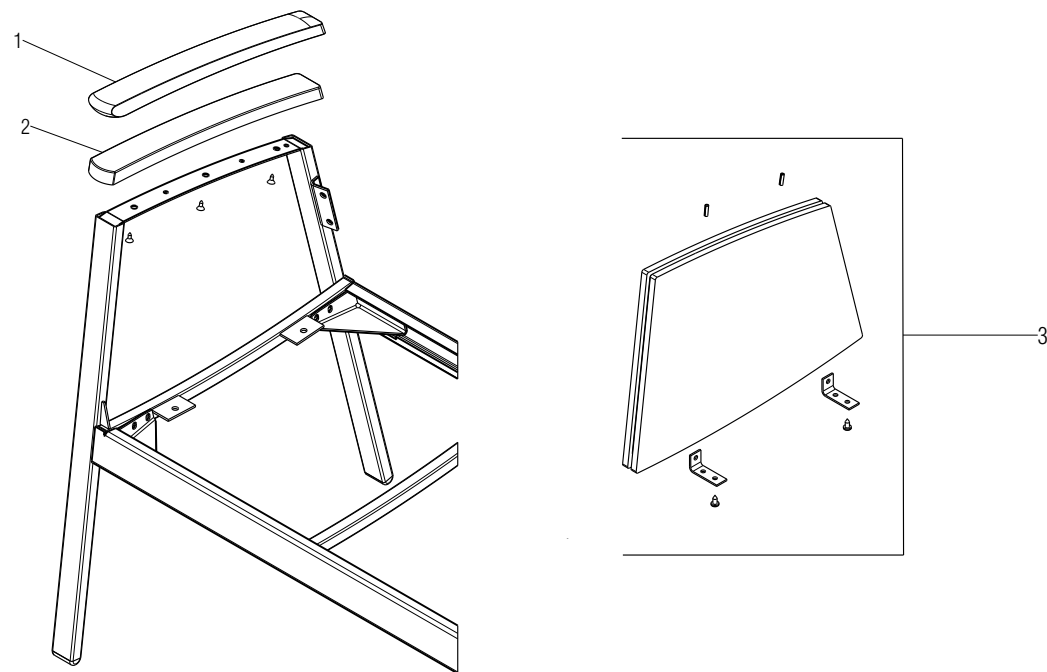

.XX = Specify Color  
Quantities in bill of materials table are "per Bariatric Chair".  
Shared arms with Closed Panel share the SMCARP Panel Replacement Assembly.  
Replacement items this page, include Hardware.

Item	Part Number	Item Description	Qty
1	SMRPAC.XX	Armcap, Replacement Urethane	2
2	SMRSAC	Armcap, Replacement Solid Surface Glacier White	2
3	SMCARP	Assembly, Closed Arm Replacement Panel	2

