



IM#: 16-0015440

Folio™
modular casegoods

Steelcase
HEALTH



IM#: 16-0015441 | SM: FOLIO CABINETS WITH JAZZ PULLS (ARCTIC WHITE); FOLIO LAMINATE WORKSURFACE (GRAPHITE WALNUT); COALESSE LAST MINUTE STOOL (DESIGNTEX SAMBA OTRA VEZ); VICTOR2 MOBILE RECYCLING CENTER (ARCTIC WHITE); V.I.A. (PLATINUM METALLIC MONITOR SHROUD; PLATINUM SEALS, ANODIZED ALUMINUM FRAME, WISP CAPTURED GLASS, MAGNETIC TILE COVERED STEEL SKIN IN DESIGNTEX HENRICK PRISM PATTERN)

Designed for Change

Folio™ casegoods deliver modular storage designed around the changing needs of healthcare places. Discrete cabinets keep supplies and intimidating clinical equipment out of sight to lower stress levels, yet within easy reach to support clinician work process.

A range of hardworking components combine to serve unique purposes in exam spaces, treatment areas and patient rooms. In clinician and administrative workspaces, Folio can combine with V.I.A. architectural solutions to divide space, create privacy and integrate technology.

INSIGHT

Healthcare organizations are under pressure to make every moment count. Folio makes it possible to locate supplies and conveniences where needed to improve workflow and efficiency.



IM#: 14-0001988



IM#: 16-0015439

Maximize Space

Space is at a premium in most healthcare facilities. Folio wall-mounted components are designed to maximize every square foot. Cabinets mount 12 inches above the floor to make cleaning easy and aid in infection control.

Flexible Solutions

Folio cabinets can be individually leveled and feature hinge options to maximize access to the interior. ADA surface heights, sink cabinets with angled fronts, and sloped-topped cabinets are available to meet specific space needs.

STATEMENT OF LINE

BASE CABINETS*

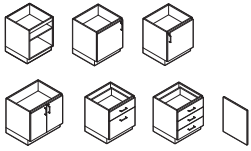

28"H base cabinets

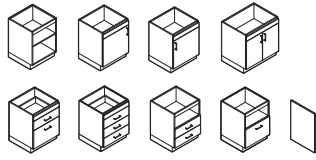

33"H (ADA) base cabinets

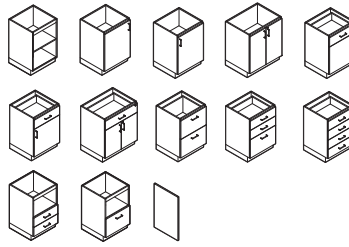

36"H base cabinets

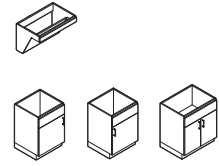

Sink cabinets

STORAGE CABINETS

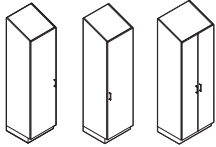

Storage cabinets with sloped top (92"H)

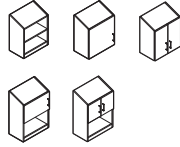

Upper storage cabinets with sloped top (24"H and 30"H)

BOOKCASES*

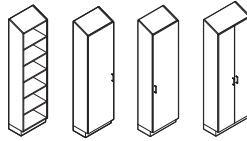

Bookcases with sloped top (89"H)

DESK FRAMES*

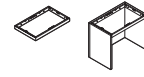

LAMINATE SURFACES

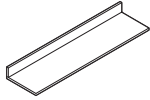

With backplash

SOLID SURFACES

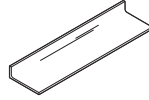

With backplash

NOTES

- * Wall-mounted versions available for base cabinets (24"H), sink cabinets, bookcases (73" and 79"H) and desk frames.
- Open base 28"H cabinet and double door bookcase not available in wall-mounted offering.
- Storage cabinets, upper storage cabinets and bookcases also available.
- Single- and double-door options are available for floor-supported desk frame styles.
- See *Specification Guide* for a full line of options and accessories.

SURFACE MATERIALS

LAMINATE

- Clear Maple
- Blonde on Maple
- Acacia
- Almond Cherry
- Ash Wenge
- Storm Noce
- Storm Wenge
- Medium Cherry

- Graphite Walnut
- Clear Walnut
- Dark Rum Cherry
- Shiraz Cherry
- Arctic White
- Dune
- Seagull

SOLID SURFACE

- Antarctica
- Linen
- Bisque
- Canvas

Colors are representative and may vary slightly from actual material.

For more information on these and other finishes and options, including the full range of available laminates, visit us online and view our *Specification Guide*. Additional solid surface finishes are available through the Steelcase Health Graded-In Program.

SUSTAINABILITY



SCS Indoor Advantage™ Gold certified for indoor air quality in North America



Level® 2 certified to ANSI/BIFMA e3



Folio is made with 83% recycled content, is designed to withstand the demands of healthcare cleaning protocols and is 5% recyclable at the end of its long lifespan. It may contribute to LEED certification for recycled content, regional materials, indoor environmental air quality, furniture and medical furnishings, and sustainable purchasing.

To find out more, visit www.Steelcase.com/sustainability.

Steelcase®

HEALTH

Call 800.333.9939 or visit SteelcaseHealth.com

facebook.com/SteelcaseHealth

twitter.com/SteelcaseHealth

youtube.com/SteelcaseTV