



**Aureus™**  
16-3/4" round vessel bathroom sink, no overflow  
**K-28039-AUR**

### Features

- Premium gold-colored shades and real gold accents in a natural marble pattern on white background
- Round bowl-like basin
- Without overflow

### Material

- Fireclay with Supramic technology

### Installation

- No faucet holes; requires wall-mount or counter-mount faucet (sold separately)
- Semi-recessed vessel

### Required Products/Accessories

K-7107 Decorative Drain

or

K-7108 Decorative Drain

### Recommended Products/Accessories

K-23726 Drain treatment

K-23723 Faucet cleaner



**ADA**

**CSA B651**

### Codes/Standards

ASME A112.19.2/CSA B45.1

ADA

ICC/ANSI A117.1

CSA B651

IAPMO Certification

### KOHLER® One-Year Limited Warranty

See website for detailed warranty information.

### Available Colors/Finishes

*Color tiles intended for reference only.*

Color	Code	Description
-------	------	-------------



0

White



**Aureus™**  
16-3/4" round vessel bathroom sink, no overflow  
**K-28039-AUR**

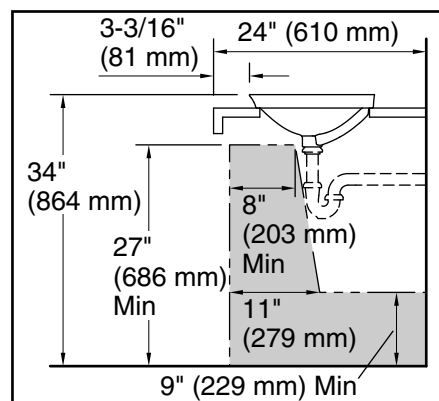
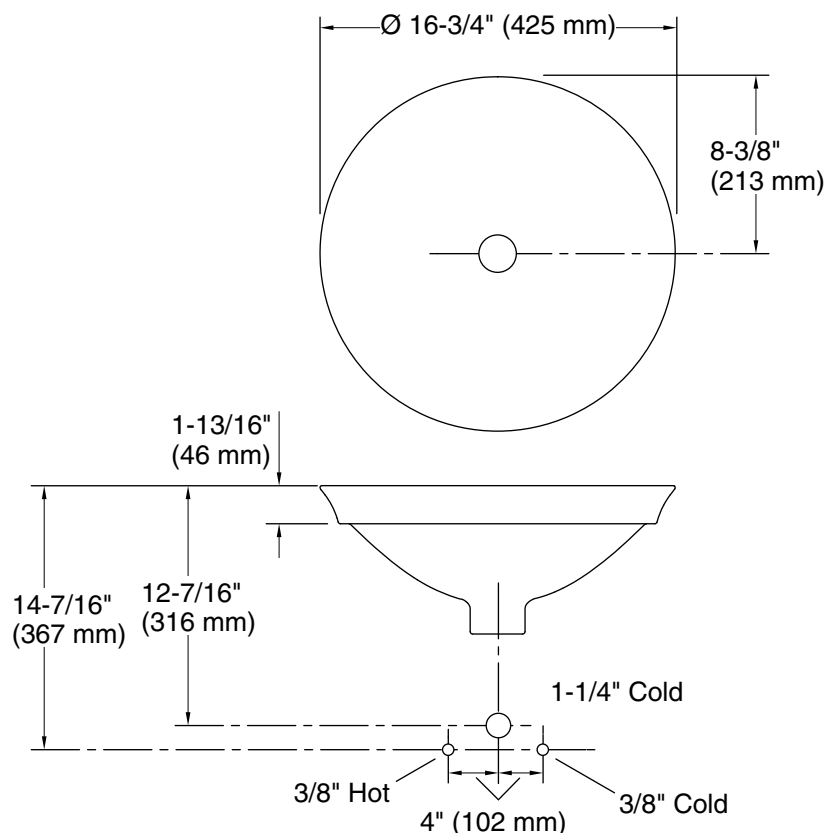

**Recommended ADA Installation**

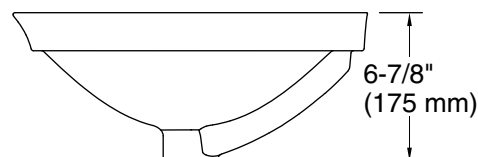

### Technical Information

All product dimensions are nominal.

Bowl configuration: Single

Min. base cabinet width: 20" (508 mm)

Bowl area (Center):  
Length: 16-7/16" (418 mm)  
Width: 16-7/16" (418 mm)  
Bowl depth: 5-3/16" (132 mm)  
Water depth: 5-3/16" (132 mm)

With overflow: No

Drain hole: 1-3/4" (45 mm)

Template: Drop-in, 1527650-7, required, included

### Notes

Install this product according to the installation instructions.

**NOTICE:** Countertop manufacturer or cutter must use the current product template available at [www.kohler.com](http://www.kohler.com) or by calling 1-800-4KOHLER. Kohler Co. is not responsible for cutout errors when the incorrect cut-out template is used.

ADA, CSA B651 compliant when installed to the specific requirements of these regulations.