



16-1/4" round undermount bathroom sink, no overflow
Caxton®
K-29000

Features

- Without overflow
- No faucet holes; requires wall- or counter-mount faucet

Material

- Vitreous china

Installation

- Undermount

Recommended Products/Accessories

K-9018 P-Trap
K-23726 Drain treatment
K-23725 Cast iron cleaner

Included Components

1193643 Basin clamps



ADA

CSA B651

Codes/Standards



ASME A112.19.2/CSA B45.1
ADA
ICC/ANSI A117.1
CSA B651
IAPMO Certification

KOHLER® One-Year Limited Warranty

See website for detailed warranty information.

Available Colors/Finishes

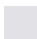
Color tiles intended for reference only.

Color	Code	Description
	0	White
	96	Biscuit
	7	Black Black™

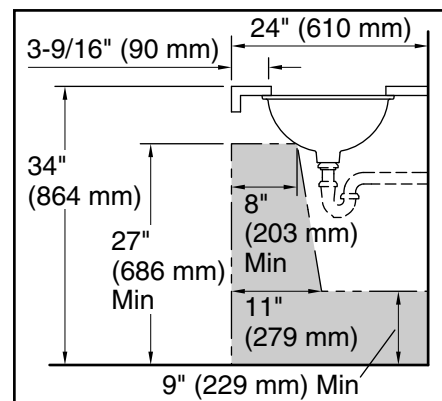
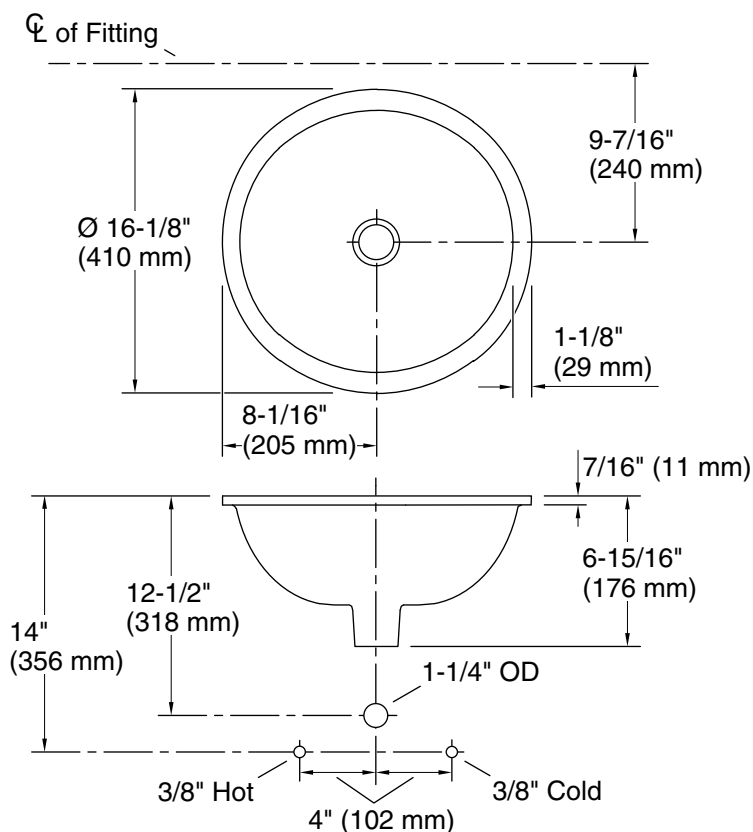

Recommended ADA Installation

Technical Information

All product dimensions are nominal.

Bowl configuration: Single

Bowl area (Only): Length: 13-13/16" (351 mm)
Width: 13-13/16" (351 mm)
Bowl depth: 5-1/16" (129 mm)
Water depth: 5" (127 mm)

Drain hole: 1-3/4" (44 mm)

Template: Undermount, 1035896-7, required, not included

Notes

Install this product according to the installation instructions.

NOTICE: Countertop manufacturer or cutter must use the current product template available at www.kohler.com or by calling 1-800-4KOHLER. Kohler Co. is not responsible for cutout errors when the incorrect cut-out template is used.

ADA, CSA B651 compliant when installed to the specific requirements of these regulations.