

Features

- Catalyzed conversion varnish provides a durable moisture-resistant finish
- One door and three drawers on right
- Frameless construction with full-overlay door and drawers
- Three-way adjustable slow-close door hinges for easy cabinet access
- Full-extension 18" (457 mm) depth drawers with soft-close undermount slides for smooth opening
- Solid wood drawers with dovetail construction
- Legs offer the polished look of furniture in the bathroom
- Coordinates with the K-99687 Poplin / Marabou rectangular pull (sold separately)
- Combines with Ceramic/Impressions®, Solid/Expressions®, and Iron/Impressions® vanity tops (sold separately) for a complete vanity
- Customize your storage with optional accessories such as shelves, trays, drawer dividers, and medicine cabinets (sold separately)



Codes/Standards

EPA TSCA Title VI/CARB P2

KOHLER® One-Year Limited Warranty

See website for detailed warranty information.

Material

- Solid wood and veneers
- Wood is a living material, and its beauty is enhanced by natural variations in grain, color, and pattern. No two pieces of wood are exactly the same, and the color will change with age, temperature, and exposure to light
- The nature of wood grain can cause variations in stain depth. Our expert craftspeople hand-apply the stain to blend these variations

Required Products/Accessories

K-20000 20-1/2" rectangular undermount bathroom sink
K-27933 Drawer appliance organizer
K-27934 Protective floor liner for 30" cabinet
K-28248 Silestone® 31" quartz vanity top with rectangular cutout
K-28262 Silestone® quartz 31" backsplash
K-99677-SH8 Adjustable shelf for 30" KOHLER Tailored® vanities
K-99679-SH8 Roll-out drawer for 24" KOHLER Tailored® vanities
K-99681 Electrical outlets for KOHLER Tailored® vanities
K-99682 General storage package for KOHLER Tailored® vanities
K-99683 Makeup storage package for KOHLER Tailored® vanities
K-99684 Drawer divider package for KOHLER Tailored® vanities

1-800-4KOHLER (1-800-456-4537)

Kohler Co. reserves the right to make revisions without notice to product specifications.

For the most current Specification Sheet, go to www.kohler.com.

12-22-2023 23:51 - US/CA

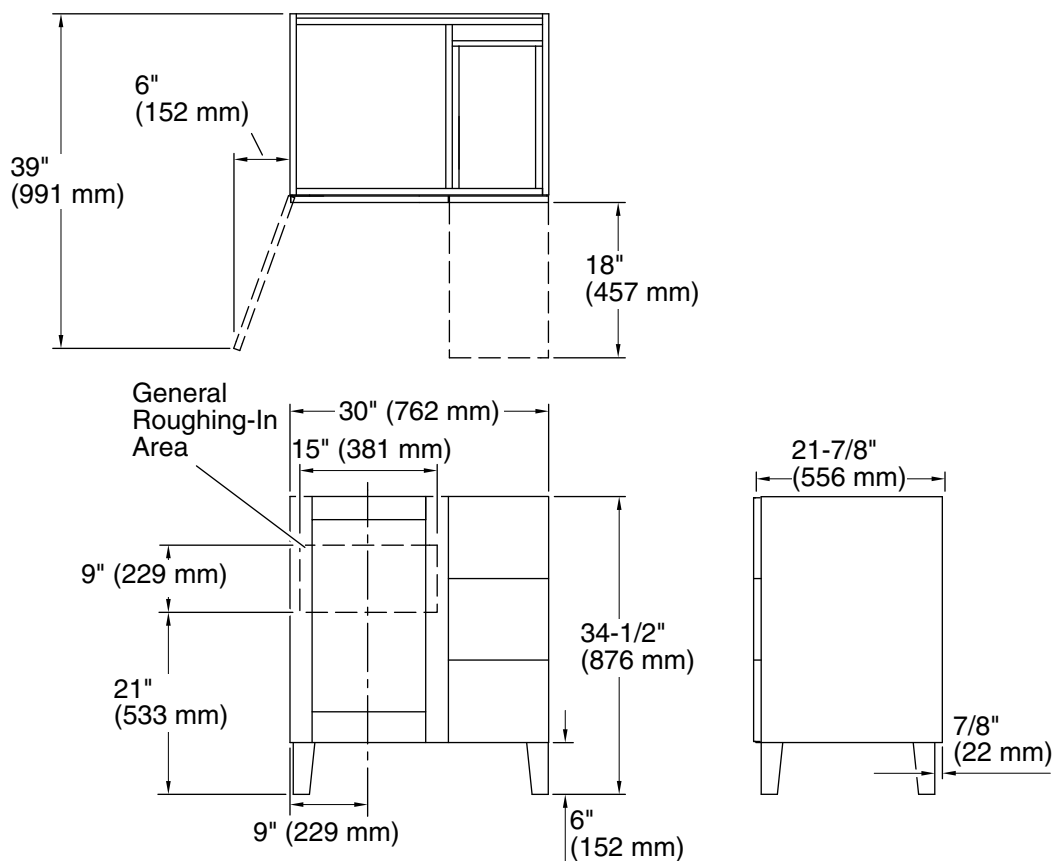

Technical Information

All product dimensions are nominal.

Vanity type: Standard

Notes

Install this product according to the installation guide.

Decorative cabinet hardware is not supplied. Refer to the KOHLER bath accessories line for recommended cabinet hardware to complement your vanity.

Select the type of fastener based upon the wall material. Two 250 lb (113.4 kg) minimum load bearing fasteners are recommended.