

MM3/SET

PROPRIETARY AND CONFIDENTIAL.

ALL DIMENSIONS HAVE A $\pm 1/32"$ TOLERANCE UNLESS OTHERWISE SPECIFIED. WE DO NOT RECOMMEND DRILLING OR CUTTING ANY HOLES BEFORE RECEIVING A PRODUCT OR A PRODUCT SAMPLE.

SPECIFICATIONS

- Maximum cord diameter is $5/8"$.

TABLE OF CONTENTS

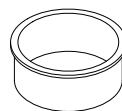

..... 1X MM3A



..... 1X MM3

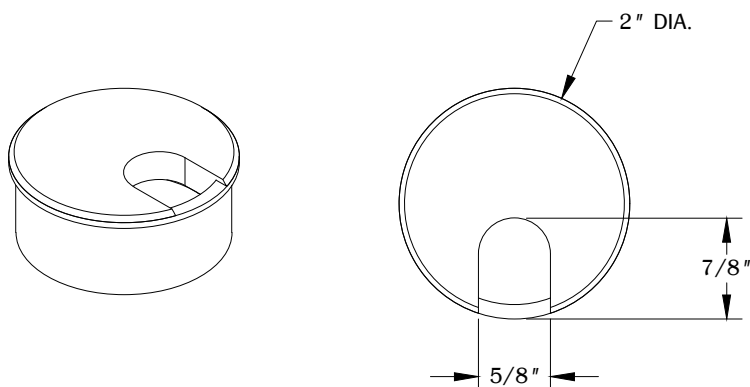

TOP VIEW

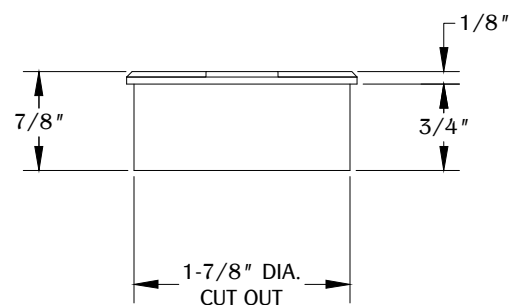

FRONT VIEW

1

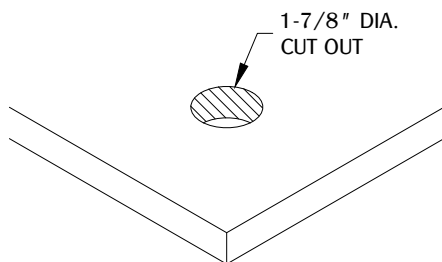

Make a cut out in the desired location on your work surface.
Cut a hole at $1-7/8"$ diameter.

2

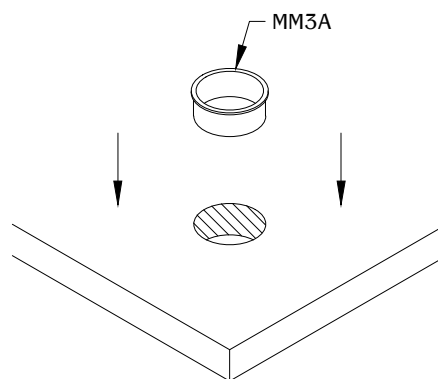

Install the MM3A into the cut out and make sure it is fully leveled onto the work surface.

MM3/SET

PROPRIETARY AND CONFIDENTIAL.

ALL DIMENSIONS HAVE A $\pm 1/32"$ TOLERANCE UNLESS OTHERWISE SPECIFIED. WE DO NOT RECOMMEND DRILLING OR CUTTING ANY HOLES BEFORE RECEIVING A PRODUCT OR A PRODUCT SAMPLE.

3

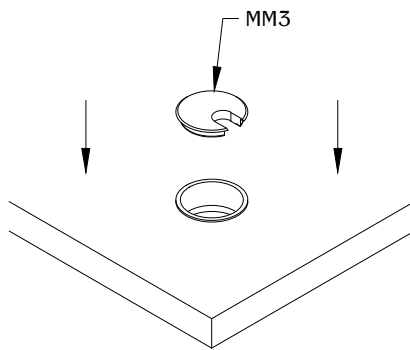

Insert MM3 into the MM3A.