

CH65







PROPRIETARY AND CONFIDENTIAL.

ALL DIMENSIONS HAVE A $\pm 1/32"$ TOLERANCE UNLESS OTHERWISE SPECIFIED. WE DO NOT RECOMMEND DRILLING OR CUTTING ANY HOLES BEFORE RECEIVING A PRODUCT OR A PRODUCT SAMPLE.

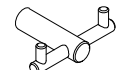
SPECIFICATIONS

- Weight capacity is 3 lbs MAX.

TABLE OF CONTENTS

	1X CH65
	1X Mounting Base
	1X Hex Key
	1X Set Screw
	1X Plastic Anchor
	1X 1-7/16" No. 8 Wood Screw

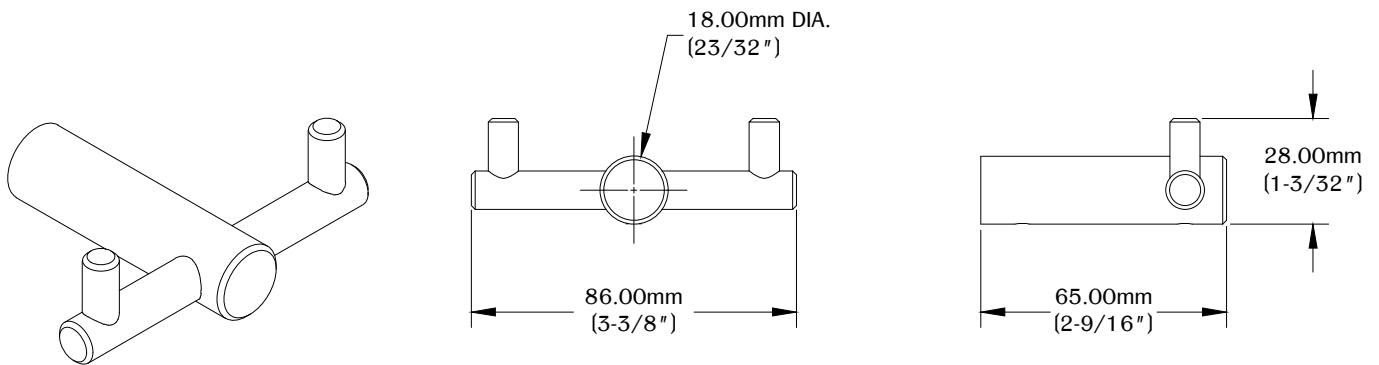

FRONT VIEW

SIDE VIEW

1

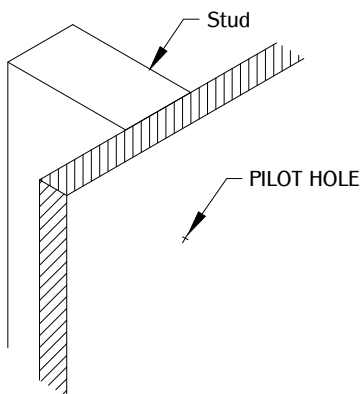

Determine the position and location of the part on the work surface. Mark the mounting position for the mounting hardware and drill a 6.00mm (1/4") DIA. pilot hole for drywall or a 3.00mm (1/8") DIA. pilot hole wood installation.

2

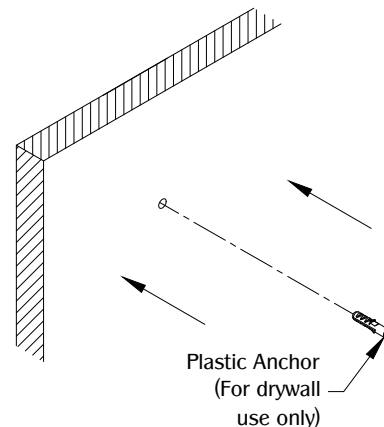

Place plastic anchor into the pilot hole. Skip this step for wood installation.

CH65

PROPRIETARY AND CONFIDENTIAL.

ALL DIMENSIONS HAVE A $\pm 1/32"$ TOLERANCE UNLESS OTHERWISE SPECIFIED. WE DO NOT RECOMMEND DRILLING OR CUTTING ANY HOLES BEFORE RECEIVING A PRODUCT OR A PRODUCT SAMPLE.

3

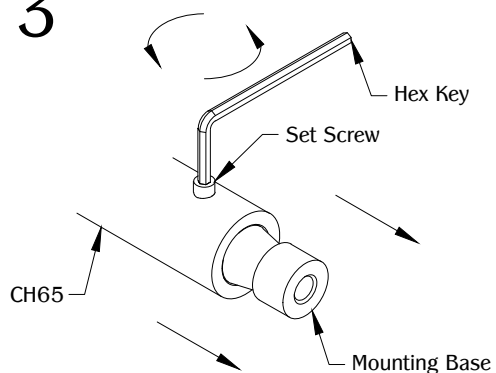

Use hex key to loosen set screw. Tilt CH65 down to release mounting base.

4

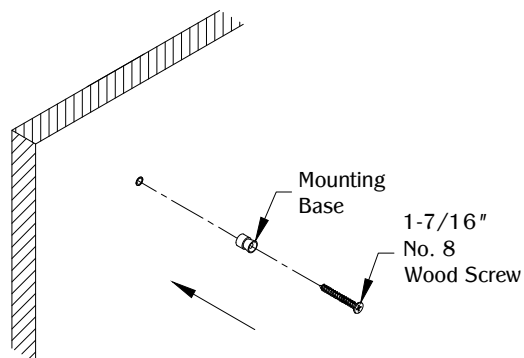

Align and secure the mounting base with 1-7/16" No. 8 wood screw.

5

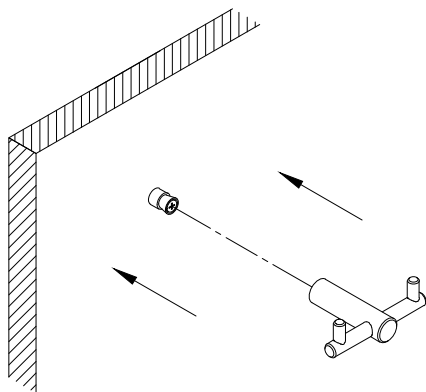

Align CH65 to mounting base.

6

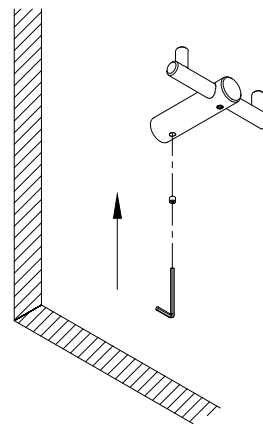

Secure the part using set screw and hand-tighten with the hex key.