

## PCS124C/UNMT

PROPRIETARY AND CONFIDENTIAL.

ALL DIMENSIONS HAVE A  $\pm 1/16"$  TOLERANCE UNLESS OTHERWISE SPECIFIED. WE DO NOT RECOMMEND DRILLING OR CUTTING ANY HOLES BEFORE RECEIVING A PRODUCT OR A PRODUCT SAMPLE.

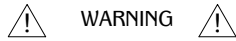

### WARNING

- For indoor use only.
- For use on a normally dry work surface.
- If any malfunction occurs, do not attempt to disassemble or repair.
- Avoid placing the charger in a high temperature environment or near fire.

### SPECIFICATIONS

- 9 ft. cord length.
- USB-A ports are for charging use only.

### TABLE OF CONTENTS

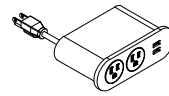

..... 1X PCS124C/UNMT

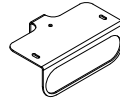

..... 1X Mounting Bracket



..... 3X  $1/2"$   
No. 10 Pan Head Screw



..... 2X Wire Manager



..... 1X Plastic Thumb Nut

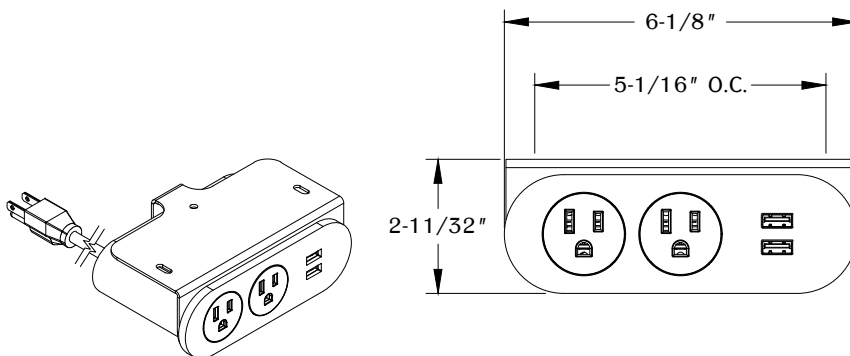

FRONT VIEW

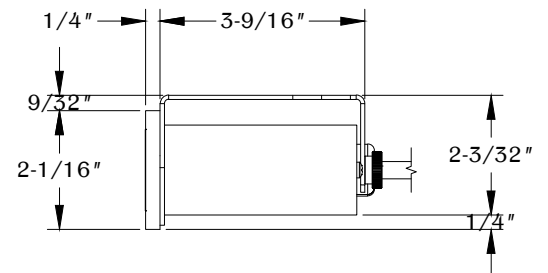

SIDE VIEW

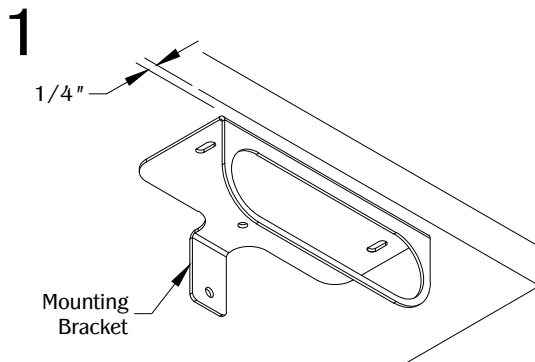

Determine the position and location of the mounting bracket underneath the edge of the work surface. DO NOT place unit where the cable is strained or trapped. Allow  $1/4"$  clearance from the edge.

2

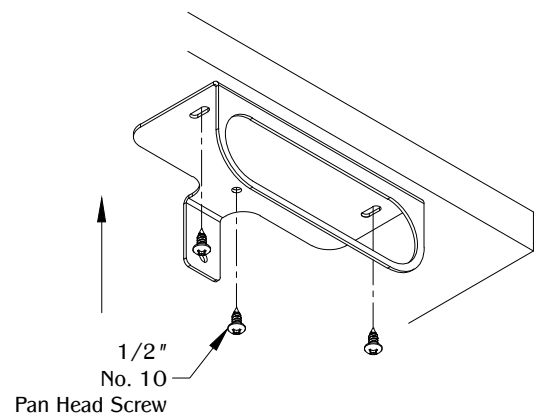

Use the (3)  $1/2"$  No. 10 pan head screws to secure the mounting bracket under the work surface.

## PCS124C/UNMT

PROPRIETARY AND CONFIDENTIAL.

ALL DIMENSIONS HAVE A  $\pm 1/16"$  TOLERANCE UNLESS OTHERWISE SPECIFIED. WE DO NOT RECOMMEND DRILLING OR CUTTING ANY HOLES BEFORE RECEIVING A PRODUCT OR A PRODUCT SAMPLE.

3

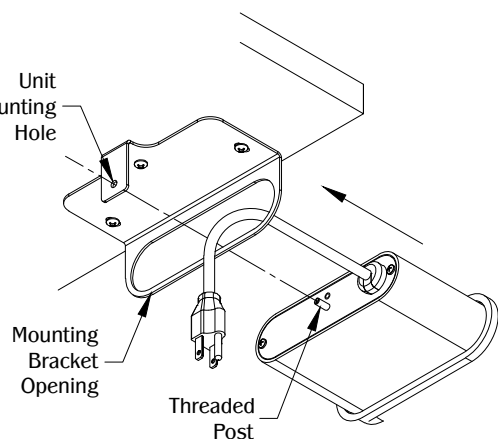

Guide the PCS124C/UNMT through the opening on the mounting bracket. Align the threaded post to the hole at the back of the mounting bracket.

4

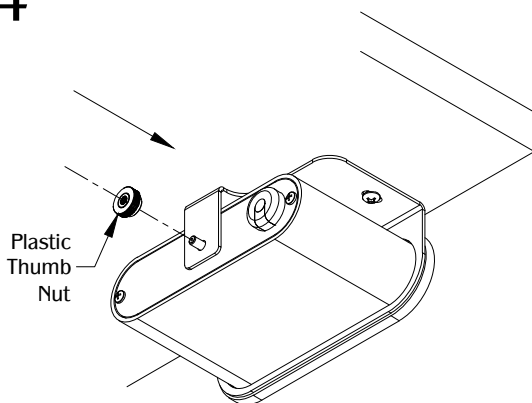

Use the plastic thumb nut to secure the unit in the mounting bracket. Plug the unit into nearby outlet and the unit is ready for use.

5

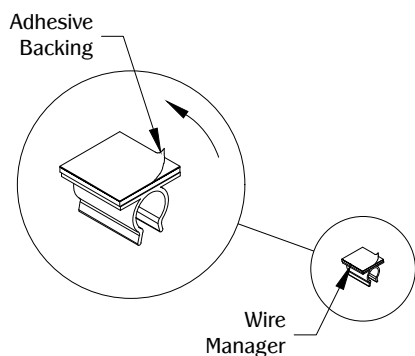

Peel adhesive backing from wire managers.

6

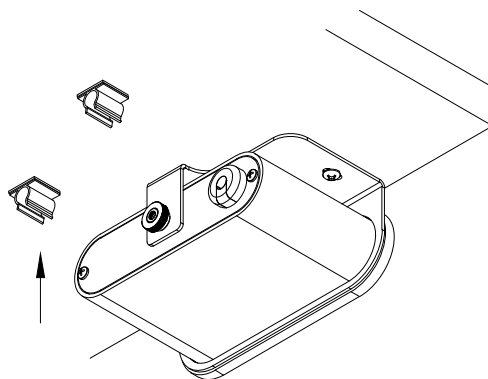

Place wire managers under work surface.

7

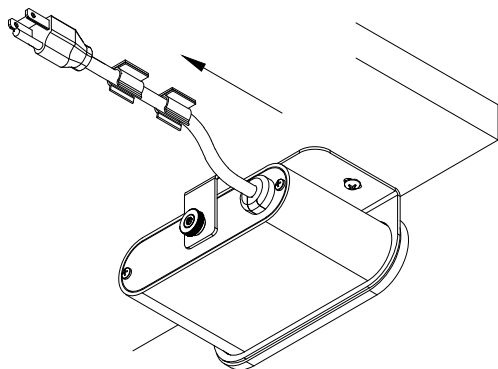

Place wires through wire managers. Plug the unit into a nearby outlet and the unit is ready for use.