

NOTE:

- 6 ft. cord length.
- For use on a normally dry work surface.
- Table thickness is $\frac{3}{4}$ " MIN. to $1\frac{3}{4}$ " MAX.
- Plug dimension is $1\frac{11}{32}$ " X $1\frac{1}{32}$ " X $\frac{7}{8}$ ".

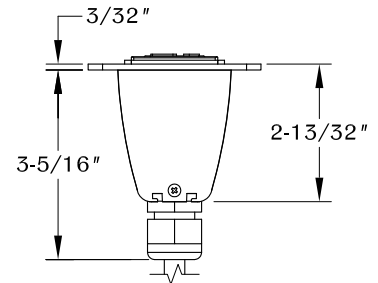
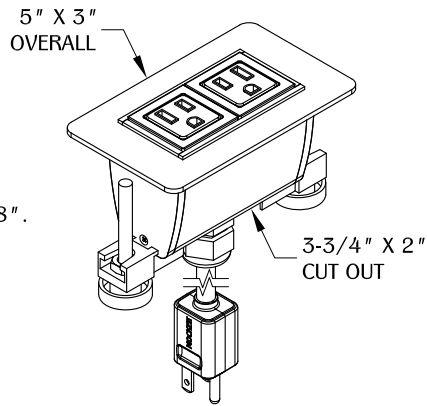

SIDE VIEW

1

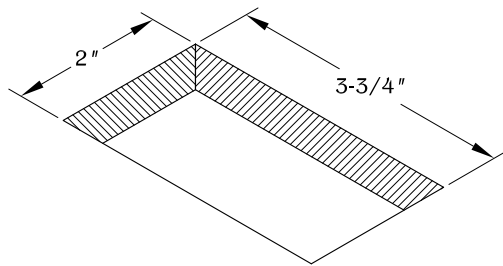

Determine the position and location of the unit on the work surface. Cut the hole at $3\frac{3}{4}$ " X 2". Place and allow enough clearance for unit operation. DO NOT place unit where the cable is strained or trapped.

2

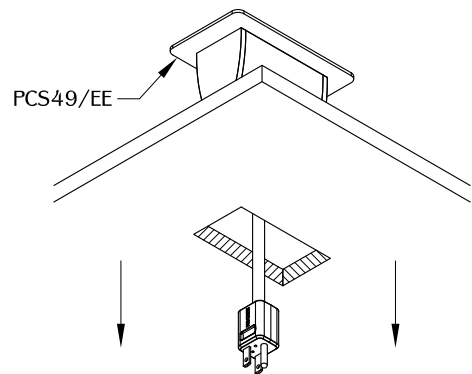

Guide the power cord through the cut out. Install the unit into the cut out and make sure it is fully leveled onto the surface.

3

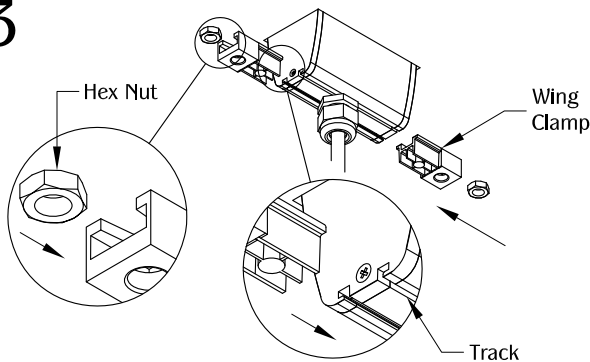

Insert (2) hex nuts into the opening on the sides of the wing clamps. Slide the (2) wing clamps in the underside track of the unit.

4

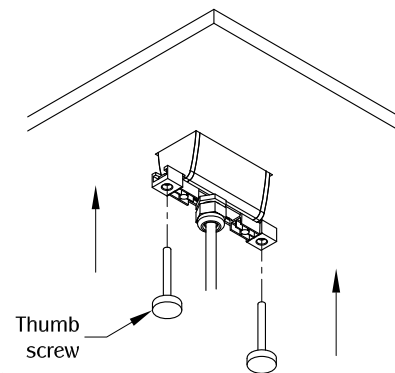

Use (2) thumb screws to secure the part in the work surface. Plug the unit into a nearby outlet and unit is ready for use.

5

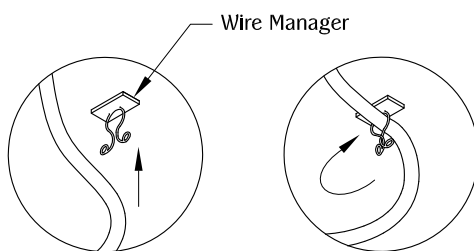

Optional wire manager.

TABLE OF CONTENTS:

	1X PCS49/EE
	2X Thumb Screw
	2X Wing Clamp
	2X Hex Nut
	1X Wire Manager