

ELKAY® BIM Content Library

User Guide – Sink Product

Products > Sinks > Installation Type > Undermount



ECTRU24169RTWC



ECTRU30169RTWC



EFRU24169RTWC



EFRU30169RTWC



ECTRU24169RTFCW



ECTRU30169RTFCW



ECTRU35179TFCBC



ECTRU35179TFCC



ECTRU30179RTFBC



ECTRU30179RTFMC



ECTRU24179RTFBC



ECTRU24179RTFCC



ECTRU21179TFCBC



ECTRU21179TFCC



ECTRU17179TFCBC



ECTRU17179TFCC



EFRU311610T



EFRU281610T



ECTRU35179T



EFRU281610T



EFRU2816T



EFRU211510T



EFRU411510DBT



ECTRU17169W



ECTRU21169W



ECTRU27169RW



EFRU17169W



EFRU21169W



EFRU27169RW

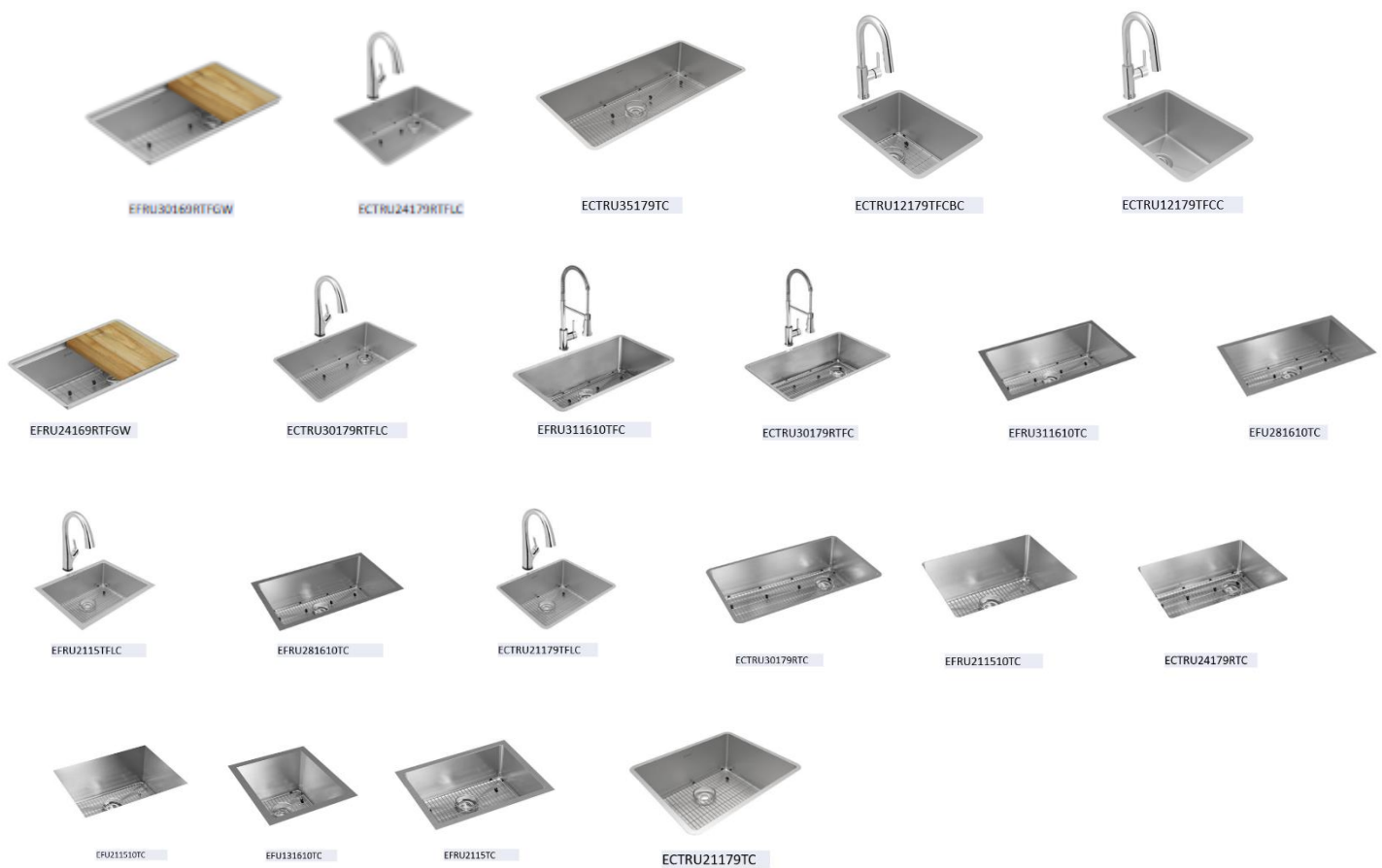

Figure 1: Crosstown

LOADING THE MODELS

How to Load the Elkay Family

It is recommended the steps outlined below are followed to properly load the BIM component into a project.

1. Open a Revit Project File (.RVT) and navigate to the Plan View.
2. Go to the 'Insert' tab on the Revit ribbon and select 'Load Family'

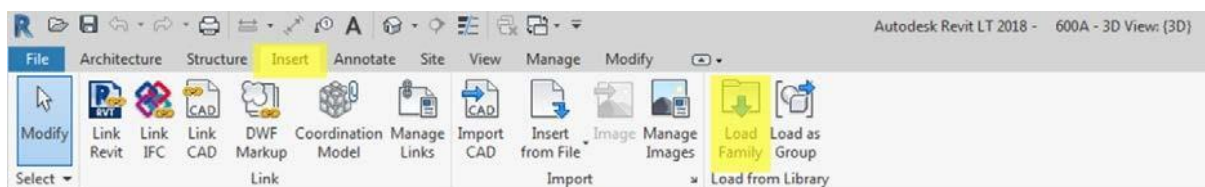

Figure 2: Loading the Family into a Project

3. Navigate to the location of the downloaded Elkay Coolers and Fountains (RFA file)
4. Click 'OK' to load the component into the project

ACCESSING PRODUCT INFORMATION

To access the data embedded into the component, simply select the desired component and click the 'Edit Type' button at the head of the 'Properties' bar. This is typically located on the left-hand side of the screen.

Figure 3: Accessing Additional Data



Master BIM Model : Elkay_Sinks_Crosstown_Undermount_Bowls1.rfa

SKU's List in BIM

[illegible]

SKU's Configured BIM Model

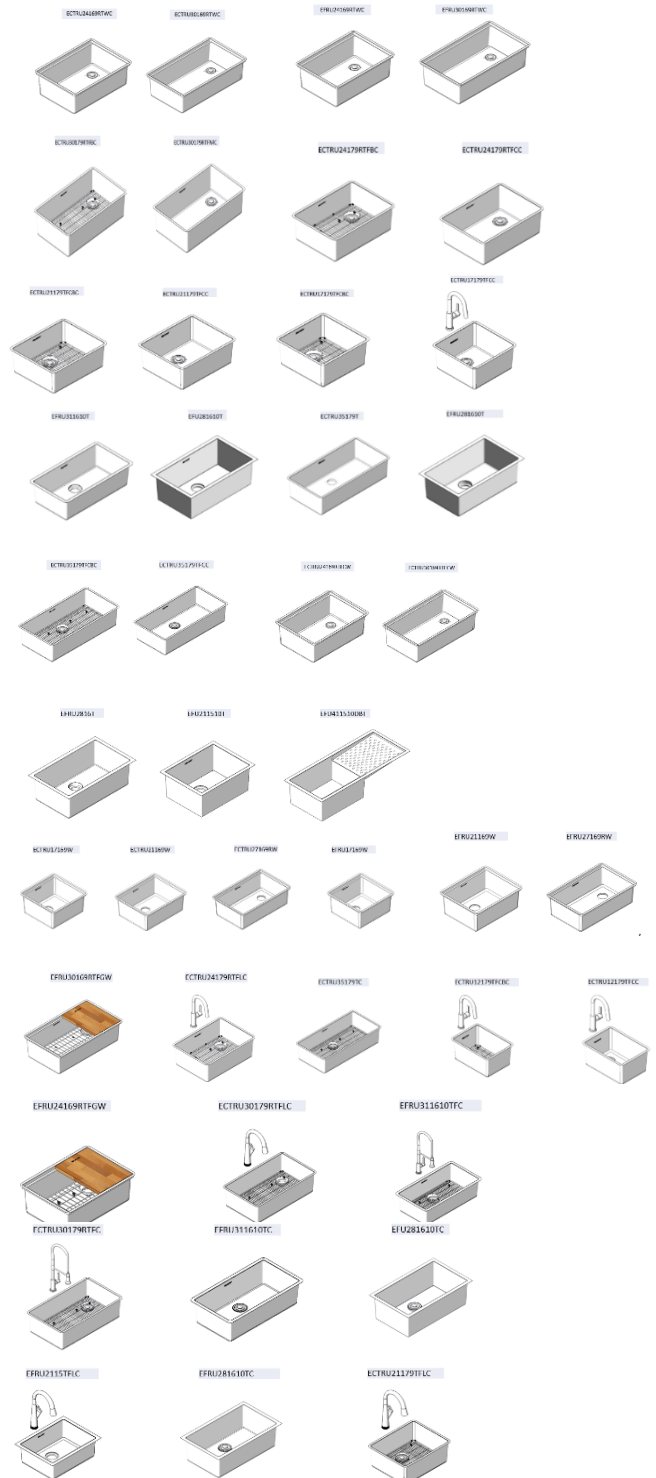



ECTR030179RTC

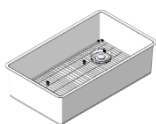

EFRU211510TC

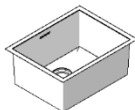

ECTR024179RTC

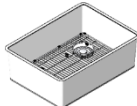

EFU211510TC

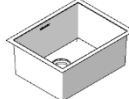

EFU131610TC

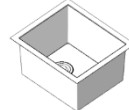

EFRU2115TC

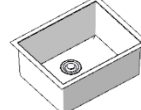

ECTR021179TC

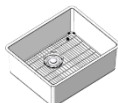

How to Place Sink Family in project

Plumbing fixtures are often hosted components, placed on a vertical face, face, or work plane.



1. In the Project Browser, open a view where you want to place a plumbing fixture.
2. In the Project Browser, right-click the view, click Apply Template Properties to Current View, and select Plumbing Plan from the Apply View Template dialog.

Note: The Plumbing Plan view template is available when you create a project using the mechanical default template.

Click Systems tab ► Plumbing & Piping panel ► , and select a particular fixture type from the Type Selector.

On the ribbon, verify that Tag on Placement is selected to tag the plumbing fixture automatically.

On the Options Bar, to include a tag leader, select Leader and specify the l

Click Place Plumbing Fixture tab ► Placement panel ► , , or  to specify a host component.

Tip: When placing a plumbing fixture on a work plane, it may be necessary to Pick a Plane in the Work plane dialog, or by selecting Placement Plane on the Options Bar when placing the fixture.

Move the cursor to where you want to place the plumbing fixture, and click.

Tip: You can press Space to rotate the plumbing fixture prior to placing it in the view. The fixture is rotated by 90 degrees each time you press Space.

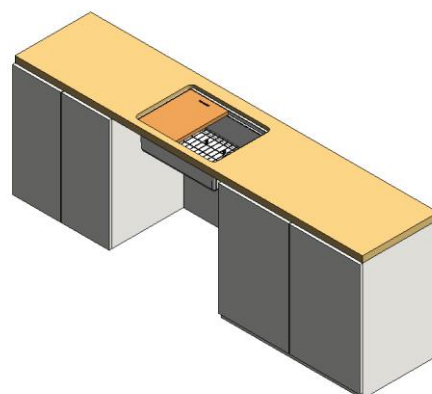
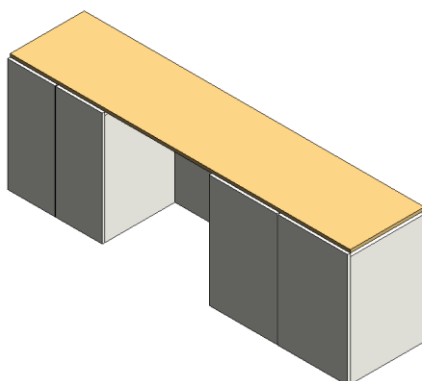





LOADING THE IFC MODEL

How to Load the Elkay IFC Model in Revit

To use an ELKAY IFC model, link the IFC file to a Revit model.

1. (Optional) Before linking an IFC file, click File tab ➤ Open ➤  (IFC Options) and use the Import IFC Options dialog to do the following:
 - Select a default Revit template to use for IFC files.
Note: If a default template is not selected, the first template listed under File Locations in Revit Options will be used.
2. Open the Revit model.
3. Click Insert tab ➤ Link panel ➤  (Link IFC).
4. In the Open IFC File dialog, navigate to the IFC file, select it, and click Open.