

Part # 13.0067
© KI 2009 Litho in USA Code KI-61592R1/HT/GT/0509

1330 Bellevue Street • P.O. Box 8100 • Green Bay, WI 54308-8100
1-800-424-2432 • www.ki.com

Operating Instructions

Flip-Top Table

Save for future reference

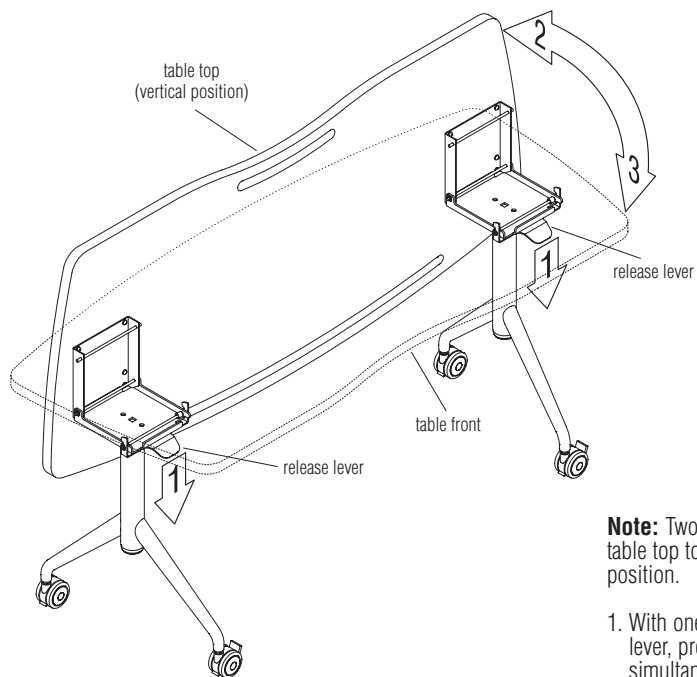

Note: Two people are required to flip table top to the vertical, stored position.

1. With one person at each release lever, press down on both levers simultaneously.
2. With release levers down, rotate front of table up to the stored vertical position.
3. To return table top to the horizontal position, carefully rotate the top down and press down firmly until a "click" is heard at both flipping mechanisms.