

Disassembly Instructions

Modular Storage: All Terrain

Material Type: A .Steel B. Wood C. Plastic D. Aluminum

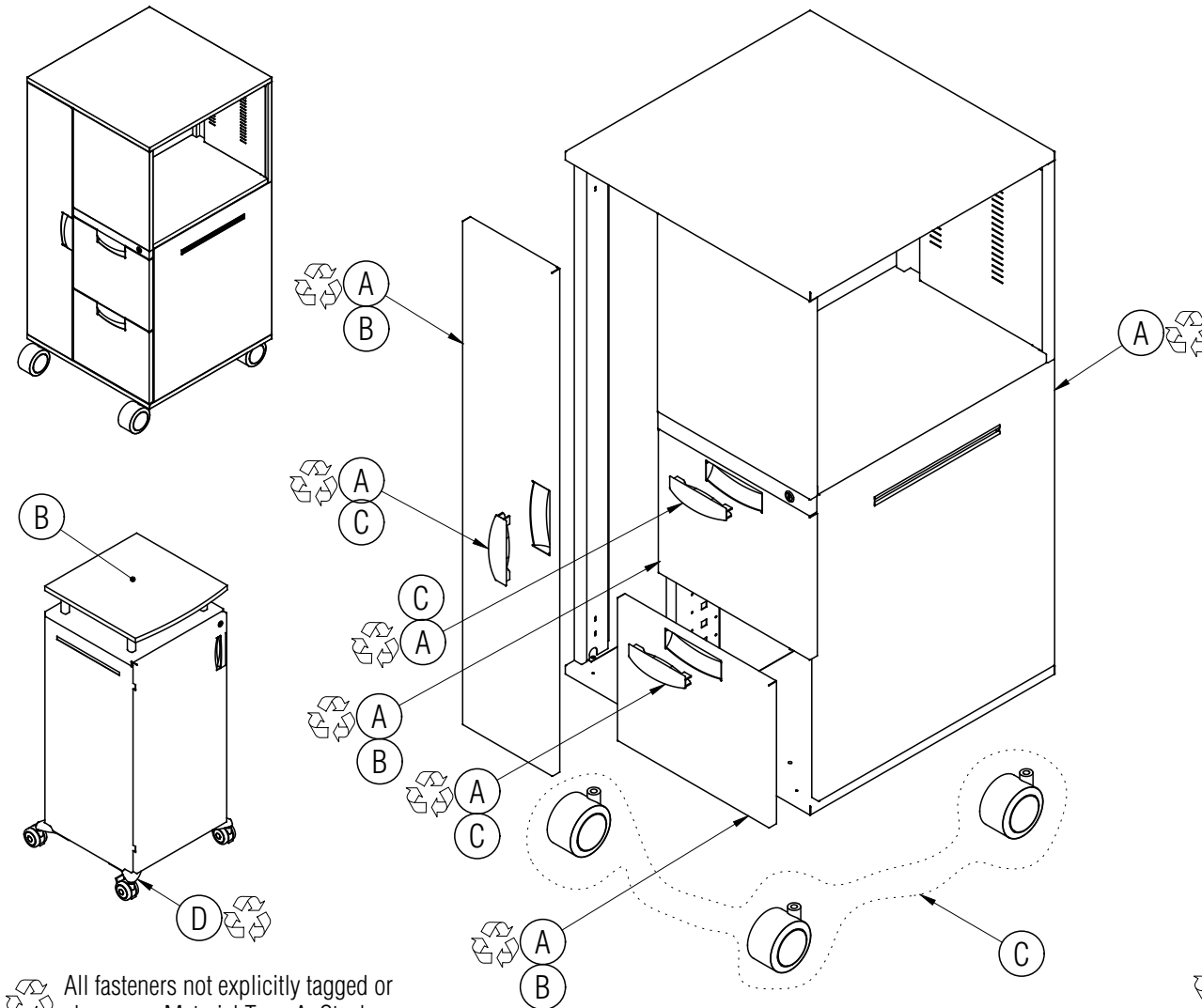

All fasteners not explicitly tagged or shown are Material Type A: Steel

Procedure:

1. Determine if the door and drawer fronts and drawer pulls are steel or plastic.
2. Remove any screws holding the drawer pulls onto the drawer front and remove the pulls.
3. For wood drawer fronts open the drawer and strike the underside of both suspensions to dislodge the suspensions from the drawer. Pull up on the drawer front until the drawer body disengages from the suspensions. Remove the screws holding the front onto the drawer tray and remove the front. Push the suspensions back into the unit.
4. For wood doors, open the door and remove the screws holding the hinges onto the back of the door. Remove the door.
5. Remove any screws holding a top onto the unit and remove the top
6. Remove any glides or casters from the bottom of the unit. For casters mounted on outriggers, remove the outriggers from the bottom of the unit and recycle.

General Notes:

1. Disassembly time: 15-30 minutes
2. This procedure assumes basic familiarity with hand tools and furniture terminology: no specialized training is required
3. All materials removed and disassembled shall be sorted and segregated with like materials and disposed of or recycled according to recycling availability or waste acceptance
4. For items to be recycled, refer to KI's End of Life Recycling Matrix and KI's End of Life Recovery Options Matrix, available at www.ki.com

Required Tools



Safety Glasses



Gloves

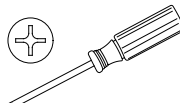

Phillips Screwdriver

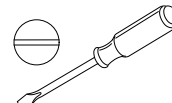

Flat Screwdriver

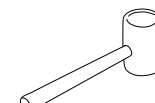

Rubber Mallet

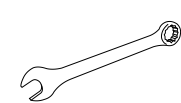

Combination Wrench