

Swing-Arm Bases

A black and white photograph of a modern office chair. The chair features a high-back design with a mesh backrest and a cushioned seat. It is mounted on a five-star base with casters. The chair is positioned on a light-colored floor against a plain, light-colored wall. The lighting creates a soft shadow of the chair on the wall behind it.

[illegible]

Jury Base Seating - Swing-Arm Bases - Floor Anchor Specifications

Assembly Instructions



Assemble units as described herein only. To do otherwise may result in instability. All screws, nuts and bolts must be tightened securely and must be checked periodically after assembly. Failure to assemble properly, or to secure parts may result in assembly failure and personal injury.

Floor Anchor Specifications

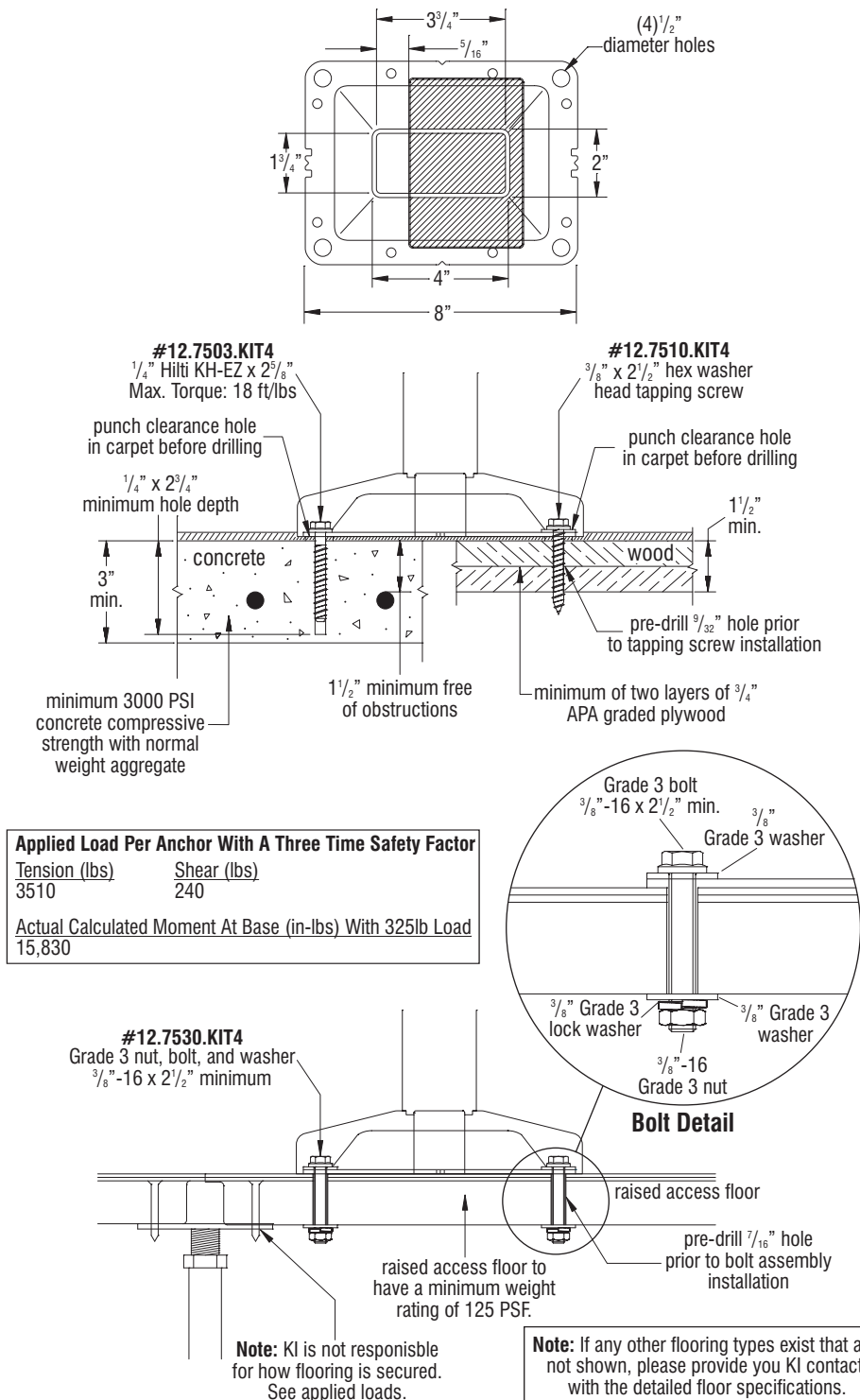



Assemble units as described herein only. To do otherwise may result in instability. All screws, nuts and bolts must be tightened securely and must be checked periodically after assembly. Failure to assemble properly, or to secure parts may result in assembly failure and personal injury.

TOOLS REQUIRED

- Hammer drill and bit for concrete anchor holes
- Drill and bit for pilot holes in wood floor
- #3 Phillips head screwdriver bits
- #2 Phillips head screwdriver bits
- Drill motor
- Drill bits set
- Socket set
- Pliers
- Chalk line
- Tape measure

Note: Read these assembly instructions carefully prior to product installation. Product failure and personal injury may result if instructions are not followed.

MINIMUM CONSTRUCTION REQUIRED FOR UPRIGHT INSTALLATION

Wood Floors

- Minimum two layers of $\frac{3}{4}$ " thickness tongue & groove
- APA rated grade plywood
- Allow minimum embedment $1\frac{1}{2}$ " with lag screws

Concrete Floors

- 3000 psi Concrete compressive strength
- 3" thick free of obstructions for $1\frac{1}{2}$ "
- 4" thick for riser mount free of obstruction for $2\frac{1}{2}$ "
- Riser to be plumb within $\frac{1}{8}$ degree
- Minimum anchor embedment $1\frac{1}{2}$ "

Note: Warranty null and void if KI product is installed on flooring not meeting minimum structural requirements stated above.

FLOOR FASTENER REQUIREMENTS

Wood Floors

- $\frac{5}{16}$ " x $1\frac{3}{4}$ " lag bolts; grade 3
- $\frac{5}{16}$ " flat washers
- $\frac{3}{8}$ " toggle bolts
- All hardware to be plated
- Four bolt assemblies required per base

Concrete Floors

- $\frac{5}{16}$ -18 or $\frac{3}{8}$ -16 Grade 3 expansion anchors.
- Standard flat washers, plated
- LockTite (red) thread lock or equal
- Four screw assemblies required per base

Note: Floor-mounting fasteners are not provided unless specified.

- For questions concerning anchor selection and special floor conditions, please contact KI Customer Service at 1-800-424-2432.

STEPS FOR INSTALLATION

1. Read and review Assembly Instructions.
2. Review space-planning layouts.
3. Review job site and verify field conditions.
4. Verify floor structural conditions.
5. Stage product for installation.
6. Locate and mark layout reference points.
7. Locate and drill holes into floor.
8. Mount bases to floor.
9. Attach seats.
10. Install plastic flange covers.

■ Jury Base Seating - Swing-Arm Bases

Assembly Instructions



Assemble units as described herein only. To do otherwise may result in instability. All screws, nuts and bolts must be tightened securely and must be checked periodically after assembly. Failure to assemble properly, or to secure parts may result in assembly failure and personal injury.

Jury Base Fixed- & Adjustable-Height Swing-Arm Installation

1. Determine if your installation includes "Fixed-Height Swing Arm Bases" (Figure 1) or "Adjustable-Height Swing Arm Bases" (Figure 2). Stage bases at the appropriate location according to the space-planning layout.

2. Mark base perimeter and remove carpet for full contact of base flange with the mounting surface.

Note: Due to varying floor conditions, shimming may be required under base flanges to level the seat.

3. Mount base flanges to the floor loosely at first using appropriate fasteners, referencing "Floor Anchor Specifications" details on page 2. Center the black flange clips under both 6" sides of the base flanges, making sure that the barbs end is up and insert the locating tabs of the flange so they are tight into the base flange notches, as illustrated (Figures 1 & 2, Detail A).

4. After all bases are positioned and adjusted with shims as needed, securely tighten base flanges to the floor (Figures 1 & 2).

5. If you are installing **Adjustable-Height Swing-Arm** bases, orient the adjustable-height cylinder as illustrated and press into the opening in the arm (Figure 2).

Note: Do not install plastic flange covers until instructed to do so on page 7.

6. If the Jury Base Seating being assembled includes seats for fixed-height swing-arms, proceed to page 5. If the seating being assembled includes seats for adjustable-height swing-arms, proceed to page 6.

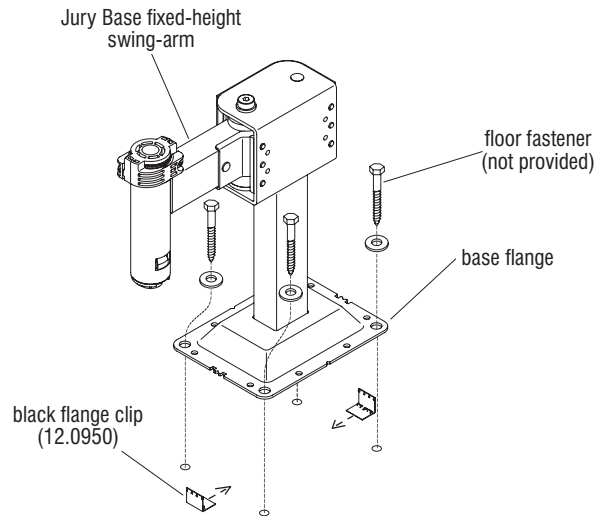
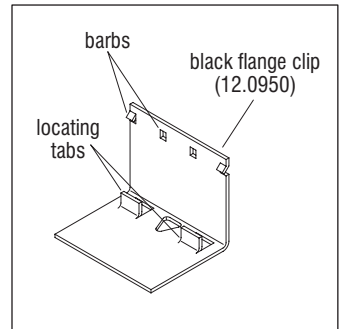

Figure 1 - Fixed-Height Swing-Arm Base



Detail A

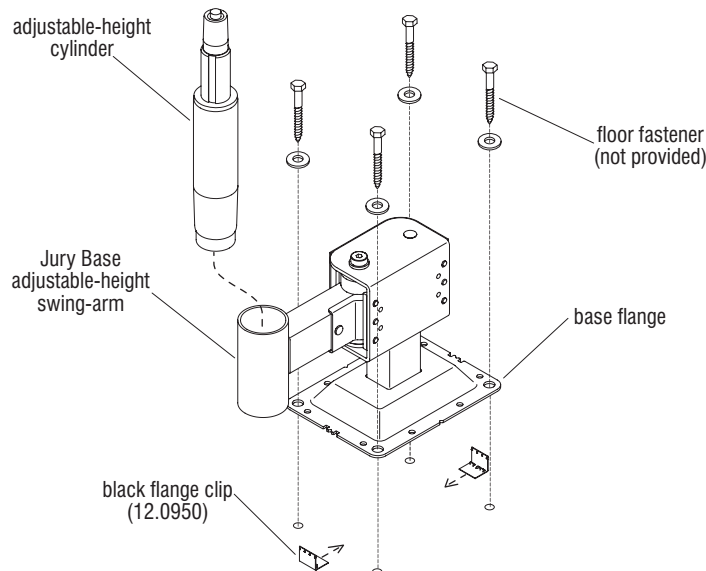

Figure 2 - Adjustable-Height Swing-Arm Base



Assemble units as described herein only. To do otherwise may result in instability. All screws, nuts and bolts must be tightened securely and must be checked periodically after assembly. Failure to assemble properly, or to secure parts may result in assembly failure and personal injury.

Jury Base with Swing-Arm - Fixed-Height Seat Installation

1. Attach the appropriate seating assemblies to the swing arm/seat spider as described below (see Detail B & reference appropriate illustrations on this page).

Note: With all seating assemblies, take care to not over-tighten any screws which may result in stripping of plastic parts.

Doni, Grazie, Intellect Wave, LimeLite, Strive & Torsion Seats:

Place a gold-steel washer onto the seat shaft. Lightly grease the seat shaft and keyway using a lithium grease and brush. Route the seat shaft down through the index collar and swing arm housing. Using a ring clip separator, place a $\frac{3}{4}$ " retaining ring onto the bottom of the seat shaft to secure.

Apply Seats: Set the seat over the seat spider, aligning the mounting locations. Secure the spider to the seat with four $\frac{1}{4}$ -20 x $\frac{1}{2}$ " hex head screws, torqued to 10 ft/lb. Do not over-tighten.

2. For all seating units, rotate the seat right or left to align the front edge of the seat to be parallel with the edge of the worksurface. **Tighten the two screws on the index collar to secure the seat alignment.** Torque screws to 50 in/lb (Detail B).
3. Proceed to flange cover installation instructions on page 7.

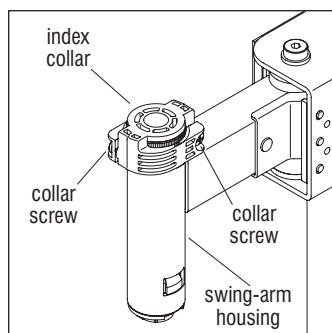

Detail B

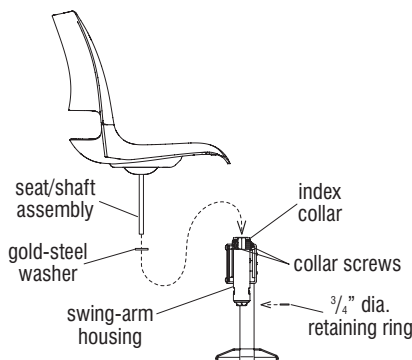

Doni

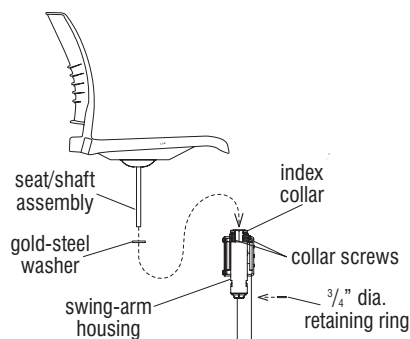

Strive

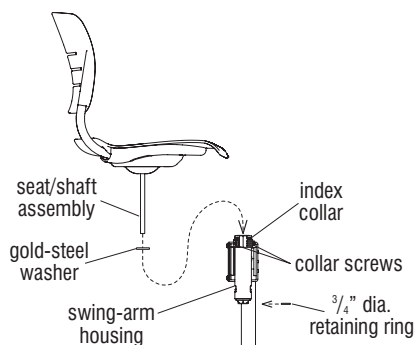

Grazie

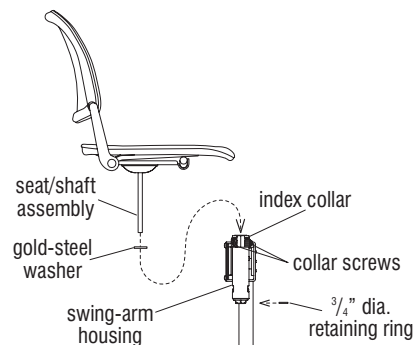

Torsion & Torsion Air

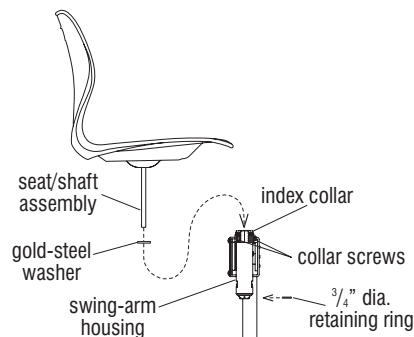

Intellect Wave

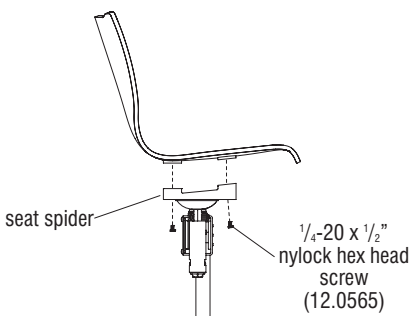

Apply

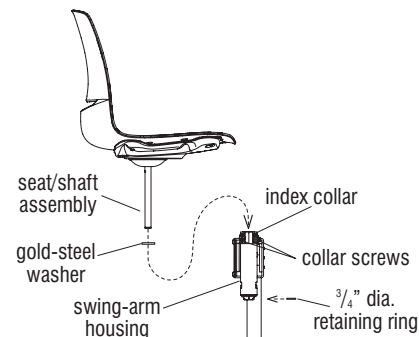

LimeLite

■ Jury Base Seating - Swing-Arm Bases

Assembly Instructions



Assemble units as described herein only. To do otherwise may result in instability. All screws, nuts and bolts must be tightened securely and must be checked periodically after assembly. Failure to assemble properly, or to secure parts may result in assembly failure and personal injury.

Jury Base with Swing-Arm - Adjustable-Height Seat Installation

1. Place the appropriate seating assemblies onto the height-adjust cylinder or seat spider following the instructions below.

Important: When installing each seat assembly onto the height-adjust cylinder, make certain that the seat back is positioned parallel to the worksurface edge when the swing-arm is forward, at it's final resting position and before applying pressure to secure the seat in place.

Diem, Doni, Grazie, Impress, Intellect Wave, LimeLite, Oath, Strive, & Torsion Seats: With the swing-arm fully forward at its resting position, align the seat assembly straight, so the back is parallel to the

edge of the worksurface and set the seat onto the height-adjust cylinder. Press down firmly to secure in place.

Note: When installing the seat spider to the apply seat, take care to not over-tighten the screws, which may result in stripping of plastic parts.

Apply Seats: Mate the seat shell over the seat spider, aligning the mounting locations. Secure the spider to the seat with four $\frac{1}{4}$ -20 x $\frac{1}{2}$ " hex head screws, torqued to 10 ft/lb. Do not over-tighten. Next, with the swing-arm fully forward at its resting

position, align the seat assembly straight, so the back is parallel to the edge of the worksurface and set the seat onto the height-adjust cylinder. Press down firmly to secure in place.

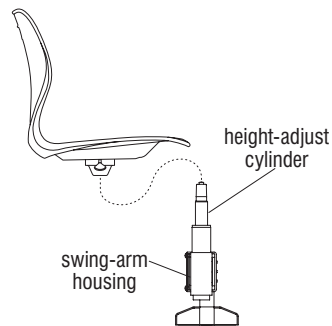

Intellect Wave

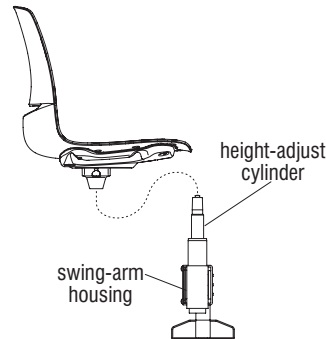

LimeLite

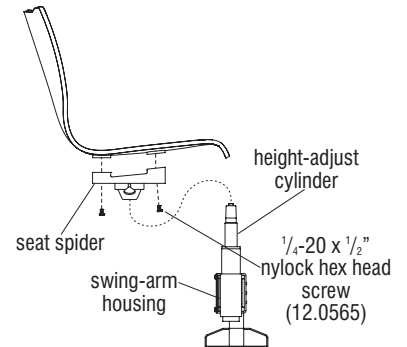

Apply

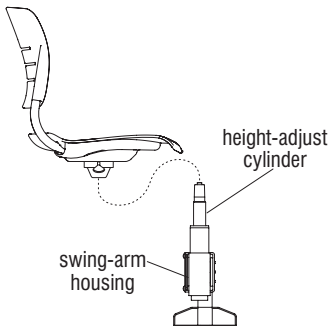

Grazie

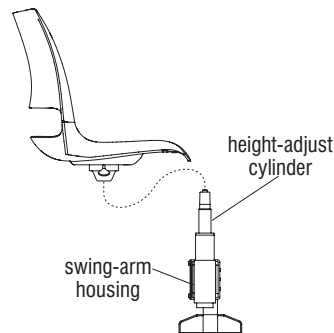

Doni

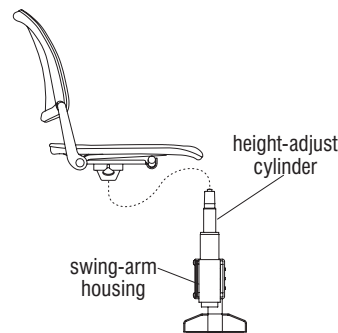

Torsion & Torsion Air

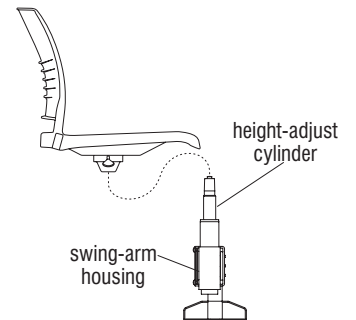

Strive

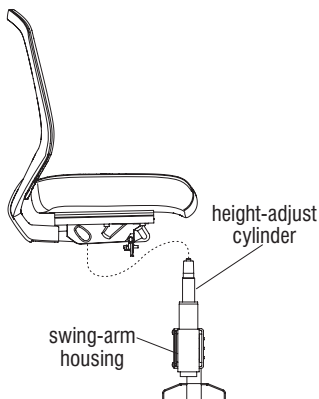

Diem

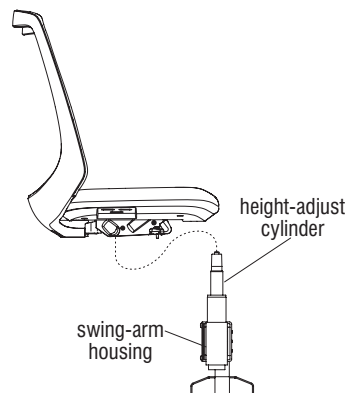

Oath

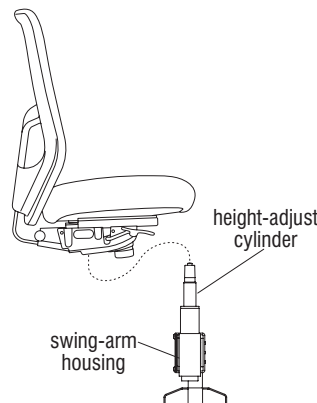

Impress Ultra

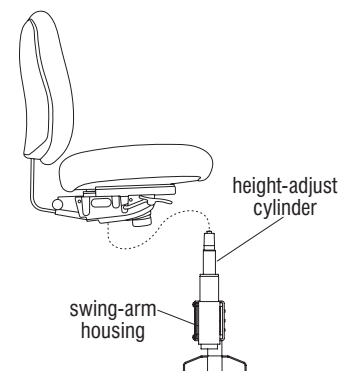

Impress Task



Assemble units as described herein only. To do otherwise may result in instability. All screws, nuts and bolts must be tightened securely and must be checked periodically after assembly. Failure to assemble properly, or to secure parts may result in assembly failure and personal injury.

**Jury Base with Swing-Arm -
Fixed- & Adjustable-Height
Flange Covers Installation**

1. Break out tabs in plastic covers to fit around rectangular columns. Snap together around column. Push down to engage flange clips. Push tight to floor. Note direction of column before breaking out tabs (Figures 3 & 4).

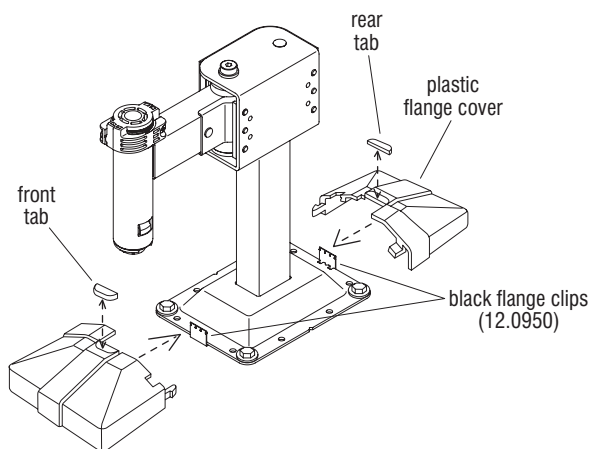

Figure 3 - Fixed-Height Swing-Arm Base

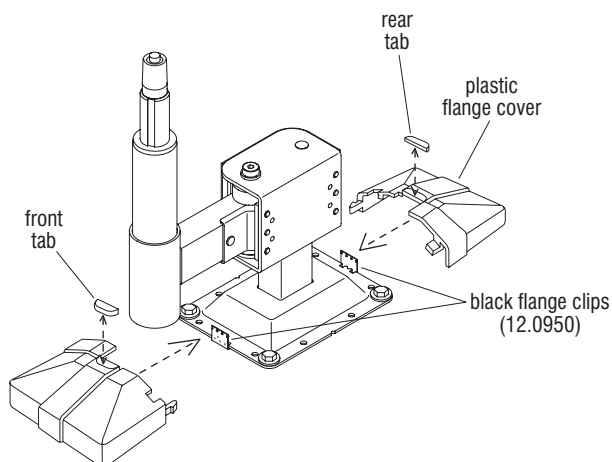

Figure 4 - Adjustable-Height Swing-Arm Base

KI
1330 Bellevue Street
P.O. Box 8100
Green Bay, Wisconsin 54308-8100
1-800-424-2432
www.ki.com

KI is a registered trademark
of Krueger International, Inc.

© 2022 Krueger International, Inc.
All Rights Reserved
Code KI-AI-000080R1/KI/PDF/I 222

