

Parts Diagram

Opt4[®] HD Sled Base Chair & Stool

May 2024

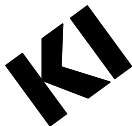
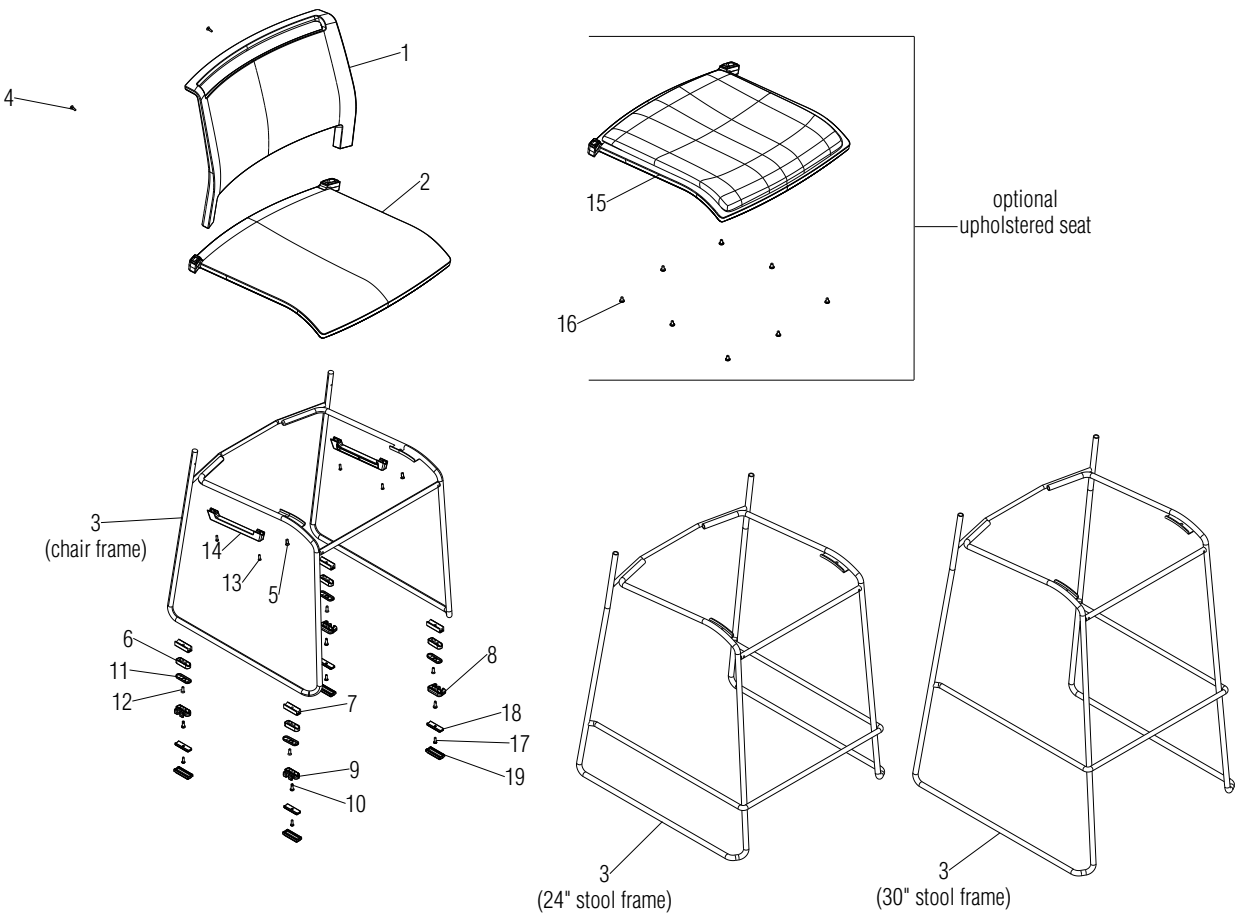

■ Opt4® HD Sled Base Chair & Stool

Parts Diagram

.X = KD

.XX = Select Color

Item 3 frame comes pre installed with specified glides.

Items 6, 7, and 11 are used on chairs manufactured before 5/4/2022.

Item 10 screw used to attach Items 6, 7, 8 & 9.

Item 12 screw used to attach Items 6 & 11 when stacked together (Item 10 not used for this configuration).

Items 13 & 14 stacking bumper and screw are only used on seats equipped with upholstered seat.

Item 15 includes Item 16 installed.

Item 18 glide body uses Item 19 glide cap and requires Item 17 screw for attachment.

Item 20 glide cap removal tool (not shown) is used to remove old glide caps for replacement of felt caps. See KI-RR-000030 for instructions.

Item	Part Number	Item Description	Req Qty	Item	Part Number	Item Description	Req Qty
1	46.3817.04XX.AX	Backrest, Poly Chair	1	9	10.0099.R.A.X	Ganging Glide, Male Nylon	2
	46.3818.04XX.AX	Backrest, Mesh Chair	1	10	12.0836.X	Screw, M5 x 14mm PPH S/T (see note)	4
2	46.3815.04XX.AX	Seat, Poly Chair	1	11	10.0101.X	Cap, Glide Steel (used on item 6)	4
	46.3816.04XX.AX	Seat, Mesh Chair	1	12	06.0098.X	Screw, M5 x 16mm TFH S/T (see note)	4
3	04RF	Weldment, Chair Frame (see note)	1	13	46.4117.X	Screw, M4 x 12mm PBH S/T (see note)	4
	04RF	Weldment, 24" Stool Frame (see note)	1	14	46.4115.XX.X	Bumper, Sled Stacking (see note)	2
	04RF	Weldment, 30" Stool Frame (see note)	1	15	04US	Seat, Upholstered (see note)	1
	04RF	Weldment, Chair Frame for Uph. Seat (see note)	1	16	12.0838.X	Screw, #12-16 x .38" #10 Truss Head Hi-Lo Zinc (see note)	8
	04RF	Weldment, 24" Stool Frame for Uph. Seat (see note)	1	17	06.0096.X	Screw, M5 x 14mm TFH S/T (see note)	4
	04RF	Weldment, 30" Stool Frame for Uph. Seat (see note)	1	18	46.4334.X	Glide Body, Sled Base Snap-Fit (see note)	4
4	12.0835.XX.X	Screw, M4 x 12mm PBH S/T	2	19	46.4338.X	Glide Cap, Sled Base Snap-Fit Steel (see note)	4
5	12.0834.X	Screw, M5 x 13mm PFH T/C	2		46.4337.X	Glide Cap, Sled Base Snap-Fit Poly (see note)	4
6	10.0098.A.GNY.X	Glide, Non-Ganging Nylon	4		46.4339.X	Glide Cap, Sled Base Snap-Fit Non-Skid (see note)	4
7	10.0102.X	Glide, Non-Skid PVC	4		46.4331.X	Glide Cap, Sled Base Snap-Fit Felt (see note)	4
8	10.0099.L.A.X	Ganging Glide, Female Nylon	2	20	10.0138.X	Removal Tool, Swivel Glide Cap (not shown) (see note)	1

